

ST. TAMMANY PARISH COUNCIL

ORDINANCE

ORDINANCE CALENDAR NO: 5039

ORDINANCE COUNCIL SERIES NO: _____

COUNCIL SPONSOR: MR. THOMPSON

PROVIDED BY: COUNCIL OFFICE

INTRODUCED BY: MR. GOULD

SECONDED BY: MR. SMITH

ON THE 11 DAY OF JULY , 2013

AN ORDINANCE ESTABLISHING A SPEED LIMIT OF 25 MPH ON A PORTION OF BEVERLY DRIVE (3-D-022). (WARD 3, DISTRICT 3)

WHEREAS, St. Tammany Parish Government is charged with protecting the safety and general welfare of citizens of the Parish; and

WHEREAS, the St. Tammany Parish department of Engineering has evaluated the current speed limit on Beverly Drive (3-D-022) between Lake Ramsey Road and Karrie Lane and have determined that the existing speed limit of 35 MPH should be reduced to 25 MPH.

THE PARISH OF ST. TAMMANY HEREBY ORDAINS: in regular session convened that:

SECTION I: A speed limit of 25 MPH is hereby established on Beverly Drive (3-D-022). (Ward 3, District 3)

SECTION II: The St. Tammany Parish Department of Public Works is hereby directed to replace the existing 35 MPH signs with 25 MPH signs and other directional signs as per the St. Tammany Parish Department of Engineering memo attached.

REPEAL: All ordinances or parts of Ordinances in conflict herewith are hereby repealed.

SEVERABILITY: If any provision of this Ordinance shall be held to be invalid, such invalidity shall not affect other provisions herein which can be given effect without the invalid provision and to this end the provisions of this Ordinance are hereby declared to be severable.

EFFECTIVE DATE: This Ordinance shall become effective fifteen (15) days after adoption.

MOVED FOR ADOPTION BY: _____ SECONDED BY: _____

WHEREUPON THIS ORDINANCE WAS SUBMITTED TO A VOTE AND RESULTED IN THE FOLLOWING:

YEAS: _____

NAYS: _____

ABSTAIN: _____

ABSENT: _____

THIS ORDINANCE WAS DECLARED DULY ADOPTED AT A REGULAR MEETING OF THE PARISH COUNCIL ON THE 1 DAY OF AUGUST , 2013 ; AND BECOMES ORDINANCE COUNCIL SERIES NO _____.

JERRY BINDER, COUNCIL CHAIRMAN

ATTEST:

THERESA L. FORD, COUNCIL CLERK

PATRICIA P. BRISTER, PARISH PRESIDENT

Published Introduction: JUNE 27 , 2013

Published Adoption: _____, 2013

Delivered to Parish President: _____, 2013 at _____

Returned to Council Clerk: _____, 2013 at _____



St. Tammany Parish

Department of Engineering
P. O. Box 628
Covington, LA 70434
Phone: 985.898.2552
Fax: 985.898.5205
E-mail: eng@stpgov.org

Pat Brister
Parish President

Date: June 13, 2013

To: Joey Lobrano
Right Of Way Coordinator
Department Of Public Works

From: Rebecca B. Lala, P.E. *RBL 6-13-13*
Traffic Engineer

Re: District 3
Beverly Dr.
6-"Speed Limit 25" signs
2-"STOP" sign
1-"No Outlet" sign

The Department of Engineering recommends the installation of Signage to be installed in District 3.

1. Replace and Raise existing STOP sign on Beverly at the intersection of Beverly and Lake Ramsey.
2. Remove old Dead End sign and Speed Limit 35 sign on Beverly near the intersection of Beverly and Lake Ramsey.
3. Install NO OUTLET sign on Beverly 15' north of the removed dead end sign.
4. Install SPEED LIMIT 25 sign on Beverly 25' south of the removed dead end sign.
5. Replace Speed Limit 35 sign on Beverly near mailbox 75437 with a SPEED LIMIT 25 sign. Put Speed Limit sign on Top of existing SC@P sign.
6. Install SPEED LIMIT 25 sign across from mailbox 75437 on Beverly near Property Line.
7. Replace existing Speed Limit 35 sign on Beverly with a SPEED LIMIT 25 sign.
8. Install SPEED LIMIT 25 sign on Beverly, across from Job #7.
9. Install SPEED LIMIT 25 sign on Beverly, 100' from the Beverly and Karrie intersection.
10. Replace existing STOP sign on Beverly at the Beverly and Karrie intersection.

cc. Charles E. Williams, P.E.
Michael Spiehler
Councilman James A. Thompson

KARRIE

BEVERLY DR.
3-D-22
DISTRICT 3

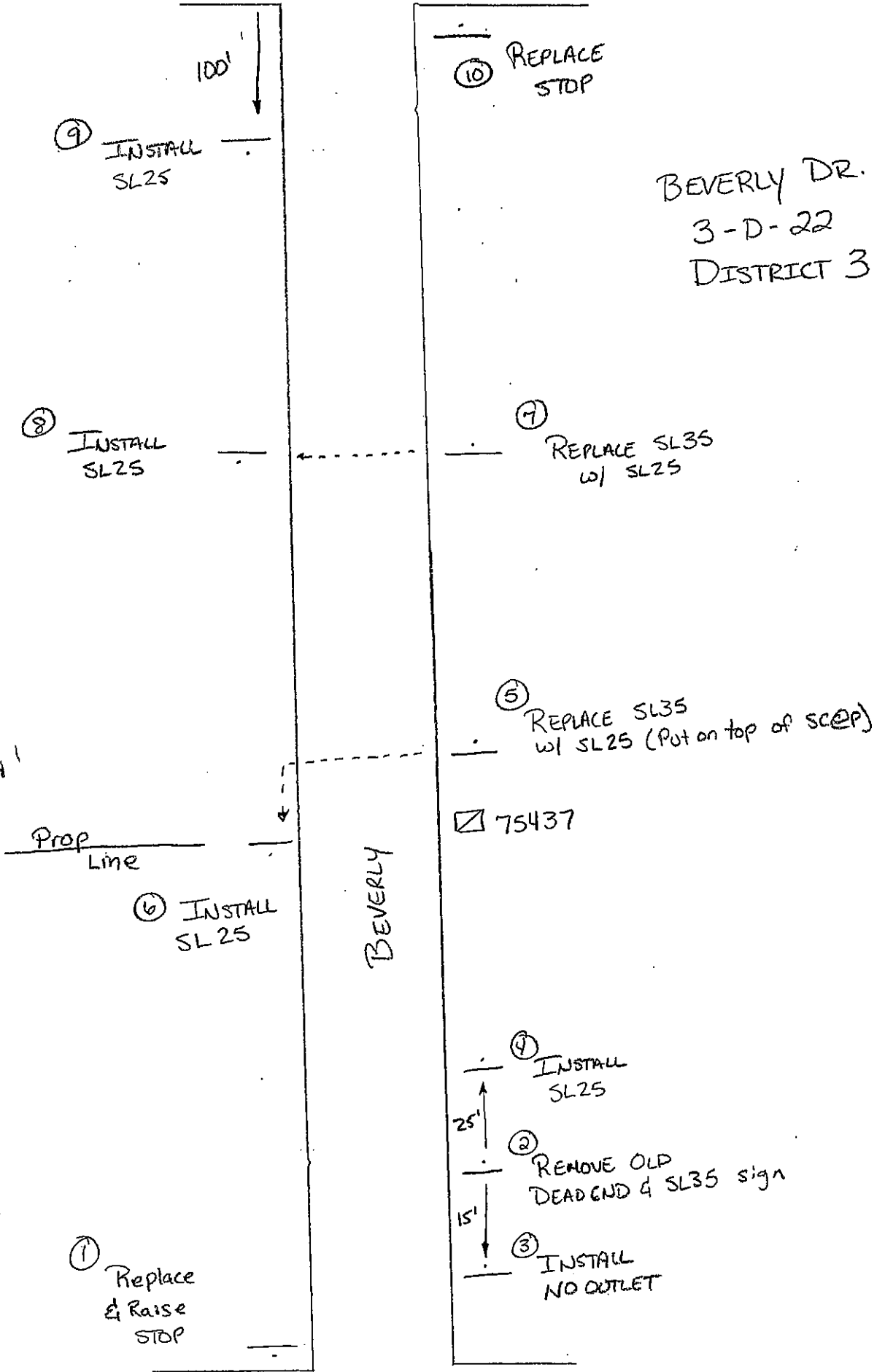

LAKE RAMSEY RD.