

ST. TAMMANY PARISH COUNCIL

ORDINANCE

ORDINANCE CALENDAR NO: 5397 ORDINANCE COUNCIL SERIES NO: _____

COUNCIL SPONSOR: TANNER/BRISTER PROVIDED BY: DEVELOPMENT

INTRODUCED BY: MR. DEAN SECONDED BY: MR. THOMPSON

ON THE 7 DAY OF MAY , 2015

(ZC15-04-039) AN ORDINANCE AMENDING THE OFFICIAL ZONING MAP OF ST. TAMMANY PARISH, LA, TO RECLASSIFY A CERTAIN PARCEL LOCATED ON THE SOUTH SIDE GALATAS ROAD, WEST OF C.S.OWENS ROAD AND WHICH PROPERTY COMPRISES A TOTAL OF 1.327 ACRES OF LAND MORE OR LESS, FROM ITS PRESENT A-2 (SUBURBAN DISTRICT) TO AN CB-1 (COMMUNITY BASED FACILITIES DISTRICT) & RO (RURAL OVERLAY), (WARD 1, DISTRICT 1). (ZC15-04-039)

Whereas, the Zoning Commission of the Parish of St. Tammany after hearing in accordance with law, Case No. ZC15-04-039, has recommended Denial to the Council of the Parish of St. Tammany, Louisiana, that the zoning classification of the above referenced area remains A-2 (Suburban District); and

Whereas, the St. Tammany Parish Council has held its public hearing in accordance with law; and

Whereas, the St. Tammany Parish Council has found it necessary for the purpose of protecting the public health, safety and general welfare, to designate the above described property as CB-1 (Community Based Facilities District) & RO (Rural Overlay) see Exhibit "A" for complete boundaries.

THE PARISH OF ST. TAMMANY HEREBY ORDAINS, in regular session convened that:

SECTION I: The zoning classification of the above described property is hereby changed from its present A-2 (Suburban District) to an CB-1 (Community Based Facilities District) & RO (Rural Overlay).

SECTION II: The official zoning map of the Parish of St. Tammany shall be and is hereby amended to incorporate the zoning reclassification specified in Section I hereof.

REPEAL: All ordinances or parts of Ordinances in conflict herewith are hereby repealed.

SEVERABILITY: If any provision of this Ordinance shall be held to be invalid, such invalidity shall not affect other provisions herein which can be given effect without the invalid provision and to this end the provisions of this Ordinance are hereby declared to be severable.

EFFECTIVE DATE: This Ordinance shall become effective fifteen (15) days after adoption.

MOVED FOR ADOPTION BY: _____ SECONDED BY: _____

WHEREUPON THIS ORDINANCE WAS SUBMITTED TO A VOTE AND RESULTED IN THE FOLLOWING:

YEAS: _____

NAYS: _____

ABSTAIN: _____

ABSENT: _____

THIS ORDINANCE WAS DECLARED DULY ADOPTED AT A REGULAR MEETING OF THE PARISH COUNCIL ON THE 9 DAY OF JULY , 2015 ; AND BECOMES ORDINANCE COUNCIL SERIES NO _____.

RICHARD E. TANNER, COUNCIL CHAIRMAN

ATTEST:

THERESA L. FORD, COUNCIL CLERK

PATRICIA P. BRISTER, PARISH PRESIDENT

Published Introduction: MAY 21 , 2015

Published Adoption: _____, 2015

Delivered to Parish President: _____, 2015 at _____

Returned to Council Clerk: _____, 2015 at _____

Exhibit "A"

ZC15-04-039

Located as part of the West Half of Lot 13 Galatas Subdivision, also located in Section 14 Township 7 South Range 10 East, St. Tammany Parish, Louisiana.

From the Northwest Corner of the West Half of Lot 13 Galatas Subdivision, this being the Point of Beginning.

From the Point of Beginning run along the South Right-of-way of Galatas Road, North 63 degrees 39 minutes 00 seconds East, 313.15 feet to a point; thence South 22 degrees 40 minutes 34 seconds East, 185.00 feet to a point; thence South 63 degrees 39 minutes 10 seconds West, 313.39 feet to a point; thence North 22 degrees 36 minutes 02 seconds West, 185.00 feet back to the Point of Beginning.

This tract contains 1.327 Acres.

CASE NO.: ZC15-04-039
PETITIONER: Chuck Hickman
OWNER: Candice & Chuck Hickman
REQUESTED CHANGE: From A-2 (Suburban District) to CB-1 (Community Based Facilities District) & RO (Rural Overlay)
LOCATION: Parcel located on the south side Galatas Road, west of C.S.Owens Road; S14, T7S, R10E; Ward 1, District 1
SIZE: 1.327 acres

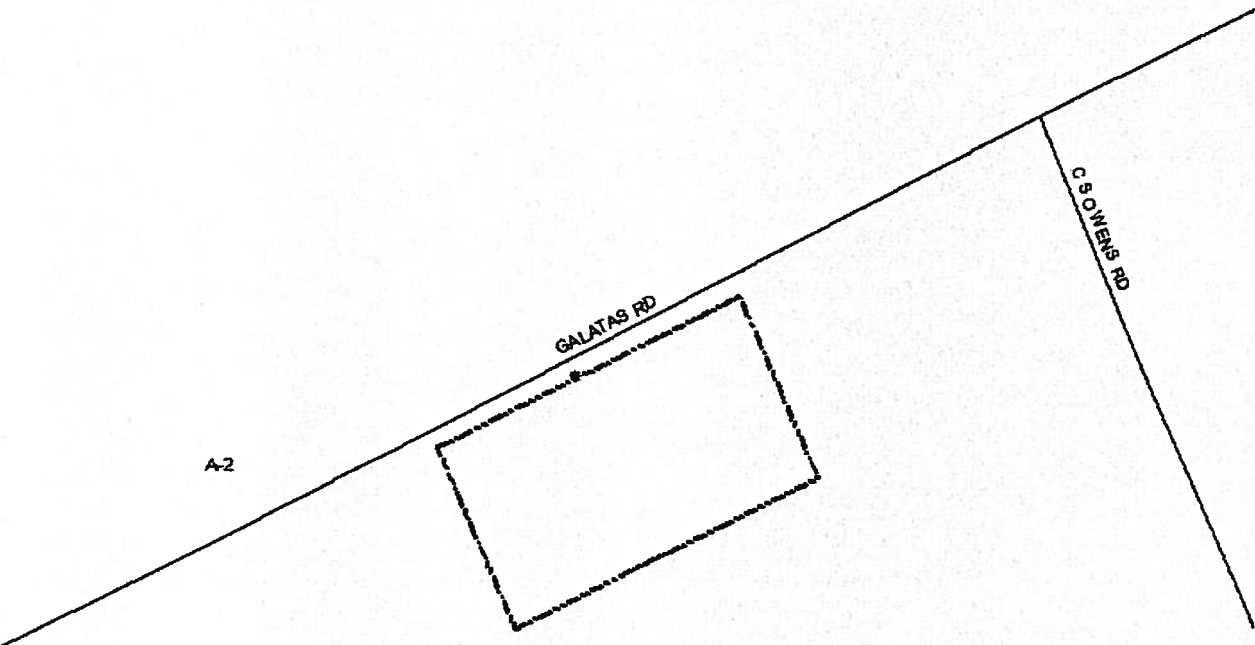

89/11/2884 06:56 5842451384
Apr-02-03 08:49A

LOMBARDO

2015-04-03

THIS PROPERTY IS LOCATED IN P2001 ZONE C.
FOR PERMITTING FIRM, COMM. PANEL NO.
280205 DEED C, MAP DATED 4-2-1991.



- 1/2" RED IRON PIPE FOUND
- 1/4" IRON PIPE FOUND
- 1/2" IRON PIPE FOUND
- 2" IRON PIPE FOUND

THIS MAP IS IN ACCORDANCE WITH THE
MINIMUM STANDARDS DETAINED REQUIRE-
MENTS PURSUANT TO THE ACCURACY
STANDARDS OF A LAND SURVEY AND THE
APPLICABLE STANDARDS OF PRACTICE
CITED IN LAC 10:61.

MAP PREPARED FOR

ROBERT J. WIENER

SECTION A SURVEY MADE OF PROPERTY LOCATED IN WEST HALF OF LOT 13, GALATHEA
SUBDIVISION, ALSO LOCATED IN SECTION 14 T7S, R1E,
ST. TAMMANY PARISH, LOUISIANA
THIS MAP IS IN ACCORDANCE WITH A PHYSICAL SURVEY MADE ON THE GROUND UNDER THE SUPERVISION OF THE ENGINEER:
SIGNATURE AND CERTIFIED SEAL MUST BE IN RED ON THIS PLAN IS NOW A TRUE COPY.

LAND SURVEYING INC.
COVINGTON, LOUISIANA

CERTIFIED CERTIFICATE

John R. Fizzarone
LOUISIANA REGISTERED LAND SURVEYOR

SCALE: 1" = 200'

DATE: FEBRUARY 14, 2000

MAP NO. 8737

(163) 840-6377

798-0757