

ST. TAMMANY PARISH COUNCIL

ORDINANCE

ORDINANCE CALENDAR NO. 2954 ORDINANCE COUNCIL SERIES NO. 04-

SPONSORED BY MR. IMPASTATO PROVIDED BY COUNCIL OFFICE

INTRODUCED BY MR. BAGERT SECONDED BY MR. IMPASTATO

ON THE 4TH DAY OF NOVEMBER 2004

ORDINANCE TO EXTEND FOR AN ADDITIONAL SIX (6) MONTHS THE MORATORIUM ON THE ISSUANCE OF BUILDING PERMITS FOR THE CONSTRUCTION OR PLACEMENT OF BUILDING STRUCTURES WITHIN A PORTION OF CYPRESS PARK SUBDIVISION AND A PORTION OF SURROUNDING AREAS WITHIN WARD 7, DISTRICT 7.

WHEREAS, on July 1, 2004, the Parish Council initially adopted Ordinance C.S. No. 04-0913 to impose a six (6) month moratorium on the issuance of building permits for construction or placement of building structures within a portion of Cypress Park Subdivision in Ward 7, District 7; and

WHEREAS, subsequent thereto, the Parish Council deemed it necessary to adopt Ordinance C.S. No. 04-0944 to expand the boundaries of the moratorium to protect and preserve the health, safety and property interests of residents within Cypress Park Subdivision and surrounding areas; and

WHEREAS, it is necessary to extend the moratorium heretofore imposed on the issuance of building permits to allow sufficient time to evaluate the adverse drainage conditions and to formulate measures to protect residents in Cypress Park Subdivision and the expanded areas.

THE PARISH OF ST. TAMMANY HEREBY ORDAINS that it extends for an additional six (6) months the moratorium on the issuance of permits for construction or placement of building structures within a portion of Cypress Park Subdivision and a portion of the surrounding areas, all as more fully described herein and on the attached map:

An area, which boundaries commence at the intersection of U.S. Highway 190 and Anchorage Drive, also the point of beginning, thence follow Anchorage Drive in a northerly direction to its intersection with Berry Todd Road, thence follow Berry Todd Road in an easterly direction to its intersection with Graci Avenue, thence follow an imaginary line due south from said intersection to the northern most point of Emerald Drive, thence follow Emerald Drive south to its intersection with U.S. Highway 190, thence follow U.S. Highway 190 west northwest to its intersection with Anchorage Drive, also the point of beginning. All as indicated on the map attached hereto.

LESS AND EXCEPT: Lots 3 and 4 of Square 8 within Cypress Park Subdivision released from the effects of this moratorium per Resolution C.S. No. C-1163, adopted July 1, 2004.

BE IT FURTHER ORDAINED that the moratorium herein imposed may be vacated, in whole or in part, by Resolution of this governing body pursuant to Chapter 5, Article II, Section 5-056.00 of the Parish Code of Ordinances.

REPEAL: All Ordinances or parts of Ordinances in conflict herewith are hereby repealed.

SEVERABILITY: If any provision of this Ordinance shall be held to be invalid, such invalidity shall not affect other provisions herein which can be given effect without the invalid provision and to this end the provisions of this Ordinance are hereby declared to be severable.

DATE OF ENACTMENT: This Ordinance shall become effective immediately upon final adoption.

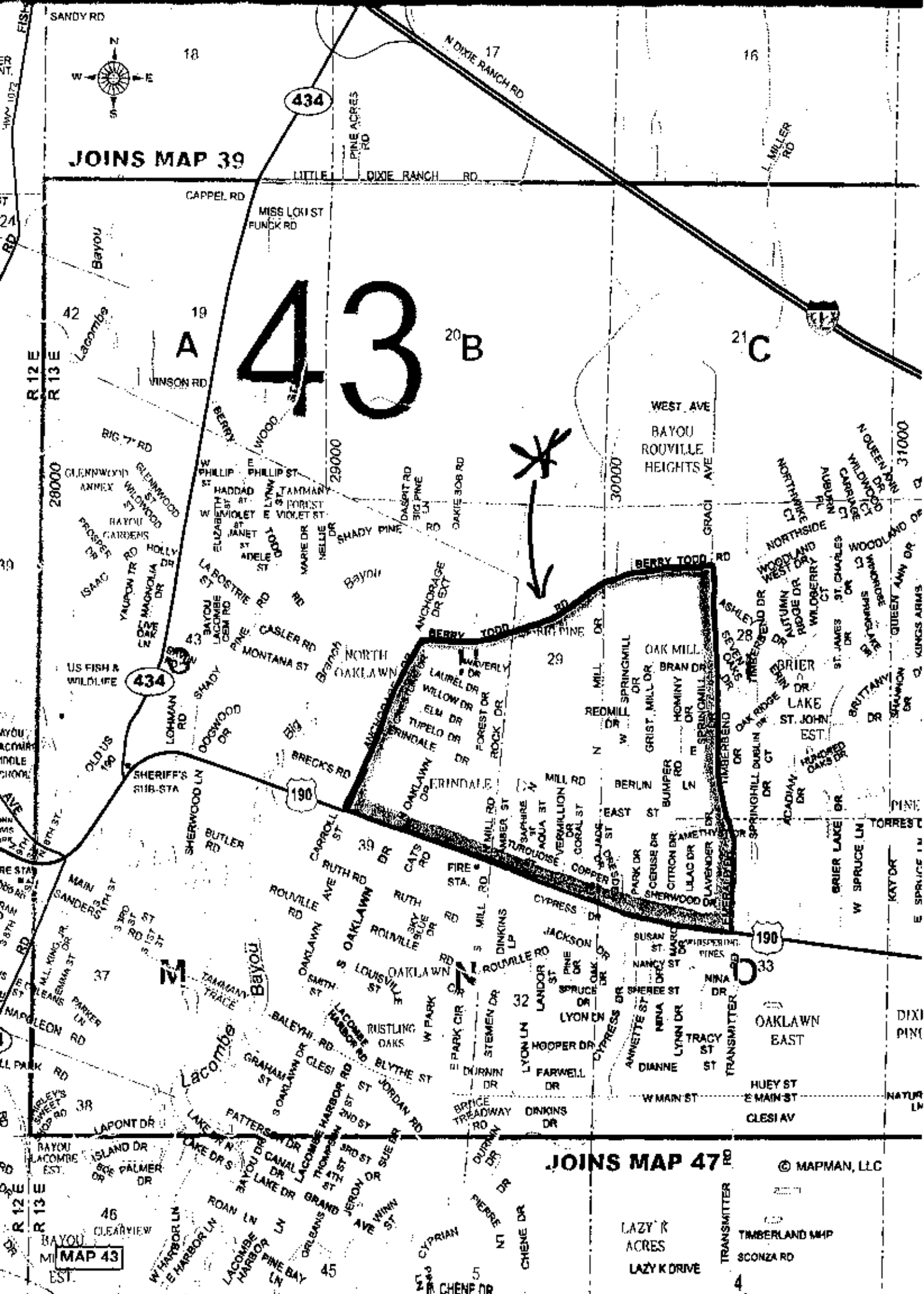

LAZY R ACRES
LAZY K DRIVE

© MAPMAN, LLC
TIMBERLAND MAP
SCONZA RD