

ST. TAMMANY PARISH COUNCIL

ORDINANCE

ORDINANCE CALENDAR NO. 2954

ORDINANCE COUNCIL SERIES NO. 04-

SPONSORED BY MR. IMPASTATO

PROVIDED BY COUNCIL OFFICE

INTRODUCED BY \_\_\_\_\_

SECONDED BY \_\_\_\_\_

ON THE 4TH DAY OF NOVEMBER 2004

ORDINANCE TO EXTEND FOR AN ADDITIONAL SIX (6) MONTHS THE MORATORIUM ON THE ISSUANCE OF BUILDING PERMITS FOR THE CONSTRUCTION OR PLACEMENT OF BUILDING STRUCTURES WITHIN A PORTION OF CYPRESS PARK SUBDIVISION AND A PORTION OF SURROUNDING AREAS WITHIN WARD 7, DISTRICT 7.

WHEREAS, on July 1, 2004, the Parish Council initially adopted Ordinance C.S. No. 04-0913 to impose a six (6) month moratorium on the issuance of building permits for construction or placement of building structures within a portion of Cypress Park Subdivision in Ward 7, District 7; and

WHEREAS, subsequent thereto, the Parish Council deemed it necessary to adopt Ordinance C.S. No. 04-0944 to expand the boundaries of the moratorium to protect and preserve the health, safety and property interests of residents within Cypress Park Subdivision and surrounding areas; and

WHEREAS, it is necessary to extend the moratorium heretofore imposed on the issuance of building permits to allow sufficient time to evaluate the adverse drainage conditions and to formulate measures to protect residents in Cypress Park Subdivision and the expanded areas.

THE PARISH OF ST. TAMMANY HEREBY ORDAINS that it extends for an additional six (6) months the moratorium on the issuance of permits for construction or placement of building structures within a portion of Cypress Park Subdivision and a portion of the surrounding areas, all as more fully described herein and on the attached map:

An area, which boundaries commence at the intersection of U.S. Highway 190 and Anchorage Drive, also the point of beginning, thence follow Anchorage Drive in a northerly direction to its intersection with Berry Todd Road, thence follow Berry Todd Road in an easterly direction to its intersection with Graci Avenue, thence follow an imaginary line due south from said intersection to the northern most point of Emerald Drive, thence follow Emerald Drive south to its intersection with U.S. Highway 190, thence follow U.S. Highway 190 west northwest to its intersection with Anchorage Drive, also the point of beginning. All as indicated on the map attached hereto.

LESS AND EXCEPT: Lots 3 and 4 of Square 8 within Cypress Park Subdivision released from the effects of this moratorium per Resolution C.S. No. C-1163, adopted July 1, 2004.

BE IT FURTHER ORDAINED that the moratorium herein imposed may be vacated, in whole or in part, by Resolution of this governing body pursuant to Chapter 5, Article II, Section 5-056.00 of the Parish Code of Ordinances.

REPEAL: All Ordinances or parts of Ordinances in conflict herewith are hereby repealed.

SEVERABILITY: If any provision of this Ordinance shall be held to be invalid, such invalidity shall not affect other provisions herein which can be given effect without the invalid provision and to this end the provisions of this Ordinance are hereby declared to be severable.

DATE OF ENACTMENT: This Ordinance shall become effective immediately upon final adoption.

WHEREUPON THIS ORDINANCE WAS SUBMITTED TO A VOTE AND RESULTED IN THE FOLLOWING:

MOVED FOR ADOPTION BY: \_\_\_\_\_, SECONDED BY: \_\_\_\_\_

YEAS:

NAYS:

ABSTAIN:

ABSENT:

THIS ORDINANCE WAS DECLARED DULY ADOPTED AT A REGULAR MEETING OF THE PARISH COUNCIL ON THE \_\_\_\_\_ DAY OF \_\_\_\_\_ 2004; AND BECOMES ORDINANCE COUNCIL SERIES NO. 04-.

\_\_\_\_\_  
PATRICIA BRISTER, COUNCIL CHAIRMAN

ATTEST:

\_\_\_\_\_  
DIANE HUESCHEN, COUNCIL CLERK

\_\_\_\_\_  
KEVIN DAVIS, PARISH PRESIDENT

Published Introduction October 28, 2004

Published Adoption: \_\_\_\_\_, 2004

Delivered to Parish President: \_\_\_\_\_, 2004 at \_\_\_\_\_

Returned to Council Clerk: \_\_\_\_\_, 2004 at \_\_\_\_\_

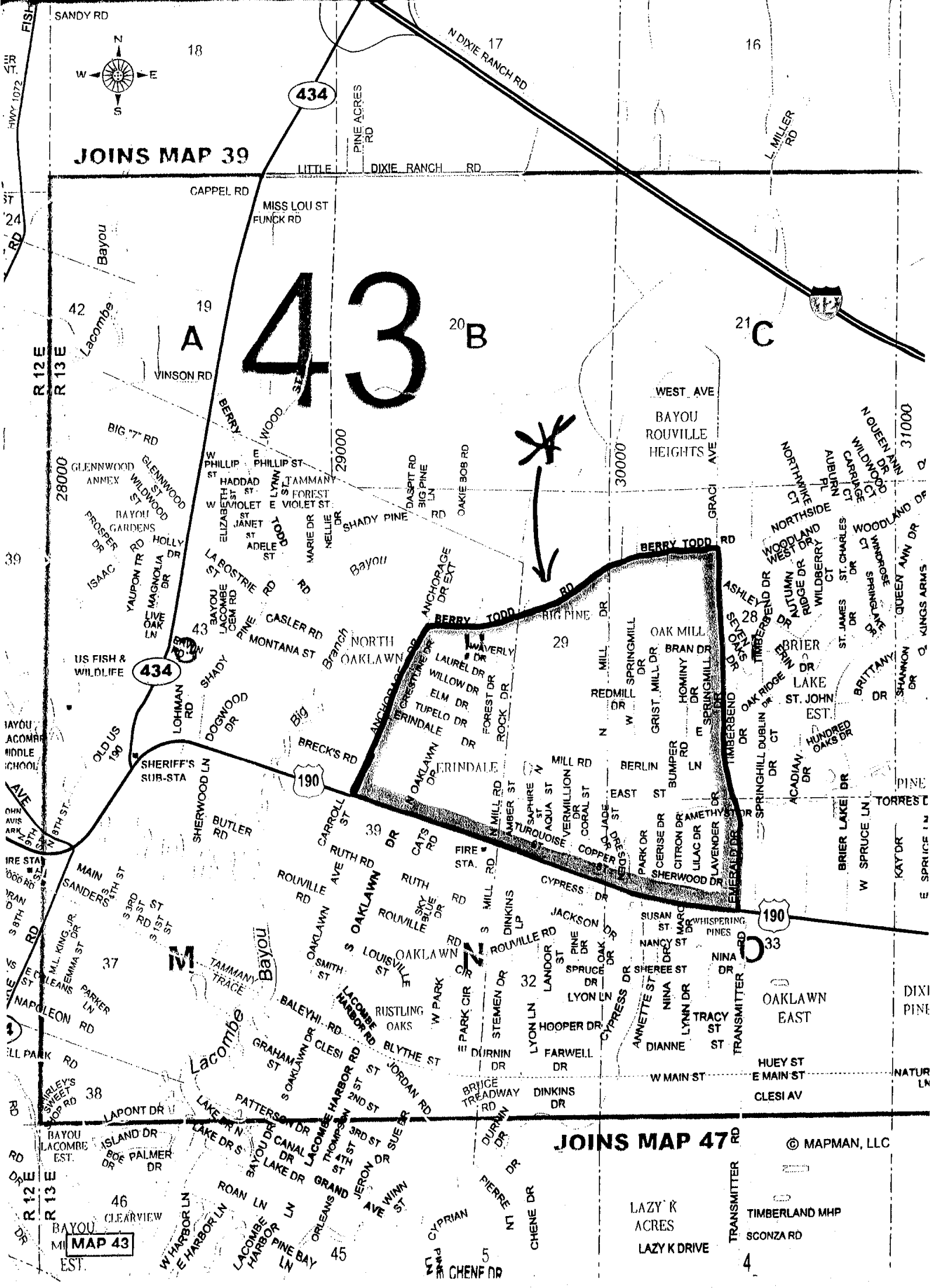

43

JOINS MAP 39

JOINS MAP 47

© MAPMAN, LLC

LAZY K ACRES  
LAZY K DRIVE

TRANSMITTER  
TIMBERLAND MHP  
SCONZA RD

HWY 1072

R 12 E  
R 13 E

AVE

MAP 43

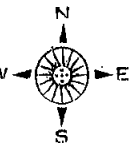

SANDY RD  
N DIXIE RANCH RD  
L MILLER RD  
Cappel Rd  
MISS LOU ST  
FUNCK RD  
VINSON RD  
BERRY WOOD ST  
BIG 7 RD  
GLENWOOD ANMEX  
GLENWOOD WILDWOOD ST  
BAYOU GARDENS  
PROSPER DR  
ISAAC  
YAUPON TR RD  
MAGNOLIA DR  
LIVE OAK  
US FISH & WILDLIFE  
LOHMAN RD  
SHERIFF'S SUB-STA  
SHERWOOD LN  
BUTLER RD  
MAIN  
SANDERS  
PARKER LN  
NAPOLION RD  
LAPONT DR  
ISLAND DR  
BOE PALMER DR  
W HARBOR LN  
E HARBOR LN  
LACOMBE HARBOR LN  
PINE BAY  
ORLEANS  
JERON DR  
AVE WINN ST  
CYPRIAN  
CHENE DR  
PIERRE LN  
DURNIN DR  
BRUCE TREADWAY RD  
DURNIN DR  
STEMEN DR  
E PARK CIR  
W PARK  
RUSTLING OAKS  
BALEYH RD  
CLESI ST  
LACOMBE HARBOR RD  
THOMPSON ST  
3RD ST  
4TH ST  
5TH ST  
6TH ST  
7TH ST  
8TH ST  
9TH ST  
10TH ST  
11TH ST  
12TH ST  
13TH ST  
14TH ST  
15TH ST  
16TH ST  
17TH ST  
18TH ST  
19TH ST  
20TH ST  
21ST ST  
22ND ST  
23RD ST  
24TH ST  
25TH ST  
26TH ST  
27TH ST  
28TH ST  
29TH ST  
30TH ST  
31ST ST  
32ND ST  
33RD ST  
34TH ST  
35TH ST  
36TH ST  
37TH ST  
38TH ST  
39TH ST  
40TH ST  
41ST ST  
42ND ST  
43RD ST  
44TH ST  
45TH ST  
46TH ST  
47TH ST  
48TH ST  
49TH ST  
50TH ST  
51ST ST  
52ND ST  
53RD ST  
54TH ST  
55TH ST  
56TH ST  
57TH ST  
58TH ST  
59TH ST  
60TH ST  
61ST ST  
62ND ST  
63RD ST  
64TH ST  
65TH ST  
66TH ST  
67TH ST  
68TH ST  
69TH ST  
70TH ST  
71ST ST  
72ND ST  
73RD ST  
74TH ST  
75TH ST  
76TH ST  
77TH ST  
78TH ST  
79TH ST  
80TH ST  
81ST ST  
82ND ST  
83RD ST  
84TH ST  
85TH ST  
86TH ST  
87TH ST  
88TH ST  
89TH ST  
90TH ST  
91ST ST  
92ND ST  
93RD ST  
94TH ST  
95TH ST  
96TH ST  
97TH ST  
98TH ST  
99TH ST  
100TH ST