

ST. TAMMANY PARISH COUNCIL

ORDINANCE

ORDINANCE CALENDAR NO. 3076 ORDINANCE COUNCIL SERIES NO. 05-
SPONSORED BY MR. IMPASTATO PROVIDED BY COUNCIL OFFICE
INTRODUCED BY MR. GOULD SECONDED BY MR. BURKHALTER
ON THE 5TH DAY OF MAY 2005

ORDINANCE TO EXTEND FOR AN ADDITIONAL SIX (6) MONTHS THE MORATORIUM ON THE ISSUANCE OF BUILDING PERMITS FOR THE CONSTRUCTION OR PLACEMENT OF BUILDING STRUCTURES WITHIN A PORTION OF CYPRESS PARK SUBDIVISION AND A PORTION OF SURROUNDING AREAS WITHIN WARD 7, DISTRICT 7.

WHEREAS, on December 2, 2004, the Parish Council adopted Ordinance C.S. No. 04-1007 to extend the six (6) month moratorium on the issuance of building permits for construction or placement of building structures within a portion of Cypress Park Subdivision and surrounding areas in Ward 7, District 7; and

WHEREAS, it is necessary to extend the moratorium heretofore imposed on the issuance of building permits to allow sufficient time to evaluate the adverse drainage conditions and to formulate measures to protect residents in Cypress Park Subdivision and the expanded areas.

THE PARISH OF ST. TAMMANY HEREBY ORDAINS that it extends for an additional six (6) months the moratorium on the issuance of permits for construction or placement of building structures within a portion of Cypress Park Subdivision and a portion of the surrounding areas, all as more fully described herein and on the attached map:

An area, which boundaries commence at the intersection of U.S. Highway 190 and Anchorage Drive, also the point of beginning, thence follow Anchorage Drive in a northerly direction to its intersection with Berry Todd Road, thence follow Berry Todd Road in an easterly direction to its intersection with Graci Avenue, thence follow an imaginary line due south from said intersection to the northern most point of Emerald Drive, thence follow Emerald Drive south to its intersection with U.S. Highway 190, thence follow U.S. Highway 190 west northwest to its intersection with Anchorage Drive, also the point of beginning. All as indicated on the map attached hereto.

LESS AND EXCEPT: Those parcels of land released from the effects of this moratorium per Resolutions duly adopted by the Parish Council.

BE IT FURTHER ORDAINED that this Ordinance shall be effective immediately upon adoption and remain in effect through December 2, 2005.

BE IT FURTHER ORDAINED that the moratorium herein imposed may be vacated, in whole or in part, by Resolution of this governing body pursuant to Chapter 5, Article II, Section 5-056.00 of the Parish Code of Ordinances.

REPEAL: All Ordinances or parts of Ordinances in conflict herewith are hereby repealed.

SEVERABILITY: If any provision of this Ordinance shall be held to be invalid, such invalidity shall not affect other provisions herein which can be given effect without the invalid provision and to this end the provisions of this Ordinance are hereby declared to be severable.

Ord. 3076

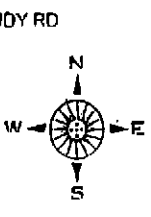

43

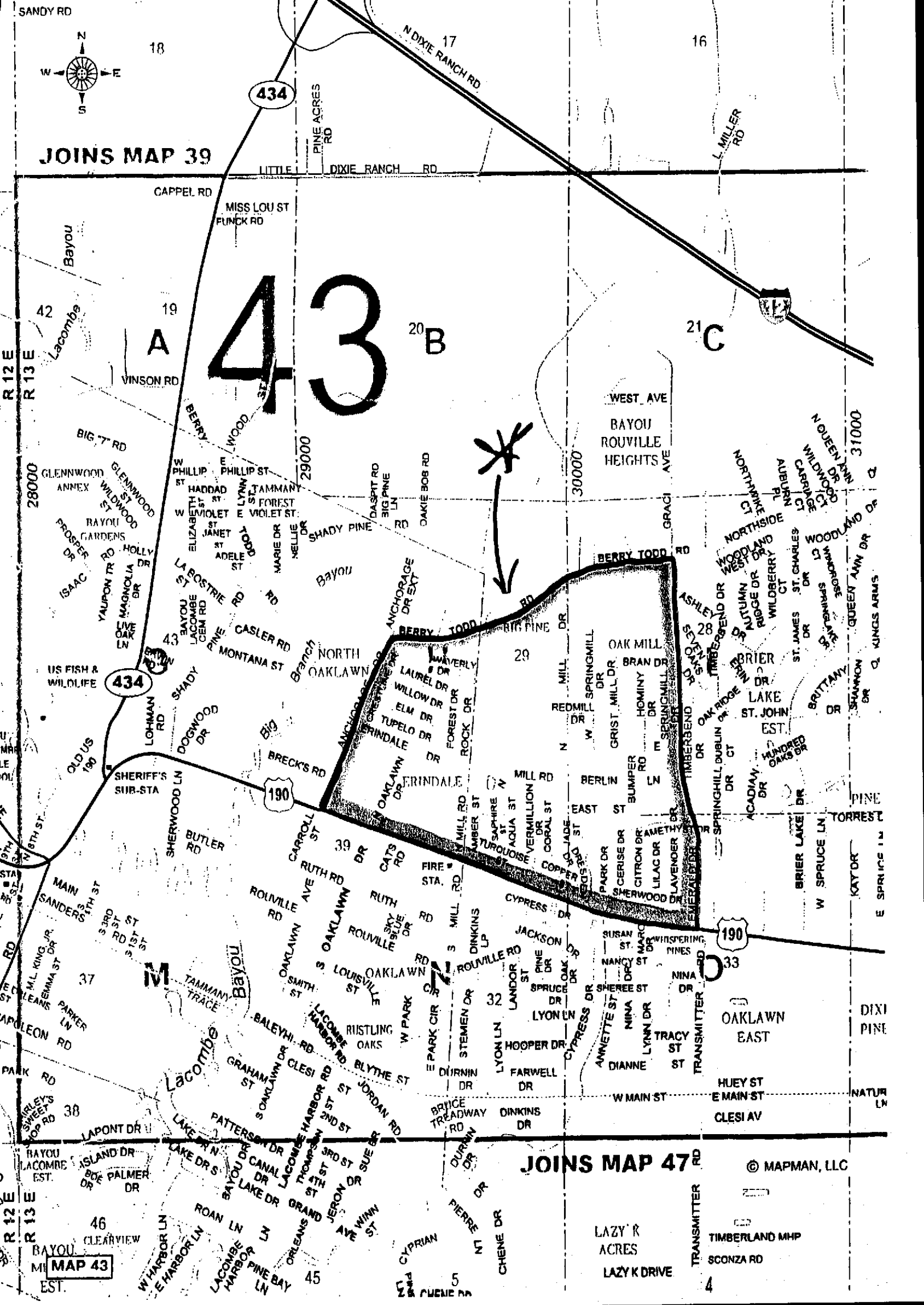

JOINS MAP 47 © MAPMAN, LLC

LAZY R ACRES
LAZY K DRIVE

TRANSMITTER
TIMBERLAND MHP
SCONZA RD

MAP 43