

ST. TAMMANY PARISH COUNCIL

ORDINANCE

ORDINANCE CALENDAR NO. 3075 ORDINANCE COUNCIL SERIES NO. 05-

COUNCIL SPONSOR: Impastato/Billiot PREPARED BY: COUNCIL OFFICE

INTRODUCED BY _____ SECONDED BY _____

ON THE _____ DAY OF _____ 2005

ORDINANCE TO EXTEND FOR AN ADDITIONAL SIX (6) MONTHS THE MORATORIUM ON THE ISSUANCE OF BUILDING PERMITS FOR CONSTRUCTION OR PLACEMENT OF BUILDING STRUCTURES ON CERTAIN PROPERTIES WITHIN UNINCORPORATED ST. TAMMANY PARISH ABUTTING, IN WHOLE OR IN PART, SOULT STREET BETWEEN HIGHWAY 190 AND HIGHWAY 1088 AND WHICH USE SOULT STREET FOR THE PURPOSES OF GAINING ACCESS TO SAID PROPERTIES. (WARD 4, DISTRICTS 7 & 10)

WHEREAS, on December 2, 2004, the Parish Council adopted Ordinance C.S. No. 04-1006 to extend the six month moratorium on the issuance of building permits on certain properties within unincorporated St. Tammany Parish abutting, in whole or in part, Soult Street between Highway 190 and Highway 1088 and which use Soult Street for purposes of gaining access to said properties; and

WHEREAS, to protect and preserve the health, safety and property interests of residents from the potential hazards of a proliferation of driveways, increased traffic on a substandard roadway, and adverse effects of poor drainage and flooding by continued development of substandard lots of record on the above referenced properties, it is necessary to extend the moratorium heretofore imposed to allow sufficient time for review of existing land use, drainage infrastructure, and traffic patterns and to formulate measures to protect residents in and near the area more fully described within this ordinance.

THE PARISH OF ST. TAMMANY HEREBY ORDAINS that it extends for an additional six (6) months the moratorium on the issuance of permits for construction or placement of building structures on certain property within unincorporated St. Tammany Parish abutting, in whole or in part, Soult Street between Highway 190 and Highway 1088, Ward 4, Districts 7 and 10, described as follows:

All properties within unincorporated St. Tammany Parish which abuts, in whole or in part, Soult Street between Highway 190 and Highway 1088, and which use Soult Street for purposes of gaining access to said properties, as more fully indicated on the vicinity map attached hereto.

LESS AND EXCEPT: Those parcels of land released from the effects of this moratorium per Resolutions duly adopted by the Parish Council.

BE IT FURTHER ORDAINED that this Ordinance shall be effective immediately upon adoption and remain in effect through December 2, 2005.

BE IT FURTHER ORDAINED that the moratorium imposed may be vacated, in whole or in part, by Resolution of this governing body pursuant to Chapter 5, Article II, Section 5-056.00 of the Parish Code of Ordinances.

REPEAL: All Ordinances or parts of Ordinances in conflict herewith are hereby repealed.

SEVERABILITY: If any provision of this Ordinance shall be held to be invalid, such invalidity shall not affect other provisions herein which can be given effect without the invalid provision and to this end the provisions of this Ordinance are hereby declared to be severable.

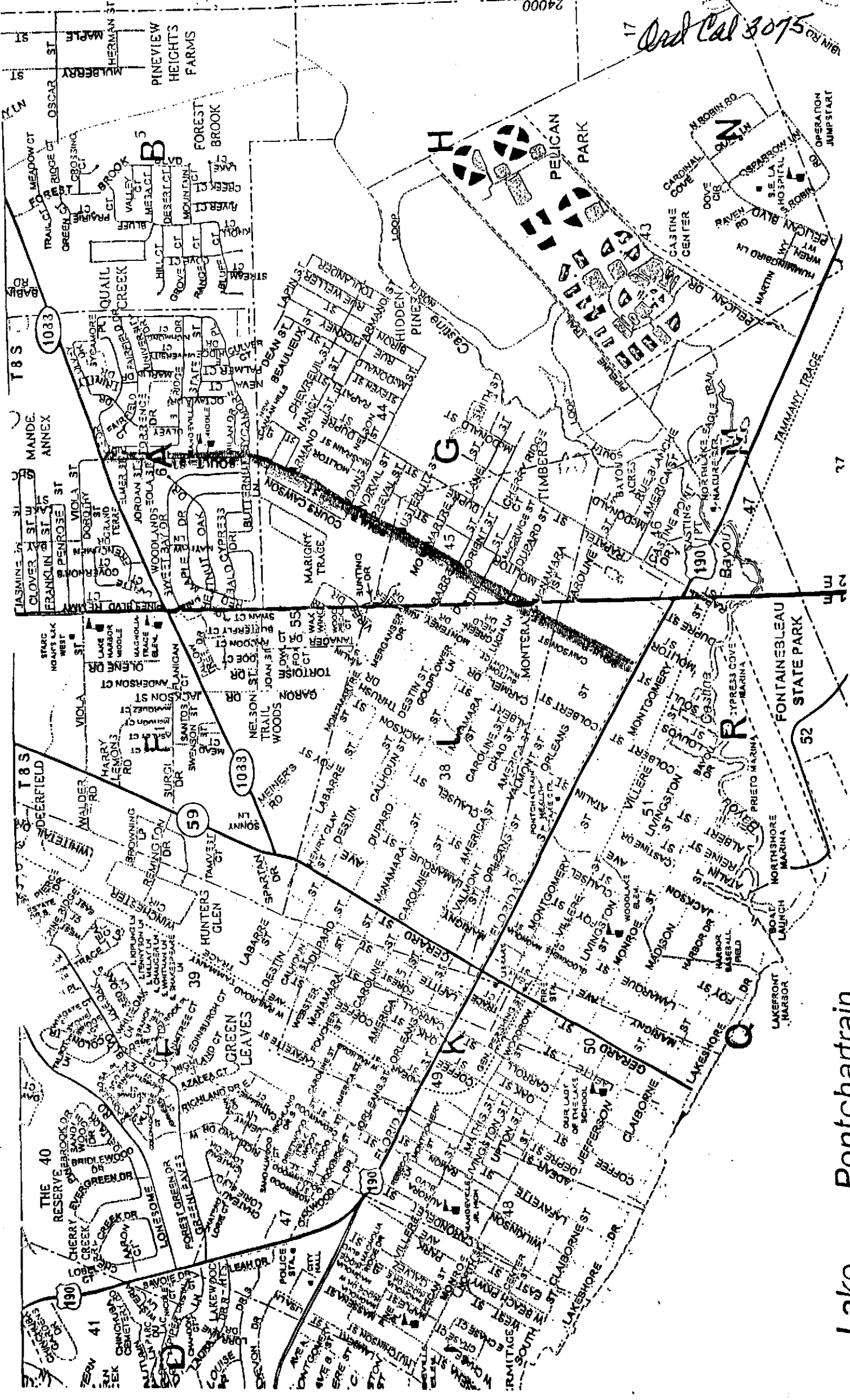

I aka Pontchartrain

Ord Cal 3075

77

52

47

1033

59

1033

190

190

41

40

39

38

37

36

35

34

33

32

31

30

29

28

27

26

25

24

24000

6500

64

17

16

15

14

13

12

11

10

9

8

7

6

5

4

3

2

1

0

0

0

0

0

0

0

0

0

0

0

0

0

0

0

0