

ST. TAMMANY PARISH COUNCIL

ORDINANCE

ORDINANCE CALENDAR NO. 3241 ORDINANCE COUNCIL SERIES NO. \_\_\_\_\_

COUNCIL SPONSOR STEFANCIK/DAVIS PROVIDED BY: PLANNING

INTRODUCED BY: MR. BAGERT SECONDED BY: MR. THOMPSON

ON THE 2<sup>ND</sup> DAY OF MARCH, 2006

An Ordinance amending the official zoning map of St. Tammany Parish, La, to reclassify a certain parcel located on the east side of LA Highway 1077, north of Brewster Road and which property comprises a total of 25.963 acres of land more or less, from its present SA (Suburban Agricultural) District to an A-2 (Suburban) District, Ward 1, District 1. (ZC06-02-013)

Whereas, the Zoning Commission of the Parish of St. Tammany after hearing in accordance with law, Case No. ZC06-02-013, has recommended to the Council of the Parish of St. Tammany, Louisiana, that the zoning classification of the above referenced area be changed from its present SA (Suburban Agricultural) District to an A-2 (Suburban) District (see Exhibit "A") for complete boundaries.

Whereas, the St. Tammany Parish Council has held its public hearing in accordance with law:

Whereas, the St. Tammany Parish Council has found it necessary for the purpose of protecting the public health, safety and general welfare, to designate the above described property as A-2 (Suburban) District.

THE PARISH OF ST. TAMMANY HEREBY ORDAINS, in regular session convened that:

SECTION I: The zoning classification of the above described property is hereby changed from its present SA (Suburban Agricultural) District to a A-2 (Suburban) District.

SECTION II: The official zoning map of the Parish of St. Tammany shall be and is hereby amended to incorporate the zoning reclassification specified in Section I hereof.

REPEAL: All Ordinances or parts of Ordinances in conflict herewith are hereby repealed.

SEVERABILITY: If any provision of this Ordinance shall be held to be invalid, such invalidity shall not affect other provisions herein which can be given effect without the invalid provision and to this end the provisions of this Ordinance are hereby declared to be severable.

EFFECTIVE DATE: This Ordinance shall become effective fifteen (15) days after adoption.

MOVED FOR ADOPTION BY: \_\_\_\_\_, SECONDED BY: \_\_\_\_\_

WHEREUPON THIS ORDINANCE WAS SUBMITTED TO A VOTE AND RESULTED IN THE FOLLOWING:

YEAS:

NAYS:

ABSTAIN:

ABSENT:

## EXHIBIT "A"

ZC06-02-013

A certain parcel of land located in Section 11, T-7-S, R-10-E, St. Tammany Parish, Louisiana, more fully described as follows.

Commence at the One-Quarter corner common to Sections 11 and 14, T-7-S, R-10-E, said point being the POINT OF BEGINNING.

From the POINT OF BEGINNING run North  $89^{\circ}56'00''$  West a distance of 621.87 feet; thence North  $05^{\circ}37'16''$  West a distance of 240.00 feet; thence South  $81^{\circ}48'09''$  West a distance of 270.00 feet; thence South  $58^{\circ}47'45''$  West a distance of 201.44 feet; thence North  $24^{\circ}24'00''$  West a distance of 385.00 feet; thence North  $65^{\circ}36'00''$  East a distance of 200.06 feet; thence North  $24^{\circ}23'37''$  West a distance of 383.79 feet; thence North  $89^{\circ}28'00''$  East a distance of 814.48 feet; thence North  $24^{\circ}13'00''$  West a distance of 457.40 feet; thence North  $89^{\circ}18'00''$  East a distance of 585.10 feet; thence South  $00^{\circ}22'00''$  East a distance of 1,311.40 feet to the POINT OF BEGINNING, and containing 25.963 Acres, more or less.

**CASE NO.:** ZC06-02-013  
**PETITIONER:** Jeff Schoen  
**OWNER:** Carl & Beverly Feigel  
**REQUESTED CHANGE:** From SA (Suburban Agricultural) District to A-2 (Suburban) District  
**LOCATION:** Parcel located on the east side of LA Highway 1077, north of Brewster Road; S11, T7S, R10E; Ward 1, District 1  
**SIZE:** 25.963 acres

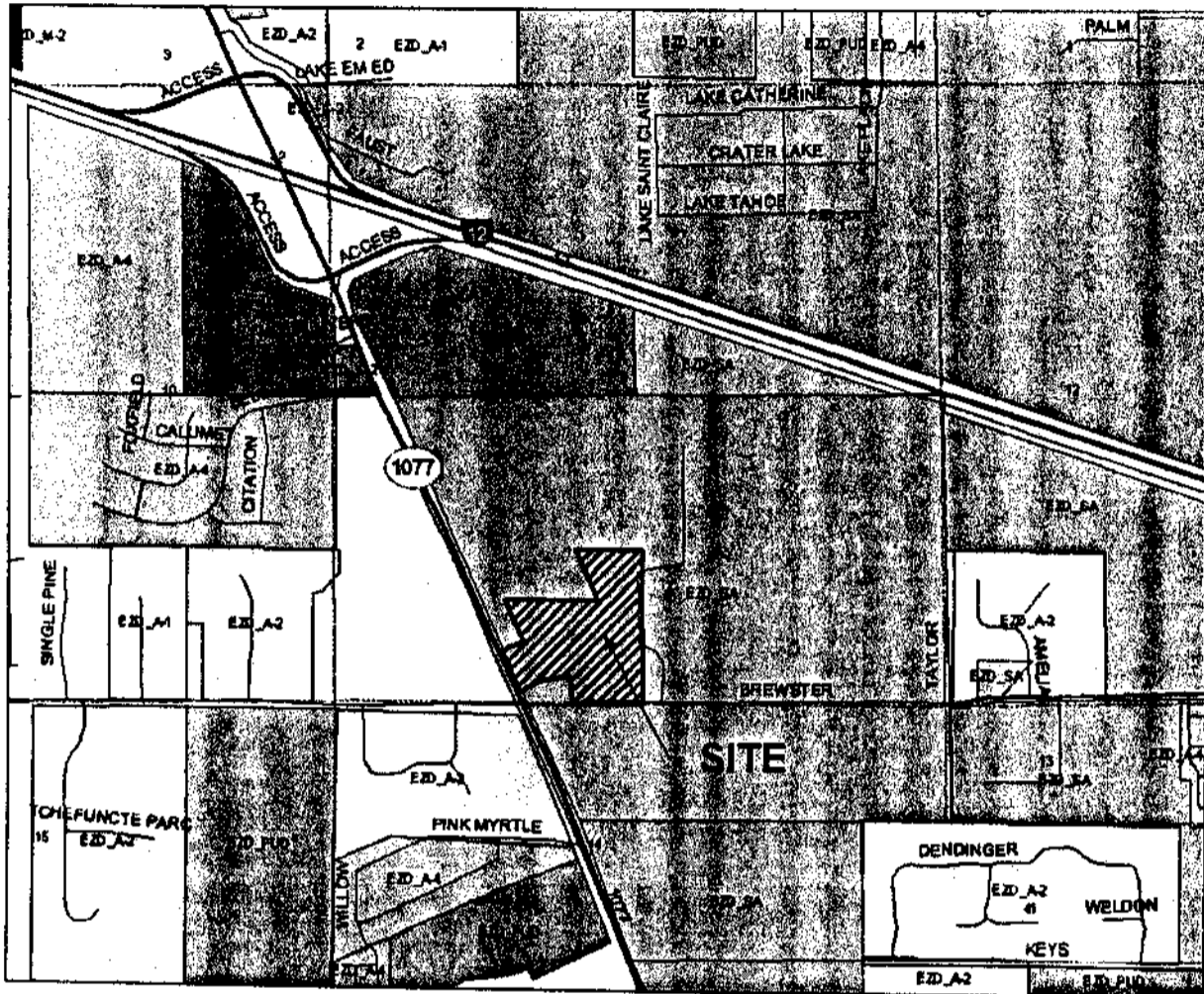

2006-02-013

N 89°18'00" E 585.10'

3241



N 24°13'00" W 457.40'

N 89°28'00" E 814.48'

S 00°22'00" E 1311.40'

25.963 ACRES

SECTION 11

N 89°56'00" W 621.87'  
BREWSTER ROAD

1/4 CORNER

SECTION 14

NOTE:

THIS PLAT PREPARED FROM SURVEYS BY OTHERS.

SKETCH OF:

25.963 ACRES  
SECTION 11, T-7-S, R-10-E  
ST. TAMMANY PARISH, LA.

PREPARED FOR:

CARL J. FEIGEL

KELLY J. McHUGH & ASSOC., INC.  
CIVIL ENGINEERS & LAND SURVEYORS  
845 GALVEZ ST., MANDEVILLE, LA. 626-5611

SCALE: 1"=200'

DATE: 12-13-2005

DRAWN: R.F.D.

JOB NO.:

REVISED:

TURNPIKE SUBD. PH. 1  
LOT 4  
N 24°23'37" W 383.79'  
N 65°36'00" E  
200.06'  
LOT 5-A  
N 24°24'00" W 385.00'  
LA. HWY. 1077  
(TURNPIKE ROAD)

LOT 6  
LOT 7  
201.44'  
S 58°47'45" W  
LOT 8  
S 81°48'09" W  
270.00'  
N 05°37'16" W  
240.00'  
NOT A PART