

ST. TAMMANY PARISH COUNCIL

RESOLUTION

RESOLUTION COUNCIL SERIES NO. C-1819

COUNCIL SPONSOR: STEFANCIK/DAVIS PROVIDED BY: PLANNING

RESOLUTION STATING THE ST. TAMMANY PARISH COUNCIL'S ENDORSEMENT OF OFFICE DEPOT, INC., FOR PARTICIPATION IN THE BENEFITS OF THE LOUISIANA ENTERPRISE ZONE PROGRAM.

WHEREAS, in accordance with the Louisiana Enterprise Zone Act 901 of 1981, Act 337 of 1982, Act 433 of 1987, Act 1024 of 1992, Act 581 of 1995, Act 624 of 1997, Act 647 of 1997, and Act 977 of 1999; and

WHEREAS, this business is located within Census Tract 411.03, Block Group 2, which is not a designated Enterprise Zone or within the boundaries of an Economic Development Zone and;

WHEREAS, in accordance with the Louisiana Enterprise Zone Program requirements the St. Tammany Parish Council agrees:

1. To participate in the Enterprise Zone Program.
2. To assist the Department in evaluating progress made in any Enterprise Zone within its jurisdiction.

THE PARISH OF ST. TAMMANY HEREBY RESOLVES that the Parish Council endorses Office Depot, Inc. - #EZ#061540-0 for the following property, located in Council District 11 of St. Tammany Parish and located at 127 Northshore Square Blvd., Slidell, LA 70460, for participation in the Louisiana Enterprise Zone Program.

BE IT FURTHER RESOLVED that all resolutions or parts thereof in conflict herewith are hereby repealed.

THIS RESOLUTION HAVING BEEN SUBMITTED TO A VOTE, THE VOTE THEREON WAS AS FOLLOWS:

MOVED FOR ADOPTION BY _____, SECONDED BY _____

YEAS:

NAYS:

ABSTAIN:

ABSENT:

THIS RESOLUTION WAS DECLARED ADOPTED ON THE _____ DAY OF _____ 2006, AT A REGULAR MEETING OF THE PARISH COUNCIL, A QUORUM OF THE MEMBERS BEING PRESENT AND VOTING.

STEVE STEFANCIK, COUNCIL CHAIRMAN

ATTEST:

DIANE HUESCHEN, COUNCIL CLERK

Enterprise Zone Site Endorsement EZ061540-0

C-1819

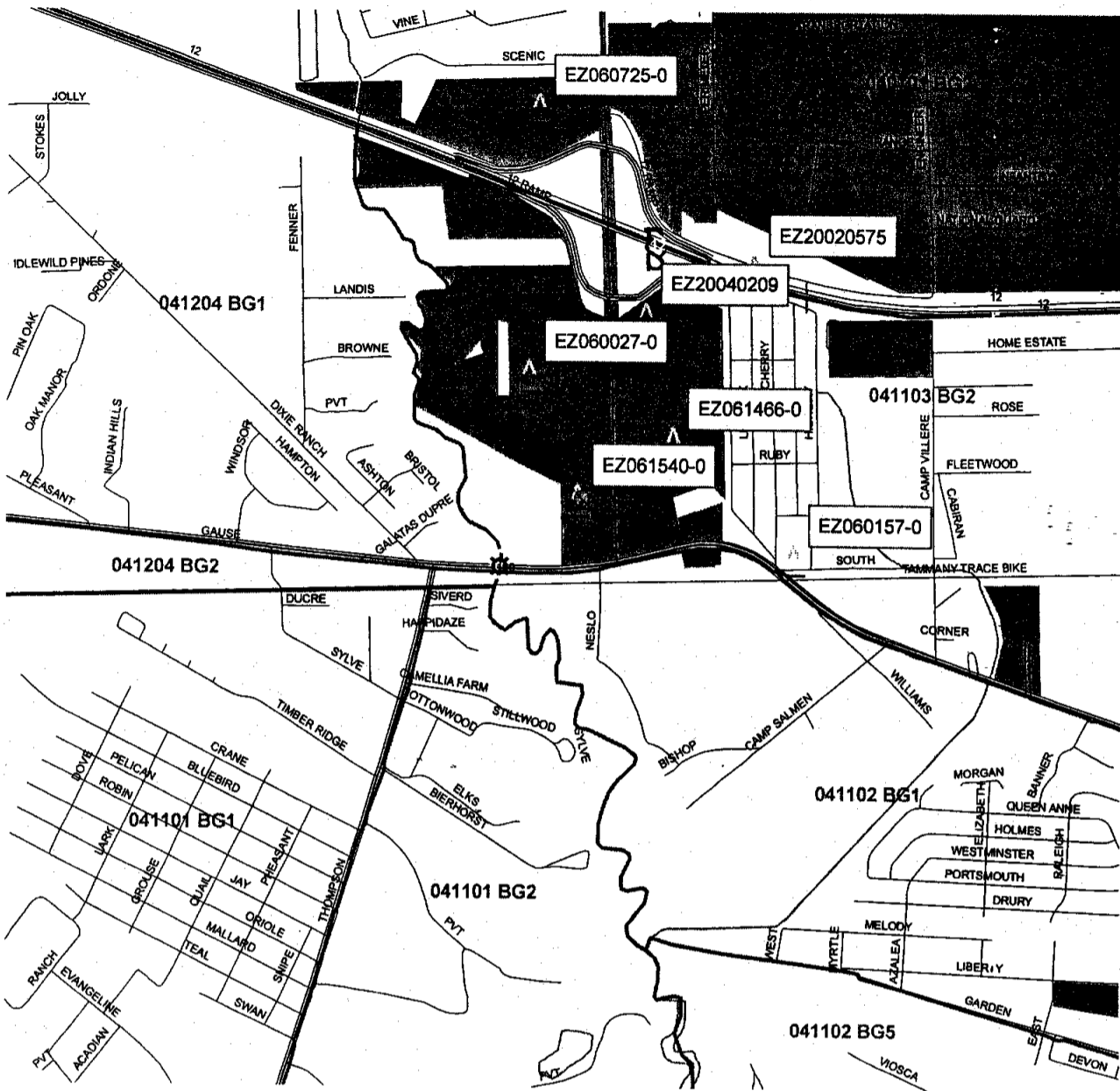

- Legend**
- Streets
 - ▲ Enterprise Zone Endorsements
 - Enterprise Zones
 - Block Groups
 - == Major Roads
 - stp-streams
- city-parish**
- Type**
- Municipally
 - Unincorporated

This map prepared by St. Tammany Parish Information Services.
This map is for planning purposes only.



State of Louisiana
DEPARTMENT OF ECONOMIC DEVELOPMENT

C-1819

KATHLEEN BABINEAUX BLANCO
Governor

June 21, 2006

MICHAEL J. OLIVIER
Secretary

Mr. Kevin Davis
St. Tammany Parish Police Jury
P.O. Box 628
Covington, LA 70434

RE: Local Endorsement Resolution
Office Depot, Inc./Project #061540-0

Dear Mr. Davis:

In accordance with Act 948 of the 1992 Louisiana Legislature, enclosed is a copy of the Advance Notification #061540-0 received from Office Depot, Inc.. Within ninety days of the receipt of this notification, your government will:

1. Pass an Endorsement Resolution supporting the project and possibly allowing the Project to receive the Local benefits of the Enterprise Zone Program
- or
2. Send written reasons why this Project is being denied endorsement
- or
3. Send a written request to delay consideration of the Advance Notification (Please give the time frame of delay requested)

If you have any questions or comments, please contact me at friedkin@la.gov or 225/342-9228.

Sincerely,

Marylyn P. Friedkin
Enterprise Zone Program

MPF/ms

cc: Office Depot, Inc.

Enclosure

Post Office Box 94185/Baton Rouge, Louisiana 70804-9185
1051 North Third Street - 70802
Phone (225) 342-9228 - Fax (225) 342-0142
www.led.louisiana.gov



C-1819

Physical Address
1051 North Third Street
Baton Rouge, LA 70802

ADVANCE NOTIFICATION

Mailing Address
P.O. Box 94185
Baton Rouge, LA 70804-9185

Visit <https://www.ledpro.led.louisiana.gov> for on-line filing
Phone: 225/342-8218 Fax: 225/342-0142

Date: _____

PLEASE TYPE

BUSINESS INFORMATION

Has an Advance Notification been filed on this project for any of the incentive programs listed below? No Yes #061540-0

If Yes, Give Assigned # _____ Federal Tax ID 59-2683954

Business Name Office Depot, Inc.

Corporate Name (if different from business name - optional)

Mailing Address1 2200 Old Germantown Road

City Delray Beach State FL

Mailing Address2

Attr: Shaun Lockhart, Dept: ACTX

Zip Code 33445

Physical Address1 (if Different from Mailing)

Physical Address2

City _____ State _____

Zip Code _____

Ext _____ Fax Number _____

Website Address officedepot.com

Is it a foreign-owned company? Yes No

State/Province _____ Country _____

NAICS Code 45321

Ownership Type:

- Corporation
- Limited Liability
- Non-Profit Organization
- Out-of-State Government
- General Partnership
- Federal Government
- Foreign Corporation
- S-Corporation
- State/Local Government
- University
- Limited Partnership
- Other

PARENT COMPANY INFORMATION

Company Name Office Depot, Inc.

Address1 (same as above)

City _____ Address2 _____ State _____

Phone Number _____ Zip Code _____

Website Address _____ Ext _____ Fax Number _____

PROJECT

Project Type: Start-up/New Additions Expansion

Project Name: (Optional) Office Depot #2158

Provide a description of this project. Hurricane restoration

RECEIVED

APR 06 2006

RESOURCE SERVICES

Project Physical Address1 127 Northshore Square Blvd. Project Physical Address1

City Slidell State LA Zip Code 70460

Phone Number _____ Ext _____ Fax Number _____

Parish St. Tammany Municipal District (if Orleans parish) A B C D E/NA

Is this project within city limits? Yes No

NAICS Code 45321

IMPORTANT NOTE: This form and fees must be received by Business Incentives before Construction, Purchasing, or Hiring begins.

(OVER)

Estimated Project Dates and Information

Beginning Date 9/3/2005

Ending Date 1/31/2007

CB-1819

Estimated Investments Costs		Estimated Number of Jobs		Estimated Payroll	
Building & Material	\$ 150,000	New	10	New	\$270,000
Machinery & Equipment	\$	Existing		Existing	\$
Labor & Engineering	\$	Transferred In-State		Transferred In-State	\$
		Transferred Out-of-State		Transferred Out-of-State	\$
		Contract		Contract	\$
		Construction		Construction	\$
Total Investment	\$150,000	Total Jobs	10	Total Payroll	\$ 270,000

Is there any gaming activity at this project site? Yes No

Are any owners of this project involved in any gaming activities elsewhere? Yes No

CONTACT INFORMATION

Contact Type (Must have legal authority to sign): Business Consultant

Prefix _____ First Name Jane MI _____ Last Name McDermott Suffix _____

Contact's Company name MAXIMUS, Inc. Title Director

Mailing Address1 8910 Route 108 Mailing Address2 Suite D
 City Columbia State MD Zip Code 21045
 Phone Number 800-274-8582 Ext 119 Fax Number 401-884-7516
 Email Address janemcdermott@maximus.com

OPTIONAL: Local Economic Development Contact
 Contact Name _____ Organization _____
 Address _____ City _____ Zip Code _____
 Phone _____ LED Contact Person _____

INCENTIVE PROGRAM(S) APPLIED

Check each program for which you wish to apply. The fee is \$100 for each of the incentive programs applied for.

- Enterprise Zone
- Quality Jobs
- Industrial Tax Exemption (Manufacturers Only)
- Restoration Tax Abatement
- Other (Please Specify) _____

Amount Due: \$100 _____

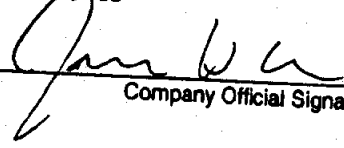
 Company Official Signature

JIM GRADY VICE PRESIDENT
 Print Official Name and Title

For Office Use Only	
Date Rec'd	4/6
Receipt #	2924
Check #	0979510
Check Amt	100.00
Initials	JDC