

ST. TAMMANY PARISH COUNCIL

RESOLUTION

RESOLUTION COUNCIL SERIES NO. C-1821

COUNCIL SPONSOR: STEFANCIK/DAVIS PROVIDED BY: PLANNING

RESOLUTION STATING THE ST. TAMMANY PARISH COUNCIL'S
ENDORSEMENT OF ROBERT LEVIS CHEVROLET, LLC, FOR
PARTICIPATION IN THE BENEFITS OF THE LOUISIANA ENTERPRISE
ZONE PROGRAM.

WHEREAS, in accordance with the Louisiana Enterprise Zone Act 901 of 1981, Act 337 of 1982, Act 433 of 1987, Act 1024 of 1992, Act 581 of 1995, Act 624 of 1997, Act 647 of 1997, and Act 977 of 1999; and

WHEREAS, this business is located within Census Tract 408.03, Block Group 5, which is not a designated Enterprise Zone or within the boundaries of an Economic Development Zone and;

WHEREAS, in accordance with the Louisiana Enterprise Zone Program requirements the St. Tammany Parish Council agrees:

1. To participate in the Enterprise Zone Program.
2. To assist the Department in evaluating progress made in any Enterprise Zone within its jurisdiction.

THE PARISH OF ST. TAMMANY HEREBY RESOLVES that the Parish Council endorses Robert Levis Chevrolet, LLC - #EZ#061590-0 for the following property, located in Council District 13 of St. Tammany Parish and located at 312 Howze Beach Road, Slidell, LA 70458, for participation in the Louisiana Enterprise Zone Program.

BE IT FURTHER RESOLVED that all resolutions or parts thereof in conflict herewith are hereby repealed.

THIS RESOLUTION HAVING BEEN SUBMITTED TO A VOTE, THE VOTE THEREON WAS AS FOLLOWS:

MOVED FOR ADOPTION BY _____, SECONDED BY _____

YEAS:

NAYS:

ABSTAIN:

ABSENT:

THIS RESOLUTION WAS DECLARED ADOPTED ON THE _____ DAY OF _____ 2006, AT A REGULAR MEETING OF THE PARISH COUNCIL, A QUORUM OF THE MEMBERS BEING PRESENT AND VOTING.

STEVE STEFANCIK, COUNCIL CHAIRMAN

ATTEST:

DIANE HUESCHEN, COUNCIL CLERK

Enterprise Zone Site Endorsement
EZ061590-0

(1-182)

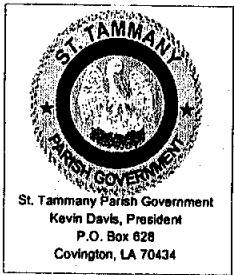
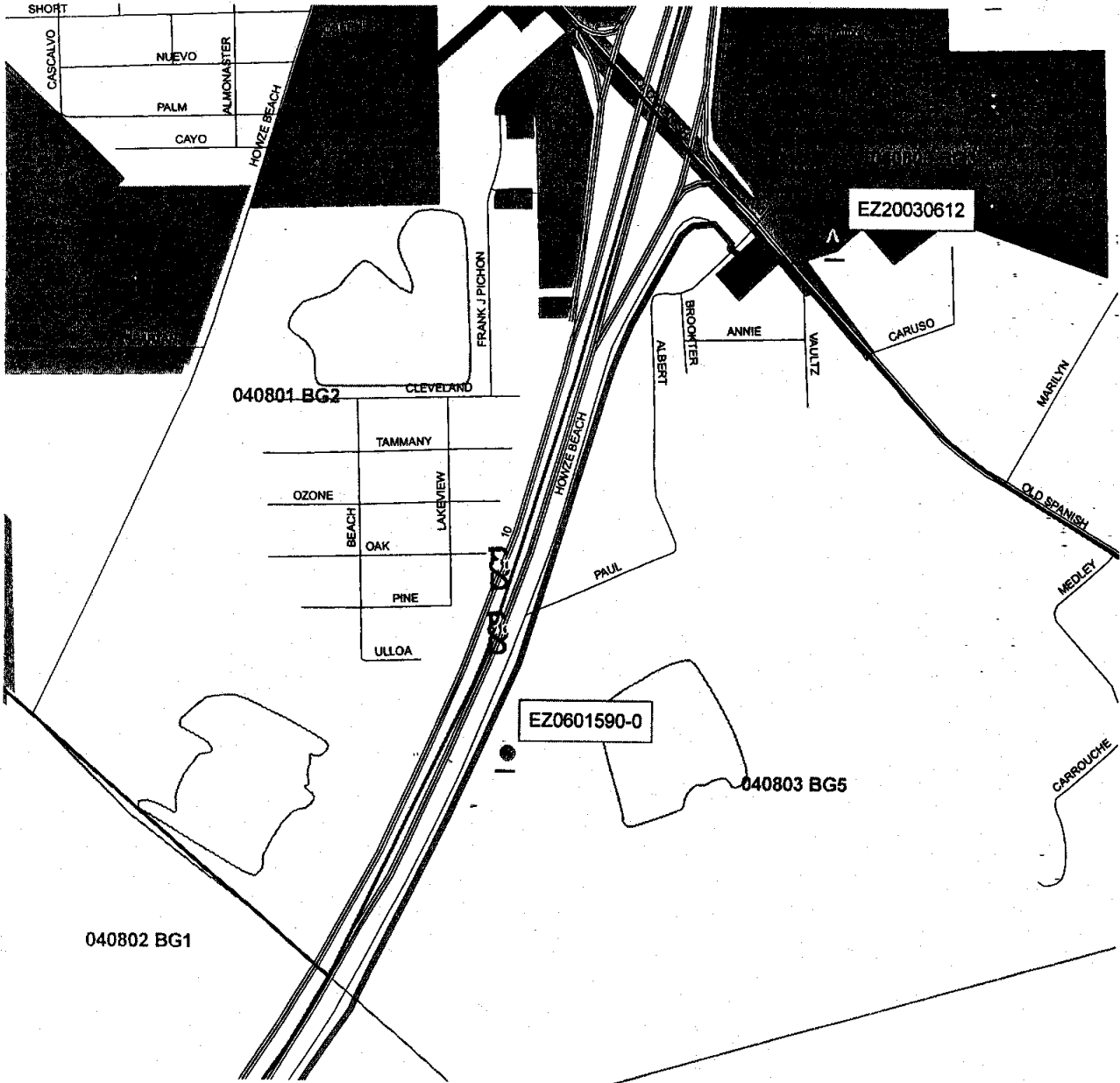

Legend

- Streets
- A Enterprise Zone Endorsements
- ▨ Enterprise_Zones
- Block Groups
- == Major Roads
- - - - - stp-streams
- city-parish**
- Type**
- Municipality
- Unincorporated

This map prepared by St. Tammany Parish Information Services.
 This map is for planning purposes only.



State of Louisiana
DEPARTMENT OF ECONOMIC DEVELOPMENT

Q-1821

KATHLEEN BABINEAUX BLANCO
Governor

June 21, 2006

MICHAEL J. OLIVIER
Secretary

Mr. Kevin Davis
St. Tammany Parish Police Jury
P.O. Box 628
Covington, LA 70434

RE: Local Endorsement Resolution
Robert Levis Chevrolet, LLC/Project #061590-0

Dear Mr. Davis:

In accordance with Act 948 of the 1992 Louisiana Legislature, enclosed is a copy of the Advance Notification #061590-0 received from Robert Levis Chevrolet, LLC. Within ninety days of the receipt of this notification, your government will:

1. Pass an Endorsement Resolution supporting the project and possibly allowing the Project to receive the Local benefits of the Enterprise Zone Program
- or
2. Send written reasons why this Project is being denied endorsement
- or
3. Send a written request to delay consideration of the Advance Notification (Please give the time frame of delay requested)

If you have any questions or comments, please contact me at friedkin@la.gov or 225/342-9228.

Sincerely,

Marylyn P. Friedkin
Enterprise Zone Program

MPF/ms

cc: Robert Levis Chevrolet, LLC

Enclosure

Post Office Box 94185/Baton Rouge, Louisiana 70804-9185
1051 North Third Street - 70802
Phone (225) 342-9228 - Fax (225) 342-0142
www.led.louisiana.gov

ADVANCE NOTIFICATION

C-1821

PLEASE TYPE

LOUISIANA OFFICE OF BUSINESS DEVELOPMENT

PLEASE TYPE

COMPANY NAME: ROBERT LEWIS CHEVROLET, LLC PARISH: Orleans PRODUCT TYPE OF BUSINESS: General Motors Dealership
 PROJECT COMPLETE PHYSICAL ADDRESS: 312 HOWZE BEAN RD Slidell, LA 70458
 NAME OF THIS PROJECT: Louis Chevrolet - Cadillac IN CITY LIMITS: YES NO NAICS CODE: 44110
 ANY GAMING ON THIS SITE? YES NO
 ARE ANY OWNERS OF THIS PROJECT INVOLVED IN ANY GAMING ACTIVITIES ELSEWHERE? YES NO
 New (or newly Product Line, etc) Short description of this project: NEW GM DEALERSHIP Expansion (Address)

ESTIMATES		
INVESTMENT	DATES	JOBS
BUILDING \$ <u>5,000,000</u>	Show BEGINNING DATE for start of CONSTRUCTION or PURCHASING or HIRING	EXISTING <u>60</u>
EQUIPMENT \$ <u>500,000</u>		NEW PERM <u>15</u>
LABOR/ENGR \$ <u>200,000</u>	BEGINNING DATE <u>8 11 2006</u>	PERM CONTRACT <u>—</u>
TOTAL \$ <u>5,700,000</u>	ENDING DATE <u>8 11 2007</u>	CONSTRUCTION <u>130</u>

STATE SENATOR: WALTER T. BOYD DISTRICT NO. 30 STATE REPRESENTATIVE: ALVIN W. BROWN DISTRICT NO. 13

NAME: ROBERT LEWIS PROJECT CONTACT LOUISIANA UNEMPLOYMENT INSURANCE # 280721-1

TITLE: President

COMPANY: Robert Lewis Chevrolet, LLC

MAILING ADDRESS: P.O. Box 1529 Slidell, LA 70459

E-MAIL ADDRESS: MRUSCH@CHEVROLET-CADILLAC.COM

PHONE: 985 443-1700 FAX: 985 443-1423

COMPANY OFFICIAL SIGNATURE: Robert Lewis
 PRINT OFFICIAL NAME AND TITLE: ROBERT LEWIS - PRESIDENT

HAS AN ADVANCE NOTIFICATION BEEN FILED ON THIS PROJECT FOR ANY OF THE INCENTIVE PROGRAMS LISTED BELOW?
 NO YES, GIVE ASSIGNED # **RECEIVED**

- INCENTIVE PROGRAM(S) APPLIED: APR 6 2006
- INDUSTRIAL TAX EXEMPTION \$100 Fee (MANUFACTURERS ONLY)
 - ENTERPRISE ZONE \$100 Fee **RESOURCE SERVICES**
 - RESTORATION TAX ABATEMENT \$100 Fee
 - QUALITY JOBS \$100 Fee
 - OTHER \$100 Fee PLEASE SPECIFY _____

OPTIONAL Local Economic Development Contact:

NAME: Brenda Reine
 ORGANIZATION: St. Tammany EDF
 ADDRESS: 21454 Koop Dr. Suite 2-E1 Mandeville, LA 70471
 PHONE: (985) 809-7874

LDDED CONTACT PERSON: _____

DEPARTMENT OF ECONOMIC DEVELOPMENT
 1051 North Third Street; Baton Rouge, LA 70802
 P. O. BOX 94185; Baton Rouge, LA 70804-9185
 (225) 342-9218 FAX: (225) 342-0142

SEE WWW.LAEMALL.COM FOR ON-LINE FILING

FOR OFFICE USE ONLY

AMOUNT DUE: _____
 CHECK NO: _____
 AMOUNT RECEIVED: 100.00
 DEPOSIT DATE: 8 11 2006
 RECEIPT NO: 19803
 INITIALS: RL ER
 APPLICATION DUE: _____
 PROJECT NO: 061590-0

IMPORTANT NOTE: This form and fee must be received by Business Incentives Division before Construction, Purchasing or Hiring begins.