

ST. TAMMANY PARISH COUNCIL

RESOLUTION

RESOLUTION COUNCIL SERIES NO. C-1825

COUNCIL SPONSOR: STEFANCIK/DAVIS PROVIDED BY: PLANNING

RESOLUTION STATING THE ST. TAMMANY PARISH COUNCIL'S ENDORSEMENT OF COPELAND'S OF NEW ORLEANS, INC., FOR PARTICIPATION IN THE BENEFITS OF THE LOUISIANA ENTERPRISE ZONE PROGRAM.

WHEREAS, in accordance with the Louisiana Enterprise Zone Act 901 of 1981, Act 337 of 1982, Act 433 of 1987, Act 1024 of 1992, Act 581 of 1995, Act 624 of 1997, Act 647 of 1997, and Act 977 of 1999; and

WHEREAS, this business is located within Census Tract 410.02, Block Group 2, which is not a designated Enterprise Zone or within the boundaries of an Economic Development Zone and;

WHEREAS, in accordance with the Louisiana Enterprise Zone Program requirements the St. Tammany Parish Council agrees:

1. To participate in the Enterprise Zone Program.
2. To assist the Department in evaluating progress made in any Enterprise Zone within its jurisdiction.

THE PARISH OF ST. TAMMANY HEREBY RESOLVES that the Parish Council endorses Copeland's of New Orleans, Inc. - #EZ#060998-0 for the following property, located in Council District 14 of St. Tammany Parish and located at 1337 Gause Blvd., Slidell, LA 70458, for participation in the Louisiana Enterprise Zone Program.

BE IT FURTHER RESOLVED that all resolutions or parts thereof in conflict herewith are hereby repealed.

THIS RESOLUTION HAVING BEEN SUBMITTED TO A VOTE, THE VOTE THEREON WAS AS FOLLOWS:

MOVED FOR ADOPTION BY _____, SECONDED BY _____

YEAS:

NAYS:

ABSTAIN:

ABSENT:

THIS RESOLUTION WAS DECLARED ADOPTED ON THE _____ DAY OF _____ 2006, AT A REGULAR MEETING OF THE PARISH COUNCIL, A QUORUM OF THE MEMBERS BEING PRESENT AND VOTING.

STEVE STEFANCIK, COUNCIL CHAIRMAN

ATTEST:

DIANE HUESCHEN, COUNCIL CLERK

Enterprise Zone Site Endorsement
EZ060998-0

C-1825

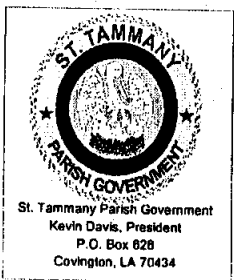
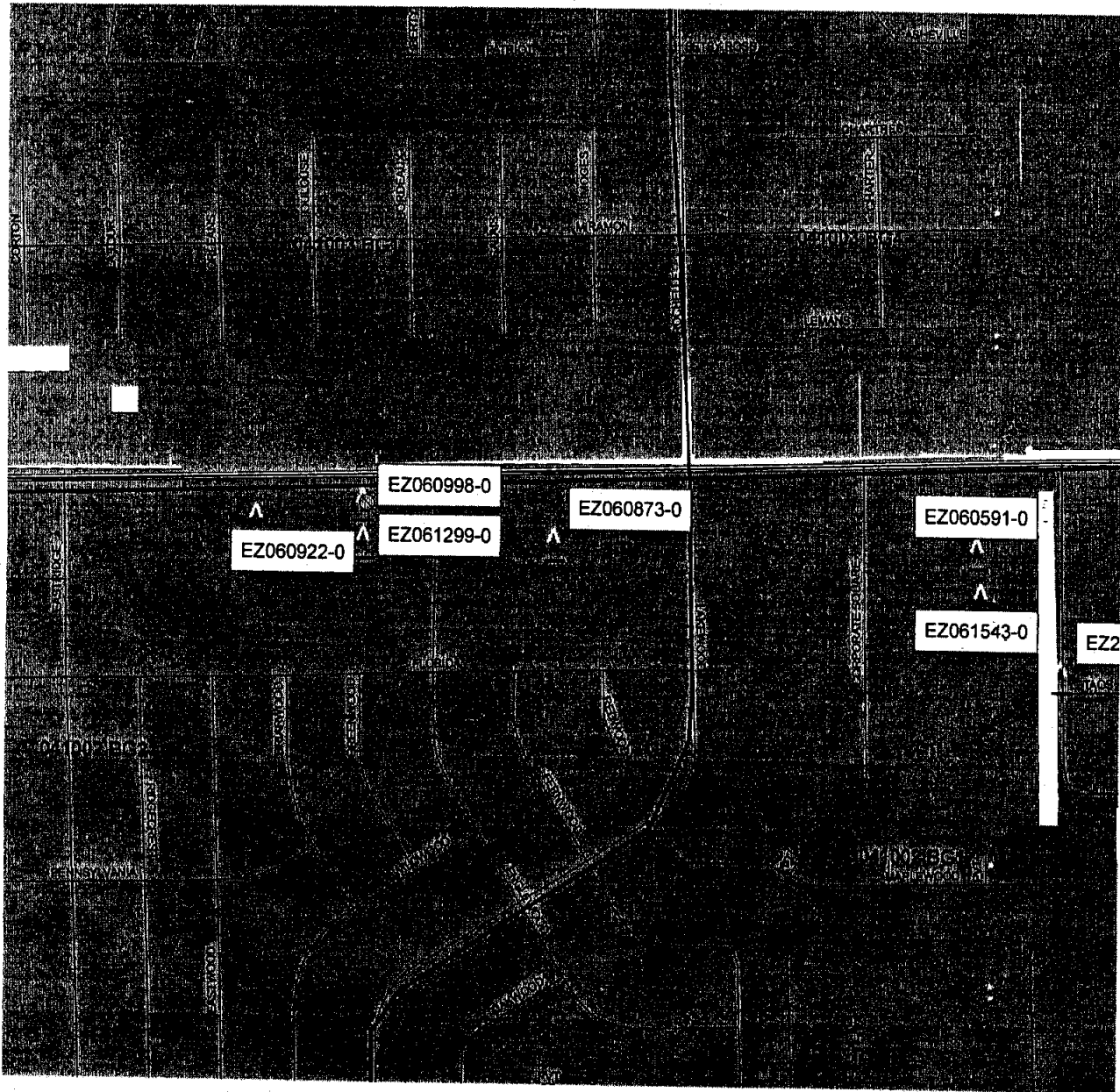

Legend

- Streets
- Enterprise Zone Endorsements
- ▨ Enterprise_Zones
- Block Groups
- ≡ Major Roads
- slp-streams

city-parish

- Municipality
- Unincorporated

■
This map prepared by St. Tammany Parish Information Services.
This map is for planning purposes only.



State of Louisiana
DEPARTMENT OF ECONOMIC DEVELOPMENT

C-1825

KATHLEEN BABINEAUX BLANCO
Governor

MICHAEL J. OLIVIER
Secretary

June 21, 2006

Mr. Kevin Davis
St. Tammany Parish Police Jury
P.O. Box 628
Covington, LA 70434

RE: Local Endorsement Resolution
Copeland's Of New Orleans, Inc./Project #060998-0

Dear Mr. Davis:

In accordance with Act 948 of the 1992 Louisiana Legislature, enclosed is a copy of the Advance Notification #060998-0 received from Copeland's Of New Orleans, Inc.. Within ninety days of the receipt of this notification, your government will:

1. Pass an Endorsement Resolution supporting the project and possibly allowing the Project to receive the Local benefits of the Enterprise Zone Program
- or
2. Send written reasons why this Project is being denied endorsement
- or
3. Send a written request to delay consideration of the Advance Notification (Please give the time frame of delay requested)

If you have any questions or comments, please contact me at friedkin@la.gov or 225/342-9228.

Sincerely,

Marylyn P. Friedkin
Enterprise Zone Program

MPF/ms

cc: Copeland's Of New Orleans, Inc.

Enclosure

Post Office Box 94185/Baton Rouge, Louisiana 70804-9185
1051 North Third Street - 70802
Phone (225) 342-9228 - Fax (225) 342-0142
www.led.louisiana.gov



0-1825

Physical Address
1051 North Third Street
Baton Rouge, LA 70802

ADVANCE NOTIFICATION

Mailing Address
P.O. Box 94185
Baton Rouge, LA 70804-9185

PLEASE TYPE

Visit <http://www.ledpro.led.louisiana.gov> for on-line filing
Phone: 225/342-9218 Fax: 225/342-0142

Date: 3/30/06

BUSINESS INFORMATION

Has an Advance Notification been filed on this project for any of the incentive programs listed below? No Yes
If Yes, Give Assigned # _____ Federal Tax ID 72-0966523 060998-0

Business Name Copeland's of New Orleans, Inc.

Corporate Name (if different from business name - optional) _____

Mailing Address1 1001 Harman Ct. S Mailing Address2 _____

City Metairie State LA Zip Code 70001

Physical Address1 (if Different from Mailing) _____

Physical Address2 _____

City _____ State _____ Zip Code _____

Phone Number (504) 830-1000 Ext _____ Fax Number (504) 832-8918

Website Address www.alcopeland.com Is it a foreign-owned company? Yes No

State/Province _____ Country _____ NAICS Code _____

- Ownership Type:
- Corporation
 - Non-Profit Organization
 - Out-of-State Government
 - Limited Liability
 - General Partnership
 - Federal Government
 - Foreign Corporation
 - S-Corporation
 - State/Local Government
 - University
 - Limited Partnership
 - Other

PARENT COMPANY INFORMATION

Company Name Alvin C Copeland

Address1 5001 False Address2 _____

City Metairie State LA Zip Code 70002

Phone Number (504) 530-1000 Ext _____ Fax Number (504) 532-8918

Website Address _____

PROJECT

Project Type: Start-up/New Additions Expansion

Project Name: (Optional) Hurricane Reopening

Provide a description of this project reopening after Hurricane Katrina

Project Physical Address1 1337 Gause Blvd Project Physical Address1 _____

City Slidell State LA Zip Code 70458

Phone Number (985) 643-0001 Ext _____ Fax Number (985) 649-1443

Parish St Tammany Municipal District (if Orleans parish) A B C D E

Is this project within city limits? Yes No NAICS Code _____

IMPORTANT NOTE: This form and fees must be received by Business Incentives before Construction, Purchasing or Hiring begins. D

(OVER)

MAR 31 2006

RESOURCE SERVICES

Estimated Project Dates and Information

Beginning Date 8/29/05 Ending Date 5/1/06

C-1825

Estimated Investments Costs		Estimated Number of Jobs		Estimated Payroll	
Building & Material	\$ 700,000	New	80	New	\$ 1,500,000
Machinery & Equipment	\$	Existing		Existing	\$
Labor & Engineering	\$	Transferred In-State		Transferred In-State	\$
		Transferred Out-of-State		Transferred Out-of-State	\$
		Contract		Contract	\$
		Construction		Construction	\$
Total Investment	\$ 700,000	Total Jobs	80	Total Payroll	\$ 1,500,000

Is there any gaming activity at this project site? Yes No
 Are any owners of this project involved in any gaming activities elsewhere? Yes No

CONTACT INFORMATION

Contact Type (Must have legal authority to sign): Business Consultant
 Prefix Mr First Name Bryan MI m Last Name White Suffix _____
 Contact's Company name Al Cepeland Investments Title CAO
 Mailing Address1 1001 Harman Ct S Mailing Address2 _____
 City Metairie State LA Zip Code 70001
 Phone Number (504) 830-1000 Ext _____ Fax Number (504) 832-8918
 Email Address W.W. alcepeland.com

OPTIONAL: Local Economic Development Contact

Contact Name _____ Organization _____
 Address _____ City _____ Zip Code _____
 Phone _____ LED Contact Person _____

INCENTIVE PROGRAM(S) APPLIED

Check each program for which you wish to apply. The fee is \$100 for each of the incentive programs applied for.

- Enterprise Zone
- Quality Jobs
- Industrial Tax Exemption (Manufacturers Only)
- Restoration Tax Abatement
- Other (Please Specify) _____

Amount Due: \$ 100



 Company Official Signature

Bryan M. White, CAO

 Print Official Name and Title

For Office Use Only	
Date Received	<u>3/31/06</u>
Receipt #	<u>19/56</u>
Check #	<u>000201339</u>
Check Amount	<u>\$100⁰⁰</u>
Initials	<u>KR</u>