

ST. TAMMANY PARISH COUNCIL

RESOLUTION

RESOLUTION COUNCIL SERIES NO. C-1770

COUNCIL SPONSOR: STEFANCIK/DAVIS PROVIDED BY: PLANNING

RESOLUTION STATING THE ST. TAMMANY PARISH COUNCIL'S ENDORSEMENT OF B & K MANAGEMENT, LLC/BAKER FAMILY HOLDING, LLC, FOR PARTICIPATION IN THE BENEFITS OF THE LOUISIANA ENTERPRISE ZONE PROGRAM.

WHEREAS, in accordance with the Louisiana Enterprise Zone Act 901 of 1981, Act 337 of 1982, Act 433 of 1987, Act 1024 of 1992, Act 581 of 1995, Act 624 of 1997, Act 647 of 1997, and Act 977 of 1999; and

WHEREAS, this business is located within Census Tract 407.07, Block Group 1, which is not a designated Enterprise Zone or within the boundaries of an Economic Development Zone and;

WHEREAS, in accordance with the Louisiana Enterprise Zone Program requirements the St. Tammany Parish Council agrees:

1. To participate in the Enterprise Zone Program.
2. To assist the Department in evaluating progress made in any Enterprise Zone within its jurisdiction.

THE PARISH OF ST. TAMMANY HEREBY RESOLVES that the Parish Council endorses **B & K Management, LLC/Baker Family Holding, LLC - #EZ#061275-0** for the following property, located in Council District 9 of St. Tammany Parish and located at 2307 Gause Blvd. East, Slidell, LA 70461, for participation in the Louisiana Enterprise Zone Program.

BE IT FURTHER RESOLVED that all resolutions or parts thereof in conflict herewith are hereby repealed.

THIS RESOLUTION HAVING BEEN SUBMITTED TO A VOTE, THE VOTE THEREON WAS AS FOLLOWS:

MOVED FOR ADOPTION BY _____, SECONDED BY _____

YEAS:

NAYS:

ABSTAIN:

ABSENT:

THIS RESOLUTION WAS DECLARED ADOPTED ON THE _____ DAY OF _____ 2006, AT A REGULAR MEETING OF THE PARISH COUNCIL, A QUORUM OF THE MEMBERS BEING PRESENT AND VOTING.

STEVE STEFANCIK, COUNCIL CHAIRMAN

ATTEST:

DIANE HUESCHEN, COUNCIL CLERK

Enterprise Zone Site Endorsement *C-1770* EZ061275-0

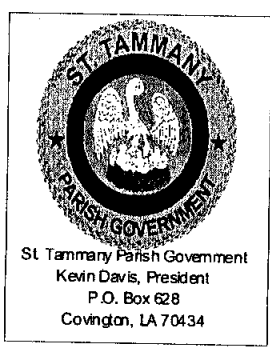
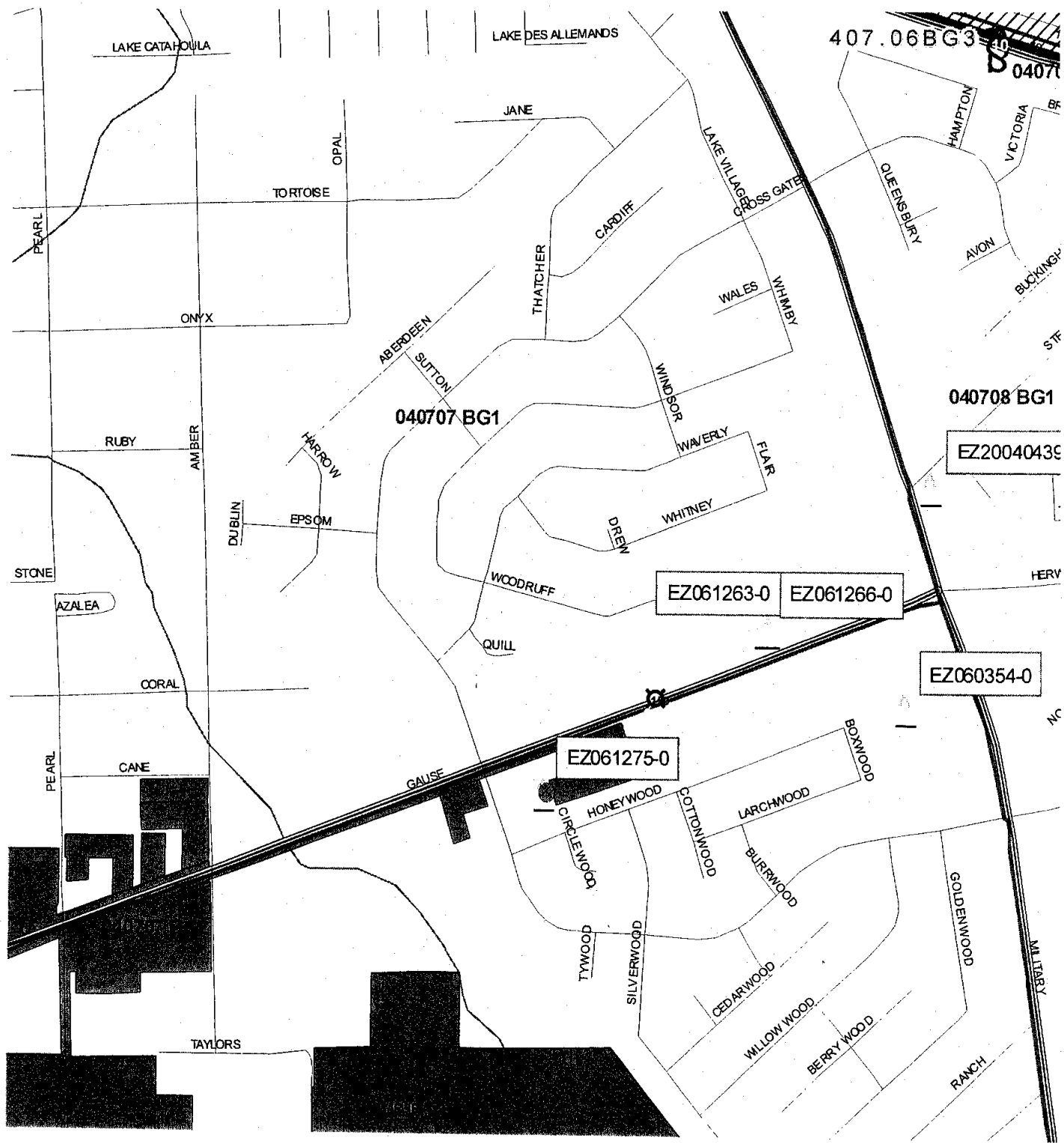

- Legend**
- Streets
 - ▲ Enterprise Zone Endorsements
 - ▨ Enterprise_Zones
 - Block Groups
 - ▬ Major Roads
 - stp-streams
- city-parish**
- Type**
- Municipality
 - Unincorporated

This map prepared by St. Tammany Parish Information Services.
This map is for planning purposes



State of Louisiana
DEPARTMENT OF ECONOMIC DEVELOPMENT

KATHLEEN BABINEAUX BLANCO
Governor

MICHAEL J. OLIVIER
Secretary

May 5, 2006



Mr. Kevin Davis
St. Tammany Parish Police Jury
P.O. Box 628
Covington, LA 70434

RE: Local Endorsement Resolution
B & K Management, LLC/Baker Family Holding, LLC/Project #061275-0

Dear Mr. Davis:

In accordance with Act 948 of the 1992 Louisiana Legislature, enclosed is a copy of the Advance Notification #061275-0 received from B & K Management, LLC/Baker Family Holding, LLC. Within ninety days of the receipt of this notification, your government will:

1. Pass an Endorsement Resolution supporting the project and possibly allowing the Project to receive the Local benefits of the Enterprise Zone Program
- or
2. Send written reasons why this Project is being denied endorsement
- or
3. Send a written request to delay consideration of the Advance Notification (Please give the time frame of delay requested)

If you have any questions or comments, please contact me at friedkin@la.gov or 225/342-9228.

Sincerely,

Marilyn P. Friedkin
Enterprise Zone Program

MPF/ms

cc: B & K Management, LLC/Baker Family Holding, LLC

Enclosure

Post Office Box 94185/Baton Rouge, Louisiana 70804-9185
1051 North Third Street - 70802
Phone (225) 342-9228 - Fax (225) 342-0142
www.led.louisiana.gov

LOUISIANA
ECONOMIC DEVELOPMENT

06/275-0

Physical Address
1051 North Third Street
Baton Rouge, LA 70802

ADVANCE NOTIFICATION

Mailing Address
P.O. Box 94185
Baton Rouge, LA 70804-9185

PLEASE TYPE

Visit <https://www.ledpro.led.louisiana.gov> for on-line filing
Phone: 225/342-9218 Fax: 225/342-0142

Date: 3/30/06

BUSINESS INFORMATION

Has an Advance Notification been filed on this project for any of the incentive programs listed below? No Yes
If Yes, Give Assigned # _____ Federal Tax ID 20-0986112

Business Name B & K Management, L.L.C./Baker Family Holding, L.L.C.

Corporate Name (if different from business name - optional) _____

Mailing Address1 2307 Gause Blvd., East Mailing Address2 _____
City Slidell State LA Zip Code 70461

Physical Address1 (If Different from Mailing) Same

Physical Address2 _____

City _____ State _____ Zip Code _____

Phone Number (985) 643-5256 Ext _____ Fax Number (985) 643-3001

Website Address _____

Is it a foreign-owned company? Yes No

State/Province Louisiana Country United States NAICS Code 531310

Ownership Type: Corporation Limited Liability General Partnership S-Corporation Limited Partnership
 Non-Profit Organization Federal Government State/Local Government
 Out-of-State Government Foreign Corporation University Other

PARENT COMPANY INFORMATION

Company Name _____

Address1 _____ Address2 _____

City _____ State _____ Zip Code _____

Phone Number _____ Ext _____ Fax Number _____

Website Address _____

PROJECT

Project Type: Start-up/New Additions Expansion

Project Name: (Optional) Post Katrina Expansion

Provide a description of this project. Post Katrina Expansion

Project Physical Address1 2307 Gause Blvd., East Project Physical Address1 _____
City Slidell State LA Zip Code 70461

Phone Number (985) 643-5256 Ext _____ Fax Number (985) 643-3001

Parish St. Tammany Municipal District (If Orleans parish) A B C D E

Is this project within city limits? Yes No NAICS Code 531310

IMPORTANT NOTE: This form and fees must be received by Business Incentives before Construction, Purchasing, or Hiring begins. RECEIVED

(OVER)

Estimated Project Dates and Information APR 03 2006

RESOURCE SERVICES

Beginning Date 9/5/05

Ending Date 12/31/06

Estimated Investment	Estimated Number of Jobs	Estimated Payroll
Building & Material \$1,000,000	New 4	New \$380,400
Machinery & Equipment \$	Existing 2	Existing \$ 71,600
Labor & Engineering \$	Transferred In-State	Transferred In-State \$
	Transferred Out-of-State	Transferred Out-of-State \$
	Contract	Contract \$
	Construction	Construction \$
Total Investment \$1,000,000	Total Jobs 6	Total Payroll \$452,000

Is there any gaming activity at this project site? Yes No

Are any owners of this project involved in any gaming activities elsewhere? Yes No

CONTACT INFORMATION

Contact Type (Must have legal authority to sign): Business Consultant
 Prefix Mr. First Name Brian MI Last Name Baker Suffix
 Contact's Company name B & K Management, L.L.C. Title Owner
 Mailing Address1 2307 Gause Blvd., East Mailing Address2
 City Slidell State LA Zip Code 70461
 Phone Number (985)643-5256 Ext Fax Number (985)643-3001
 Email Address bbaker@expstore.com

OPTIONAL: Local Economic Development Contact

Contact Name Organization
 Address City Zip Code
 Phone LED Contact Person

INCENTIVE PROGRAMS (OPTIONAL)

Check each program for which you wish to apply. The fee is \$100 for each of the incentive programs applied for.

- Enterprise Zone Quality Jobs Industrial Tax Exemption (Manufacturers Only) Restoration Tax Abatement
 Other (Please Specify)

Amount Due: \$100.00

[Signature]
 Company Official Signature

Brian Baker manager
 Print Official Name and Title

For Office Use Only	
Date Received	4/3
Receipt #	19493
Check #	015479
Check Amount	\$100.00
Initials	

from
3-30-06