

ST. TAMMANY PARISH COUNCIL

RESOLUTION

RESOLUTION COUNCIL SERIES NO. C- 1759

COUNCIL SPONSOR MR.FITZMORRIS PROVIDED BY COUNCIL OFFICE

RESOLUTION OF INTENTION TO AMEND THE BOUNDARIES OF
WATERWORKS DISTRICT NO. 2, AND DIRECTING THE COUNCIL
CHAIRMAN TO GIVE DUE NOTICE THEREOF.

WHEREAS, by Ordinance No. 428, dated February 15, 1968, the St. Tammany Parish Police Jury created Waterworks District No. 2; and

WHEREAS, the St. Tammany Parish Council has received a request from St. Tammany Waterworks District No. 2 to expand its boundaries in order to provide a larger area of service; and

WHEREAS, in order to permit Waterworks District No. 2 to expand its boundaries of service into areas not currently served by a Waterworks District, the district boundaries need to be amended to include a certain portion of unincorporated St. Tammany Parish located generally north of the Town of Abita Springs; and

WHEREAS, the Parish Council now desires to amend the boundaries of Waterworks District No. 2 as described below.

THE PARISH OF ST. TAMMANY HEREBY RESOLVES that in compliance with the provisions of St. Tammany Home Rule Charter Section 8-06 and Louisiana Revised Statute 33:3811 and other constitutional and statutory authority supplemental thereto, it is the intention of the Parish Council to amend the boundaries of Waterworks District No. 2 of St. Tammany Parish to include the following area, to-wit:

Sections 17, 18, 37, 19, and 20 in their entirety, and the triangular Northwest corner of Section 30 bounded by the Long Branch waterway and adjacent section lines, Township 6S, Range 12E, Ward 10.

The Parish Council shall meet in open and public session at its regular meeting place, the Council Chambers, 21490 Koop Drive, Mandeville, Louisiana, on the 6TH day of July, 2006, at 6:00 p.m., for the purpose of hearing any and all objections to the amendments of the boundaries of the aforesaid Waterworks District, and, after disposing of all objections, the Parish Council shall, if it determines to do so, adopt the necessary ordinance providing for same.

BE IT FURTHER RESOLVED that the Chairman of the Parish Council is hereby ordered and directed to issue a Notice of Intention of the Parish Council to amend the boundaries of the said District, which notice shall embrace substantially all things set forth in this resolution, shall be substantially in the form attached as Exhibit "A" hereto, and shall be published in accordance with the provisions of law.

THIS RESOLUTION HAVING BEEN SUBMITTED TO A VOTE, THE VOTE THEREON WAS AS FOLLOWS:

MOVED FOR ADOPTION BY _____, SECONDED BY _____

YEAS:

NAYS:

ABSTAIN:

ABSENT:

EXHIBIT "A"

NOTICE OF INTENTION TO AMEND BOUNDARIES

Pursuant to the provisions of a resolution adopted by the Council of The Parish of St. Tammany, State of Louisiana, on June 1, 2006, NOTICE IS HEREBY GIVEN of the intention of said Parish Council to amend the boundaries of Waterworks District No. 2, St. Tammany Parish, Louisiana, to include the following described area within waterworks District No. 2, to-wit:

Sections 17, 18, 37, 19, and 20 in their entirety, and the triangular Northwest corner of Section 30 bounded by the Long Branch waterway and adjacent section lines, Township 6S, Range 12E, Ward 10.

NOTICE IS HEREBY FURTHER GIVEN that the Council of the Parish of St. Tammany, State of Louisiana, will meet in open and public session at its regular meeting place, the Parish Council Chambers, 21490 Koop Drive, Mandeville, Louisiana, on Thursday, July 6, 2006 at 6:00 p.m., and will at that time hear any and all objections to amending the boundaries of said Waterworks District, and, after disposing of all objections, if it determines to do so, will adopt an ordinance ratifying and approving the amending of the boundaries of Waterworks District No. 2.

THUS DONE AND SIGNED at Mandeville, Louisiana, on this 1st day of June, 2006.

STEVE STEFANCIK, COUNCIL CHAIRMAN

ATTEST:

DIANE HUESCHEN, COUNCIL CLERK

TO BE PUBLISHED June 1, June 8, June 15, AND June 22, 2006

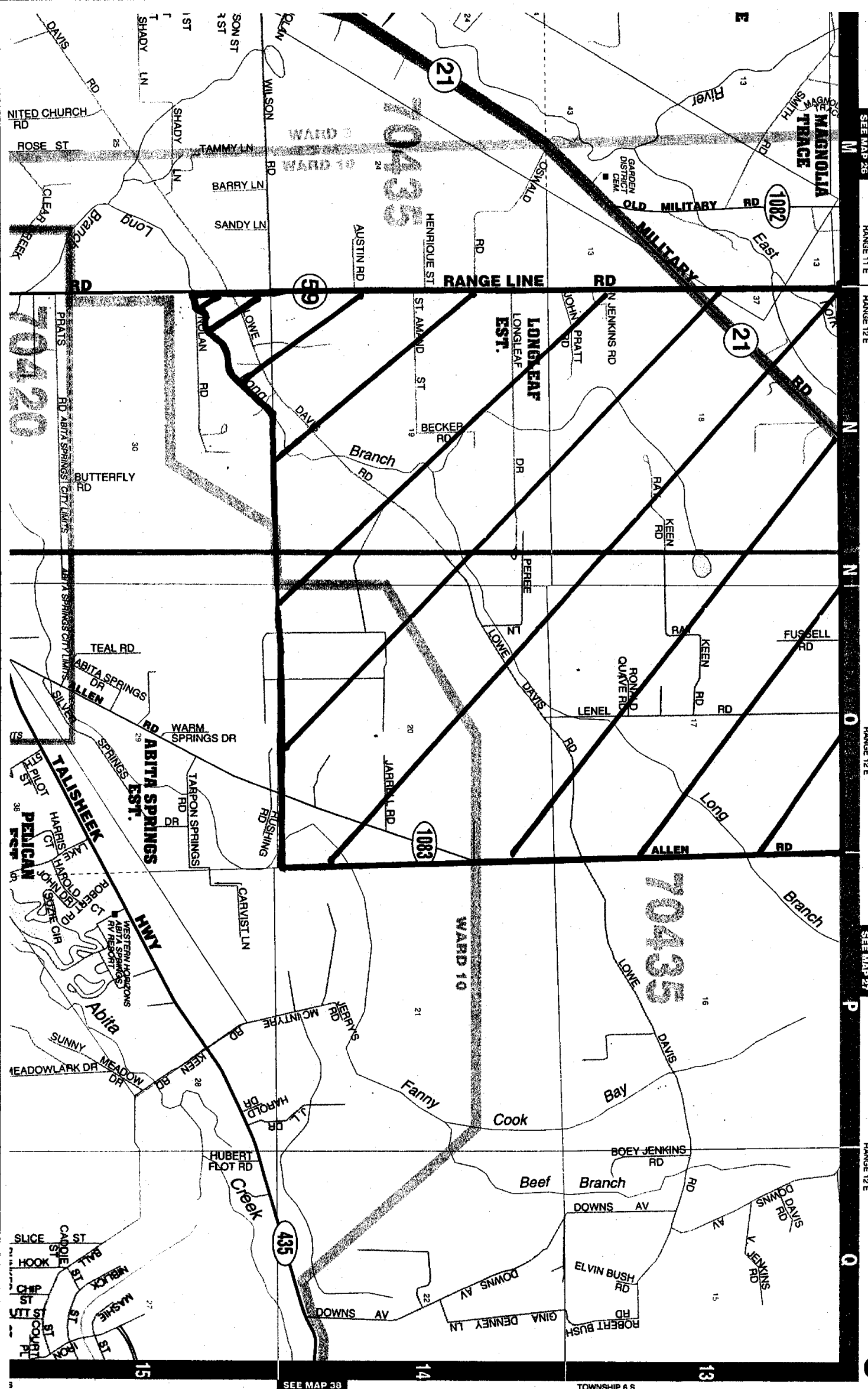

ABITA SPRINGS, HILLCREST

SEE MAP 26 RANGE 11 E RANGE 12 E

RANGE 12 E

SEE MAP 27

RANGE 12 E

SEE MAP 38

TOWNSHIP 6 S