

ST. TAMMANY PARISH COUNCIL

ORDINANCE

ORDINANCE CALENDAR NO. 3303

ORDINANCE COUNCIL SERIES NO. \_\_\_\_\_

COUNCIL SPONSOR MR. FITZMORRIS

PROVIDED BY COUNCIL OFFICE

INTRODUCED BY \_\_\_\_\_

SECONDED BY \_\_\_\_\_

ON THE \_\_\_\_\_ DAY OF \_\_\_\_\_ 2006

ORDINANCE TO AMEND THE CODE OF ORDINANCES, CHAPTER  
22, ARTICLE II, DIVISION 2, PROVIDING FOR THE AMENDMENT  
OF THE BOUNDARIES OF WATERWORKS DISTRICT NO. 2

WHEREAS, at a regular meeting, this Parish Council, acting under the authority of St. Tammany Home Rule Charter Section 8-06 and Louisiana Revised Statute 33:3811 and other Constitutional and statutory authority, adopted a resolution giving notice of intention to amend the boundaries of St. Tammany Waterworks District No. 2 (the "District"), describing the area proposed to be altered and all other matters required by law; and provided that this Parish Council would meet in open and public session at 6:00 pm on this date, at its regular meeting place, for the purpose of hearing any and all objections to the amendment of the boundaries of the District, and after disposing of all objections, if it so determines, adopt an ordinance providing for same; and

WHEREAS, said notice of intention has been duly published once a week for four consecutive weeks in the official journal of this Parish Council, the first publication being not less than thirty (30) days prior to this date; and

WHEREAS, this Parish Council did assemble at such place and time and all objections were heard to the proposed amendment of the boundaries of the District, and duly disposed.

THE PARISH OF ST. TAMMANY HEREBY ORDAINS that the Code of Ordinances, Chapter 22, Article II, Division 2, is hereby amended with regard to the boundaries of Waterworks District No. 2, as follows, to-wit:

SECTION 1: By virtue of the authority of St. Tammany Home Rule Charter Section 8-06 and Louisiana Revised Statute 33:3811 and other Constitutional and statutory authority, the boundaries of St. Tammany Waterworks District No. 2 are hereby amended to include the following described area within its boundaries, to-wit:

Sections 17, 18, 37, 19, and 20 in their entirety, and the triangular Northwest corner of Section 30 bounded by the Long Branch waterway and adjacent section lines, Township 6S, Range 12E, Ward 10

SECTION 2: The District has constituted since its creation on February 15, 1968, and shall continue to constitute, a public corporation and political subdivision of the State of Louisiana, and has had since its creation, and shall continue to have, all rights, powers and privileges granted by and conferred by the Constitution and statutes of the State of Louisiana to Waterworks district, including the authority to incur debt, issue bonds and levy taxes.

ORDINANCE CAL. NO. 3303

ORDINANCE C.S.NO. \_\_\_\_\_

PAGE 2 OF 2

REPEAL: All Ordinances or parts of Ordinances in conflict herewith are hereby repealed.

SEVERABILITY: If any provision of this Ordinance shall be held to be invalid, such invalidity shall not effect other provisions herein which can be given effect without the invalid provision and to this end the provisions of this Ordinance are hereby declared to be severable.

EFFECTIVE DATE: This Ordinance shall become effective fifteen (15) days after adoption.

MOVED FOR ADOPTION BY: \_\_\_\_\_, SECONDED BY: \_\_\_\_\_

WHEREUPON THIS ORDINANCE WAS SUBMITTED TO A VOTE AND RESULTED IN THE FOLLOWING:

YEAS:

NAYS:

ABSTAIN:

ABSENT:

THIS ORDINANCE WAS DECLARED ADOPTED AT A REGULAR MEETING OF THE PARISH COUNCIL ON THE \_\_\_\_\_ DAY OF \_\_\_\_\_ 2006 AND BECOMES ORDINANCE COUNCIL SERIES NO. 06-\_\_\_\_\_.

\_\_\_\_\_  
STEVE STEFANCIK, COUNCIL CHAIRMAN

ATTEST:

\_\_\_\_\_  
DIANE HUESCHEN, COUNCIL CLERK

\_\_\_\_\_  
KEVIN DAVIS, PARISH PRESIDENT

Published introduction: \_\_\_\_\_, 2006  
Published adoption on: \_\_\_\_\_, 2006

Delivered to Parish President: \_\_\_\_\_, 2006 @ \_\_\_\_\_  
Returned to Council Clerk: \_\_\_\_\_, 2006 @ \_\_\_\_\_

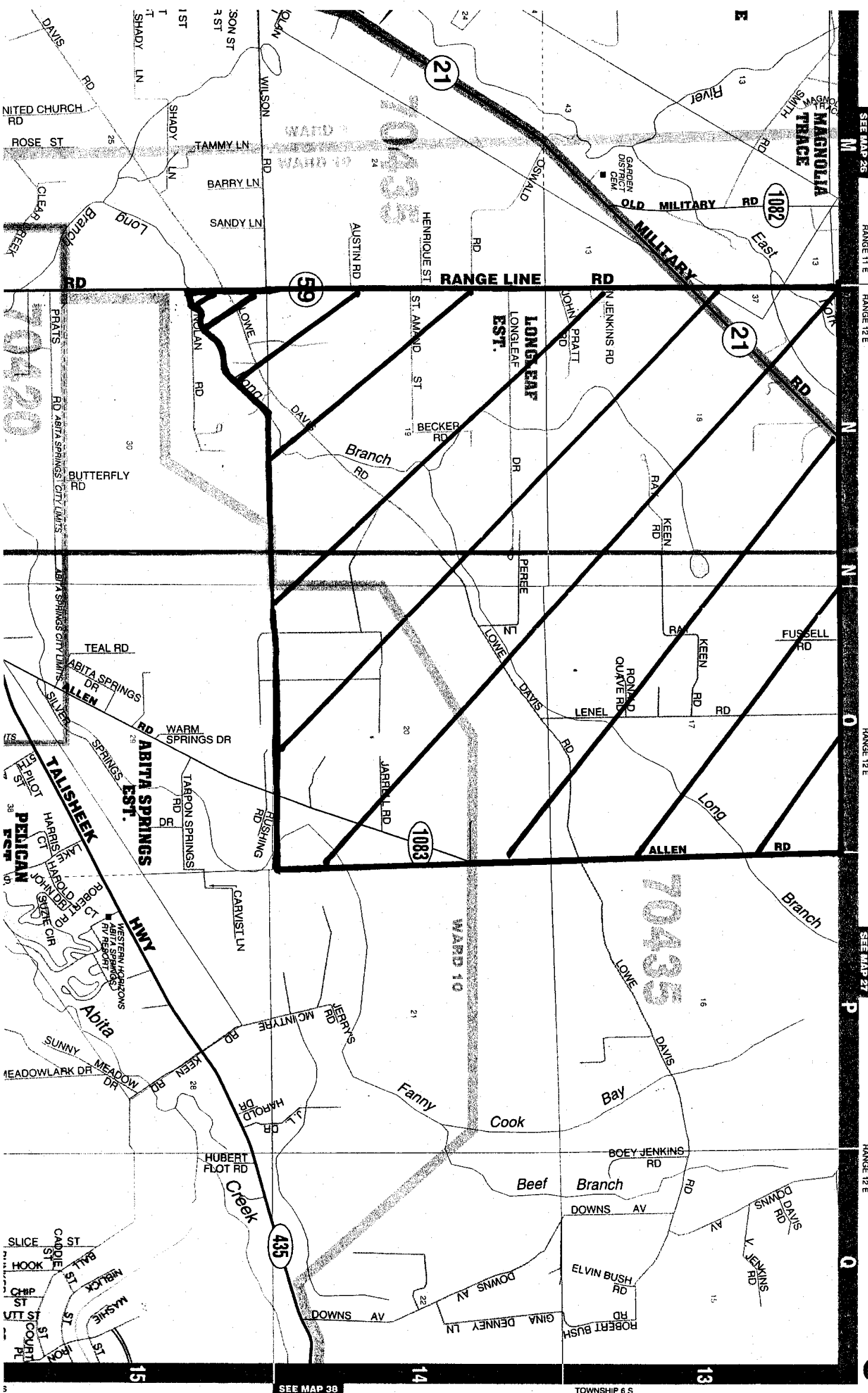

**ABITA SPRINGS, HILLCREST**



SEE MAP 26 RANGE 11 E RANGE 12 E SEE MAP 27 P RANGE 12 E

TOWNSHIP 6 S

SEE MAP 38

**WATERWORKS DISTRICT NO. 2  
PARISH OF ST. TAMMANY  
STATE OF LOUISIANA**

The following Resolution was offered by T. Wayne Jacob, and seconded by Mr. Glynn Huhn.

**RESOLUTION**

A resolution to expand the boundaries of Waterworks District No. 2 of the Parish of St. Tammany, State of Louisiana to include the following property:

**Parcel #2**

Sections 17, 18, 19, 20 & the NW corner of Section 30 along the Northern Boundary of the Long Branch Waterway up to Long Branch Road.

All as more fully shown on the attached map.

**WHEREAS**, pursuant to Chapter 8 of Title 33 of the Louisiana Revised Statutes of 1950, as amended, the St. Tammany Parish Police Jury created Waterworks District No. 2 of the Parish of St. Tammany, State of Louisiana by Ordinance No. 428 adopted February 15, 1968.

**WHEREAS**, pursuant to Ordinance No. 428 the boundaries of Waterworks District No. 2 of the Parish of St. Tammany, State of Louisiana were established as follows:

"Sections 42 and 35 in Ward 3, Township Six South, Range Eleven East; that portion of Section 36 located in Ward 3; that portion of Section 25 located in Ward 3; that portion of Section 27 in Ward 3 located east of State Highway No. 437; that portion of Section 23 in Ward 3 located east of Little Bogue Falaya River; that portion of Section 43 in Ward 3 located east of Little Bogue Falaya River; that portion of Section 24 located in Ward 3; that portion of Section 36 in Ward 10 located outside of the corporate limits of Abita Springs; that portion of Section 25 in Ward 10 located outside of the corporate limits of Abita Springs; and that portion of Section 24 located in Ward 10."

**WHEREAS**, the Waterworks District No. 2 of the Parish of St. Tammany, State of Louisiana desiring to expand the boundaries of Waterworks District No. 2 of the Parish of St. Tammany, State of Louisiana did duly advertise its meeting of July 25, 2005 to expand the boundaries of Waterworks District No. 2 of the Parish of St. Tammany, State of Louisiana. The description and map of said expansion Parcel #2, described above, was posted in said notice and advertisement of said meeting.

**WHEREAS**, pursuant to Title 8 of Chapter 33 of the Louisiana Revised Statutes of 1950, as amended, and other constitutional and statutory authority, Waterworks District No. 2 of the Parish of St. Tammany, State of Louisiana did vote at its meeting held on July 25, 2005 to expand the boundaries of Waterworks District No. 2 of the Parish of St. Tammany, State of

Louisiana to include the following property:

**Parcel #2**

Sections 17, 18, 19, 20 & the NW corner of Section 30 along the Northern Boundary of the Long Branch Waterway up to Long Branch Road.  
All as more fully shown on the attached map.

**WHEREAS**, at its meeting on July 25, 2005, Waterworks District No. 2 of the Parish of St. Tammany, State of Louisiana did further vote to request that the Council of the Parish of St. Tammany, State of Louisiana, adopt an ordinance, after due advertisement, public notice and public meeting, to expand the boundaries of Waterworks District No. 2 of the Parish of St. Tammany, State of Louisiana to include said Parcel #2 as described above.

**NOW THEREFORE BE IT RESOLVED** by the Board of Commissioners of Waterworks District No. 2 of the Parish of St. Tammany, State of Louisiana that:

**SECTION 1:** The Boundaries of Waterworks District No. 2 of the Parish of St. Tammany, State of Louisiana be expanded to include the following parcel:

**Parcel #2**

Sections 17, 18, 19, 20 & the NW corner of Section 30 along the Northern Boundary of the Long Branch Waterway up to Long Branch Road.  
All as more fully shown on the attached map.

**SECTION 2:** Waterworks District No. 2 of the Parish of St. Tammany, State of Louisiana shall submit a request to the Parish Council for the Parish of St. Tammany, State of Louisiana to adopt an ordinance, after due advertisement, public notice and public meeting, to expand the boundaries of Waterworks District No. 2 of the Parish of St. Tammany, State of Louisiana to include said Parcel #2 described as follows:

**Parcel #2**

Sections 17, 18, 19, 20 & the NW corner of Section 30 along the Northern Boundary of the Long Branch Waterway up to Long Branch Road.  
All as more fully shown on the attached map.

**SECTION 3:** Kathy Nastasi, the President of the Waterworks District No. 2 of the Parish of St. Tammany, State of Louisiana, is authorized to execute any and all documents necessary to carry out and effect the expansion of the boundaries of Waterworks District No. 2 of the Parish of St. Tammany, State of Louisiana.

**SECTION 4:** The headings of the various sections hereof are inserted for convenience of reference only and shall not control or affect the meaning or construction of any of the provisions hereof.

**SECTION 5:** All resolutions or ordinances in conflict herewith are hereby repealed to the extent of such conflict.

**SECTION 6:** This Resolution shall become effective immediately.

This Resolution having been submitted to a vote, the vote thereon was as follows:

**YEAS:** Pierre Fabre, T. Wayne Jacob, Glynn Huhn, Michael Stubbs.

**NAYS:** NONE.

**ABSENT:** Kathy Nastasi.

And the Resolution was declared adopted on this, the 05 Day of December, 2005.

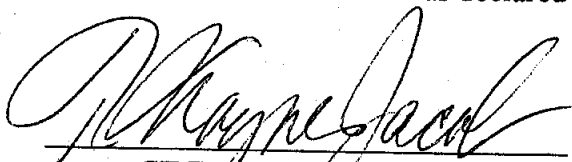
  
\_\_\_\_\_  
**SECRETARY**

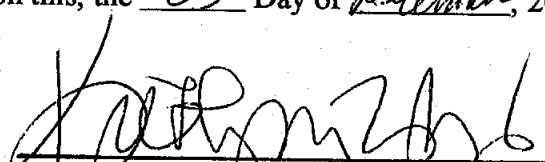
  
\_\_\_\_\_  
**PRESIDENT**

ALLIEN ROULE LA 1082

CLELAND RD

Benedict Clape

HWY LA-27

18

FUSSELL  
RD 7

177 ~~Branch~~  
~~Chapel~~

LOWE DAVIS ROAD

PARCEL #2

20

RECEIVED

NOLAN RO

WARM SPRINGS DR

AGITA SPRINGS OR 20

TEAL RD.

TOWN OF ABITA SPRINGS

TALISHEEN

FIFTH AVE.

CAYE R 20

150AK ST

~~SECRET~~ FBI CONFIDENTIAL

5 ADDITION  
5 MINUTE



---

**PONTCHARTRAIN ENGINEERS & SURVEYORS, INC.**

---

Karl J. Aucoin, PE - President  
Steven E. Tate, PE - Vice President  
Robert F. Zabbia - Secretary

February 24, 2003

A.J. Cigali, General Manager  
Water Works District No. 2  
Parish of St. Tammany  
P.O. Box 636  
Covington, LA 70434

RE: Water Works District No. 2  
Parish of St. Tammany  
Water Production Capacity Analysis  
File No. 03-13-01

Dear Mr. Cigali:

Water Works District No. 2 presently serves 1,400 customers with an average daily consumption of 330,000 g/d.

The production facilities of the water system consist of the following:

Water Well No. 2 - 1,325' depth, 600 gpm capacity  
Water Well No. 3 - 2,310' depth, 800 gpm capacity  
Ground Storage - 429,000 gallons  
Elevated Storage - 250,000 gallons  
2 High Head Service Pumps - 525 gpm @ 150 TDH  
125 KW Diesel Standby Generator with Auto Transfer Switch

The existing well capacity of the system is 1,400 gpm or 340,000 g/d based on 10 hrs/day.

---

174 SOUTH SIXTH ST. • PONCHATOULA • LA • 70454

---

(504) 386-9768

E-Mail: [ponteng@i-55.com](mailto:ponteng@i-55.com)

FAX (504) 386 2203

Mr. A.J. Cigali  
Water Works District No. 2  
Page - 2 -

The capacity of the production facilities with the two existing high head service pumps is 600,000 g/d with a 10 hour run time. The addition of a third high head service pump would increase the capacity to 840,000 gallons/day production. The existing facilities can provide potable water for approximately 3,000 to 3,500 customers with an average use of 7,000 g/c/month.

Please advise should any additional information be needed concerning this matter.

Sincerely,

PONTCHARTRAIN ENGINEERS & SURVEYORS, INC.

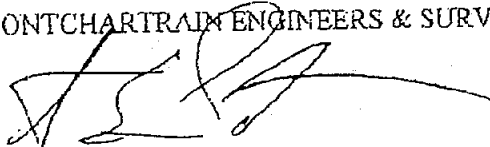

Steven E. Tate

cc: Robert F. Zabbia