

ST. TAMMANY PARISH COUNCIL

RESOLUTION

RESOLUTION COUNCIL SERIES NO. C-1652

COUNCIL SPONSOR: STEFANCIK/DAVIS PROVIDED BY: Planning

RESOLUTION STATING THE ST. TAMMANY PARISH COUNCIL'S ENDORSEMENT OF WALGREEN LOUISIANA COMPANY, INC., FOR PARTICIPATION IN THE BENEFITS OF THE LOUISIANA ENTERPRISE ZONE PROGRAM.

WHEREAS, in accordance with the Louisiana Enterprise Zone Act 901 of 1981, Act 337 of 1982, Act 433 of 1987, Act 1024 of 1992, Act 581 of 1995, Act 624 of 1997, Act 647 of 1997, and Act 977 of 1999; and

WHEREAS, this business is located within Census Tract 404.00, Block Group 2, which is not a designated Enterprise Zone or within the boundaries of an Economic Development Zone and;

WHEREAS, in accordance with the Louisiana Enterprise Zone Program requirements the St. Tammany Parish Council agrees:

1. To participate in the Enterprise Zone Program.
2. To assist the Department in evaluating progress made in any Enterprise Zone within its jurisdiction.

THE PARISH OF ST. TAMMANY HEREBY RESOLVES that the Parish Council endorses Walgreen Louisiana Company, Inc. - #EZ060071-0 for the following property, located in Council District 1 of St. Tammany Parish and located at NWC of Highway 21 & Highway 1085, Covington, LA 70433, for participation in the Louisiana Enterprise Zone Program.

BE IT FURTHER RESOLVED that all resolutions or parts thereof in conflict herewith are hereby repealed.

THIS RESOLUTION HAVING BEEN SUBMITTED TO A VOTE, THE VOTE THEREON WAS AS FOLLOWS:

MOVED FOR ADOPTION BY _____, SECONDED BY _____

YEAS:

NAYS:

ABSTAIN:

ABSENT:

THIS RESOLUTION WAS DECLARED ADOPTED ON THE _____ DAY OF _____ 2006, AT A REGULAR MEETING OF THE PARISH COUNCIL, A QUORUM OF THE MEMBERS BEING PRESENT AND VOTING.

STEVE STEFANCIK, COUNCIL CHAIRMAN

ATTEST:





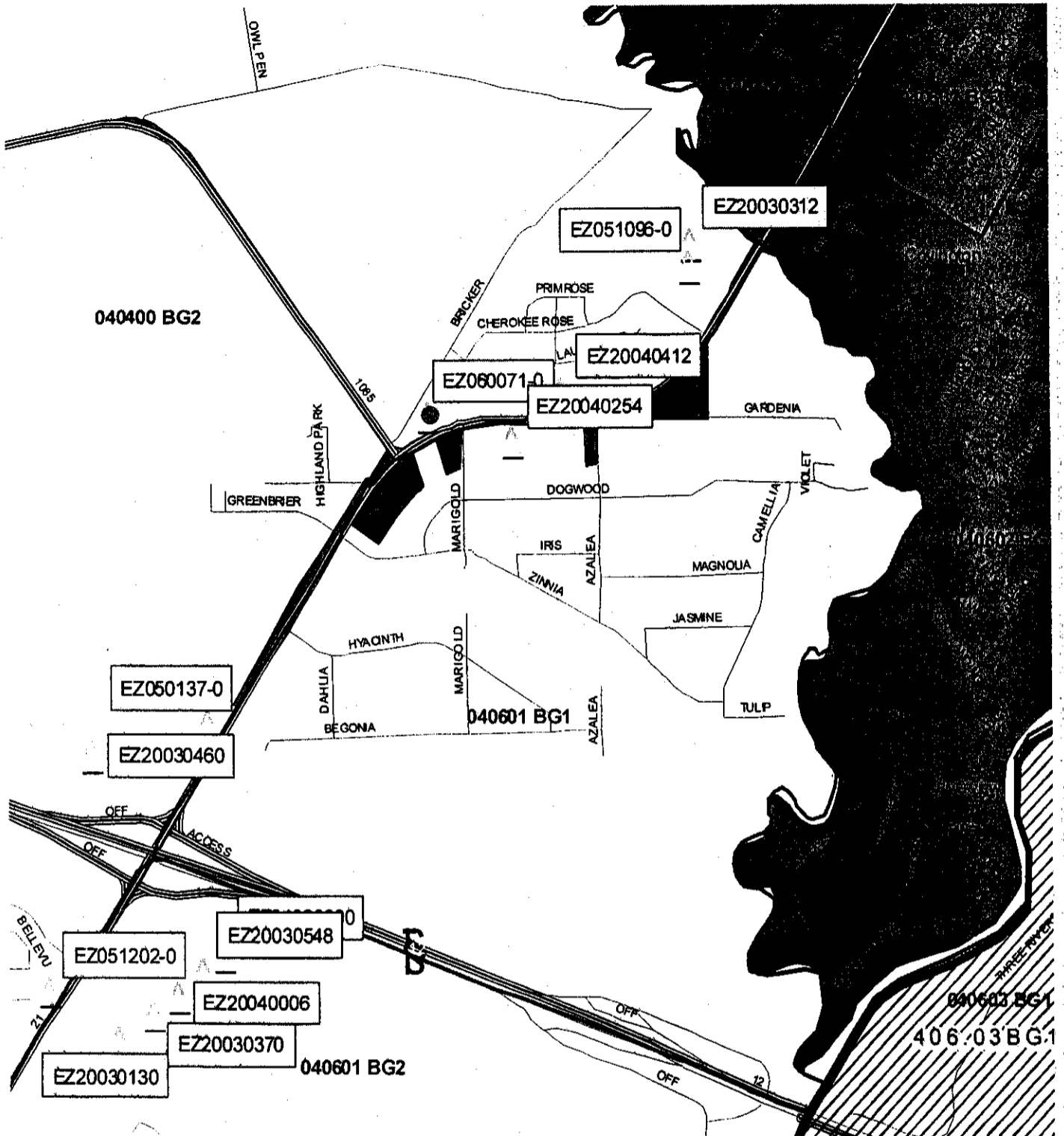

DIANE HUESCHEN, COUNCIL CLERK

Enterprise Zone Site Endorsement EZ060071-0

C-1652



Legend

-  Enterprise Zone Endorsements
-  Enterprise_Zones
-  Block Groups
-  Major Roads
-  Streets
- city-parish**
- Type**
-  Municipality
-  Unincorporated

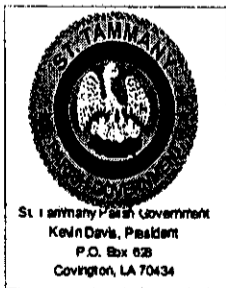

St. Tammany Parish Government
Kevin Davis, President
P.O. Box 628
Covington, LA 70434

This map prepared by St. Tammany Parish Information Services.
This map is for planning purposes



State of Louisiana
DEPARTMENT OF ECONOMIC DEVELOPMENT

C-1652

KATHLEEN BABINEAUX BLANCO
Governor

MICHAEL J. OLIVIER
Secretary

January 13, 2006

Mr. Kevin Davis
St. Tammany Parish Police Jury
P.O. Box 628
Covington, LA 70434

RE: Local Endorsement Resolution
Walgreen Louisiana Company, Inc./Project #060071-0

Dear Mr. Davis:

In accordance with Act 948 of the 1992 Louisiana Legislature, enclosed is a copy of the Advance Notification #060071-0 received from Walgreen Louisiana Company, Inc.. Within ninety days of the receipt of this notification, your government will:

1. Pass an Endorsement Resolution supporting the project and possibly allowing the Project to receive the Local benefits of the Enterprise Zone Program
- or
2. Send written reasons why this Project is being denied endorsement
- or
3. Send a written request to delay consideration of the Advance Notification (Please give the time frame of delay requested)

If you have any questions or comments, please contact me at friedkin@la.gov or 225/342-9228.

Sincerely,

Marylyn P. Friedkin
Enterprise Zone Program

MPF/ms

cc: Walgreen Louisiana Company, Inc.

Enclosure

Post Office Box 94185/Baton Rouge, Louisiana 70804-9185
1051 North Third Street - 70802
Phone (225) 342-9228 - Fax (225) 342-0142
www.led.louisiana.gov



C-1652

Physical Address
1051 North Third Street
Baton Rouge, LA 70802

ADVANCE NOTIFICATION

Mailing Address
P.O. Box 94185
Baton Rouge, LA 70804-9185

Visit https://www.ledpro.led.louisiana.gov for on-line filing
Phone: 225/342-9218 Fax: 225/342-0142

PLEASE TYPE

Date:

BUSINESS INFORMATION 060071-0

Has an Advance Notification been filed on this project for any of the incentive programs listed below? X No [] Yes
If Yes, Give Assigned # Federal Tax ID 36-1924039

Business Name Walgreen Louisiana Company, Inc.

Corporate Name (if different from business name - optional) Walgreen Company

Mailing Address1 NWC of Highway 21 & Highway 1085 Mailing Address2

City Covington State LA Zip Code 70433

Physical Address1 (If Different from Mailing)

Physical Address2

City State Zip Code

Phone Number Ext Fax Number

Website Address www.walgreens.com Is it a foreign-owned company? [] Yes [X] No

State/Province Country NAICS Code 44611

Ownership Type: [X] Corporation [] Limited Liability [] General Partnership [] S-Corporation [] Limited Partnership
[] Non-Profit Organization [] Federal Government [] State/Local Government
[] Out-of-State Government [] Foreign Corporation [] University [] Other

PARENT COMPANY INFORMATION

Company Name Walgreen Company

Address1 300 Wilmot Rd. MS #3301 Address2

City Deerfield State IL Zip Code 60015 -4614

Phone Number (847)914-5419 Ext Fax Number (847)914-5481

Website Address www.walgreens.com

PROJECT

Project Type: [X] Start-up/New [] Additions [] Expansion

Project Name: (Optional) Walgreens

Provide a description of this project. New Walgreens pharmacy and retail store

Project Physical Address1 NWC of Highway 21 & Highway 1085 Project Physical Address1

City Covington State LA Zip Code 70433

Phone Number Ext Fax Number

Parish St. Tammany Municipal District (if Orleans parish) [] A [] B [] C [] D [] E

Is this project within city limits? [X] Yes [] No NAICS Code 44611

IMPORTANT NOTE: This form and fees must be received by Business Incentives before Construction, Purchasing, or Hiring begins.

(OVER)

RESOURCE SERVICES

Estimated Project Dates and Information

Beginning Date 01/12/06 Ending Date 07/01/06

C-1652

Estimated Investments Costs		Estimated Number of Jobs		Estimated Payroll	
Building & Material	\$ 0	New	25	New	\$ 140,000
Machinery & Equipment	\$ 350,000	Existing	0	Existing	\$ 0
Labor & Engineering	\$ 0	Transferred In-State	0	Transferred In-State	\$ 0
		Transferred Out-of-State	0	Transferred Out-of-State	\$ 0
		Contract	0	Contract	\$ 0
		Construction	100	Construction	\$ 635,000
Total Investment	\$ 350,000	Total Jobs	125	Total Payroll	\$ 775,000

Is there any gaming activity at this project site? Yes No

Are any owners of this project involved in any gaming activities elsewhere? Yes No

CONTACT INFORMATION

Contact Type (Must have legal authority to sign): Business Consultant

Prefix Mrs. First Name Frances MI E Last Name Barber Suffix _____

Contact's Company name ADP Tax Credit Services, Inc. Title Associate Tax Analyst

Mailing Address1 1720 Peachtree St. NW, Suite 520 Mailing Address2 _____

City Atlanta State GA Zip Code 30309

Phone Number (404)602-1241 Ext 141 Fax Number (404)888-9584

Email Address frances_barber@adp.com

OPTIONAL: Local Economic Development Contact

Contact Name _____ Organization _____

Address _____ City _____ Zip Code _____

Phone _____ LED Contact Person _____

INCENTIVE PROGRAM(S) APPLIED

Check each program for which you wish to apply. The fee is \$100 for each of the incentive programs applied for.

- Enterprise Zone Quality Jobs Industrial Tax Exemption (Manufacturers Only) Restoration Tax Abatement
 Other (Please Specify) _____

Amount Due: \$ \$100

Company Official Signature

M. Angela [Signature]
 Notary
 Commission expires 1/30/06

Michael Hinson, Director

Print Official Name and Title

For Office Use Only	
Date Received	<u>1/12/06</u>
Receipt #	<u>18506</u>
Check #	<u>30-00100166400</u>
Check Amount	<u>\$100.00</u>
Initials	<u>SH</u>