

ST. TAMMANY PARISH COUNCIL

ORDINANCE

ORDINANCE CALENDAR NO. 3365 ORDINANCE COUNCIL SERIES NO. 06-
COUNCIL SPONSOR MR. BINDER PROVIDED BY COUNCIL OFFICE
INTRODUCED BY _____ SECONDED BY _____
ON THE _____ DAY OF _____ 2006

**ORDINANCE TO EXTEND FOR AN ADDITIONAL SIX (6) MONTHS
THE MORATORIUM ON THE ISSUANCE OF PERMITS FOR
CONSTRUCTION OR PLACEMENT OF BUILDING STRUCTURES ON
PROPERTY WITHIN A CERTAIN PORTION OF HIGHLAND PARK
SUBDIVISION (DISTRICT 12)**

WHEREAS, per Ordinance C.S. No. 03-0679, a six (6) month moratorium was imposed on the issuance of permits for construction or placement of building structures on property within a certain portion of Highland Park Subdivision. Thereafter, the Parish Council adopted subsequent Ordinances, each extending the six (6) month moratorium for said subdivision; and

WHEREAS, the moratorium is to protect and preserve the health, safety and property interests of residents from potential hazards of flood water problems and existing drainage conditions in and near the subject property; and

WHEREAS, it is necessary to extend the moratorium to allow additional time for the parish to complete evaluation of drainage conditions affecting the area more fully described within this ordinance.

THE PARISH OF ST. TAMMANY HEREBY ORDAINS that it extends for an additional six (6) months the moratorium on the issuance of permits for the construction or placement of any building structures on property within a portion of Highland Park Subdivision, District 12, as more fully described as follows:

All that property commonly known as Highland Park Subdivision, comprising any and all squares and lots of record therein, generally bounded by Orchard Street on the north, City Drive on the east, Windsor Place Subdivision on the south and Peach Tree Street to the west, less and except property within the corporate limits of the City of Slidell, and LESS AND EXCEPT property north of Lopez Street. All as indicated on the plat attached hereto.

BE IT FURTHER ORDAINED that this Ordinance shall be effective immediately upon final adoption and remain in effect through April 5, 2007.

BE IT FURTHER ORDAINED that the moratorium herein imposed may be vacated, in whole or in part, by Resolution of this governing body pursuant to Chapter 5, Article II, Section 5-056.00 of the Parish Code of Ordinances.

REPEAL: All Ordinances or parts of Ordinances in conflict herewith are hereby repealed.

SEVERABILITY: If any provision of this Ordinance shall be held to be invalid, such invalidity shall not affect other provisions herein which can be given effect without the invalid provision and to this end the provisions of this Ordinance are hereby declared to be severable.

SLIDELL

MAN HOPE

TO OLD SPANISH TRAIL

SOUTH CORPORATE LINE OF SLIDELL

1842' EAST

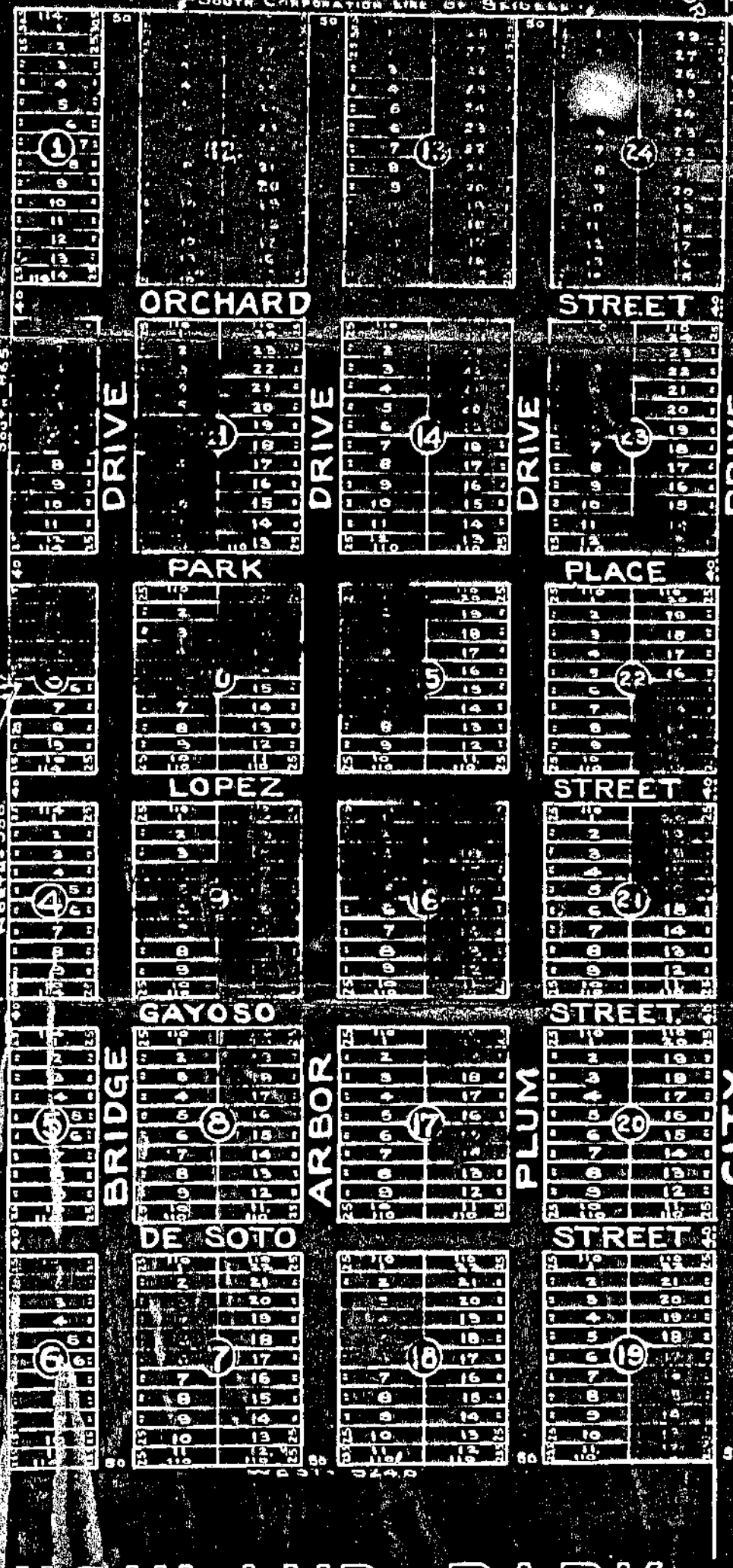

T.9.S. - R.14.E

2

3

4

5

6

7

BEACH VIEW SUBDIVISION

T.9.S.

FORMERLY SUTER

SALMON

FORMERLY SUTER

HIGHLAND PARK

SUB-DIVISION

ADJOINING CITY LIMITS OF

TOWN OF SLIDELL

ST. TAMMANY PARISH - LOUISIANA