

ST. TAMMANY PARISH COUNCIL

RESOLUTION

RESOLUTION COUNCIL SERIES NO. C-1852

COUNCIL SPONSOR: STEFANCIK/DAVIS PROVIDED BY: Planning

RESOLUTION STATING THE ST. TAMMANY PARISH COUNCIL'S ENDORSEMENT OF SLIDELL DENTAL ASSOCIATES, LLC, FOR PARTICIPATION IN THE BENEFITS OF THE LOUISIANA ENTERPRISE ZONE PROGRAM.

WHEREAS, in accordance with the Louisiana Enterprise Zone Act 901 of 1981, Act 337 of 1982, Act 433 of 1987, Act 1024 of 1992, Act 581 of 1995, Act 624 of 1997, Act 647 of 1997, and Act 977 of 1999; and

WHEREAS, this business is located within Census Tract 411.02, Block Group 2, which is not a designated Enterprise Zone or within the boundaries of an Economic Development Zone and;

WHEREAS, in accordance with the Louisiana Enterprise Zone Program requirements the St. Tammany Parish Council agrees:

1. To participate in the Enterprise Zone Program.
2. To assist the Department in evaluating progress made in any Enterprise Zone within its jurisdiction.

THE PARISH OF ST. TAMMANY HEREBY RESOLVES that the Parish Council endorses Slidell Dental Associates, LLC - #EZ#061636-0 for the following property, located in Council District 14 of St. Tammany Parish and located at 1301 Eastridge Drive, Slidell, LA 70458, for participation in the Louisiana Enterprise Zone Program.

BE IT FURTHER RESOLVED that all resolutions or parts thereof in conflict herewith are hereby repealed.

THIS RESOLUTION HAVING BEEN SUBMITTED TO A VOTE, THE VOTE THEREON WAS AS FOLLOWS:

MOVED FOR ADOPTION BY _____, SECONDED BY _____

YEAS:

NAYS:

ABSTAIN:

ABSENT:

THIS RESOLUTION WAS DECLARED ADOPTED ON THE _____ DAY OF _____ 2006, AT A REGULAR MEETING OF THE PARISH COUNCIL, A QUORUM OF THE MEMBERS BEING PRESENT AND VOTING.

STEVE STEFANCIK, COUNCIL CHAIRMAN

ATTEST:







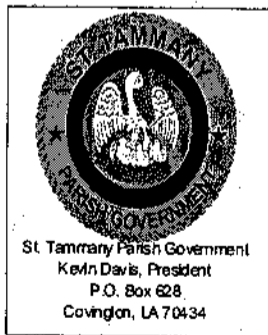
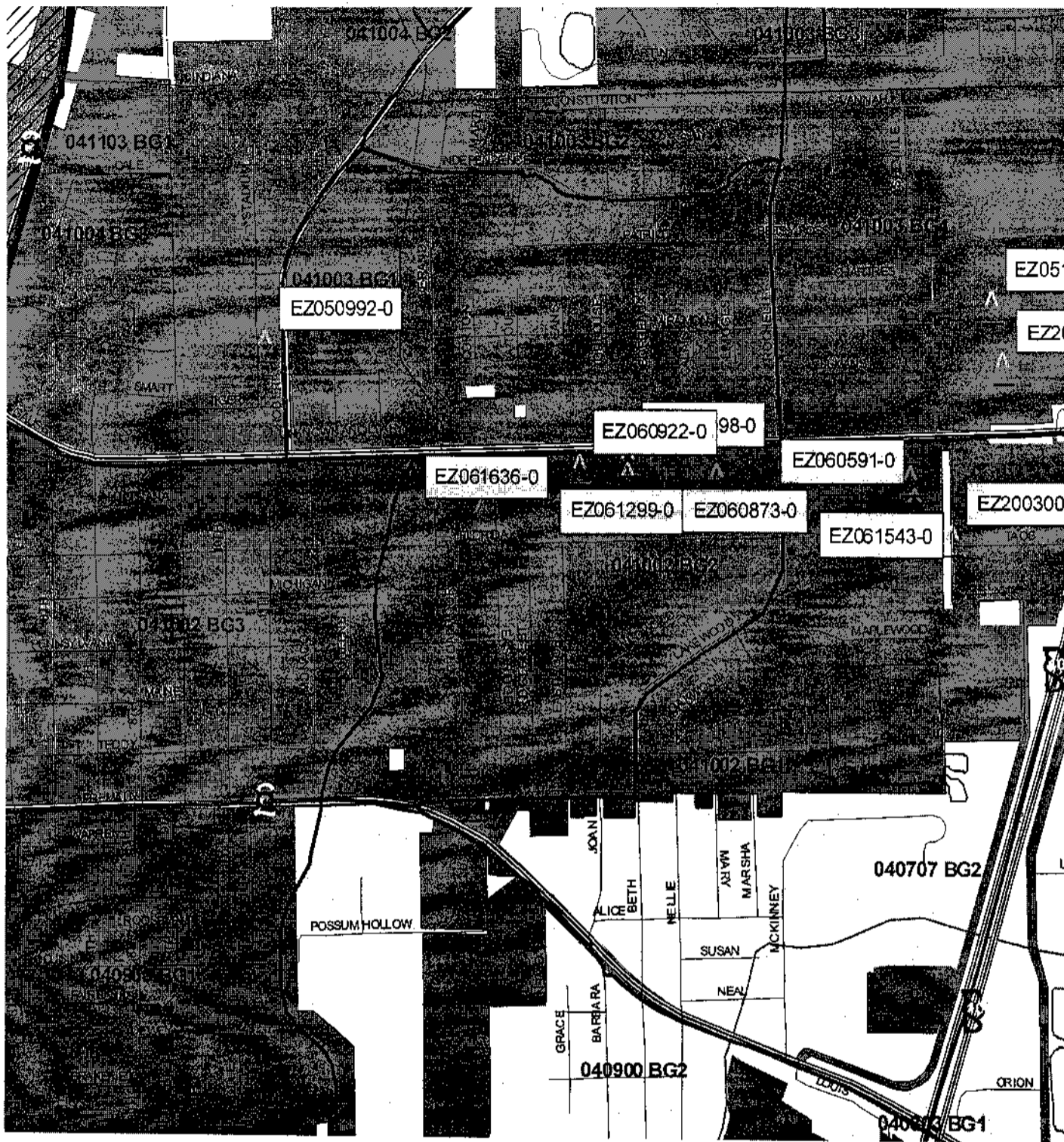

DIANE HUESCHEN, COUNCIL CLERK

Enterprise Zone Site Endorsement EZ061636-0

C-1857



Legend

-  Streets
-  Enterprise Zone Endorsements
-  Enterprise Zones
-  Block Groups
-  Major Roads
-  Streams
- city-parish**
- Type**
-  Municipality
-  Unincorporated

This map prepared by St. Tammany Parish Information Services.
This map is for planning purposes.



State of Louisiana
DEPARTMENT OF ECONOMIC DEVELOPMENT

C-1852

KATHLEEN BABINEAUX BLANCO
Governor

MICHAEL J. OLIVIER
Secretary

June 26, 2006

Mr. Kevin C. Davis
St. Tammany Parish Police Jury
P.O. Box 628
Covington, LA 70434

RE: Local Endorsement Resolution
Slidell Dental Associates, LLC/Project #061636-0

Dear Mr. Davis:

In accordance with Act 948 of the 1992 Louisiana Legislature, enclosed is a copy of the Advance Notification #061636-0 received from Slidell Dental Associates, LLC. Within ninety days of the receipt of this notification, your government will:

1. Pass an Endorsement Resolution supporting the project and possibly allowing the Project to receive the Local benefits of the Enterprise Zone Program

or

2. Send written reasons why this Project is being denied endorsement

or

3. Send a written request to delay consideration of the Advance Notification (Please give the time frame of delay requested)

If you have any questions or comments, please contact me at friedkin@la.gov or 225/342-9228.

Sincerely,

Marylyn P. Friedkin
Enterprise Zone Program

MPF/ms

cc: Slidell Dental Associates, LLC

Enclosure

Post Office Box 94185/Baton Rouge, Louisiana 70804-9185
1051 North Third Street - 70802
Phone (225) 342-9228 - Fax (225) 342-0142
www.led.louisiana.gov

Printed Date: 6/27/2006



LOUISIANA ECONOMIC DEVELOPMENT

C-1852

Physical Address
1051 North Third Street
Baton Rouge, LA 70802

Mailing Address
P.O. Box 94185
Baton Rouge, LA 70804-9185

Visit <https://www.ledpro.led.louisiana.gov> for online filing
Phone: 225/342-9218 Fax: 225/342-0142

Advance Notification #: 061636-0 (Online payment)

ADVANCE NOTIFICATION

Received Date: 5/17/2006

Business Name: Slidell Dental Associates, LLC Federal Tax ID: _____

Physical Address 1: 1301 Eastridge Drive

Physical Address 2: _____

City: Slidell State: LA Zip Code: 70458 - _____

Mailing Address 1: 305 North Oak Mailing Address 2: _____

City: Hammond State: LA Zip Code: 70401 - _____

Phone Number: (985) 643-1500 Ext: _____ Fax Number: _____

Website Address: www.ladentalcenter.com Is it a foreign-owned company? Yes No

State/Province: _____ Country: _____ NAICS Code: 621210

Ownership Type: Corporation Limited Liability General Partnership S-Corporation Limited Partnership
 Non-Profit Organization Federal Government State/Local Government
 Out-of-State Government Foreign Corporation University Other

Company Name: _____

Mailing Address 1: _____ Mailing Address 2: _____

City: _____ State: _____ Zip Code: _____

Phone Number: _____ Ext: _____ Fax Number: _____

Website Address: _____

Project Type: Start-Up/New

Project Name: Lacoste - Slidell

Provide a description of this project:

The company is opening a location in Slidell and will be hiring new employees and making equipment purchases.

Physical Address 1: 1301 Eastridge Drive Physical Address 2: _____

City: Slidell State: LA Zip Code: 70458 - _____

Parish: St Tammany Municipal District (If Orleans Parish): _____

Is this project within city limits? Yes No NAICS Code: 621210

Beginning Date: 5/18/2006

Ending Date: 5/18/2007

Building & Material		New	2	New	\$ 60,000
Machinery & Equipment	\$ 100,000	Existing	2	Existing	\$ 45,000
Labor & Engineering		Transferred In-State		Transferred In-State	
		Transferred Out-of-State		Transferred Out-of-State	
		Contract		Contract	
		Construction		Construction	
Total Investment	\$ 100,000	Total Jobs	4	Total Payroll	\$ 105,000

Is there any gaming activity at this project site?

Yes No

Are any owners of this project involved in any gaming activities elsewhere in Louisiana?

Yes No

Contact Type: Consultant

Prefix: Mr. First Name: Herbert MI: L Last Name: Carter Suffix: III

Contact's Company Name: Wegmann Dazet & Company, APC Title: Tax Consultant

Mailing Address 1: 111 Veterans Memorial Blvd. Mailing Address 2: Suite 800

City: Metairie State: LA Zip Code: 70005 -

Phone Number: (504) 837-8844 Ext: Fax Number: (504) 837-0856

E-mail Address: bcarte@wdco.biz

Check each program for which you wish to apply. The fee is \$100 for each of the incentive programs applied for.

Enterprise Zone Quality Jobs Industrial Tax Exemption (Manufacturers Only) Restoration Tax Abatement

Other (Please Specify) _____

Amount Due: \$ 100

Company Official Signature

Print Official Name and Title

Date Received	
Receipt #	
Check #	
Check Amount	
Initials	