

ST. TAMMANY PARISH COUNCIL

RESOLUTION

RESOLUTION COUNCIL SERIES NO. C-1857

COUNCIL SPONSOR: STEFANCIK/DAVIS PROVIDED BY: Planning

RESOLUTION STATING THE ST. TAMMANY PARISH COUNCIL'S ENDORSEMENT OF TUFF EQUIPMENT RENTAL, LLC, FOR PARTICIPATION IN THE BENEFITS OF THE LOUISIANA ENTERPRISE ZONE PROGRAM.

WHEREAS, in accordance with the Louisiana Enterprise Zone Act 901 of 1981, Act 337 of 1982, Act 433 of 1987, Act 1024 of 1992, Act 581 of 1995, Act 624 of 1997, Act 647 of 1997, and Act 977 of 1999; and

WHEREAS, this business is located within Census Tract 408.01, Block Group 1, which is not a designated Enterprise Zone or within the boundaries of an Economic Development Zone and;

WHEREAS, in accordance with the Louisiana Enterprise Zone Program requirements the St. Tammany Parish Council agrees:

1. To participate in the Enterprise Zone Program.
2. To assist the Department in evaluating progress made in any Enterprise Zone within its jurisdiction.

THE PARISH OF ST. TAMMANY HEREBY RESOLVES that the Parish Council endorses Tuff Equipment Rental, LLC - #EZ061937-0 for the following property, located in Council District 12 of St. Tammany Parish and located at 3300 Pontchartrain Drive, Slidell, LA, for participation in the Louisiana Enterprise Zone Program.

BE IT FURTHER RESOLVED that all resolutions or parts thereof in conflict herewith are hereby repealed.

THIS RESOLUTION HAVING BEEN SUBMITTED TO A VOTE, THE VOTE THEREON WAS AS FOLLOWS:

MOVED FOR ADOPTION BY _____, SECONDED BY _____

YEAS:

NAYS:

ABSTAIN:

ABSENT:

THIS RESOLUTION WAS DECLARED ADOPTED ON THE _____ DAY OF _____ 2006, AT A REGULAR MEETING OF THE PARISH COUNCIL, A QUORUM OF THE MEMBERS BEING PRESENT AND VOTING.

STEVE STEFANCIK, COUNCIL CHAIRMAN

ATTEST:

DIANE HUESCHEN, COUNCIL CLERK

Enterprise Zone Site Endorsement
EZ061937-0

C-1857

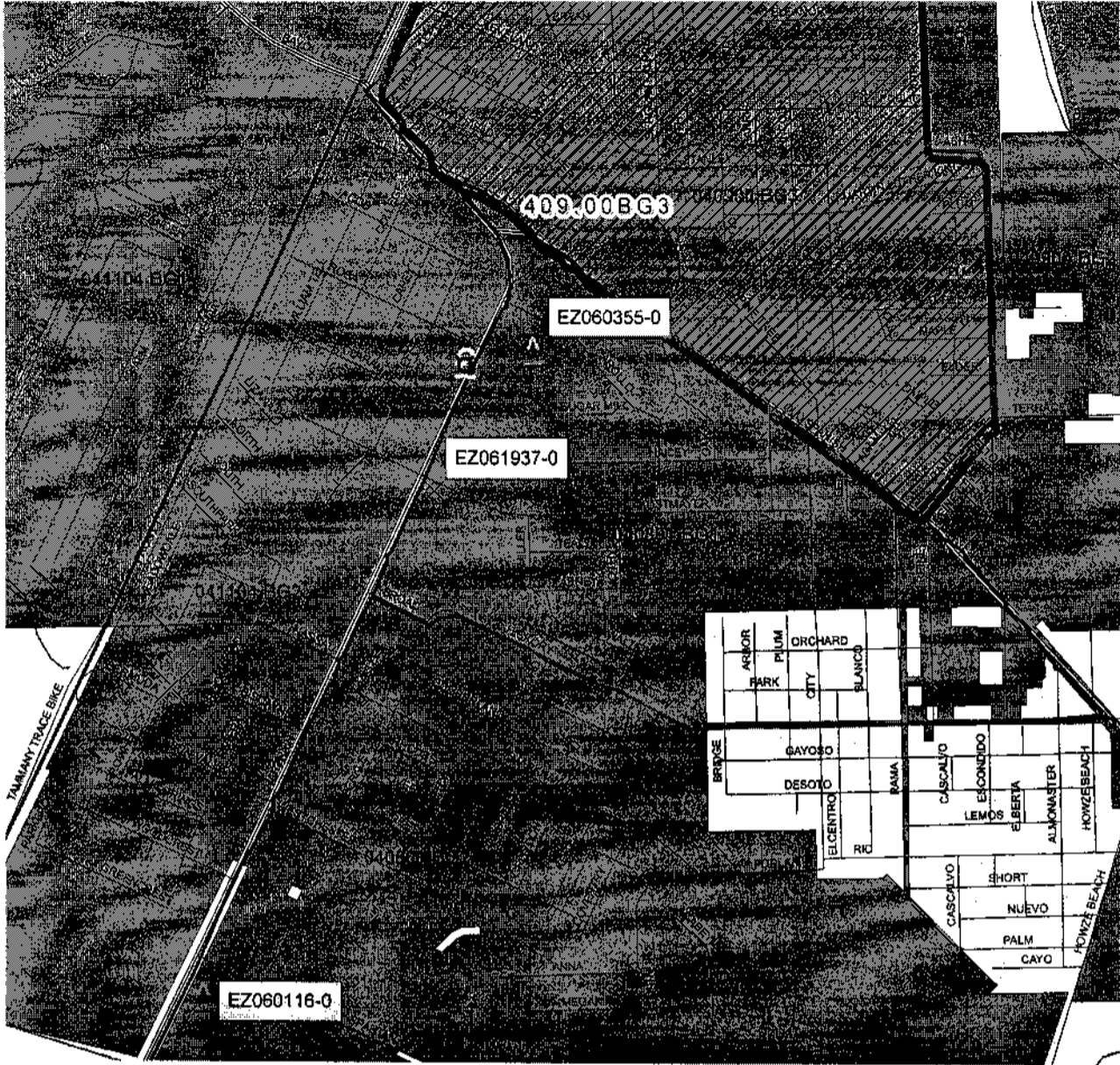

Legend

- Streets
- ▲ Enterprise Zone Endorsements
- ▨ Enterprise_Zones
- Block Groups
- ▬ Major Roads
- slp-streams
- city-parish
- Type
- Municipality
- Unincorporated

This map prepared by St. Tammany Parish Information Services.
This map is for planning purposes only.



State of Louisiana
DEPARTMENT OF ECONOMIC DEVELOPMENT

C-1857

KATHLEEN BABINEAUX BLANCO
Governor

MICHAEL J. OLIVIER
Secretary

July 28, 2006



Mr. Kevin Davis
St. Tammany Parish Police Jury
P.O. Box 628
Covington, LA 70434

RE: Local Endorsement Resolution
Tuff Equipment Rental, LLC/Project #061937-0

Dear Mr. Davis:

In accordance with Act 948 of the 1992 Louisiana Legislature, enclosed is a copy of the Advance Notification #061937-0 received from Tuff Equipment Rental, LLC. Within ninety days of the receipt of this notification, your government will:

1. Pass an Endorsement Resolution supporting the project and possibly allowing the Project to receive the Local benefits of the Enterprise Zone Program
- or
2. Send written reasons why this Project is being denied endorsement
- or
3. Send a written request to delay consideration of the Advance Notification (Please give the time frame of delay requested)

If you have any questions or comments, please contact me at friedkin@la.gov or 225/342-9228.

Sincerely,

Marilyn P. Friedkin
Enterprise Zone Program

MPF/ms

cc: Tuff Equipment Rental, LLC

Enclosure

Post Office Box 94185/Baton Rouge, Louisiana 70804-9185
1051 North Third Street - 70802
Phone (225) 342-9228 - Fax (225) 342-0142
www.led.louisiana.gov



LOUISIANA ECONOMIC DEVELOPMENT

C-1857

Physical Address
1051 North Third Street
Baton Rouge, LA 70802

Mailing Address
P.O. Box 94185
Baton Rouge, LA 70804-9185

Visit <https://www.ledpro.led.louisiana.gov> for online filing
Phone: 225/342-9218 Fax: 225/342-0142

Advance Notification #: 061937-0 (Online payment) ADVANCE NOTIFICATION Received Date: 7/10/2006

Business Name: Tuff Equipment Rental, LLC Federal Tax ID: _____

Physical Address 1: 3300 Pontchartrain Drive

Physical Address 2: _____

City: Slidell State: LA Zip Code: 70458 - _____

Mailing Address 1: 3300 Pontchartrain Drive Mailing Address 2: _____

City: Slidell State: LA Zip Code: 70458 - _____

Phone Number: (985) 643-5424 Ext: _____ Fax Number: (985) 649-0047

Website Address: www.tuffequipmentrentals.com Is it a foreign-owned company? Yes No

State/Province: _____ Country: _____ NAICS Code: 532412

Ownership Type: Corporation Limited Liability General Partnership S-Corporation Limited Partnership
 Non-Profit Organization Federal Government State/Local Government
 Out-of-State Government Foreign Corporation University Other

Company Name: _____

Mailing Address 1: _____ Mailing Address 2: _____

City: _____ State: _____ Zip Code: _____

Phone Number: _____ Ext: _____ Fax Number: _____

Website Address: _____

Project Type: Addition

Project Name: Tuff Equipment Rental

Provide a description of this project:

The company will be hiring additional employees and making some equipment purchases.

Physical Address 1: 3300 Pontchartrain Drive Physical Address 2: _____

City: Slidell State: LA Zip Code: 70458 - _____

Parish: St Tammany Municipal District (If Orleans Parish): _____

Is this project within city limits? Yes No NAICS Code: 532412

Beginning Date: 7/11/2006

Ending Date: 7/11/2007

Building & Material	\$ 50,000	New	5	New	\$ 100,000
Machinery & Equipment	\$ 25,000	Existing	32	Existing	\$ 850,000
Labor & Engineering		Transferred In-State		Transferred In-State	
		Transferred Out-of-State		Transferred Out-of-State	
		Contract		Contract	
		Construction		Construction	
Total Investment	\$ 75,000	Total Jobs	37	Total Payroll	\$ 950,000

Is there any gaming activity at this project site?

Yes No

Are any owners of this project involved in any gaming activities elsewhere in Louisiana?

Yes No

Contact Type: Consultant

Prefix: Mr. First Name: Herbert MI: L Last Name: Carter Suffix: III

Contact's Company Name: Wegmann Dazet & Company, APC Title: Tax Consultant

Mailing Address 1: 111 Veterans Memorial Blvd. Mailing Address 2: Suite 800

City: Metairie State: LA Zip Code: 70005

Phone Number: (504) 837-8844 Ext: _____ Fax Number: (504) 837-0856

E-mail Address: bccarter@wdco.biz

Check each program for which you wish to apply. The fee is \$100 for each of the incentive programs applied for.

Enterprise Zone Quality Jobs Industrial Tax Exemption (Manufacturers Only) Restoration Tax Abatement
 Other (Please Specify) _____

Amount Due: \$ 100

Company Official Signature

Print Official Name and Title

Date Received	
Receipt #	
Check #	
Check Amount	
Initials	