

ST. TAMMANY PARISH COUNCIL

RESOLUTION

RESOLUTION COUNCIL SERIES NO. C-2171

COUNCIL SPONSOR: BAGERT/DAVIS

PROVIDED BY: PLANNING

RESOLUTION STATING THE ST. TAMMANY PARISH COUNCIL'S
ENDORSEMENT OF RAYMOND E. MASKER, JR., FOR PARTICIPATION IN THE
BENEFITS OF THE LOUISIANA ENTERPRISE ZONE PROGRAM.

WHEREAS, in accordance with the Louisiana Enterprise Zone Act 901 of 1981, Act 337 of 1982, Act 433 of 1987, Act 1024 of 1992, Act 581 of 1995, Act 624 of 1997, Act 647 of 1997, and Act 977 of 1999; and

WHEREAS, this business is located within Census Tract 41104, Block Group 2, which is not a designated Enterprise Zone or within the boundaries of an Economic Development Zone and;

WHEREAS, in accordance with the Louisiana Enterprise Zone Program requirements the St. Tammany Parish Council agrees:

1. To participate in the Enterprise Zone Program.
2. To assist the Department in evaluating progress made in any Enterprise Zone within its jurisdiction.

THE PARISH OF ST. TAMMANY HEREBY RESOLVES that the Parish Council endorses Raymond E. Masker, Jr. - #EZ#070948-0 for the following property, located in Council District 12 of St. Tammany Parish and located at Highway 11, Slidell, LA 70461, for participation in the Louisiana Enterprise Zone Program.

BE IT FURTHER RESOLVED that all resolutions or parts thereof in conflict herewith are hereby repealed.

THIS RESOLUTION HAVING BEEN SUBMITTED TO A VOTE, THE VOTE THEREON WAS AS FOLLOWS:

MOVED FOR ADOPTION BY _____, SECONDED BY _____

YEAS:

NAYS:

ABSTAIN:

ABSENT:

THIS RESOLUTION WAS DECLARED ADOPTED ON THE _____ DAY OF _____ 2007, AT A REGULAR MEETING OF THE PARISH COUNCIL, A QUORUM OF THE MEMBERS BEING PRESENT AND VOTING.

BARRY BAGERT, COUNCIL CHAIRMAN

ATTEST:

DIANE HUESCHEN, COUNCIL CLERK

C-2111

Enterprise Zone Site Endorsement EZ070948-0

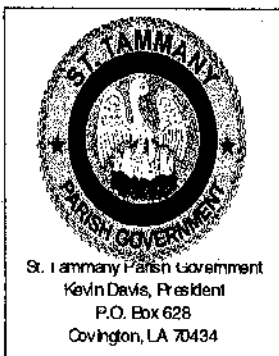
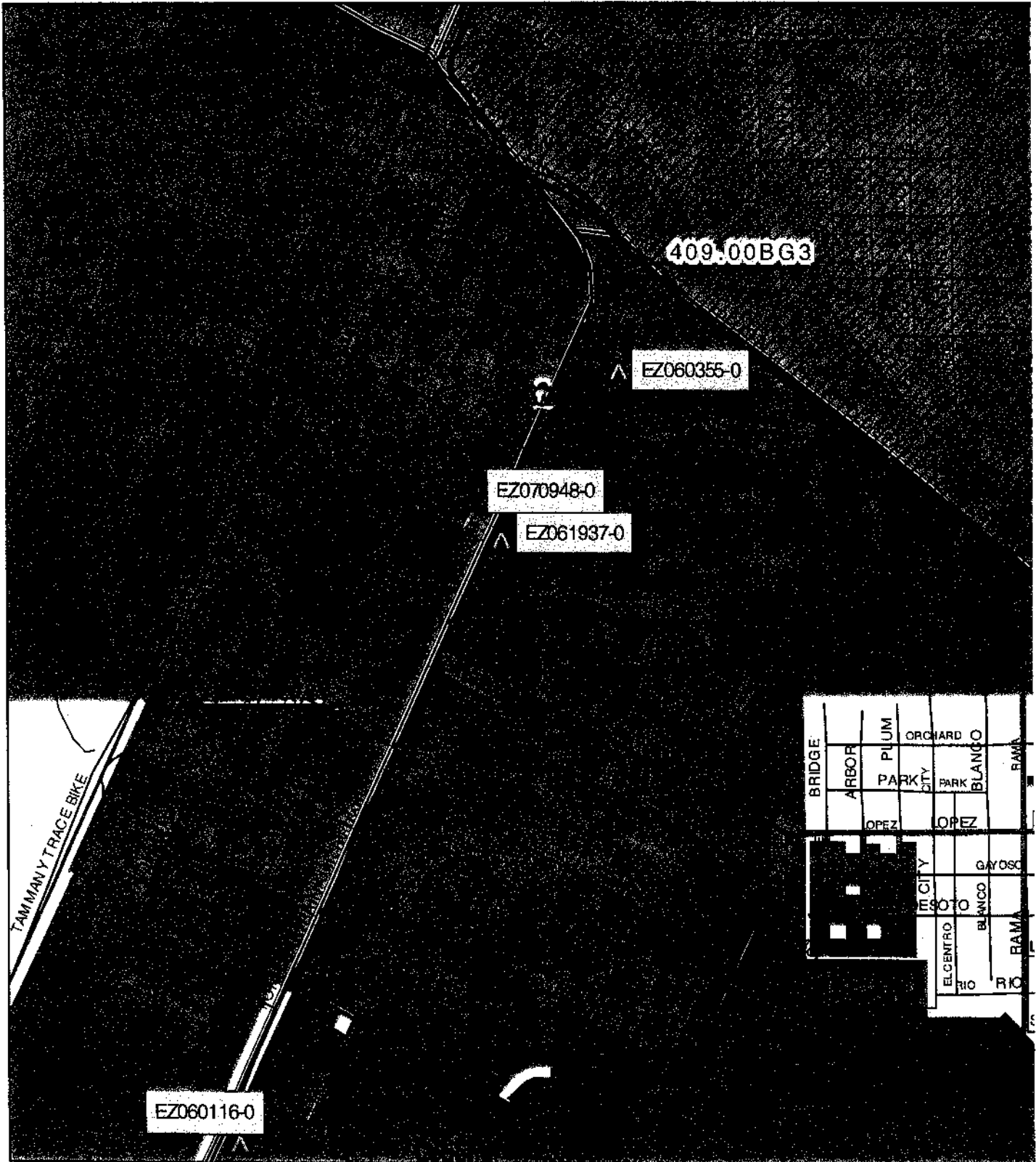

- Streets
- ▲ Enterprise Zone Endorsements
- ▨ Enterprise_Zones
- Block Groups
- ▬ Major Roads
- stp-streams
- sections
- wards

This map prepared by St. Tammany Parish Information Services.
This map is for planning purposes c



State of Louisiana
DEPARTMENT OF ECONOMIC DEVELOPMENT

C-2171

KATHLEEN BABINEAUX BLANCO
Governor

MICHAEL J. OLIVIER
Secretary

July 27, 2007

Mr. Kevin Davis
St. Tammany Parish Council
PO Box 628
Covington, LA 70434

RE: Local Endorsement Resolution
Raymond E. Masker Jr./Project #070948-0

Dear Mr. Davis:

In accordance with Act 948 of the 1992 Louisiana Legislature, enclosed is a copy of the Advance Notification #070948-0 received from Raymond E. Masker Jr.. Within ninety days of the receipt of this notification, your government will:

1. Pass an Endorsement Resolution supporting the project and possibly allowing the Project to receive the Local benefits of the Enterprise Zone Program
- or
2. Send written reasons why this Project is being denied endorsement
- or
3. Send a written request to delay consideration of the Advance Notification (Please give the time frame of delay requested)

If you have any questions or comments, please contact me at friedkin@la.gov or 225/342-9228.

Sincerely,

Marilyn P. Friedkin
Enterprise Zone Program

MPF/ms

cc: Raymond E. Masker Jr.

Enclosure

Post Office Box 94185/Baton Rouge, Louisiana 70804-9185
1051 North Third Street - 70802
Phone (225) 342-9228 - Fax (225) 342-0142
www.fed.louisiana.gov

LOUISIANA ECONOMIC DEVELOPMENT
 P.O. Box 94185
 Baton Rouge, LA 70804-9185
 Physical Address
 1051 North Third Street
 Baton Rouge, LA 70802



ADVANCE NOTIFICATION

For Office Use Only	
Deposit Date	7-25-07
Receipt #	23406
Check #	100.00
Check #	6915
Initials	RA

PLEASE TYPE

Visit <https://www.louisianaforward.com> for on-line filing

Date: C-2171

BUSINESS INFORMATION

Does this project have Advance Notification number? No Yes If yes, provide assigned # 070948-0

Business Name RAYMOND E. MASKER JR, DBA MCDONALDS

Project Beginning Date 8/11/2007 Project Ending Date 12/31/2007

Project Type: Start-up/New Additions Expansion

Project Name: (Optional) MCDONALD'S RESTAURANT

Project Physical Address1 HIGHWAY 11 Mailing Address2 SEE BELOW

City SLIDELL State LA Zip Code 70461

Provide a description of this project. CONSTRUCTION OF NEW MCDONALD'S RESTAURANT

Parish _____ Municipal District (If Orleans parish) 1 2 3 4 5 6 7

Is this project within city limits? Yes No NAICS Code 722210

Estimated Investments Costs		Estimated Number of Jobs		Estimated Payroll	
Building & Material	\$ 888,524	New	50	New	\$ 660,000
Machinery & Equipment	\$ 584,719	Existing	-	Existing	\$ -
Labor & Engineering	\$ 270,000	Construction	50	Construction	\$ 250,000
Total Investment	\$ 1,743,243		100		\$ 910,000

GAMING

Is there gaming activity at this project site? Yes No Are any owners involved in any gaming activities elsewhere? Yes No

CONTACT INFORMATION

Contact Type (Must have legal authority to sign): Business Consultant

Prefix _____ First Name: RAYMOND MI E Last Name MASKER Suffix JR

Contact's Company name MCDONALD Title OWNER

Mailing Address1 848 MORGAN BLUFF ROAD Mailing Address2 SAME

City PEARL RIVER State LA Zip Code 70452

Phone Number 985-863-6126 Fax Number 863-0666 Email Address RAYMOND.MASKER@PARTNERS.MCD.COM

OPTIONAL: Local Economic Development Contact

Contact Name _____ Organization _____

Phone _____ LED Contact Person _____

INCENTIVE PROGRAM(S)

Check each program for which you wish participate. Submit \$100 for each program. Do not apply for EZ and QJ for the same project.

Enterprise Zone Quality Jobs Industrial Tax Exemption (Manufacturers Only) Restoration Tax Abatement

Amount Due: \$ 100

Ray Masker Jr
 Company Official Signature

RECEIVED
 RAYMOND E. MASKER JR, OWNER
 Print Official Name
 JUL 25 2007

RESOURCE SERVICES