

ST. TAMMANY PARISH COUNCIL

RESOLUTION

RESOLUTION COUNCIL SERIES NO. 2310

COUNCIL SPONSOR: BINDER/DAVIS

PROVIDED BY: PLANNING

RESOLUTION STATING THE ST. TAMMANY PARISH COUNCIL'S ENDORSEMENT OF **HERMAN & KITTLE PROPERTIES, INC.**, FOR PARTICIPATION IN THE BENEFITS OF THE LOUISIANA ENTERPRISE ZONE PROGRAM.

WHEREAS, in accordance with the Louisiana Enterprise Zone Act 901 of 1981, Act 337 of 1982, Act 433 of 1987, Act 1024 of 1992, Act 581 of 1995, Act 624 of 1997, Act 647 of 1997, and Act 977 of 1999; and

WHEREAS, this business is located within Census Tract 408.01, Block Group 2, which is not a designated Enterprise Zone or within the boundaries of an Economic Development Zone and;

WHEREAS, in accordance with the Louisiana Enterprise Zone Program requirements the St. Tammany Parish Council agrees:

1. To participate in the Enterprise Zone Program.
2. To assist the Department in evaluating progress made in any Enterprise Zone within its jurisdiction.

THE PARISH OF ST. TAMMANY HEREBY RESOLVES that the Parish Council endorses **Herman & Kittle Properties, Inc. - #EZ#20071295** (Canterberry House Apartments, Phase 1) for the following property, located in Council District 12 of St. Tammany Parish and located at 500 Spartan Drive Slidell, LA. for participation in the Louisiana Enterprise Zone Program.

BE IT FURTHER RESOLVED that all resolutions or parts thereof in conflict herewith are hereby repealed.

THIS RESOLUTION HAVING BEEN SUBMITTED TO A VOTE, THE VOTE THEREON WAS AS FOLLOWS:

MOVED FOR ADOPTION BY _____, SECONDED BY _____

YEAS:

NAYS:

ABSTAIN:

ABSENT:

THIS RESOLUTION WAS DECLARED ADOPTED ON THE _____ DAY OF _____ 2008, AT A REGULAR MEETING OF THE PARISH COUNCIL, A QUORUM OF THE MEMBERS BEING PRESENT AND VOTING.

JERRY BINDER, COUNCIL CHAIRMAN





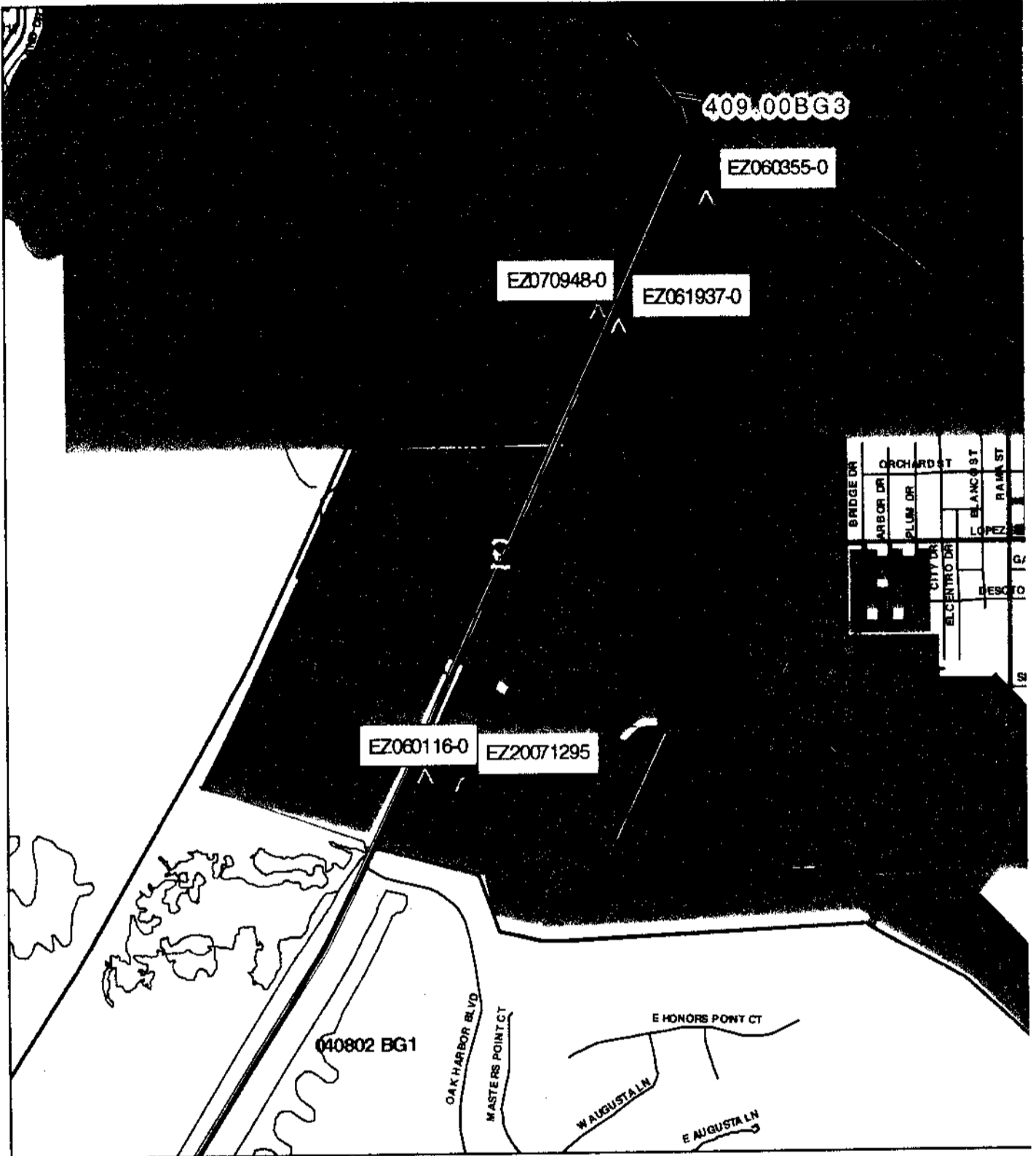

ATTEST:

DIANE HUESCHEN, COUNCIL CLERK

Enterprise Zone Site Endorsement EZ#20071295



Legend

-  Enterprise Zone Endorsements
-  Enterprise_Zones
-  Block Groups
-  Major Roads
-  Streams
-  sections
-  wards



This map prepared by St. Tammany Parish Information Services.
This map is for planning purposes c



State of Louisiana
DEPARTMENT OF ECONOMIC DEVELOPMENT

6-230

KATHLEEN BABINEAUX BLANCO
Governor

MICHAEL J. OLIVIER
Secretary

January 4, 2008

Mr. Kevin Davis
St. Tammany Parish Council
P.O. Box 628
Covington, LA 70434

RE: Local Endorsement Resolution
Herman & Kittle Properties, Inc./Project #20071295

Handwritten mark

Dear Mr. Davis:

In accordance with Act 948 of the 1992 Louisiana Legislature, enclosed is a copy of the Advance Notification #20071295 received from Herman & Kittle Properties, Inc.. Within ninety days of the receipt of this notification, your government will:

- 1. Pass an Endorsement Resolution supporting the project and possibly allowing the Project to receive the Local benefits of the Enterprise Zone Program
- or
- 2. Send written reasons why this Project is being denied endorsement
- or
- 3. Send a written request to delay consideration of the Advance Notification (Please give the time frame of delay requested)

If you have any questions or comments, please contact me at friedkin@la.gov or 225/342-9228.

Sincerely,

Marylyn P. Friedkin

Marylyn P. Friedkin
Enterprise Zone Program

MPF/ms

cc: Herman & Kittle Properties, Inc.

Enclosure

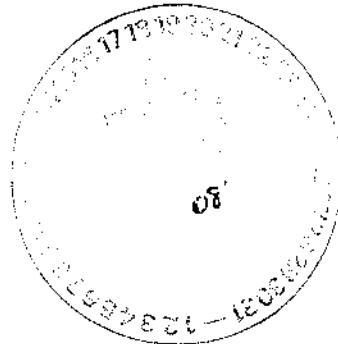

Post Office Box 94185/Baton Rouge, Louisiana 70804-9185
1051 North Third Street - 70802
Phone (225) 342-9228 - Fax (225) 342-0142
www.led.louisiana.gov

Mailing Address
 Louisiana Economic
 Development
 P.O. Box 94185
 Baton Rouge, LA 70804-9185

Physical Address
 1051 North Third Street
 Baton Rouge, LA 70802



LOUISIANA
 ECONOMIC DEVELOPMENT

**ADVANCE
 NOTIFICATION**

For Office Use Only	
Deposit Date	11/29/07
Receipt #	1338
Check #	2319
Check Amt.	40,500.00
Initials	AP

PLEASE TYPE

Visit <https://www.louisianaforward.com> for on-line filing

Date: 11/29/07

BUSINESS INFORMATION 20071295

Does this project have an Advance Notification number? No Yes If yes, provide assigned # _____

Business Name Herman & Kittle Properties, Inc.

Project Beginning Date 11/29/07 Project Ending Date 11/28/09

Project Type: Start-up/New Additions Expansion

Project Name: (Optional) Canterbury House Apartments - Slidell - Phase 1

Project Physical Address1 301 Spartan Drive Mailing Address2 _____

City Slidell State LA Zip Code _____

Provide a description of this project. New apartment complex - 120 units

Parish St. Tammany Municipal District (If Orleans parish) 1 2 3 4 5 6 7

Is this project within city limits? Yes No NAICS Code 531110

Estimated Investments Costs		Estimated Number of Jobs		Estimated Payroll	
Building & Material	\$ 10,000,000	New	4	New	\$ 120,000
Machinery & Equipment	\$ 2,000,000	Existing	0	Existing	\$ 0
Labor & Engineering	\$ incl in above	Construction	100	Construction	\$ 4,000,000
Total Investment	\$ 12,000,000				\$

GAMING

Is there gaming activity at this project site? Yes No Are any owners involved in any gaming activities elsewhere? Yes No

CONTACT INFORMATION

Contact Type (Must have legal authority to sign): Business Consultant

Prefix _____ First Name Don MI _____ Last Name Allison Suffix _____

Contact's Company name Advantous Consulting, L.L.C. Title Principal

Mailing Address1 9270 Siegen Lane, Suite 801 Mailing Address2 _____

City Baton Rouge State LA Zip Code 70810

Phone Number 225-769-1818 Fax Number 225-769-1890 Email Address don.allison@advantous.com

OPTIONAL: Local Economic Development Contact

Contact Name _____ Organization _____

Phone _____ LED Contact Person _____

INCENTIVE PROGRAMS/SOURCE SERVICES

Check each program for which you wish participate. Submit \$100 for each program. Do not apply for EZ and QJ for the same project.

Enterprise Zone Quality Jobs Industrial Tax Exemption (Manufacturers Only) Restoration Tax Abatement

Amount Due: \$ 100

Don Allison
 Company Representative Signature Don Allison, Principal
 Print Representative Name and Title

RECEIVED
 NOV 28 2007