

ST. TAMMANY PARISH COUNCIL

RESOLUTION

RESOLUTION COUNCIL SERIES NO. C-2362

COUNCIL SPONSOR: BINDER/DAVIS PROVIDED BY: PLANNING

RESOLUTION STATING THE ST. TAMMANY PARISH COUNCIL'S
ENDORSEMENT OF **SLIDELL DEVELOPMENT COMPANY**, FOR PARTICIPATION IN
THE BENEFITS OF THE LOUISIANA ENTERPRISE ZONE PROGRAM.

WHEREAS, in accordance with the Louisiana Enterprise Zone Act 901 of 1981, Act 337 of 1982, Act 433 of 1987, Act 1024 of 1992, Act 581 of 1995, Act 624 of 1997, Act 647 of 1997, and Act 977 of 1999; and

WHEREAS, this business is located within Census Tract 409.00, Block Group 2, which is not a designated Enterprise Zone or within the boundaries of an Economic Development Zone and;

WHEREAS, in accordance with the Louisiana Enterprise Zone Program requirements the St. Tammany Parish Council agrees:

1. To participate in the Enterprise Zone Program.
2. To assist the Department in evaluating progress made in any Enterprise Zone within its jurisdiction.

THE PARISH OF ST. TAMMANY HEREBY RESOLVES that the Parish Council endorses Slidell Development Company - #EZ#20071374 for the following property, located in Council District 14 of St. Tammany Parish and located at Hwy 433 & Hwy 190 Slidell, LA 70458, for participation in the Louisiana Enterprise Zone Program.

BE IT FURTHER RESOLVED that all resolutions or parts thereof in conflict herewith are hereby repealed.

THIS RESOLUTION HAVING BEEN SUBMITTED TO A VOTE. THE VOTE THEREON WAS AS FOLLOWS:

MOVED FOR ADOPTION BY _____, SECONDED BY _____

YEAS:

NAYS:

ABSTAIN:

ABSENT:

THIS RESOLUTION WAS DECLARED ADOPTED ON THE _____ DAY OF _____ 2008. AT A REGULAR MEETING OF THE PARISH COUNCIL. A QUORUM OF THE MEMBERS BEING PRESENT AND VOTING.

JERRY BINDER, COUNCIL CHAIRMAN

ATTEST:

DIANE HUESCHEN, COUNCIL CLERK

Enterprise Zone Site Endorsement EZ#20071374

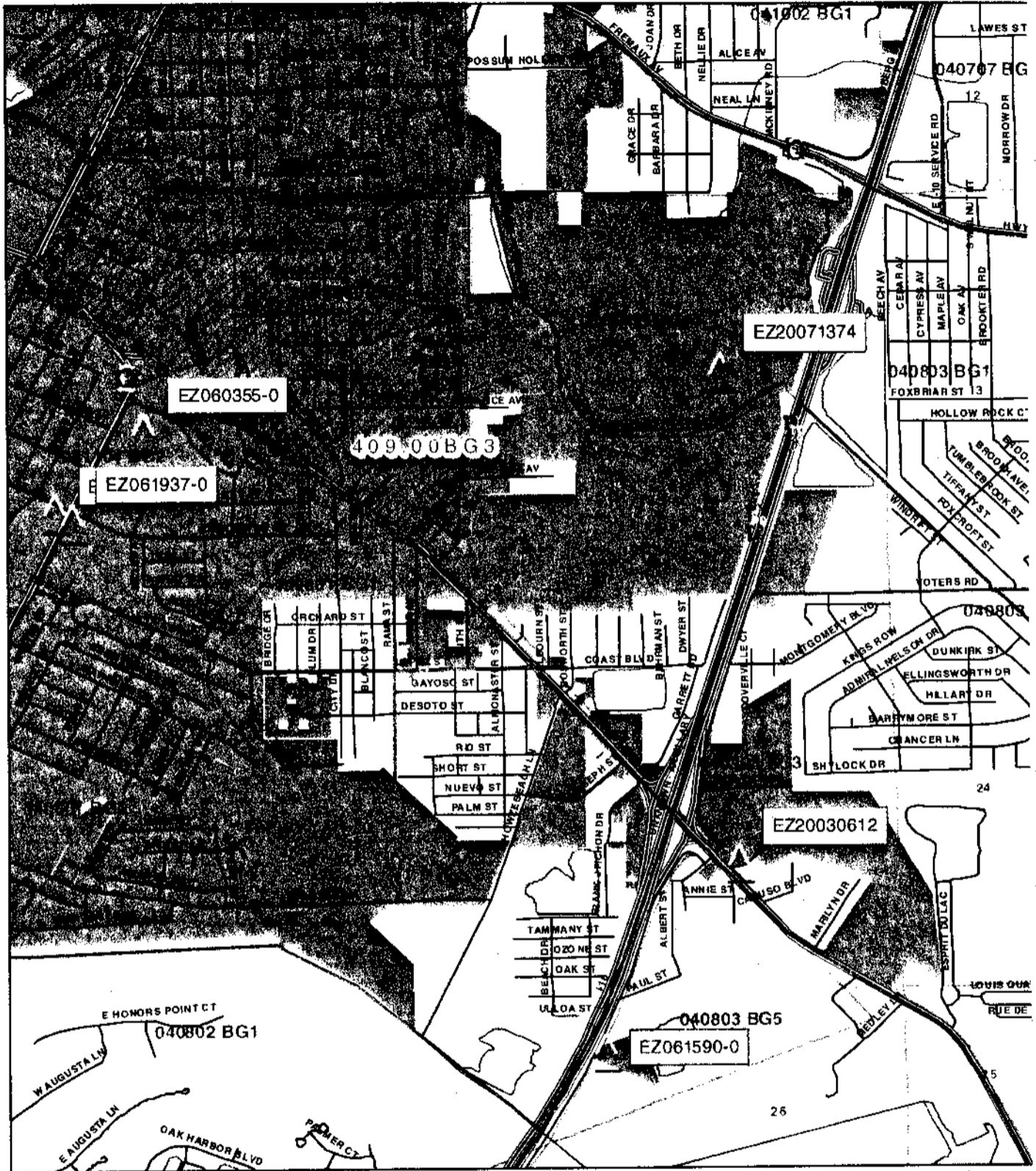

St. Tammany Parish Government
Kevin Davis, President
P.O. Box 628
Covington, LA 70434

Legend

- Enterprise Zone Endorsements
- Major Roads
- Streams
- Sections
- Block Groups
- Wards
- Enterprise_Zones

This map prepared by St. Tammany Parish Information Services.
This map is for planning purposes o



State of Louisiana
DEPARTMENT OF ECONOMIC DEVELOPMENT

Bobby Jindal
Governor

Stephen Moret
Secretary

March 14, 2008

Ms. Brenda Reine
St. Tammany Economic Dev Foundation
21489 Koop Drive
Mandeville, LA 70471

RE: Local Endorsement Resolution
Slidell Development Company/Project #20071374

Dear Ms. Reine:

In accordance with Act 948 of the 1992 Louisiana Legislature, enclosed is a copy of the Advance Notification #20071374 received from Slidell Development Company. Within ninety days of the receipt of this notification, your government will:

1. Pass an Endorsement Resolution supporting the project and possibly allowing the Project to receive the Local benefits of the Enterprise Zone Program
- or
2. Send written reasons why this Project is being denied endorsement
- or
3. Send a written request to delay consideration of the Advance Notification (Please give the time frame of delay requested)

If you have any questions or comments, please contact me at friedkin@la.gov or 225/342-9228.

Sincerely,

Marilyn P. Friedkin
Enterprise Zone Program

MPF/ms

cc: Slidell Development Company

Enclosure

RECEIVED

MAR 20 2008

Post Office Box 94185/Baton Rouge, Louisiana 70804-9185
1051 North Third Street - 70802
Phone (225) 342-9228 - Fax (225) 342-0142
www.led.louisiana.gov

Mailing Address
Louisiana Economic
Development
P.O. Box 94185
Baton Rouge, LA 70804-9185

Physical Address
1051 North Third Street
Baton Rouge, LA 70802



ADVANCE NOTIFICATION

For Office Use Only	
Deposit Date	
Receipt #	
Check #	
Check Amt.	
Initials	

PLEASE TYPE

Visit <https://www.louisianaforward.com> for on-line filing

Date: 12/27/07

BUSINESS INFORMATION

Does this project have Advance Notification number? No Yes If yes, provide assigned # 20071374

Business Name SLIDELL DEVELOPMENT COMPANY, LLC

Project Beginning Date 01/01/2008 Project Ending Date 06/30/2010

Project Type: Start-up/New Additions Expansion

Project Name: (Optional) SLIDELL DEVELOPMENT

Project Physical Address1 400 acres on west side of I-10 bounded by La Hwy 443 & US Hwy 190B Mailing Address2 _____

City SLIDELL State LA Zip Code 70458

Provide a description of this project. Construction and operation of commercial/retail/education/medical development, plus 500 multi-family residential units

Parish ST. TAMMANY Municipal District (If Orleans parish) 1 2 3 4 5 6 7

Is this project within city limits? Yes No NAICS Code 531312

Estimated Investments Costs		Estimated Number of Jobs		Estimated Payroll	
Building & Material	\$300,000,000	New	5	New	\$200,000
Machinery & Equipment	\$100,000,000	Existing	0	Existing	\$0
Labor & Engineering	\$600,000,000	Construction	2000	Construction	\$200,000,000
Total Investment	\$1,000,000,000				\$

GAMING

Is there gaming activity at this project site? Yes No Are any owners involved in any gaming activities elsewhere? Yes No

CONTACT INFORMATION

Contact Type (Must have legal authority to sign): Business Consultant

Prefix _____ First Name JILL MI _____ Last Name DEER Suffix _____

Contact's Company name BAYER PROPERTIES Title VICE PRESIDENT

Mailing Address1 2222 Arlington Avenue S Mailing Address2 _____

City BIRMINGHAM State AL Zip Code 35205

Phone Number 205-795-4138 Fax Number 205-795-4161 Email Address jdeer@bayerproperties.com

OPTIONAL: Local Economic Development Contact

Contact Name Gary J. Elkins Organization Elkins PLC

Phone 504-529-3800 LED Contact Person Gary J. Elkins

INCENTIVE PROGRAM(S)

Check each program for which you wish participate. Submit \$100 for each program. Do not apply for EZ and QJ for the same project.

Enterprise Zone Quality Jobs Industrial Tax Exemption (Manufacturers Only) Restoration Tax Abatement

Amount Due: \$ 100.00  Gary J. Elkins