

ST. TAMMANY PARISH COUNCIL

ORDINANCE

ORDINANCE CALENDAR NO. 3933

ORDINANCE COUNCIL SERIES NO. \_\_\_\_\_

COUNCIL SPONSOR MR. BINDER

PROVIDED BY COUNCIL OFFICE

INTRODUCED BY: MR. BILLIOT

SECONDED BY: MR. STEFANCIK

ON THE 11<sup>TH</sup> DAY OF SEPTEMBER, 2008.

ORDINANCE TO EXTEND FOR AN ADDITIONAL SIX (6) MONTHS  
THE MORATORIUM ON THE ISSUANCE OF PERMITS FOR  
CONSTRUCTION OR PLACEMENT OF BUILDING STRUCTURES ON  
PROPERTY WITHIN CERTAIN PORTIONS OF HIGHLAND PARK  
SUBDIVISION (DISTRICT 12)

WHEREAS, the Parish Council adopted Ordinance C.S. No. 08-1785 extending the six (6) month moratorium on issuance of permits for construction or placement of building structures on property within a certain portion of Highland Park Subdivision; and

WHEREAS, the moratorium was initiated in order to protect and preserve the health, safety and property interests of residents from potential hazards of flood water problems and existing drainage conditions in and near the subject property; and

WHEREAS, it is necessary to further extend the moratorium to allow time for the parish to complete evaluation of drainage conditions affecting the area more fully described within this ordinance.

THE PARISH OF ST. TAMMANY HEREBY ORDAINS that it extends for an additional six (6) months the moratorium on the issuance of permits for the construction or placement of any building structures on property within a portion of Highland Park Subdivision, District 12, as more fully described as follows:

All that property commonly known as Highland Park Subdivision, comprising any and all squares and lots of record therein, generally bounded by Orchard Street on the north, City Drive on the east, Windsor Place Subdivision on the south and Peach Tree Street to the west, less and except property within the corporate limits of the City of Slidell, and LESS AND EXCEPT property north of Lopez Street. All as indicated on the plat attached hereto.

BE IT FURTHER ORDAINED that this Ordinance shall be effective immediately upon final adoption and remain in effect through April 6, 2008.

BE IT FURTHER ORDAINED that the moratorium herein imposed may be vacated, in whole or in part, by Resolution of this governing body pursuant to Chapter 5, Article II, Section 5-056.00 of the Parish Code of Ordinances.

REPEAL: All Ordinances or parts of Ordinances in conflict herewith are hereby repealed.

SEVERABILITY: If any provision of this Ordinance shall be held to be invalid, such invalidity shall not affect other provisions herein which can be given effect without the invalid provision and to this end the provisions of this Ordinance are hereby declared to be severable.

ORDINANCE CALENDAR NO. 3933

ORDINANCE COUNCIL SERIES. NO. \_\_\_\_\_

PAGE 2 OF 2

MOVED FOR ADOPTION BY: \_\_\_\_\_, SECONDED BY: \_\_\_\_\_

WHEREUPON THIS ORDINANCE WAS SUBMITTED TO A VOTE AND RESULTED IN THE FOLLOWING:

YEAS:

NAYS:

ABSTAIN:

ABSENT:

THIS ORDINANCE WAS DECLARED DULY ADOPTED AT A REGULAR MEETING OF THE PARISH COUNCIL ON THE \_\_\_\_\_ DAY OF \_\_\_\_\_ 2008; AND BECOMES ORDINANCE COUNCIL SERIES NO. \_\_\_\_\_.

\_\_\_\_\_  
JERRY BINDER, COUNCIL CHAIRMAN

ATTEST:

\_\_\_\_\_  
THERESA L. FORD, COUNCIL CLERK

\_\_\_\_\_  
KEVIN DAVIS, PARISH PRESIDENT

Published Introduction: August 28, 2008  
Published adoption: \_\_\_\_\_, 2008

Delivered to Parish President \_\_\_\_\_, 2008 @ \_\_\_\_\_  
Returned to Council Clerk \_\_\_\_\_, 2008 @ \_\_\_\_\_

ST TAMMANY PARISH - LOUISIANA

TOWN OF SLIDELL

ADJOINING CITY LIMITS OF

SUB-DIVISION

# HIGHLAND PARK

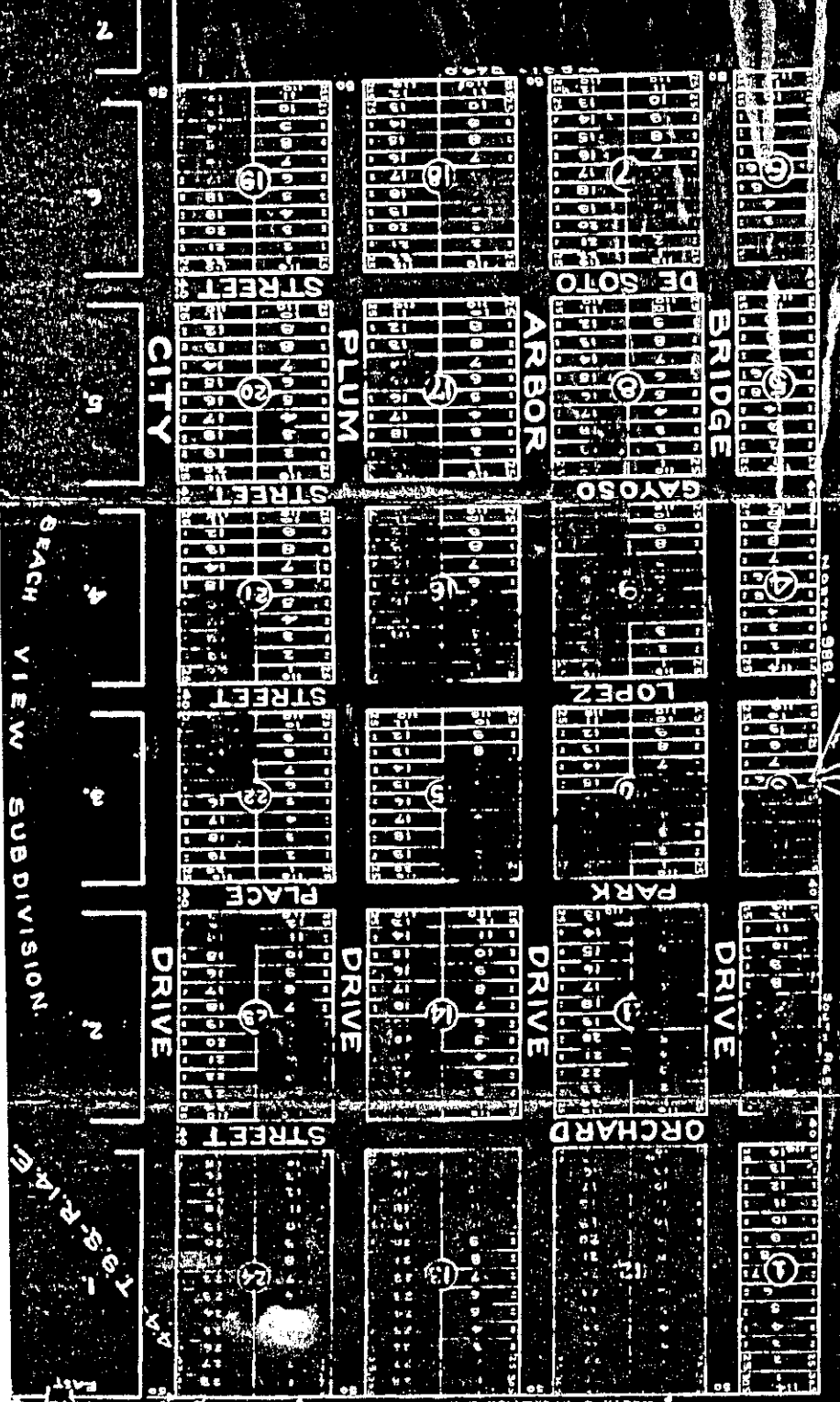

T.9.S.

BEACH VIEW SUBDIVISION

T.9.S. - R.14.16

3933