

ST. TAMMANY PARISH COUNCIL

ORDINANCE

ORDINANCE CALENDAR NO. 3901

ORDINANCE COUNCIL SERIES NO. 08-

COUNCIL SPONSOR MR. BELLISARIO

PROVIDED BY: COUNCIL OFFICE

INTRODUCED BY MR. STEFANCIK

SECONDED BY MR. ARTIGUE

ON THE 7TH DAY OF AUGUST, 2008

ORDINANCE ESTABLISHING A "NO PARKING" ZONE ON A PORTION OF BOTH SIDES OF DEFIANCE DRIVE (8-I-54)(WARD 8, DISTRICT 9)

WHEREAS, St. Tammany Parish Government is charged with protecting the safety and general welfare of citizens of the parish; and

WHEREAS, St. Tammany Parish has experienced an increase in parking along portions of Defiance Drive, particularly at the intersections of side streets; and

WHEREAS, affected citizens have requested control measures be taken to address this unsafe situation on Parish roads.

THE PARISH OF ST. TAMMANY HEREBY ORDAINS, that

SECTION I: A "NO PARKING" zone is hereby established on both sides of Defiance Drive beginning at Lenwood Drive and continuing to Meridith Drive.

SECTION II: The Parish Department of Public Works is directed to post the appropriate signs at this location, in accordance with the attached Engineering data.

REPEAL: All ordinances or parts of ordinances in conflict herewith are hereby repealed.

SEVERABILITY: If any provision of this ordinance shall be held to be invalid, such invalidity shall not affect any other provision herein which can be given effect without the invalid provision and to this end the provisions of this ordinance are hereby declared to be severable.

DATE OF ENACTMENT: This ordinance shall become effective immediately upon final adoption.

MOVED FOR ADOPTION BY: _____, SECONDED BY: _____

WHEREUPON THIS ORDINANCE WAS SUBMITTED TO A VOTE AND RESULTED IN THE FOLLOWING:

YEAS:

NAYS:

ABSTAIN:

ABSENT:

INTER OFFICE



Kevin Davis
Parish President

MEMORANDUM

ST. TAMMANY PARISH GOVERNMENT
DEPARTMENT OF ENGINEERING

Date: July 9, 2008

To: Joey Lobrano
Right Of Way Coordinator
Department Of Public Works

From: Rebecca B. Lala, P.E.
Traffic Engineer

Re: District 9
Defiance Dr. (8-I-54)
2-"Speed Limit 25"
2-"NO PARKING Any Time (Right Arrow)" (R7-1) signs
2-"NO PARKING Any Time (Left Arrow)" (R7-1) signs
8-"NO PARKING" signs

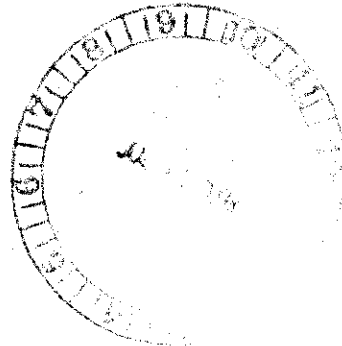

The Department of Engineering recommends the installation of signage in District 9.

As per MUTCD, when signs with arrows are used to indicate the restricted parking zones, the signs with the arrows should be set at an angle of not less than 30 degrees and not more than 45 degrees with the line of traffic flow in order to be visible to approaching traffic.

1. Install "Speed Limit 25" sign 50' from the Lenwood and Defiance intersection.
 2. Install "NO PARKING (Right Arrow R7-1)" sign on the east side of Defiance, 140' north of the Lenwood and Defiance intersection.
 3. Install "NO PARKING (Left Arrow R7-1)" sign on the west side of Defiance, 140' north of the Lenwood and Defiance intersection.
 4. Install "NO PARKING" sign on the east side of Defiance, 85' north of the Defiance and Heather intersection next to the corner of the wood fence.
 5. Install "NO PARKING" sign on the west side of Defiance, 45' north of the Defiance and Celeste intersection next to the small tree.
 6. Install "NO PARKING" sign on the east side of Defiance, 80' north of the Defiance and Celeste intersection next to the corner of the wood fence.
-

7. Install "NO PARKING" sign on the east side of Defiance, 80' south of the Defiance and Dixie Circle intersection next to the corner of the wood fence.
8. Install "NO PARKING" sign on the west side of Defiance, across from the Dixie Circle and Defiance intersection next to light pole.
9. Install "NO PARKING" sign on east side of Defiance, 80' south of the Defiance and Marywood Circle intersection next to the corner of the wood fence.
10. Install "NO PARKING" sign on the east side of Defiance, 90' north of the Defiance and Marywood Circle intersection.
11. Install "NO PARKING" sign on west side of Defiance, 90' north of the Defiance and Marywood Circle intersection.
12. Install "Speed Limit 25" sign 50' from the Meredith and Defiance intersection.
13. Install "NO PARKING (Right Arrow R7-1)" sign on the east side of Defiance, 25' south of the Meredith and Defiance intersection.
14. Install "NO PARKING (Left Arrow R7-1)" sign on the west side of Defiance, 25' south of the Meredith and Defiance intersection.

Please install signs in accordance with MUTCD standards and see the attached sketch.
Thank you for your assistance. If you have any questions, please let me know.

Xc: Councilman E.L. "Gene" Bellisario
E. deEtte Smythe Ph.D., Director of Engineering
Michael Spiehler, Traffic Data Tech.

MEREDITH

DEFIANCE DR.
8-I-54
DISTRICT 9
NO PARKING

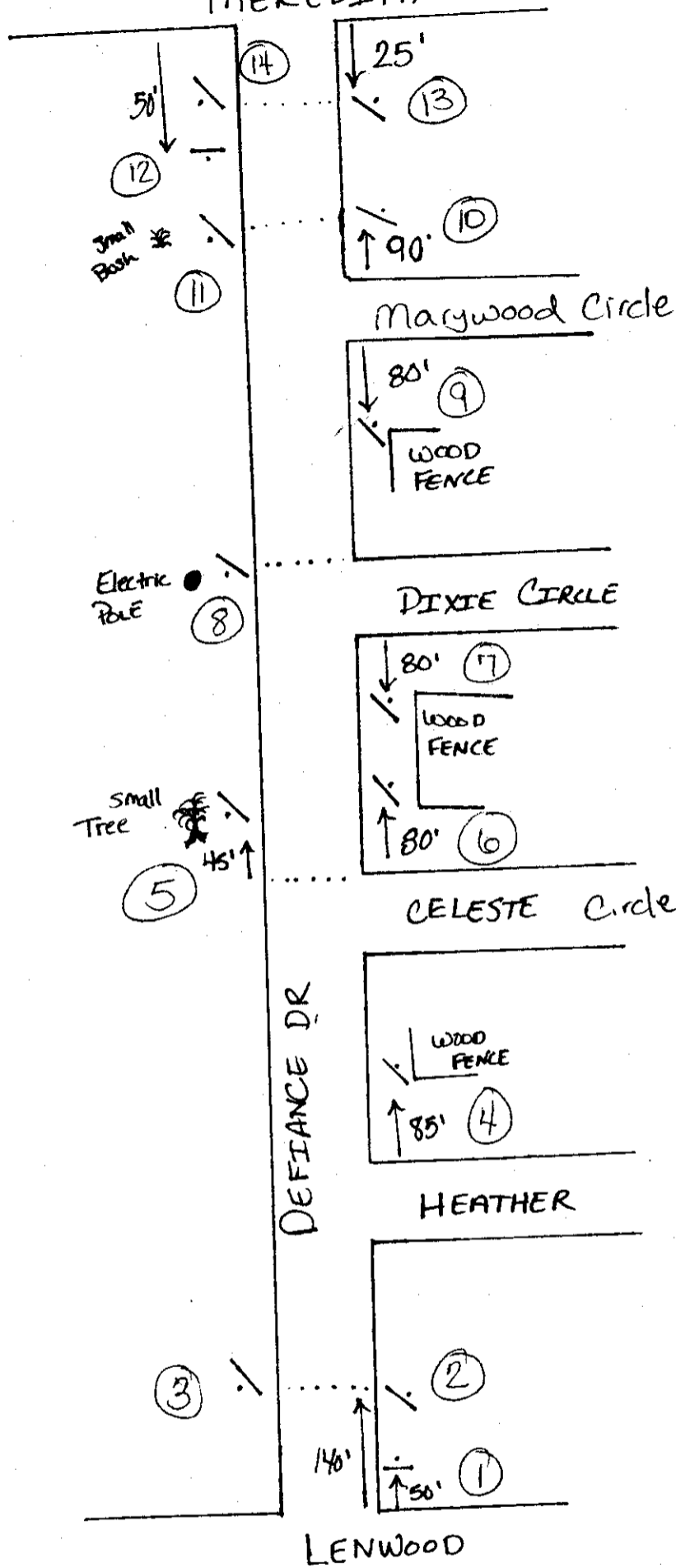

LENWOOD