

ST. TAMMANY PARISH COUNCIL

ORDINANCE

ORDINANCE CALENDAR NO. 4007 ORDINANCE COUNCIL SERIES NO. \_\_\_\_\_

COUNCIL SPONSOR: MR. ARTIGUE PREPARED BY COUNCIL OFFICE

INTRODUCED BY: MR. STEFANCIK SECONDED BY: MR. BURKHALTER

ON THE 5<sup>TH</sup> DAY OF FEBRUARY, 2009

ORDINANCE TO EXTEND FOR AN ADDITIONAL SIX (6) MONTHS THE MORATORIUM ON THE ISSUANCE OF BUILDING PERMITS FOR CONSTRUCTION OR PLACEMENT OF BUILDING STRUCTURES ON PROPERTY ON THE SOUTH SIDE OF LAKEVIEW DRIVE (WARD 9, DISTRICT 13).

WHEREAS, the Parish Council adopted Ordinance C.s. No. 08-1928 imposing a six (6) month moratorium on issuance of building permits for construction or placement of building structures on property on the south side of Lakeview Drive (Ward 9, District 13); and

WHEREAS, the moratorium was initiated to protect and preserve the health, safety and property interests of residents from adverse building construction activities in the re-development of lakeshore properties along the south side of Lakeview Drive; and

WHEREAS, it is necessary to extend the moratorium until proper coordination among regulatory agencies is accomplished and appropriate reclamation policies and procedures are established.

THE PARISH OF ST. TAMMANY HEREBY ORDAINS that it extends for an additional six (6) months the moratorium on the issuance of building permits for construction or placement of building structures on a certain portion of Lakeview Drive, Ward 9, District 13.

The properties subject to this moratorium shall be those located on the south side of Lakeview Drive beginning at its intersection with U.S. Highway 11 to its termination east of Harborview Court, as further described on the attached map.

BE IT FURTHER ORDAINED that this Ordinance shall be effective immediately upon final adoption and shall remain in effect through September 4, 2009.

BE IT FURTHER ORDAINED that the moratorium herein imposed may be vacated, in whole or in part, by Resolution of this governing body pursuant to Chapter 5, Article II, Section 5-056.00 of the Parish Code of Ordinances.

REPEAL: All Ordinances or parts of Ordinances in conflict herewith are hereby repealed.

SEVERABILITY: If any provision of this Ordinance shall be held to be invalid, such invalidity shall not affect other provisions herein which can be given effect without the invalid provision and to this end the provisions of this Ordinance are hereby declared to be severable.

WHEREUPON THIS ORDINANCE WAS SUBMITTED TO A VOTE AND RESULTED IN THE FOLLOWING:

MOVED FOR ADOPTION BY \_\_\_\_\_, SECONDED BY \_\_\_\_\_

YEAS:

NAYS:

ABSTAIN:

ABSENT:

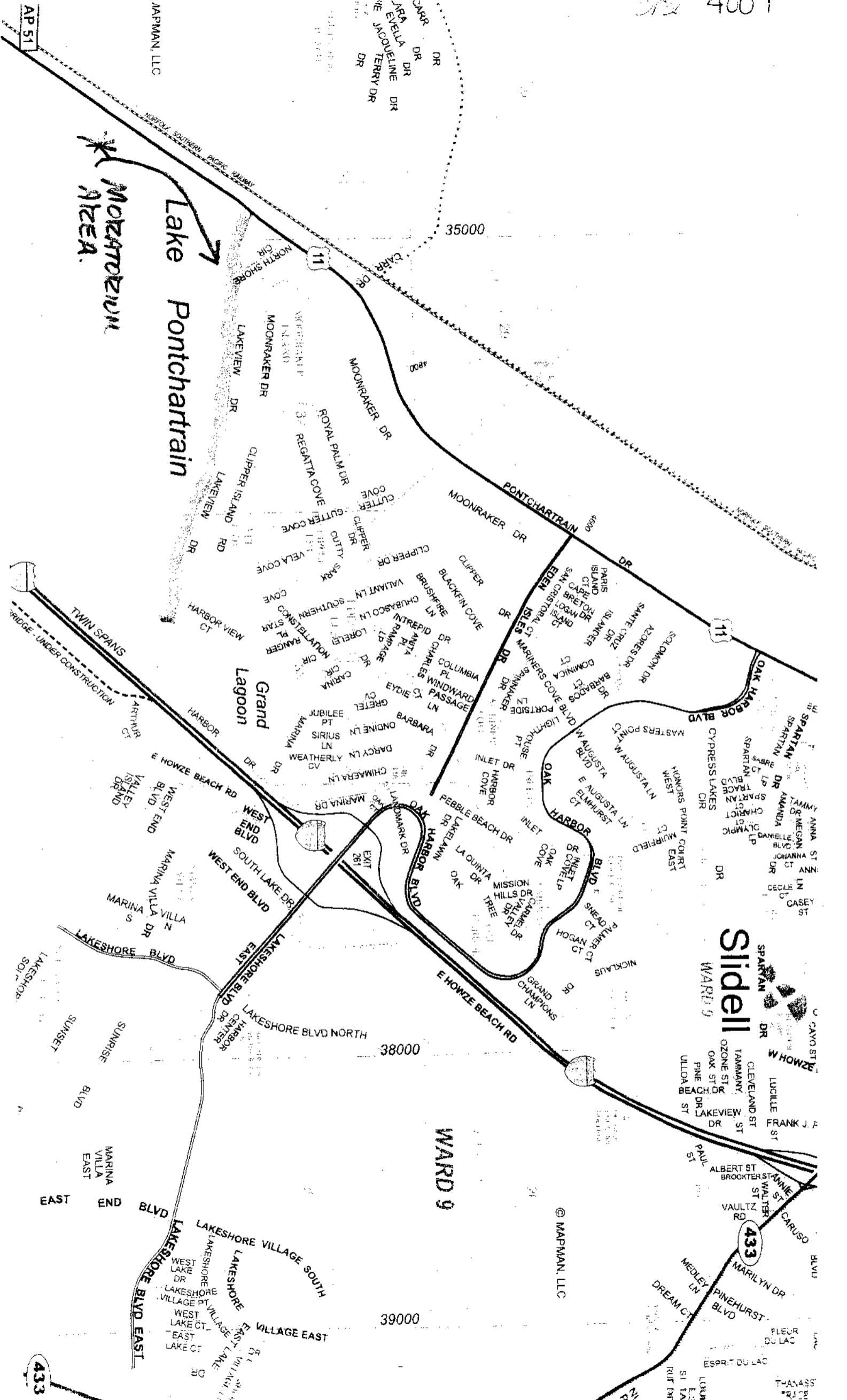

**Mozartium Area**

**Lake Pontchartrain**

**Grand Lagoon**

**Sidel**

**WARD 9**

© MAPMAN, LLC

AP 51

MAPMAN, LLC

11

11

WARD 9

433

433

35000

38000

39000

4800

JARA DR  
EVELLA DR  
TERRY DR  
JACQUELINE DR  
CARR DR

SPARTAN DR  
AMANDA DR  
ANNAMIA DR  
ANNAMIA ST  
ANNAMIA LN  
ANNAMIA CT  
ANNAMIA BLVD  
ANNAMIA RD  
ANNAMIA PKWY  
ANNAMIA AVE  
ANNAMIA HWY  
ANNAMIA EXPY  
ANNAMIA CIRCLE  
ANNAMIA DRIVE  
ANNAMIA ROAD  
ANNAMIA PARKWAY  
ANNAMIA EXPRESSWAY  
ANNAMIA CIRCLE  
ANNAMIA DRIVE  
ANNAMIA ROAD  
ANNAMIA PARKWAY  
ANNAMIA EXPRESSWAY

TWIN SPANS BRIDGE - UNDER CONSTRUCTION

LAKESHORE BLVD

LAKESHORE BLVD EAST

PONTCHARTRAIN DR

OAK HARBOR BLVD

E HOWZE BEACH RD

MOONRAKER DR

CLIPPER DR

WEST END BLVD

LAKESHORE BLVD

LAKESHORE VILLAGE SOUTH

LAKESHORE VILLAGE EAST

W HOWZE

MARILYN DR

RESORT DU LAC

HARBOR VIEW CT

VALLEY ISLAND DR

MARINA VILLA DR

SUNRISE BLVD

MARINA VILLA EAST

LAKESHORE VILLAGE EAST

CLIPPER COVE

OAK HARBOR BLVD

E HOWZE BEACH RD

LAKESHORE BLVD

LAKESHORE VILLAGE SOUTH

LAKESHORE VILLAGE EAST

W HOWZE

MARILYN DR

RESORT DU LAC

HARBOR VIEW CT

VALLEY ISLAND DR

MARINA VILLA DR

SUNRISE BLVD

MARINA VILLA EAST

LAKESHORE VILLAGE EAST

CLIPPER COVE

OAK HARBOR BLVD

E HOWZE BEACH RD

LAKESHORE BLVD

LAKESHORE VILLAGE SOUTH

LAKESHORE VILLAGE EAST

W HOWZE

MARILYN DR

RESORT DU LAC