

ST. TAMMANY PARISH COUNCIL

ORDINANCE

ORDINANCE CALENDAR NO: 4513

ORDINANCE COUNCIL SERIES NO: \_\_\_\_\_

COUNCIL SPONSOR: GOULD/DAVIS

PROVIDED BY: PLANNING

INTRODUCED BY: MR. STEFANCIK

SECONDED BY: MR. BELLISARIO

ON THE 3 DAY OF MARCH, 2011

ORDINANCE AMENDING THE OFFICIAL ZONING MAP OF ST. TAMMANY PARISH, LA, TO RECLASSIFY A CERTAIN PARCEL LOCATED ON THE SOUTH SIDE OF LA HIGHWAY 36 AND WHICH PROPERTY COMPRISES A TOTAL 16,843 ACRES OF LAND MORE OR LESS, FROM ITS PRESENT PF-1 (PUBLIC FACILITIES DISTRICT) TO AN PF-1 (PUBLIC FACILITIES DISTRICT) & AAO (ABITA AIRPORT OVERLAY DISTRICT), (WARD 4, 6 & 10, DISTRICT 6 & 7). (ZC10-08-103)

Whereas, the Zoning Commission of the Parish of St. Tammany after hearing in accordance with law, Case No. ZC10-08-103, has recommended to the Council of the Parish of St. Tammany, Louisiana, that the zoning classification of the above referenced area be changed from its present PF-1 (Public Facilities District) to an PF-1 (Public Facilities District) & AAO (Abita Airport Overlay District) see Exhibit "A" for complete boundaries; and

Whereas, the St. Tammany Parish Council has held its public hearing in accordance with law; and

Whereas, the St. Tammany Parish Council has found it necessary for the purpose of protecting the public health, safety and general welfare, to designate the above described property as PF-1 (Public Facilities District) & AAO (Abita Airport Overlay District).

THE PARISH OF ST. TAMMANY HEREBY ORDAINS, in regular session convened that:

SECTION I: The zoning classification of the above described property is hereby changed from its present PF-1 (Public Facilities District) to an PF-1 (Public Facilities District) & AAO (Abita Airport Overlay District).

SECTION II: The official zoning map of the Parish of St. Tammany shall be and is hereby amended to incorporate the zoning reclassification specified in Section I hereof

REPEAL: All ordinances or parts of Ordinances in conflict herewith are hereby repealed.

SEVERABILITY: If any provision of this Ordinance shall be held to be invalid, such invalidity shall not affect other provisions herein which can be given effect without the invalid provision and to this end the provisions of this Ordinance are hereby declared to be severable.

EFFECTIVE DATE: This Ordinance shall become effective fifteen (15) days after adoption.

[REMAINDER OF PAGE INTENTIONALLY LEFT BLANK]

MOVED FOR ADOPTION BY: \_\_\_\_\_ SECONDED BY: \_\_\_\_\_

WHEREUPON THIS ORDINANCE WAS SUBMITTED TO A VOTE AND RESULTED IN THE FOLLOWING:

YEAS: \_\_\_\_\_

NAYS: \_\_\_\_\_

ABSTAIN: \_\_\_\_\_

ABSENT: \_\_\_\_\_

THIS ORDINANCE WAS DECLARED DULY ADOPTED AT A REGULAR MEETING OF THE PARISH COUNCIL ON THE 7 DAY OF April, 2011; AND BECOMES ORDINANCE COUNCIL SERIES NO \_\_\_\_\_.

\_\_\_\_\_  
MARTIN W. GOULD, JR., COUNCIL CHAIRMAN

ATTEST:

\_\_\_\_\_  
THERESA L. FORD, COUNCIL CLERK

\_\_\_\_\_  
KEVIN DAVIS, PARISH PRESIDENT

Published Introduction: February 24, 2011

Published Adoption: \_\_\_\_\_, 2011

Delivered to Parish President: \_\_\_\_\_, 2011 at \_\_\_\_\_

Returned to Council Clerk: \_\_\_\_\_, 2011 at \_\_\_\_\_

**EXHIBIT "A"**

**ZC10-08-103**

A certain portion of land located in Sections 1, 2, 3, 4, 5, 6, 7, 8, 9, 10, 11, 12, 13, 14, 15, 16, 17, 18, 19, 20, 21, 22, 23, 24, 25, 26, 27, 28, 29, 33, 34, & 35, Township 7 South, Range 12 East, and in Sections 32, 33, 34, 35 & 36, Township 6 South, Range 12 East, St. Tammany Parish, Louisiana, and being more fully described as follows:

Commence at the Section corner common to Sections 1, 2, 35 & 36, Township 6 South, Range 12 East, Thence proceed SOUTH 42 degrees 28 minutes 02 seconds EAST a distance of 1101.827 feet to a point; said point being the POINT OF BEGINNING; Thence proceed SOUTH 31 degrees 52 minutes 30 seconds EAST a distance of 2744.480 feet to a point; Thence proceed SOUTH 20 degrees 37 minutes 30 seconds EAST a distance of 2744.479 feet to a point; Thence proceed SOUTH 9 degrees 22 minutes 30 seconds EAST a distance of 2744.480 feet to a point; Thence proceed SOUTH 0 degrees 28 minutes 8 seconds EAST a distance of 6058.212 feet to a point; Thence proceed SOUTH 9 degrees 22 minutes 30 seconds WEST a distance of 2744.481 feet to a point; Thence proceed SOUTH 20 degrees 37 minutes 30 seconds WEST a distance of 2744.480 feet to a point; Thence proceed SOUTH 31 degrees 52 minutes 30 seconds WEST a distance of 2744.481 feet to a point; Thence proceed SOUTH 43 degrees 7 minutes 30 seconds WEST a distance of 2744.481 feet to a point; Thence proceed SOUTH 54 degrees 22 minutes 30 seconds WEST a distance of 2744.481 feet to a point; Thence proceed SOUTH 65 degrees 37 minutes 30 seconds WEST a distance of 2744.481 feet to a point; Thence proceed SOUTH 76 degrees 52 minutes 30 seconds WEST a distance of 2744.480 feet to a point; Thence proceed SOUTH 88 degrees 7 minutes 30 seconds WEST a distance of 2744.481 feet to a point; Thence proceed NORTH 80 degrees 37 minutes 30 seconds WEST a distance of 2744.481 feet to a point; Thence proceed NORTH 69 degrees 22 minutes 30 seconds WEST a distance of 2744.481 feet to a point; Thence proceed NORTH 58 degrees 7 minutes 30 seconds WEST a distance of 2744.480 feet to a point; Thence proceed NORTH 46 degrees 52 minutes 30 seconds WEST a distance of 2744.481 feet to a point; Thence proceed NORTH 35 degrees 37 minutes 30 seconds WEST a distance of 2744.481 feet to a point; Thence proceed NORTH 20 degrees 37 minutes 30 seconds WEST a distance of 4561.074 feet to a point; Thence proceed NORTH 2 degrees 40 minutes 36 seconds WEST a distance of 6801.223 feet to a point; Thence proceed NORTH 5 degrees 17 minutes 21 seconds EAST a distance of 2907.830 feet to a point; Thence proceed NORTH 18 degrees 45 minutes 0 seconds EAST a distance of 3654.732 feet to a point; Thence proceed NORTH 31 degrees 52 minutes 30 seconds EAST a distance of 2744.479 feet to a point; Thence proceed NORTH 45 degrees 0 minutes 0 seconds EAST a distance of 3654.733 feet to a point; Thence proceed NORTH 58 degrees 7 minutes 30 seconds EAST a distance of 2744.479 feet to a point; Thence proceed NORTH 71 degrees 15 minutes 0 seconds EAST a distance of 3654.732 feet to a point; Thence proceed NORTH 84 degrees 22 minutes 30 seconds EAST a distance of 2744.479 feet to a point; Thence proceed SOUTH 82 degrees 30 minutes 0 seconds EAST a distance of 3654.733 feet to a point; Thence proceed SOUTH 69 degrees 22 minutes 30 seconds EAST a distance of 2744.479 feet to a point; Thence proceed SOUTH 58 degrees 7 minutes 30 seconds EAST a distance of 2744.479 feet to a point; Thence proceed SOUTH 45 degrees 0 minutes 0 seconds EAST a distance of 3654.733 feet to a point; said point being the POINT OF BEGINNING.

**CASE NO.:**

ZC10-08-103

**REQUESTED CHANGE:**

From PF-1 (Public Facilities) District to PF-1 (Public Facilities) & AAO (Abita Airport Overlay) Districts

**LOCATION:**

Parcel located on the south side of LA Highway 36; Sections 1, 2, 3, 4, 5, 6, 7, 8, 9 10, 11, 12, 13, 14, 15, 16, 17, 18, 19, 20, 21, 22, 23, 24, 25, 26, 27, 28, 29, 33, 34, & 35, Township 7 South, Range 12 East, and in Sections 32, 33, 34, 35 & 36, Township 6 South, Range 12 East; Ward 4, 6 & 10, District 6 & 7

**SIZE:**

16,843 acres

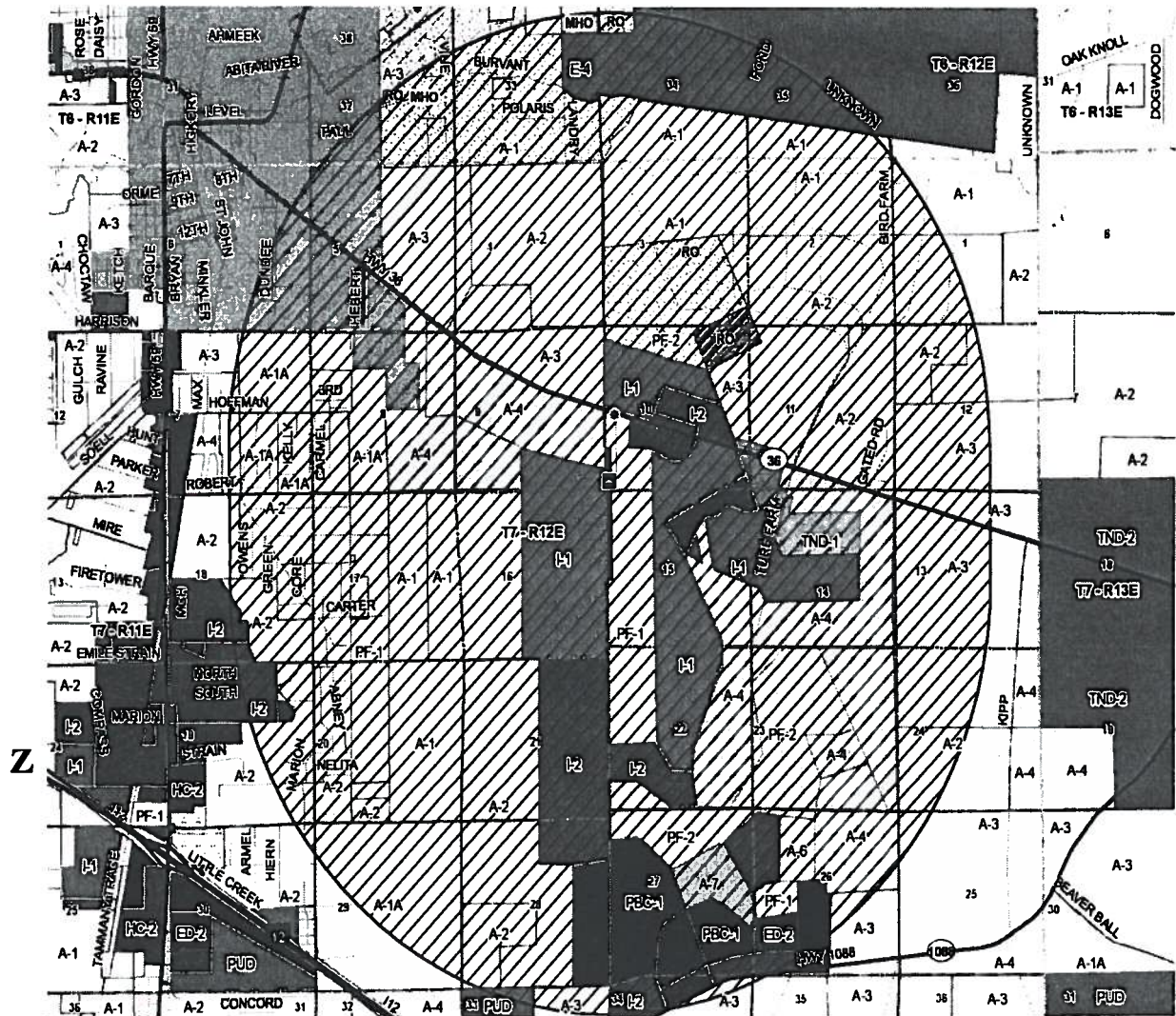

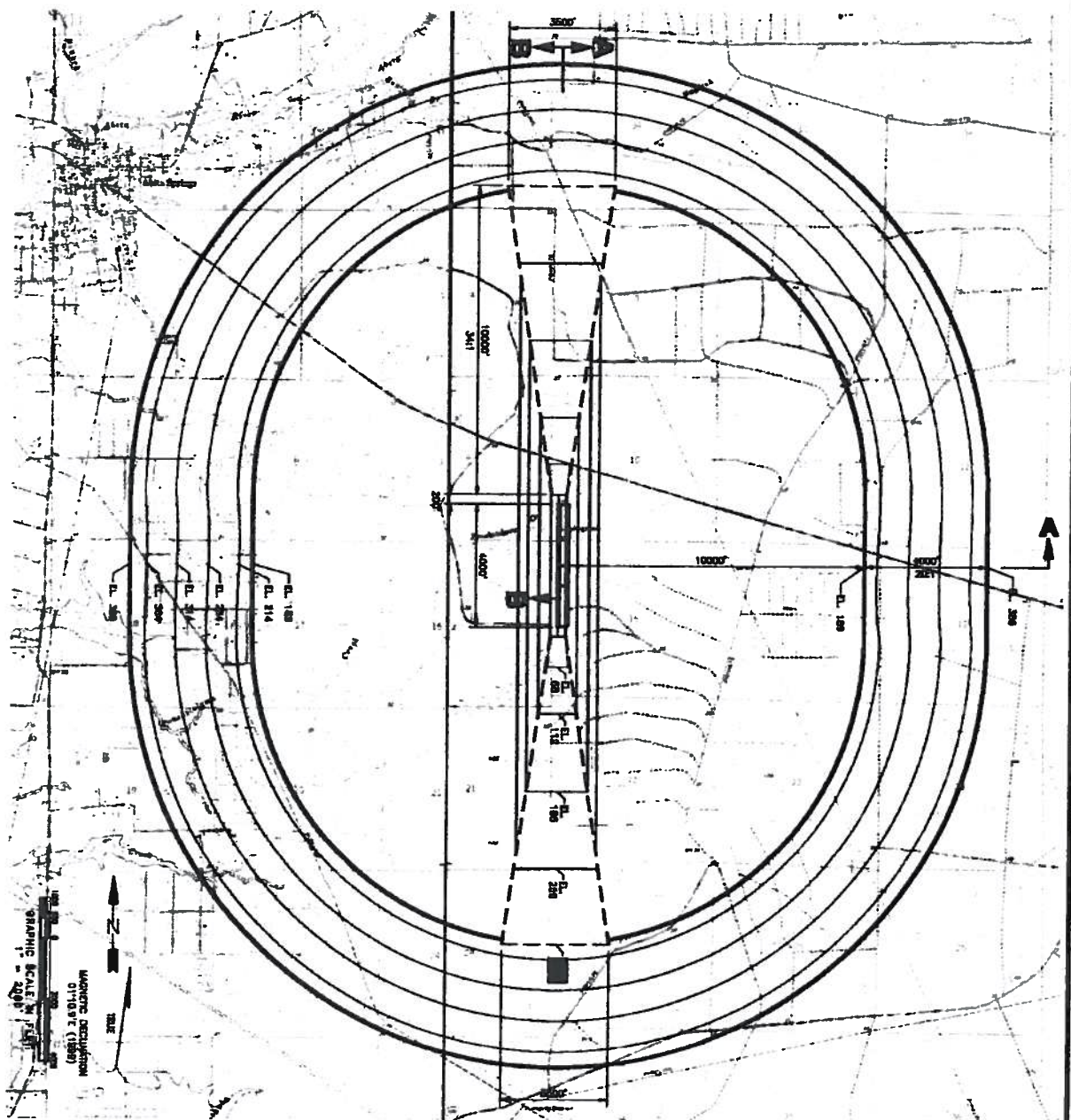

**AIRPORT AIRSPACE PLAN**  
PART 77 (AS SHOWN)

CONTRIBUTIONS INCLUDE ANY CORRECT 200' ASL AT THE CENTER, CENTERLINE AND 1/4  
OF AIRSPACE WITHIN AIRPORT AIRSPACE (CONSIDERING 1000' WITHIN A  
MILE) AND ANY FROM SUCH ADDITIONAL INSTRUMENTAL, PART OF INSTRUMENT FROM  
THE TO A PART OF THE.

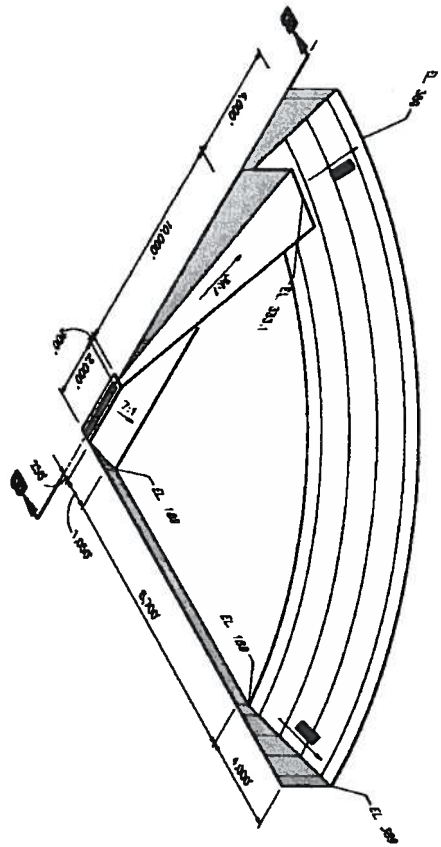

**SECTION A-A**  
**AIRPORT AIRSPACE**  
PART TO BE SUB

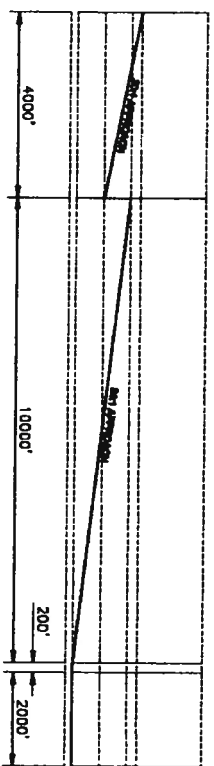

**SECTION B-B**  
**PROFILE VIEW**  
(7/1/89)

THE PREPARATION OF THESE DRAWINGS WAS FINANCED IN  
PART THROUGH A FUNDING GRANT FROM THE FEDERAL  
AVIATION ADMINISTRATION. THE DRAWINGS ARE THE PROPERTY  
OF THE AIRPORT AND SHALL BE RETURNED TO THE  
ADMINISTRATOR OF THE AIRPORT UPON REQUEST. THE  
DRAWINGS ARE NOT TO BE REPRODUCED OR COPIED  
WITHOUT THE WRITTEN PERMISSION OF THE AIRPORT  
ADMINISTRATOR. THE AIRPORT ADMINISTRATOR  
MAKES NO WARRANTY, REPRESENTATION OR  
GARANTEE OF ANY KIND FOR THE UNITED STATES TO  
USE OR REPRODUCE THESE DRAWINGS IN ANY MANNER  
WHICH IS NOT EXPRESSLY AUTHORIZED BY THE  
ADMINISTRATOR. THE AIRPORT ADMINISTRATOR IS  
NOT RESPONSIBLE FOR ANY DAMAGE TO PERSONS OR  
PROPERTY THAT MAY OCCUR IN ACCORDANCE WITH THE  
DRAWINGS HEREON.

NO.	DESCRIPTION	BY	DATE	STP APPROVAL
1	ISSUED TO THE AIRPORT ADMINISTRATION	DOB	1/23/07	
2	ISSUED TO THE AIRPORT ADMINISTRATION	DOB	12/28/06	

<b>LOUISIANA DEPARTMENT OF TRANSPORTATION &amp; DEVELOPMENT</b> AIRPORT DIVISION	
<b>AIRPORT LAYOUT PLAN UPDATE</b> ST. TAMMANY REGIONAL AIRPORT COVINGTON, LOUISIANA	
<b>AIRPORT AIRSPACE PLAN (PART 77)</b> BUDDHART HORN, IND.	
PROJECT NO. 780701-401 DATE 10/1/06	SHEET NO. 3 OF 8