

ST. TAMMANY PARISH COUNCIL

ORDINANCE

ORDINANCE CALENDAR NO: 6713

ORDINANCE COUNCIL SERIES NO: _____

COUNCIL SPONSOR: MR. DAVIS

PROVIDED BY: CIVIL DIVISION ADA

INTRODUCED BY: MR. DAVIS

SECONDED BY: MR. TOLEDANO

ON THE 8 DAY OF JULY, 2021

AN ORDINANCE TO DISSOLVE THE WADSWORTH COMMUNITY DEVELOPMENT DISTRICT, STATE OF LOUISIANA, UNDER THE AUTHORITY OF LOUISIANA REVISED STATUTE TITLE 33, CHAPTER 27-B, SECTION 9039.34(B)(3).

WHEREAS, the Wadsworth Community Development District, State of Louisiana ("Wadsworth CDD") was duly created pursuant to St. Tammany Parish Ordinance Council Series No. 09-1999 on February 5, 2009, upon petition of then-owners of Parcel 1 of Wadsworth Subdivision, being Wadsworth Estates, L.L.C., and pursuant to Chapter 27-B of Title 33 of the Louisiana Revised Statutes, as amended (La. R.S. 33:9039.11, *et seq.*, the "CDD Act"); and

WHEREAS, the boundaries of the Wadsworth CDD encompassed all of Parcel 1 of Wadsworth Subdivision, totaling 92.5034 acres, as set forth in Exhibits A and B incorporated in and made part of Ordinance Council Series No. 09-1999; and

WHEREAS, Ordinance Council Series No. 09-1999 identified the Members of the Board of Supervisors of the Wadsworth CDD as Jacqueline Geeck Edrington; Ashton J. Ryan, Jr.; Jolene Favalora Ryan; Warren Treme; and, Kevin Hingle; and

WHEREAS, subsequent to the adoption of Ordinance Council Series No. 09-1999, a Notice of Establishment of the Wadsworth CDD was recorded as Instrument No. 1717068 with the Clerk of Court of St. Tammany Parish, Louisiana; and

WHEREAS, Parcel 1 of Wadsworth Subdivision, consisting of 92.5034 acres, located in Section 33, Township 7 South, Range 12 East, St. Tammany Parish, Louisiana, was acquired by the current owner, Crosby Development Company, L.L.C. ("Crosby"), on June 10, 2021; and

WHEREAS, current owner, Crosby, and the above-identified Members of the Board of Supervisors of the Wadsworth CDD have submitted to St. Tammany Parish Government a joint Petition to Terminate/Dissolve the Wadsworth Community Development District, attached hereto as Exhibit A and made part of this Ordinance; and

WHEREAS, the joint Petition to Terminate/Dissolve the Wadsworth CDD avows that the Wadsworth CDD never operated in any manner whatsoever, including, but not limited to, the acquisition of any assets, the incurment of any debt, nor the installation of any infrastructure (drainage, utilities, roads, sewer, water, and the like) on Parcel 1 of Wadsworth Subdivision; and

WHEREAS, Louisiana Revised Statute 33:9039.34(b)(3) authorizes a community development district to be terminated or dissolved by the parish which created the district in the event the district has become inactive.

THE PARISH OF ST. TAMMANY HEREBY ORDAINS: that upon joint Petition to Terminate/Dissolve the Wadsworth Community Development District, attached hereto as Exhibit A and made part of this Ordinance, and under the authority of Louisiana Revised Statute Title 33, Chapter 27-B, Section 9039.34(b)(3), the Wadsworth Community Development District, State of Louisiana, created pursuant to Ordinance Council Series No. 09-1999, be and is hereby dissolved.

REPEAL: All ordinances or parts of Ordinances in conflict herewith are hereby repealed.

SEVERABILITY: If any provision of this Ordinance shall be held to be invalid, such invalidity shall not affect other provisions herein which can be given effect without the invalid provision and to this end the provisions of this Ordinance are hereby declared to be severable.

EFFECTIVE DATE: This Ordinance shall become effective fifteen (15) days after adoption.

MOVED FOR ADOPTION BY: _____ SECONDED BY: _____

WHEREUPON THIS ORDINANCE WAS SUBMITTED TO A VOTE AND RESULTED IN THE FOLLOWING:

YEAS: _____

NAYS: _____

ABSTAIN: _____

ABSENT: _____

THIS ORDINANCE WAS DECLARED DULY ADOPTED AT A REGULAR MEETING OF THE PARISH COUNCIL ON THE 5 DAY OF AUGUST , 2021 ; AND BECOMES ORDINANCE COUNCIL SERIES NO _____.

MICHAEL R. LORINO, JR. , COUNCIL CHAIRMAN

ATTEST:

KATRINA L. BUCKLEY, COUNCIL CLERK

MICHAEL B. COOPER, PARISH PRESIDENT

Published Introduction: JUNE 30 , 2021

Published Adoption: _____ , 2021

Delivered to Parish President: _____ , 2021 at _____

Returned to Council Clerk: _____ , 2021 at _____

**PETITION TO TERMINATE/DISSOLVE THE
WADSWORTH COMMUNITY DEVELOPMENT DISTRICT**

Petitioners herein consist of the following persons, namely:

**I. CURRENT OWNER OF PARCEL 1 OF WADSWORTH SUBDIVISION
("Wadsworth")**

CROSBY DEVELOPMENT COMPANY, L.L.C. , herein represented by its duly authorized Member, John L. Crosby, Jr., being the Owner of Parcel 1 (92.5034 acres) of Wadsworth Subdivision located in Section 33, Township 7 South, Range 12 East, St. Tammany Parish, Louisiana.

**II. MEMBERS OF BOARD OF SUPERVISORS OF THE WADSWORTH
COMMUNITY DEVELOPMENT DISTRICT ("CDD")**

- A. Jacqueline Geeck Edrington
- B. Ashton J. Ryan, Jr.
- C. Jolene Favalora Ryan
- D. Warren Treme
- E. Kevin Heigle

who, after being duly sworn, did depose and state that:

1. The CDD was created pursuant to St. Tammany Parish Council Ordinance No. 3982 adopted on February 5, 2009, pursuant to the Petition of the (then current) owners of Parcel 1 of Wadsworth Estates, being Wadsworth Estates, L.L.C., resulting in the issuance, and recordation of, that certain NOTICE OF ESTABLISHMENT OF THE WADSWORTH COMMUNITY DEVELOPMENT DISTRICT, a copy of which is annexed hereto as Exhibit "A".
2. The CDD never operated in any manner whatsoever, including, but not limited to, the acquisition of any assets, the incurment of any debt, nor the installation of any infrastructure (drainage, utilities, roads, sewer, water, and the like) on Parcel 1 of Wadsworth.
3. In light of the foregoing, and in accordance with La. R.S. 33:9039.34 (b), Petitioners declare that the CDD is, and has been, inactive, and accordingly they respectfully request that the St. Tammany Parish Council take appropriate action, via Ordinance, to dissolve and terminate The Wadsworth Community Development District, and thereafter so record said Ordinance in the public records of the Clerk of Court of St. Tammany Parish, Louisiana, said Ordinance to be cross referenced with Exhibit "A", which is recorded as Instrument No. 1717068.

Exhibit A

THUS DONE AND SIGNED, as shown below:

Jacqueline Geeck Edrington

Date: _____

Ashton J. Ryan Jr

Ashton J. Ryan, Jr.

Date: 6/2/21

Jolene Favalora Ryan

Jolene Favalora Ryan

Date: 6/2/21

Warren Treme

Date: _____

Kevin Heigle

Date: _____

CROSBY DEVELOPMENT COMPANY, L.L.C.

BY: _____

[Signature]
John L. Crosby, Jr., Authorized Member

Date: 6/2/21

THUS DONE AND SIGNED, as shown below:

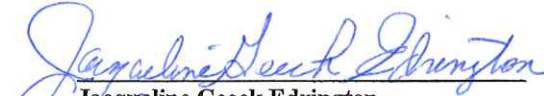
Jacqueline Geeck Edrington
Date: June 8, 2021

Ashton J. Ryan, Jr.
Date: _____

Jolene Favalora Ryan
Date: _____

Warren Treme
Date: 6.8.21

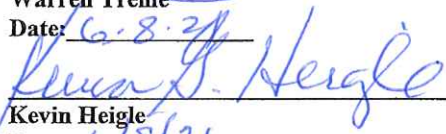
Kevin Heigle
Date: 6/8/21

CROSBY DEVELOPMENT COMPANY, L.L.C.

BY: _____
John L. Crosby, Jr., Authorized Member
Date: _____



**NOTICE OF ESTABLISHMENT OF THE
WADSWORTH COMMUNITY DEVELOPMENT DISTRICT**

NOTICE IS HEREBY GIVEN in accordance with Chapter 27-B of Title 33 of the Louisiana Revised Statutes of 1950, as amended (La. R.S. 33:9039.12 *et seq.*) (the "Act"), that the St. Tammany Parish Council (the "Parish") adopted Ordinance No. 3982 on February 5, 2009, effective February 20, 2009, creating a community development district designated "Wadsworth Community Development District, State of Louisiana" (the "District").

The District comprises approximately 92.5 acres generally located east of Mandeville, Louisiana, immediately to the north of the intersection of Interstate 12 and La. Hwy. 1088.

NOTICE IS FURTHER GIVEN to all existing residents of the District, and to all prospective residents of the District, that the District intends to utilize its authority under the Act to impose and levy assessments on the property in the District to pay the construction, operation and maintenance costs of certain public facilities and services of the District, which assessments shall be set annually by the governing board of the District and will be in addition to Parish and other local governmental taxes and assessments and all other taxes and assessments provided for by law.

All immovable property in the District is presently owned by Wadsworth Estates, L.L.C. and the owner has consented in writing to the establishment of the District.

The legal description of the District is as follows:

A CERTAIN PORTION OF GROUND, situated in the PARISH OF ST. TAMMANY, State of Louisiana, located in Section 33, Township 7 South, Range 12 East, comprised of a portion of the Northwest Quarter of Section 33, designated as WADSWORTH SUBDIVISION, and being more fully described as follows:

Begin at the Northwest corner of Section 33, Township 7 South, Range 12 East;
 Thence proceed along the northerly line of the aforesaid Section 33, South 89 degrees, 31 minutes, 47 seconds East, a distance of 996.86 feet to a point;
 Thence proceed along the southerly line of a 30' United Gas Pipeline right-of-way, South 59 degrees, 04 minutes, 50 seconds East, a distance of 1,286.84 feet to a point; thence proceed South 01 degrees, 55 minutes, 27 seconds West, a distance of 627.38 feet to a point of curve;
 Thence proceed along a curve to the left, in a southeasterly direction, with a radius of 12 feet, having an arc length of 14.71 feet, along a chord bearing of South 33 degrees, 11 minutes, 50 seconds East, a distance of 13.81 feet to a point of continuous curve;
 Thence proceed along a curve to the left, in a southeasterly direction, with a radius of 135.61 feet, having an arc length of 50.21 feet, along a chord bearing of South 78 degrees, 55 minutes, 27 seconds East, a distance of 49.92 feet to a point of tangent; Thence proceed South 89 degrees, 31 minutes, 47 seconds East, a distance of 185.33 feet to a point located on the westerly right-of-way line of Wadsworth Parkway (a 100' ROW);
 Thence proceed along the aforesaid right-of-way line, South 01 degrees, 55 minutes, 27 seconds West, a distance of 280.09 feet to a point; thence proceed North 89 degrees, 31 minutes, 47 seconds West, a distance of 178.22 feet to a point of curve;

B:\ORC\Wadsworth\CDD\Notice of Establishment.doc

St. Tammany Parish 124
 Instrmnt #: 1717068
 Registry #: 1893844 SHC
 03/04/2009 10:53:00 AM
 MB X CB MI UCC

Thence proceed along a curve to the right, in a northwesterly direction, with a radius of 415.61 feet, having an arc length of 209.40 feet, along a chord bearing of North 75 degrees, 05 minutes, 46 seconds West, a distance of 207.19 feet to a point;

Thence proceed South 63 degrees, 55 minutes, 43 seconds West, a distance of 70.82 feet to a point;

Thence proceed North 89 degrees, 31 minutes, 47 seconds West, a distance of 32.41 feet to a point;

Thence proceed South 01 degrees, 55 minutes, 27 seconds West, a distance of 157.30 feet to a point of curve;

Thence proceed along a curve to the right, in a southwesterly direction, with a radius of 100 feet, having an arc length of 77.96 feet, along a chord bearing of South 24 degrees, 15 minutes, 30 seconds West, a distance of 76 feet to a point of reverse curve;

Thence proceed along a curve to the left, in a southwesterly direction, with a radius of 490 feet, having an arc length of 110.57 feet, along a chord bearing of South 40 degrees, 07 minutes, 41 seconds West, a distance of 110.34 feet to a point of tangent;

Thence proceed South 33 degrees, 39 minutes, 49 seconds West, a distance of 239.42 feet to a point of curve;

Thence proceed along a curve to the right, in a southwesterly direction, with a radius of 180 feet, having an arc length of 149.11 feet, along a chord bearing of South 57 degrees, 23 minutes, 37 seconds West, a distance of 144.88 feet to a point of tangent;

Thence proceed South 81 degrees, 07 minutes, 26 seconds West, a distance of 373.17 feet to a point of curve;

Thence proceed along a curve to the right, in a northwesterly direction, with a radius of 440 feet, having an arc length of 206.82 feet, along a chord bearing of North 85 degrees, 24 minutes, 38 seconds West, a distance of 204.92 feet to a point of reverse curve; Thence proceed along a curve to the left, in a southwesterly direction, with a radius of 340 feet, having an arc length of 280.61 feet, along a chord bearing of South 84 degrees, 24 minutes, 40 seconds West, a distance of 272.71 feet to a point of reverse curve;

Thence proceed along a curve to the right, in a northwesterly direction, with a radius of 260 feet, having an arc length of 410.10 feet, along a chord bearing of North 74 degrees, 02 minutes, 45 seconds West, a distance of 368.89 feet to a non-tangent point;

Thence proceed North 68 degrees, 32 minutes, 54 seconds West, a distance of 292.49 feet to a point on the common section line of Sections 32 and 33, Township 7 South, Range 12 East;

Thence proceed along the aforesaid section line, North 00 degrees, 06 minutes, 55 seconds West, a distance of 2,022.74 feet to the POINT OF BEGINNING.

* * * * *

WADSWORTH COMMUNITY DEVELOPMENT
DISTRICT, STATE OF LOUISIANA

ST. TAMMANY PARISH COUNCIL

ORDINANCE

ORDINANCE CALENDAR NO. 3982 ORDINANCE COUNCIL SERIES NO. 09-1999

COUNCIL SPONSOR: BINDER/DAVIS PROVIDED BY: PRESIDENT/LEGAL

INTRODUCED BY: MR. HAMAUEI SECONDED BY: MR. GOULD

ON THE 8TH DAY OF JANUARY, 2009

ORDINANCE GRANTING THE PETITION FOR ESTABLISHMENT OF THE WADSWORTH COMMUNITY DEVELOPMENT DISTRICT, STATE OF LOUISIANA, UNDER THE AUTHORITY OF CHAPTER 27-B OF TITLE 33 OF THE LOUISIANA REVISED STATUTES OF 1950, AS AMENDED (LA. R.S. 33:9039.11, ET SEQ.); AND PROVIDING FOR OTHER MATTERS IN CONNECTION THEREWITH.

WHEREAS, Chapter 27-B, Title 33 of the Louisiana Revised Statutes of 1950, as amended (La. R.S. 33:9039.11, *et seq.*) (the "CDD Act") allows the governing authority of parishes to create community development districts to carry out the purposes of the Act, which community development districts possess such powers and authority and have such duties as provided by the Act and other law; and

WHEREAS, in accordance with the Act, (a) Wadsworth Estates, L.L.C., has filed a petition for the creation of a community development district to be called the "Wadsworth Community Development District, State of Louisiana" (the "District"), which petition is attached to this Ordinance as Exhibit A; (b) the Parish of St. Tammany, State of Louisiana (the "Parish"), acting through this Parish Council as its governing authority, has given notice of its intention to hold a public hearing, (c) an appropriate notice of public hearing was published in four (4) successive weekly issues of the Parish's official journal by the Petitioner, and (d) a public hearing on the creation of the District was held, at which public hearing no objections were received with respect to the creation of the District; and

WHEREAS, in accordance with the Act, this Parish Council has considered the record of the public hearing and any other relevant factors in making its determination to grant the petition for the establishment of the District and now desires to avail itself of the Act to create the District in accordance with La. R.S. 33:9039.14.

THE PARISH OF ST. TAMMANY HEREBY ORDAINS that:

SECTION 1. Creation of District. Under the authority of La. R.S. 33:9039.14 there is hereby created a community development district within the Parish, to be named the "Wadsworth Community Development District, State of Louisiana," having the geographical boundaries set forth in Exhibit B hereto.

SECTION 2. Boundaries of District. The boundaries of the District are as set forth in Exhibit B attached hereto, which Exhibit B is hereby incorporated in and made a part of this Ordinance.

SECTION 3. Members of Board of Supervisors. The following persons are designated as the initial members of the board of supervisors of the District, and shall serve in that office until replaced by elected members as provided in R.S. 33:9039.15(B)(1):

<u>Name</u>	<u>Mailing Address</u>
Jacqueline Greeck Edrington*	20066 Tammany Avenue Covington, Louisiana 70435
Ashton J. Ryan, Jr.	151 Chateau St. Michel Kenner, Louisiana 70065
Jolene Favolora Ryan	151 Chateau St. Michel Kenner, Louisiana 70065
Warren Treme	20 Veterans Blvd, Suite 102 Kenner, Louisiana 70062
Kevin Heigle	3525 Tolmes Drive Metairie, Louisiana 70002

*As required by R.S. 33:9039.15(A), Ms. Edrington is a resident of the area immediately adjacent to the district.

ORDINANCE CALENDAR NO. 3982

ORDINANCE COUNCIL SERIES NO. 09-1999

PAGE 2 OF 2

SECTION 4. Authorization of Officers. The Parish President and the Council Clerk are hereby authorized to do any and all things necessary and incidental to carry out the provisions of this Ordinance.

SECTION 5. Severability. If any provision of this ordinance shall be held to be illegal or invalid, such illegality or invalidity shall not affect any other provision of this ordinance, but this ordinance shall be construed and enforced as if such illegal or invalid provisions had not been contained herein. Any constitutional or statutory provision enacted after the date of this ordinance which validates or makes legal any provision of this ordinance which would not otherwise be valid or legal, shall be deemed to apply to this ordinance.

SECTION 6. Repealer. All ordinances or resolutions, or parts thereof, in conflict herewith are hereby repealed.

SECTION 7. Publication; Effective Date. This ordinance shall be published one time in the official journal of the Parish, and shall become effective as provided by law.

MOVED FOR ADOPTION BY MR. HAMAUEI SECONDED BY MR. BURKHALTER

WHEREUPON THIS ORDINANCE WAS SUBMITTED TO A VOTE AND RESULTED IN THE FOLLOWING:

YEAS: DEAN, THOMPSON, GOULD, CRAWFORD-HOWELL, HAMAUEI, CANULETTE, BELLISARIO, BILLIOT, STEFANCIK, ARTIGUE, BURKHALTER (11)

NAYS: (0)

ABSTAIN: (0)

ABSENT: COOPER, FALCONER, BINDER (3)

THIS ORDINANCE WAS DECLARED ADOPTED AT A REGULAR MEETING OF THE PARISH COUNCIL ON THE 5TH DAY OF FEBRUARY 2009; AND BECOMES ORDINANCE COUNCIL SERIES NO. 09-1999.

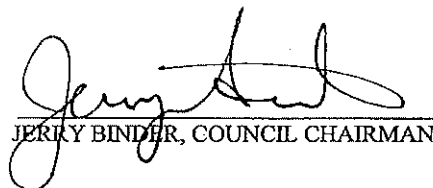
JERRY BINDER, COUNCIL CHAIRMAN

ATTEST:

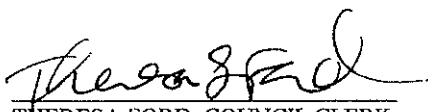
THERESA FORD, COUNCIL CLERK

KEVIN DAVIS, PARISH PRESIDENT

Published introduction: November 27, 2008

Published adoption on: February 26, 2009

Delivered to Parish President Council Chairman: Feb. 12th, 2009 @ 2:17PM

Returned to Council Clerk: Feb. 13th, 2009 @ 3:30PM

EXHIBIT "A" ORDINANCE CALENDAR NO. 3982

**PETITION TO CREATE THE WADSWORTH COMMUNITY
DEVELOPMENT DISTRICT
PURSUANT TO LA. R.S. 33:9039.14**

This petition of Wadsworth Estates, LLC, which is being delivered to the St. Tammany Parish Council, the governing authority of the Parish of St. Tammany, State of Louisiana, pursuant to La. R.S. 33:9039.14, respectfully requests that said Parish Council proceed with the creation of a community development district pursuant to Chapter 27-B of Title 33 of the Louisiana Revised Statutes of 1950, as amended (the "CDD Act"). The undersigned petitioners are the sole owners of all of the property in the proposed district. In accordance with the CDD Act, the following information is provided:

1. Boundaries of District: The boundaries of the proposed district are as follows:
A CERTAIN PORTION OF GROUND, situated in the PARISH OF ST. TAMMANY, State of Louisiana, located in Section 33, Township 7 South, Range 12 East, comprised of a portion of the Northwest Quarter of Section 33, designated as WADSWORTH SUBDIVISION, and being more fully described as follows:
Begin at the Northwest corner of Section 33, Township 7 South, Range 12 East;
Thence proceed along the northerly line of the aforesaid Section 33, South 89 degrees, 31 minutes, 47 seconds East, a distance of 996.86 feet to a point; thence proceed along the southerly line of a 30' United Gas Pipeline right-of-way, South 59 degrees, 04 minutes, 50 seconds East, a distance of 1,286.84 feet to a point;
Thence proceed South 01 degrees, 55 minutes, 27 seconds West, a distance of 627.38 feet to a point of curve;
Thence proceed along a curve to the left, in a southeasterly direction, with a radius of 12 feet, having an arc length of 14.71 feet, along a chord bearing of South 33 degrees, 11 minutes, 50 seconds East, a distance of 13.81 feet to a point of continuous curve;
Thence proceed along a curve to the left, in a southeasterly direction, with a radius of 135.61 feet, having an arc length of 50.21 feet, along a chord bearing of South 78 degrees, 55 minutes, 27 seconds East, a distance of 49.92 feet to a point of tangent;
Thence proceed South 89 degrees, 31 minutes, 47 seconds East, a distance of 185.33 feet to a point located on the westerly right-of-way line of Wadsworth Parkway (a 100' ROW);
Thence proceed along the aforesaid right-of-way line, South 01 degrees, 55 minutes, 27 seconds West, a distance of 280.09 feet to a point;
Thence proceed North 89 degrees, 31 minutes, 47 seconds West, a distance of 178.22 feet to a point of curve;
Thence proceed along a curve to the right, in a northwesterly direction, with a radius of 415.61 feet, having an arc length of 209.40 feet, along a chord bearing of North 75 degrees, 05 minutes, 46 seconds West, a distance of 207.19 feet to a point;
Thence proceed South 63 degrees, 55 minutes, 43 seconds West, a distance of 70.82 feet to a point;
Thence proceed North 89 degrees, 31 minutes, 47 seconds West, a distance of 32.41 feet to a point;
Thence proceed South 01 degrees, 55 minutes, 27 seconds West, a distance of 157.30 feet to a point of curve;
Thence proceed along a curve to the right, in a southwesterly direction, with a radius of 100 feet, having an arc length of 77.96 feet, along a chord bearing of South 24 degrees, 15 minutes, 30 seconds West, a distance of 76 feet to a point of reverse curve;
Thence proceed along a curve to the left, in a southwesterly direction, with a radius of 490 feet, having an arc length of 110.57 feet, along a chord bearing of South 40 degrees, 07 minutes, 41 seconds West, a distance of 110.34 feet to a point of tangent;
Thence proceed South 33 degrees, 39 minutes, 49 seconds West, a distance of 239.42 feet to a point of curve;
Thence proceed along a curve to the right, in a southwesterly direction, with a radius of 180 feet, having an arc length of 149.11 feet, along a chord bearing of South 57 degrees, 23 minutes, 37 seconds West, a distance of 144.88 feet to a point of tangent;
Thence proceed South 81 degrees, 07 minutes, 26 seconds West, a distance of 373.17 feet to a point of curve;

Thence proceed along a curve to the right, in a northwesterly direction, with a radius of 440 feet, having an arc length of 206.82 feet, along a chord bearing of North 85 degrees, 24 minutes, 38 seconds West, a distance of 204.92 feet to a point of reverse curve;
Thence proceed along a curve to the left, in a southwesterly direction, with a radius of 340 feet, having an arc length of 280.61 feet, along a chord bearing of South 84 degrees, 24 minutes, 40 seconds West, a distance of 272.71 feet to a point of reverse curve;
Thence proceed along a curve to the right, in a northwesterly direction, with a radius of 260 feet, having an arc length of 410.10 feet, along a chord bearing of North 74 degrees, 02 minutes, 45 seconds West, a distance of 368.89 feet to a non-tangent point;
Thence proceed North 68 degrees, 32 minutes, 54 seconds West, a distance of 292.49 feet to a point on the common section line of Sections 32 and 33, Township 7 South, Range 12 East;
Thence proceed along the aforesaid section line, North 00 degrees, 06 minutes, 55 seconds West, a distance of 2,022.74 feet to the POINT OF BEGINNING.

The above described portion of ground contains 92.5034 acres more or less.

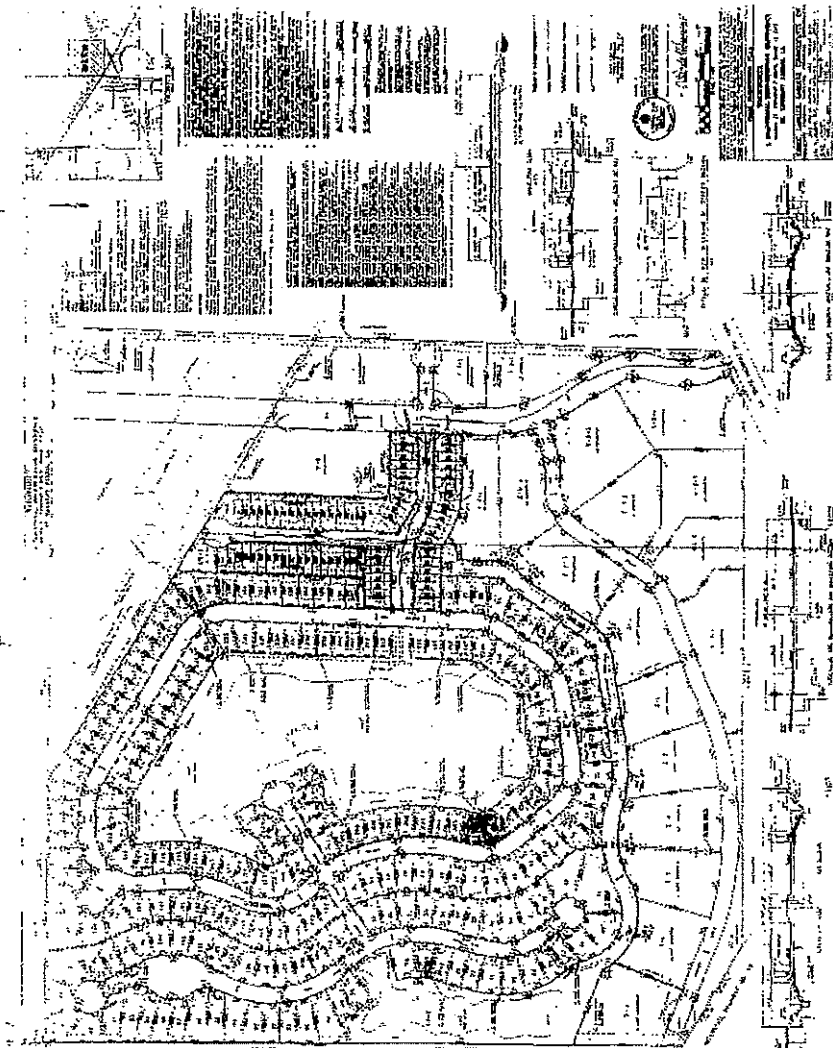

2. Consent. The undersigned are the owners of 100% of the immovable property in the proposed district, and hereby consents to the establishment of the district and the inclusion of the property described in Paragraph 1 above in the proposed district.

3. Members of Board of Supervisors. The following five (5) persons are designated as the initial members of the board of supervisors of the district, and shall serve in that office until replaced by elected members as provided in R.S. 33:9039.15(B)(1):

Exhibit A

<u>Name</u>	<u>Mailing Address</u>
Jacqueline Giceck Edrington*	20066 Tammany Avenue Covington, Louisiana 70435
Ashton J. Ryan, Jr.	151 Chateau St. Michel Kenner, Louisiana 70065
Jolene Favalora Ryan	151 Chateau St. Michel Kenner, Louisiana 70065
Warren Tremc	20 Veterans Boulevard, Suite 102 Kenner, Louisiana 70062
Kevin Heigle	3525 Tolmes Drive Metairie, Louisiana 70002

*As required by R.S. 33:9039.15(A), Ms. Edrington is a resident of the area immediately adjacent to the district.

4. Name of District. The district shall be called the "Wadsworth Community Development District, State of Louisiana."

5. Map of District. A map of the district, showing existing infrastructure, if any, is attached as Exhibit B attached to this petition:

6. Proposed Services and Estimated Construction Costs. Based upon available data, the district proposes to provide the following services, and the proposed timetable for construction of same is as follows:

A Schedule of values		B	
1Y 2 CB	\$17,290.00	WATER WELL	\$550,000.00
1Y 3 CB	\$25,977.00	WASTE WATER TREATMENT PLANT	\$850,000.00
DRAIN MH	\$21,000.00	STREET AND CURBS	\$1,300,000.00
DROP INLETS	\$130,000.00		
15" PVC	\$22,632.00	TOTAL	\$2,500,000.00
15" RCP	\$46,728.00		
18" PVC	\$96,741.00		
18" RCP	\$7,600.00		
21" PVC	\$46,920.00		
24" PVC	\$40,443.00		
24" RCP	\$2,040.00	C	
27" PVC	\$30,820.00	LAND ACQUISITION	\$1,500,000.00
30" PVC	\$40,425.00	LEGAL	\$73,500.00
30" RCP	\$3,600.00	ENGINEERING	\$162,000.00
36" PVC	\$46,740.00	INTEREST CHARGE	\$960,000.00
36" RCP	\$10,080.00	INSURANCE	\$48,000.00
48" PVC	\$27,600.00	SURVEY	\$32,000.00
21" RCPA	\$2,120.00	TOTAL	\$2,775,500.00
24" RCPA	\$43,200.00		
30" RCPA	\$2,920.00	TOTALS: (A)	\$4,688,311.00
36" RCPA	\$3,760.00	(B)	\$2,500,000.00
48" RCPA	\$14,000.00	(C)	\$2,775,500.00
FIRE HYDRANTS	\$83,200.00	TOTAL	\$9,963,811.00
21" POLYETHYLENE	\$11,224.00		
31" HC	\$118,006.00		
6" WATERLINE	\$5,202.00		
8" WATERLINE	\$488,435.00		
12" WATERLINE	\$38,352.00		
HOUSE CONNECTIONS	\$11,445.00		
DOUBLE CONNECTIONS	\$10,800.00		
SEWER STRUCTURE	\$137,200.00		
1.5" SFM	\$16,813.00		
2" SFM	\$12,141.00		
3" SFM	\$17,374.00		
4" SFM	\$17,040.00		
6" SFM	\$47,695.00		
8" SEWERLINE	\$234,500.00		
8" SEWERLINE	\$317,312.00		
CUT OPEN DITCHES	\$60,216.00		
CLEARING	\$288,800.00		
LAYOUT	\$100,000.00		
MOBILIZATION	\$73,000.00		
STOCKPILE PIPE	\$34,404.00		
STOCKPILE DRAIN	\$158,536.00		
BOND	\$39,788.00		
POND EXCAVATION	\$1,200,000.00		
STOCKPILE BASINS	\$38,788.00		
STOCKPILE SEWER PIPE	\$34,404.00		
CLEARING SITE LESS BURNING	\$381,000.00		
TOTAL	\$4,688,311.00		

CONSTRUCTION TIMETABLE

Construction Item	Estimated Completion Date
Development of Main Boulevard	December 2009
Drainage, Water and Waste Water	June 2009

WHEREFORE, the petitioner respectfully requests that the St. Tammany Parish Council advertise for and hold the public hearing called for in La. R.S. 33:9039.14(B) within forty-five (45) days after the filing of this petition, unless an extension of time is requested by the undersigned and granted by the said Parish Council. Notice of the hearing shall be published in the official journal of the Parish of St. Tammany, State of Louisiana once a week for the four (4) successive weeks immediately prior to the hearing, as provided by La. R.S. 33:9039.14(B).

PETITIONERS:

By: *Ashton J Ryan Jr*
Name: *Ashton J Ryan Jr*

By: *W*
Name: *WARREN G TREME*

Dated: October 21, 2008

EXHIBIT "B" ORDINANCE CALENDAR NO. 3982

MAP OF DISTRICT

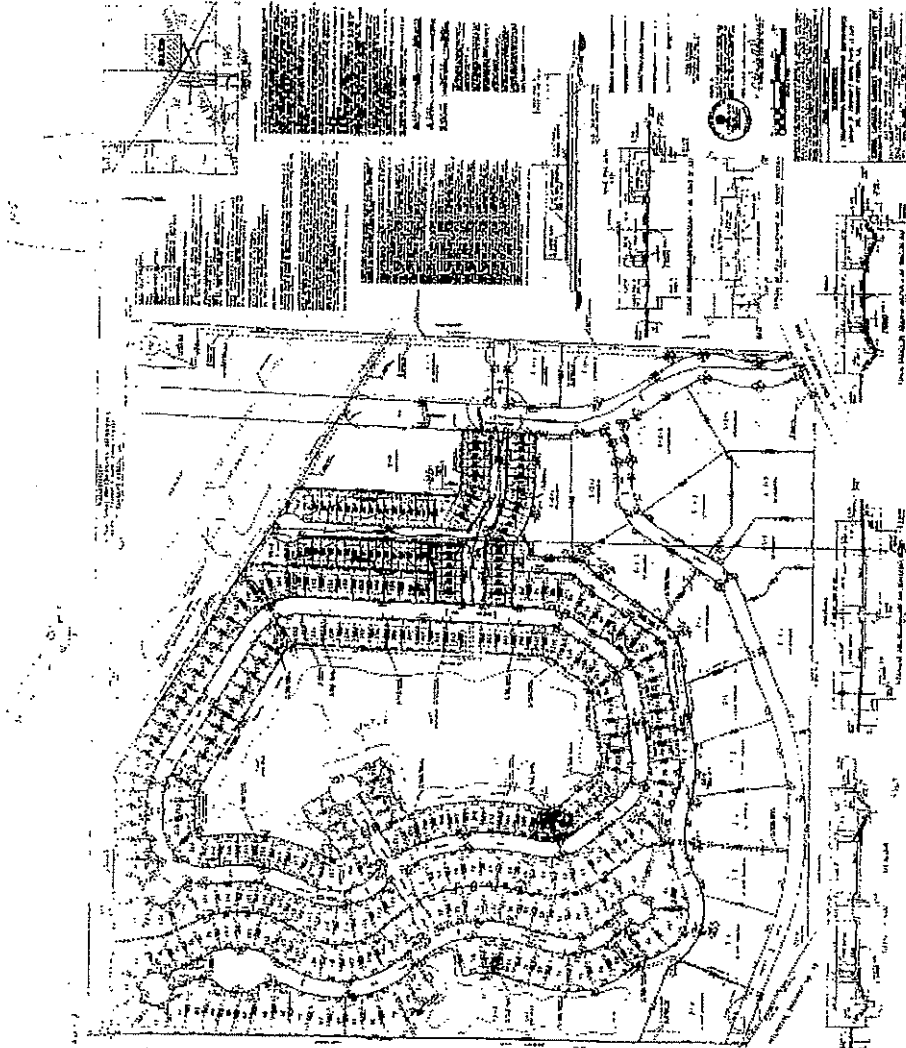

STATE OF LOUISIANA

PARISH OF ST. TAMMANY

I, the undersigned Council Clerk of the St. Tammany Parish Council do hereby certify that the foregoing eight (8) pages constitute a true and correct copy of the proceedings taken by said Council on Feb 5, 2009, to create the Wadsworth Community Development District, State of Louisiana, as authorized by Chapter 27-B of Title 33 of the Louisiana Revised Statutes of 1950, as amended; and providing for other matters in connection with the foregoing.

IN FAITH WHEREOF, witness my official signature and the impress of the official seal of said Parish on this, the 2nd day of March, 2009.



THERESA FORD, COUNCIL CLERK