

ST. TAMMANY PARISH COUNCIL

ORDINANCE

ORDINANCE CALENDAR NO: 6683

ORDINANCE COUNCIL SERIES NO: \_\_\_\_\_

COUNCIL SPONSOR: LORINO/COOPER

PROVIDED BY: CIVIL DIVISION ADA

INTRODUCED BY: \_\_\_\_\_

SECONDED BY: \_\_\_\_\_

ON THE 3 DAY OF JUNE , 2021

ORDINANCE TO DECLARE CERTAIN PARCELS NEAR THE INTERSECTION OF THE TAMMANY TRACE AND U.S. HWY 190 AS SURPLUS PROPERTY AND TO AUTHORIZE THE TRANSFER OF SAID PROPERTY TO THE STATE OF LOUISIANA, DEPARTMENT OF TRANSPORTATION AND DEVELOPMENT (WARD 3, DISTRICT 2)

WHEREAS, St. Tammany Parish owns the property identified as parcels 3-1 and 3-2 in the attachment hereto; and

WHEREAS, the State of Louisiana, Department of Transportation and Development, has identified this property as being desirable for construction of the U.S. 190: La 437 - U.S. 190 Business project; and

WHEREAS, Parish desires to transfer the fee parcels via cash sale for appraised value.

THE PARISH OF ST. TAMMANY HEREBY ORDAINS: that the property described in the attachment hereto as parcels 3-1 and 3-2 are surplus property to be sold to the State of Louisiana, Department of Transportation and Development for appraised value and/or by any other method provided by Louisiana law; and

BE IT FURTHER ORDAINED: that pursuant to all applicable provisions of law, the Office of the Parish President is authorized to assess, deem, designate and determine that such immovable property to be sold is now surplus; and

BE IT FURTHER ORDAINED: that the Office of the Parish President tis authorized to exercise its discretion in selling the property for the purpose of facilitating the construction of the project; and

BE IT FURTHER ORDAINED: that all actions previously taken by the Office of the Parish President in furtherance of the actions contemplated herein are ratified and accepted accordingly.

REPEAL: All ordinances or parts of Ordinances in conflict herewith are hereby repealed.

SEVERABILITY: If any provision of this Ordinance shall be held to be invalid, such invalidity shall not affect other provisions herein which can be given effect without the invalid provision and to this end the provisions of this Ordinance are hereby declared to be severable.

EFFECTIVE DATE: This Ordinance shall become effective fifteen (15) days after adoption.

MOVED FOR ADOPTION BY: \_\_\_\_\_ SECONDED BY: \_\_\_\_\_

WHEREUPON THIS ORDINANCE WAS SUBMITTED TO A VOTE AND RESULTED IN THE FOLLOWING:

YEAS: \_\_\_\_\_

NAYS: \_\_\_\_\_

ABSTAIN: \_\_\_\_\_

ABSENT: \_\_\_\_\_

THIS ORDINANCE WAS DECLARED DULY ADOPTED AT A REGULAR MEETING OF THE PARISH COUNCIL ON THE 8 DAY OF JULY, 2021; AND BECOMES ORDINANCE COUNCIL SERIES NO \_\_\_\_\_.

\_\_\_\_\_  
MICHAEL R. LORINO, JR., COUNCIL CHAIRMAN

ATTEST:

\_\_\_\_\_  
KATRINA L. BUCKLEY, COUNCIL CLERK

\_\_\_\_\_  
MICHAEL B. COOPER, PARISH PRESIDENT

Published Introduction: MAY 26, 2021

Published Adoption: \_\_\_\_\_, 2021

Delivered to Parish President: \_\_\_\_\_, 2021 at \_\_\_\_\_

Returned to Council Clerk: \_\_\_\_\_, 2021 at \_\_\_\_\_





STATE OF LOUISIANA  
 DEPARTMENT OF TRANSPORTATION AND DEVELOPMENT  
 RIGHT OF WAY PROPERTY MAP OF PROPOSED  
 STATE HIGHWAY  
 STATE PROJECT NO. H.001344  
 US 190: LA 437 - US 190 BUS (PH 1)  
 ST. TAMMANY PARISH  
 US 190

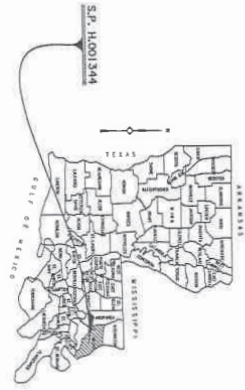

LOCATION OF WORK		
CONTROL SECTION	BEGIN	END
	0.198	0.330
	1.276	2.309
	2.79-01	

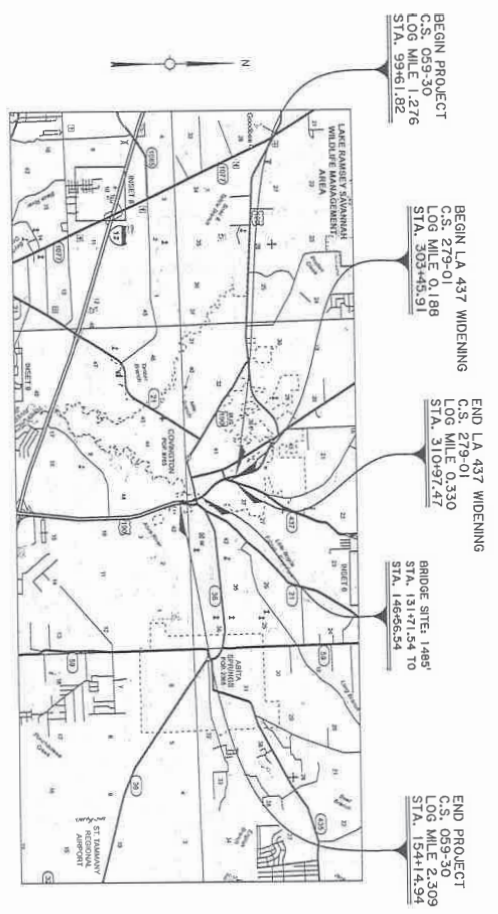

LAYOUT MAP  
 SCALE: 1 INCH = 1 MILE



FILE NO. 021505 ROW SHEET NO. 0110

DATE	REVISION DESCRIPTION		RIGHT OF WAY MAP STATE PROJECT NO. H.001344 US 190: LA 437 - US 190 BUS (PH 1) ST. TAMMANY PARISH US 190	COMPUTED BY: BSH CHECKED BY: BSH DATE: 12/14/2020 SCALE: 1" = 1 MILE	PARISH: ST. TAMMANY CONTROL SECTION: 059-30 & 279-01 STATE PROJECT: H.001344
------	----------------------	--	--	---	--

### **Ordinance Administrative Comment**

ORDINANCE TO DECLARE CERTAIN PARCELS NEAR THE INTERSECTION OF THE TAMMANY TRACE AND U.S. HWY 190 AS SURPLUS PROPERTY AND TO AUTHORIZE THE TRANSFER OF SAID PROPERTY TO THE STATE OF LOUISIANA, DEPARTMENT OF TRANSPORTATION AND DEVELOPMENT (WARD 3, DISTRICT 2)

LaDOTD has requested Parish's assistance by selling the parcels identified as 3-1 and 3-2 to LaDOTD for advancement of the project for expansion of U.S. Highway 190 over the Bogue Falaya River. Both parcels will be sold to LaDOTD for appraised value and in full ownership.