

ST. TAMMANY PARISH COUNCIL

ORDINANCE

ORDINANCE CALENDAR NO: 6883

ORDINANCE COUNCIL SERIES NO: _____

COUNCIL SPONSOR: BINDER/COOPER

PROVIDED BY: PUBLIC WORKS

INTRODUCED BY: _____

SECONDED BY: _____

ON THE 3 DAY OF FEBRUARY , 2022

AN ORDINANCE TO CORRECT THE ROAD AND DRAINAGE INVENTORY TO INCLUDE DENTY CRAWFORD RD. (R08F112) (WARD 8, DISTRICT 9)

WHEREAS, the St. Tammany Parish Selective Road and Drainage Inventories require updating/amending periodically to provide for the corrections/additions/deletions to the road and drainage inventories based upon the recommendation of the Department of Engineering, Director of Public Works, 911 Facilitator, or Certificate of Road and/or Drainage Maintenance by Area Foreman, Act of Exchange and/or Act of Donation.

THE PARISH OF ST. TAMMANY HEREBY ORDAINS: The St. Tammany Parish Selective Road and Drainage Maintenance System Inventory is amended as follows:

1. Add Denty Crawford Rd. (R08F112) for approximately 228 ft., runs west off of Roger Dr.
2. The Department of Public Works is directed to obtain, place, and/or remove the appropriate street signs as necessary to effectuate said amendments. REPEAL: All ordinances or parts of Ordinances in conflict herewith are hereby repealed.

SEVERABILITY: If any provision of this Ordinance shall be held to be invalid, such invalidity shall not affect other provisions herein which can be given effect without the invalid provision and to this end the provisions of this Ordinance are hereby declared to be severable.

EFFECTIVE DATE: This Ordinance shall become effective fifteen (15) days after adoption.

MOVED FOR ADOPTION BY: _____ SECONDED BY: _____

WHEREUPON THIS ORDINANCE WAS SUBMITTED TO A VOTE AND RESULTED IN THE FOLLOWING:

YEAS: _____

NAYS: _____

ABSTAIN: _____

ABSENT: _____

THIS ORDINANCE WAS DECLARED DULY ADOPTED AT A REGULAR MEETING OF THE PARISH COUNCIL ON THE 3 DAY OF MARCH , 2022 ; AND BECOMES ORDINANCE COUNCIL SERIES NO _____.

JERRY BINDER, COUNCIL CHAIRMAN

ATTEST:

KATRINA L. BUCKLEY, COUNCIL CLERK

MICHAEL B. COOPER, PARISH PRESIDENT

Published Introduction: JANUARY 26 , 2022

Published Adoption: _____, 2022

Delivered to Parish President: _____, 2022 at _____

Returned to Council Clerk: _____, 2022 at _____

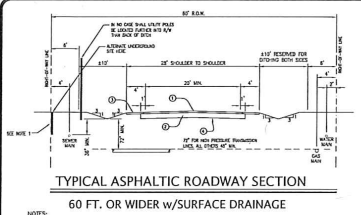

TYPICAL ASPHALTIC ROADWAY SECTION
60 FT. OR WIDER w/SURFACE DRAINAGE

NOTES:
1. ALL UNDERGROUND UTILITIES PARALLELING LANES SHALL BE A MINIMUM OF 36 IN. BELOW THE SURFACE, WHEN CROSSING LANES. UTILITIES SHALL BE A MINIMUM OF 18 IN. EXCEPT FROM PRESSURE TRANSMISSION LINES WHICH SHALL BE A MINIMUM OF 72 IN. BELOW BOTTOM OF DITCH.
2. ALL ALL UNDERGROUND UTILITIES PARALLELING LANES SHALL BE A MINIMUM OF 18 IN. ABOVE ROAD CROWN, AERIAL, AERIAL/AUGU/OVD
3. DEVIATIONS FROM THESE STANDARDS MUST BE APPROVED BEFORE CONSTRUCTION BY THE PARISH ENGINEER.

LEGEND - FOR ASPHALT PAVING:
① 1/2" (MIN) GRANITE FINISHED 1/2" TYPE DPM-1 MEANS CHANGE
② 1/2" (MIN) GRANITE FINISHED 1/2" TYPE DPM-1 MEANS CHANGE
③ 1/2" (MIN) GRANITE CONCRETE ROCK
④ 1/2" (MIN) GRANITE CONCRETE ROCK FOR ADJ. DITCH
⑤ 1/2" (MIN) GRANITE CONCRETE ROCK FOR ADJ. DITCH
⑥ 1/2" (MIN) GRANITE CONCRETE ROCK FOR ADJ. DITCH

BASE PREPARATION AND PAVING NOTES:
1. ALL WORK AND MATERIAL TO BE IN COMPLIANCE WITH THE SPECIFICATIONS OF TRANSPORTATION DIVISION SPECIFICATIONS FOR ROADS AND BRIDGES, LATEST EDITION, UNLESS OTHERWISE NOTED.
2. EXISTING TOP SOIL IN PROPOSED ROAD BED TO BE EXCAVATED 1/2" MIN. DEPTH AND REMOVED AS NECESSARY FOR FINEL GRADE.
3. DRAIN REMAINING BASE MATERIAL TO A DEPTH OF 1/2" BEFORE TREATING WITH CEMENT.
4. 1/2" BEFORE TREATING WITH CEMENT.

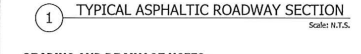

TYPICAL ASPHALTIC ROADWAY SECTION
Scale: N.T.S.

GRADING AND DRAINAGE NOTES:

- CONTRACTOR SHALL VERIFY TOP ELEVATIONS OF ALL DRAINAGE STRUCTURES IN FIELD AND SET FLOW LINE INDICATING TO REFLECT DESIGN INDICATED IN CONSTRUCTION PLANS.
- ALL GRADINGS MUST BE VERIFIED WITH WATER, WHICH AND OR PLANT MATERIAL TO ENSURE THAT RUNOFF AND SET DOES NOT LEAVE PROJECT SITE.
- ALL REPAIRED IMPAVED AREAS SHALL BE RESTORED BY SODDING OR RESEEDING IN ACCORDANCE WITH THE SPECIFICATIONS.
- ADJUST PROPOSED AND/OR CURB ELEVATIONS AS NECESSARY TO ASSURE AS SHOWN FIT AND CORRESPONDENCE WITH EXISTING.
- CONTRACTOR IS RESPONSIBLE FOR VERIFYING ALL UTILITIES AND NOTIFYING THE APPROPRIATE UTILITY COMPANY PRIOR TO BEGINNING CONSTRUCTION.
- CONTRACTOR SHALL VERIFY HORIZONTAL AND VERTICAL LOCATION OF ALL EXISTING STORM SEWER STRUCTURES, PIPES, AND ALL UTILITIES FROM THE CONSTRUCTION.
- CONTRACTOR IS RESPONSIBLE FOR REPAIRS OF DAMAGE TO ANY EXISTING IMPROVEMENTS DURING CONSTRUCTION, SUCH AS BUT NOT LIMITED TO: DRAINAGE UTILITIES, PAVEMENT, STREETS, CURBS, ETC. REPAIRS SHALL BE EQUAL TO OR BETTER THAN EXISTING CONDITIONS.
- PROPOSED SLOPE GRADINGS ARE SHOWN AND TO TOP OF HIGHEST UNPAVED DRIVEWAY NOTES.
- ALL UN-SURFACED AREAS SUBJECTED BY GRADING OPERATIONS SHALL RECEIVE A MINIMUM OF 2" TOPSOIL. CONTRACTOR SHALL VERIFY ELEVATIONS OF ADJACENT PROPERTIES TO SITE. IF EXISTING GRADINGS ARE NOT SHOWN ON THIS PLAN, CONTRACTOR SHALL VERIFY OWNERS PROPERTY GRADINGS.
- CONSTRUCTION SHALL COMPLY WITH ALL GOVERNING CODES AND BE CONSTRUCTED TO MAINTAIN.
- THE CONTRACTOR SHALL MAINTAIN DUST CONTROL ON SITE AT ALL TIMES BY WATERING SITE AS OFTEN AS NEEDED.
- CONTRACTOR SHALL FIELD VERIFY ELEVATIONS OF ADJACENT PROPERTIES TO SITE. IF EXISTING GRADINGS ARE NOT SHOWN ON THIS PLAN, CONTRACTOR SHALL VERIFY OWNERS PROPERTY GRADINGS.
- CONTRACTOR SHALL BE RESPONSIBLE FOR ANY TRAFFIC CONTROL NECESSARY FOR DRIVEWAY CONSTRUCTION.
- ALL MANICURED AREAS, SODDING, ROCKET, ETC. MUST BE CONSTRUCTED IN ACCORDANCE WITH LOCAL STATE CITY STANDARDS. IN THE EVENT THESE REQUIREMENTS CANNOT BE MET, THE MANICURED AREAS SHALL BE NOTIFIED PRIOR TO CONSTRUCTION FOR AN ALTERNATE SOLUTION.
- CONTRACTOR SHALL FIELD VERIFY ELEVATIONS OF ADJACENT PROPERTIES TO SITE. IF EXISTING GRADINGS ARE NOT SHOWN ON THIS PLAN, CONTRACTOR SHALL VERIFY OWNERS PROPERTY GRADINGS.
- CONTRACTOR SHALL MAINTAIN ALL SEWER AND STORM DRAIN LINES IN THE PRESENCE OF THE ENGINEER AND OWNER.
- CONTRACTOR SHALL AT ALL TIMES, PREVENT AND MAINTAIN UNOBTAINED ACCESS TO THE PROJECT SITE IN ACCORDANCE WITH THE REQUIREMENTS OF THE FIRE PROTECTION AGENCY HAVING JURISDICTION OVER THE PROJECT SITE.
- CONTRACTOR SHALL ADJUST ALL UTILITY BOVES, MANHOLE COVERS, DRAIN VALVES, VALVE COVERS, ETC. TO MATCH FINISH GRADE IN THE CONSTRUCTION AREA UNLESS OTHERWISE APPROVED BY THE ENGINEER.
- CONTRACTOR SHALL EXCAVATE FOR AND EXPOSE EXISTING UNDERGROUND UTILITIES WHERE CONFLICTING ARE TO MAINTAIN PRIOR TO ANY CONSTRUCTION. SHOULD ANY ADJUSTMENTS IN LINE OR GRADE BE NECESSARY, THE CONTRACTOR SHALL NOTIFY IT TO THE ATTENTION OF THE ENGINEER.
- CONTRACTOR SHALL COORDINATE UNDERGROUND UTILITY CONSTRUCTION IN SUCH A MANNER AS TO PREVENT AND CONTACT WORKER UTILITY LINES CROSS.
- ALL ROP SHALL BE CLASS B UNLESS OTHERWISE NOTED.
- ALL DRAINAGE PIPES SHALL HAVE A MIN SLOPE OF 0.15% UNLESS OTHERWISE NOTED.

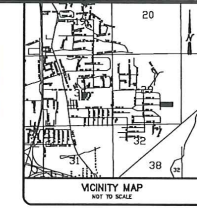
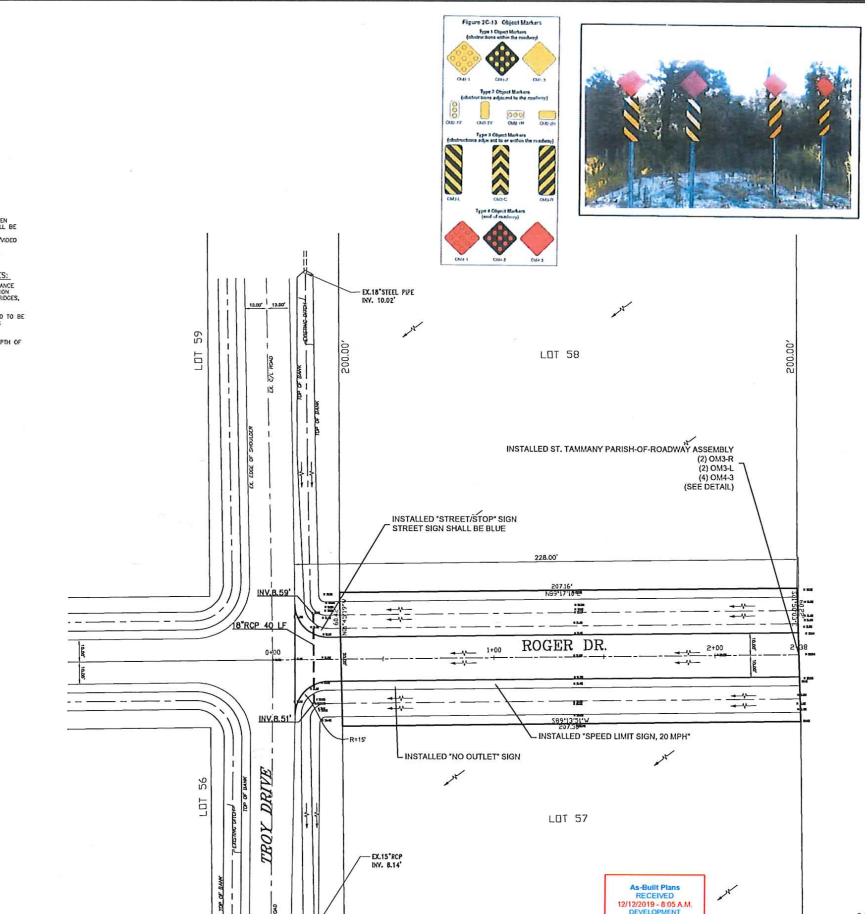

LEGEND:

- SEWER MANHOLE - SEWER LINE
- WATER MANHOLE - WATER LINE
- DES MANHOLE - GAS LINE
- TELE MANHOLE - TELE LINE
- DRAIN MANHOLE - DRAIN LINE
- DRAIN INLET - DRAIN LINE
- POWER POLE / OPTIC/FIBER LINES
- ELECTRICAL/PHENOLICABLE TV
- ELEC. TRUNK / OVERHEAD LINES
- CATCH BASIN
- LIGHT STANDARDS
- TRAFFIC LIGHT
- TELE. - ELEC. - CATV PEDESTAL
- GAS, WATER, ELECTRIC METER
- GAS, WATER VALVE
- SEWER - DRAIN CLEANOUT
- FIRE HYDRANT
- DAY WIRE ANCHOR
- SOIL
- PILE/IN
- WALDOX
- TREE
- SHRUB
- FENCE

DRAINAGE LEGEND:

- PROPOSED TOP OF CURB ELEV.
- PROPOSED BOTTOM OF CURB ELEV.
- PROPOSED COVER PLATE FINISH ELEV.
- PROPOSED FINISH GRADE ELEV.
- EXISTING ELEVATION
- PROPOSED STORM DRAINAGE PIPE
- PROPOSED STORM DRAINAGE PIPE OCCUPATION
- PROPOSED CHIMNEY HIGH POINT OR LOW POINT
- FLUSH APPROX.
- DRAINAGE AREA

J.V. Burke & Associates, Inc.
SURVEYING, ENGINEERING, ARCHITECTURAL
1000 Lakeshore Drive
Greensburg, Louisiana 70042
Phone: 850-348-0077 Fax: 850-348-0074

PLANNING AND DRAINAGE PLAN
SECTION 24.02-02-01-07
HICKORY HILLS SUB., IN SEC. 24, T-8-S, R-15-E
GREENSBURG LAND DISTRICT
ST. TAMMANY PARISH, LOUISIANA

SCALE: 1" = 20'
DATE: 8/29/2018
DRAWN BY: [Name]
CHECKED BY: [Name]
DATE: [Date]
SHEET NO. 1 OF 1

AS-BUILT

CALL LA ONE CALL FOR UTILITY LOCATION PRIOR TO BEGINNING CONSTRUCTION

ADMINISTRATIVE COMMENT

Reference No. _____

Administrative Department: Public Works

PURPOSE: To provide for corrections/additions/deletions to the road and drainage inventory based upon recommendation of the Department of Engineering, or Certificates of Road and/or Drainage Maintenance by Area Foreman.

RECOMMENDATION: The Public Works Department recommends adoption.