

ST. TAMMANY PARISH COUNCIL

ORDINANCE

ORDINANCE CALENDAR NO: 6883

ORDINANCE COUNCIL SERIES NO: \_\_\_\_\_

COUNCIL SPONSOR: BINDER/COOPER

PROVIDED BY: PUBLIC WORKS

INTRODUCED BY: MR. TOLEDANO

SECONDED BY: MR. DEAN

ON THE 3 DAY OF FEBRUARY , 2022

AN ORDINANCE TO CORRECT THE ROAD AND DRAINAGE INVENTORY TO INCLUDE DENTY CRAWFORD RD. (R08F112) (WARD 8, DISTRICT 9)

WHEREAS, the St. Tammany Parish Selective Road and Drainage Inventories require updating/amending periodically to provide for the corrections/additions/deletions to the road and drainage inventories based upon the recommendation of the Department of Engineering, Director of Public Works, 911 Facilitator, or Certificate of Road and/or Drainage Maintenance by Area Foreman, Act of Exchange and/or Act of Donation.

THE PARISH OF ST. TAMMANY HEREBY ORDAINS: The St. Tammany Parish Selective Road and Drainage Maintenance System Inventory is amended as follows:

1. Add Denty Crawford Rd. (R08F112) for approximately 228 ft., runs west off of Roger Dr.
2. The Department of Public Works is directed to obtain, place, and/or remove the appropriate street signs as necessary to effectuate said amendments. REPEAL: All ordinances or parts of Ordinances in conflict herewith are hereby repealed.

SEVERABILITY: If any provision of this Ordinance shall be held to be invalid, such invalidity shall not affect other provisions herein which can be given effect without the invalid provision and to this end the provisions of this Ordinance are hereby declared to be severable.

EFFECTIVE DATE: This Ordinance shall become effective fifteen (15) days after adoption.

MOVED FOR ADOPTION BY: \_\_\_\_\_ SECONDED BY: \_\_\_\_\_

WHEREUPON THIS ORDINANCE WAS SUBMITTED TO A VOTE AND RESULTED IN THE FOLLOWING:

YEAS: \_\_\_\_\_

NAYS: \_\_\_\_\_

ABSTAIN: \_\_\_\_\_

ABSENT: \_\_\_\_\_

THIS ORDINANCE WAS DECLARED DULY ADOPTED AT A REGULAR MEETING OF THE PARISH COUNCIL ON THE 3 DAY OF MARCH , 2022 ; AND BECOMES ORDINANCE COUNCIL SERIES NO \_\_\_\_\_.

\_\_\_\_\_

JERRY BINDER, COUNCIL CHAIRMAN

ATTEST:

\_\_\_\_\_  
KATRINA L. BUCKLEY, COUNCIL CLERK

\_\_\_\_\_  
MICHAEL B. COOPER, PARISH PRESIDENT

Published Introduction: JANUARY 26 , 2022

Published Adoption: \_\_\_\_\_, 2022

Delivered to Parish President: \_\_\_\_\_, 2022 at \_\_\_\_\_

Returned to Council Clerk: \_\_\_\_\_, 2022 at \_\_\_\_\_

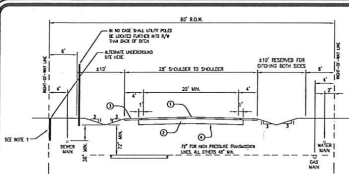

**TYPICAL ASPHALTIC ROADWAY SECTION  
60 FT. OR WIDER w/SURFACE DRAINAGE**

NOTES:  
 1. ALL UNDERGROUND UTILITIES PARALLELING LANES SHALL BE A MINIMUM OF 36 IN. BELOW THE SURFACE. WHEN CROSSING LANES, UTILITIES SHALL BE A MINIMUM OF 48 IN. EXCEPT FROM PRESSURE TRANSMISSION LINES WHICH SHALL BE A MINIMUM OF 72 IN. BELOW BOTTOM OF CUTCH.  
 2. ALL ALL UNDERGROUND UTILITIES PARALLELING LANES SHALL BE A MINIMUM OF 18 IN. ABOVE ROAD CROWN, AERIAL, AIR/GAS/AUG/VOID TYPE STRUCTURING LINES SHALL BE 18 IN. FROM ALL OTHERS. CROSSING LANES SHALL BE 30 FT. HIGH.  
 3. DEVIATIONS FROM THESE STANDARDS MUST BE APPROVED BEFORE CONSTRUCTION BY THE PAVEMENT ENGINEER.

- LEGEND - FOR ASPHALT PAVING**
- 1. 1" (MIN) FINISH ASPHALT. TYPE DPM-1 MEANING CHANGE: 1" - 1" ASPHALT CHANGE
  - 2. 1" (MIN) FINISH CONCRETE. ROCK COMPACTED TO 95% MODIFIED PROCTOR PER ASTM D1557. 22 FEET WIDE
  - 3. 1" (MIN) FINISH SHOULDER BINDER MATERIAL. COMPACTED TO 95% MODIFIED PROCTOR. MINIMUM 18" DEPTH. 10' WIDE. TO BE CONFORMANT WITH THE SPECIFICATIONS OF TRANSPORTATION MATERIALS DIVISION FOR BOND AND RESIDUE AND LATEST REVISIONS INDICATE.
  - 4. ASPHALT CHANGE

- BASE PREPARATION AND PAVING NOTES:**
- 1. ALL WORK AND MATERIAL TO BE IN COMPLIANCE WITH THE SPECIFICATIONS OF TRANSPORTATION MATERIALS DIVISION FOR ROAD AND BRIDGES, LATEST EDITION, UNLESS OTHERWISE NOTED.
  - 2. EXISTING TOP SOIL IN PROPOSED ROAD BED TO BE EXCAVATED 14" MIN. DEPTH AND REMOVED AS NECESSARY FOR FINE SAND.
  - 3. DRIVE REMAINING BASE MATERIAL TO A DEPTH OF 12" BEFORE TREATING WITH CEMENT.

**TYPICAL ASPHALTIC ROADWAY SECTION**  
Scale: N.T.S.

- GRADING AND DRAINAGE NOTES:**
1. CONTRACTOR SHALL VERIFY TOP ELEVATIONS OF ALL DRAINAGE STRUCTURES IN FIELD AND SET FLOW LINE HEIGHT ELEVATIONS TO REFLECT DESIGN INCLUDING IN CONSTRUCTION PLANS.
  2. CUT OR FILL SLOPES SHALL NOT BE STEEPER THAN 30:1 (H:V).
  3. ALL SLOPES MUST BE STABILIZED WITH MATTER WHICH AND OR PLANT MATERIAL TO ENSURE THAT RUNOFF AND SET DOES NOT LEAVE PROJECT SITE.
  4. ALL NEAREST ADJACENT AREAS SHALL BE RESTORED BY SOILING OR RESEEDING IN ACCORDANCE WITH THE SPECIFICATIONS.
  5. ADJUT PROPERTY AND/OR CURB ELEVATIONS AS NECESSARY TO ASSURE AS SHOWN FIT AND CONTIGUOUS WITH THE EXISTING.
  6. CONTRACTOR IS RESPONSIBLE FOR VERIFYING ALL UTILITIES AND NOTIFYING THE APPROPRIATE UTILITY COMPANY PRIOR TO BEGINNING CONSTRUCTION.
  7. CONTRACTOR SHALL VERIFY HORIZONTAL AND VERTICAL LOCATION OF ALL EXISTING STORM SEWER STRUCTURES, PIPES, AND ALL UTILITIES FROM ITS CONSTRUCTION.
  8. CONTRACTOR IS RESPONSIBLE FOR REPAIRS OF DAMAGE TO ANY EXISTING IMPEDIMENTS DURING CONSTRUCTION, SUCH AS BUT NOT LIMITED TO SIGNAGE, UTILITY, PATIO, STREMS, DRIVE, ETC. REPAIRS SHALL BE EQUAL TO OR BETTER THAN EXISTING CONDITIONS.
  9. PROPOSED SLOPES AND GRADES ARE SHOWN AS TO TOP OF EXISTING GRADE UNLESS OTHERWISE NOTED.
  10. ALL UN-SURFACED AREAS SUBJECTED BY GRADING OPERATIONS SHALL RECEIVE 4 INCHES OF TOPSOIL. CONTRACTOR SHALL VERIFY THE ELEVATION OF ALL EXISTING DRAINAGE STRUCTURES AND SHALL BE RESPONSIBLE FOR REPAIRS TO ALL EXISTING DRAINAGE STRUCTURES TO MEET DESIGN SPECIFICATIONS. A HEAVY STRAND OF CLASS B COARSE SAND SHALL BE CONSTRUCTED IN ACCORDANCE WITH THE SPECIFICATIONS OF TRANSPORTATION MATERIALS DIVISION FOR BOND AND RESIDUE AND LATEST REVISIONS INDICATE.
  11. CONSTRUCTION SHALL COMPLY WITH ALL GOVERNING CODES AND BE CONSTRUCTED TO MATCH.
  12. THE CONTRACTOR SHALL MAINTAIN DUST CONTROL ON SITE AT ALL TIMES BY WATERING SITE AS OFTEN AS NEEDED.
  13. CONTRACTOR SHALL FIELD VERIFY ELEVATIONS OF ADJACENT PROPERTY TO SITE. IF EXISTING GRADES DO NOT MATCH THOSE SHOWN ON THIS PLAN, CONTRACTOR SHALL NOTIFY OWNER PROJECT MANAGER.
  14. CONTRACTOR SHALL BE RESPONSIBLE FOR ANY TRAFFIC CONTROL NECESSARY FOR DRIVE CONSTRUCTION/CONSTRUCTION.
  15. ALL MANICURED AREAS, INCLUDING PAVED, DRIVEWAYS, ETC. MUST BE CONSTRUCTED IN ACCORDANCE WITH FEDERAL STATE CITY STANDARDS. IN THE EVENT THESE REQUIREMENTS CANNOT BE MET, A MUTED & ADJUSTED SHALL BE NOTIFIED PRIOR TO CONSTRUCTION FOR AN ALTERNATE SOLUTION.
  16. CONTRACTOR SHALL FIELD VERIFY ELEVATIONS OF ADJACENT PROPERTY TO SITE. IF EXISTING GRADES DO NOT MATCH THOSE SHOWN ON THIS PLAN, CONTRACTOR SHALL NOTIFY OWNER PROJECT MANAGER.
  17. CONTRACTOR SHALL BE RESPONSIBLE FOR ANY TRAFFIC CONTROL NECESSARY FOR DRIVE CONSTRUCTION/CONSTRUCTION.
  18. ALL MANICURED AREAS, INCLUDING PAVED, DRIVEWAYS, ETC. MUST BE CONSTRUCTED IN ACCORDANCE WITH FEDERAL STATE CITY STANDARDS. IN THE EVENT THESE REQUIREMENTS CANNOT BE MET, A MUTED & ADJUSTED SHALL BE NOTIFIED PRIOR TO CONSTRUCTION FOR AN ALTERNATE SOLUTION.
  19. THE CONTRACTOR SHALL MAINTAIN ALL STORM AND STORM DRAIN LANES IN THE PRESENCE OF THE ENGINEER AND OWNER.
  20. THE CONTRACTOR SHALL MAINTAIN ACCESS TO ALL EXISTING UNDERGROUND UTILITIES. ACCESS TO ALL EXISTING UNDERGROUND UTILITIES, MANHOLE COVERS, RAIN WELLS, VALVE COVERS, ETC. TO MATCH THOSE SHOWN IN THE CONSTRUCTION AREA UNLESS OTHERWISE APPROVED BY THE ENGINEER.
  21. THE CONTRACTOR SHALL EXCAVATE FOR AND EXPOSE EXISTING UNDERGROUND UTILITIES WHERE CONFLICTS ARE TO OCCUR PRIOR TO ANY CONSTRUCTION. SHOULD ANY ADJUSTMENTS IN LANE OR GRADE BE NECESSARY, THE CONTRACTOR SHALL NOTIFY IT TO THE ATTENTION OF THE ENGINEER.
  22. THE CONTRACTOR SHALL COORDINATE UNDERGROUND UTILITY CONSTRUCTION IN SUCH A MANNER AS TO PREVENT AND CONTACT WORKER UTILITY LINES CROSS.
  23. ALL H.P. SHALL BE CLASS B UNLESS OTHERWISE NOTED.
  24. ALL DRAINAGE PIPES SHALL HAVE A MIN SLOPE OF 0.15% UNLESS OTHERWISE NOTED.

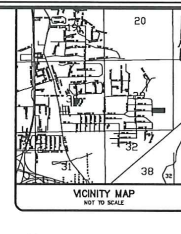
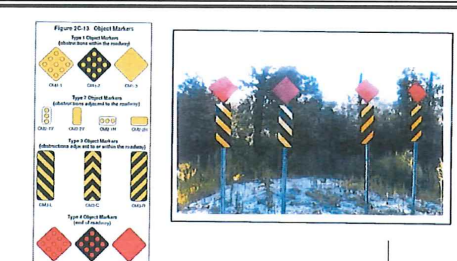
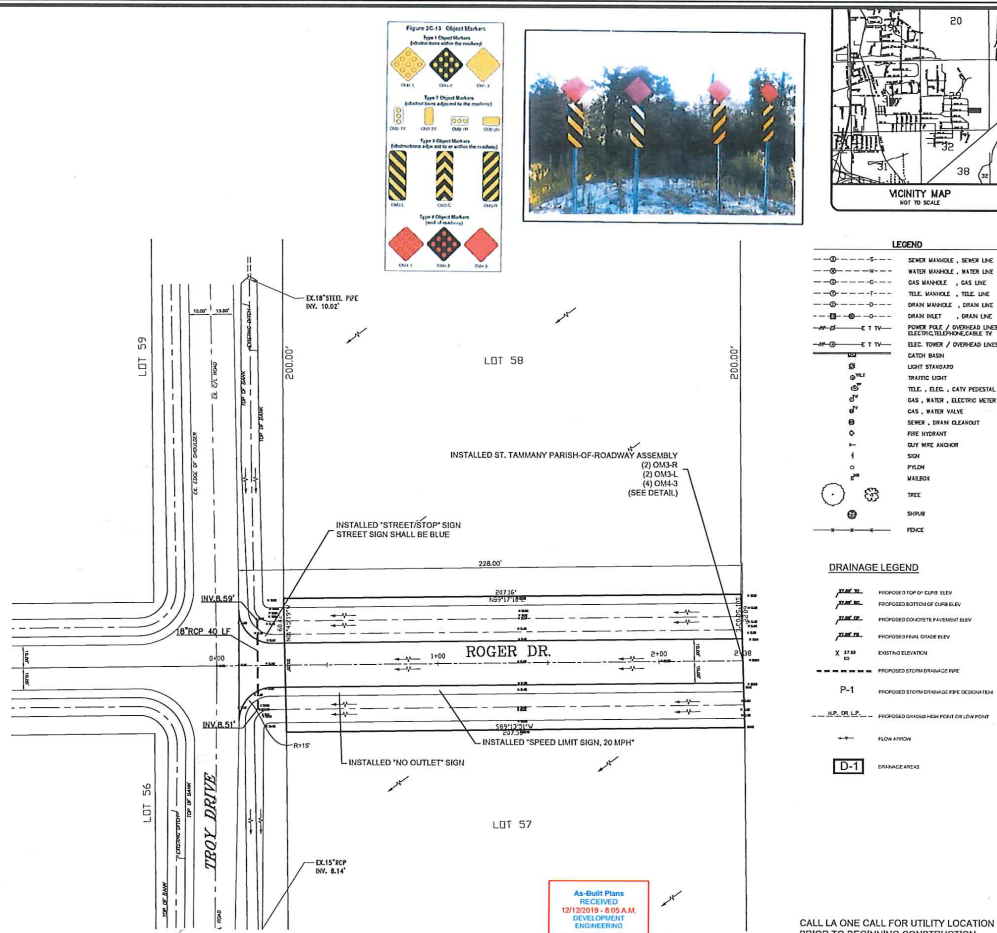

- LEGEND**
- SEWER MANHOLE - SEWER LINE
  - WATER MANHOLE - WATER LINE
  - D/S MANHOLE - GAS LINE
  - TILE MANHOLE - TILE LINE
  - DRAIN MANHOLE - DRAIN LINE
  - DRAIN INLET - DRAIN LINE
  - POWER POLE / OPTICAL LINES
  - ELECTRIC TELEPHONE/CABLE TV
  - ELEC. TRUNK / OVERHEAD LINES
  - CATCH BASIN
  - LIGHT STANDARDS
  - TRAFFIC LIGHT
  - TILE - ELEC. CANY FEEDBACK
  - GAS, WATER, ELECTRIC METER
  - GAS, WATER VALVE
  - SEWER - DRAIN CLEANOUT
  - FIRE HYDRANT
  - DAY WIRE ANCHOR
  - SOIL
  - PULMON
  - MALBOX
  - TREE
  - SURUB
  - FENCE

- DRAINAGE LEGEND**
- P-1 PROPOSED TOP OF CURB ELEV
  - P-2 PROPOSED BOTTOM OF CURB ELEV
  - P-3 PROPOSED COVER ELEVATION
  - P-4 PROPOSED DRAINAGE GRADE ELEV
  - X 1/2" EXISTING ELEVATION
  - P-5 PROPOSED STORM DRAINAGE PIPE DECK/CLASH
  - P-6 PROPOSED CHANGES FROM P-1 ON LOW POINT
  - FLOOD AREA
  - D-1 DRAINAGE AREA

**J.V. Burkholder & Associates, Inc.**  
 SURVEYING, ENGINEERING, PLANNING  
 1100 Westwood Agency  
 1100 Westwood Drive  
 Metairie, Louisiana 70002  
 Phone: 850-880-0777 Fax: 850-880-2124  
 Email: jvburkholder@jvba.com

**PAVING AND DRAINAGE PLAN**  
 PROJECT NO. 2018-0077  
 HICKORY HILLS SUB., IN SEC. 24, T-8-S-15-E  
 OF GREENBERG LAND DISTRICT,  
 ST. TAMMANY PARISH, LOUISIANA  
 PREPARED FOR: [Name Redacted]  
 PROJECT LOCATION: [Address Redacted]  
 DATE: 8/29/2018  
 DRAWN BY: [Name Redacted] CHECKED BY: [Name Redacted]  
 DATE: 8/29/2018  
 DWG NO.: 20170480  
 SHEET 1 OF 1

CALL LA ONE CALL FOR UTILITY LOCATION PRIOR TO BEGINNING CONSTRUCTION

AS-BUILT Plans RECEIVED 12/12/2019 - 8:05 A.M. DEVELOPMENT ENGINEERING

**AS-BUILT**

## ADMINISTRATIVE COMMENT

Reference No. \_\_\_\_\_

Administrative Department: Public Works

PURPOSE: To provide for corrections/additions/deletions to the road and drainage inventory based upon recommendation of the Department of Engineering, or Certificates of Road and/or Drainage Maintenance by Area Foreman.

RECOMMENDATION: The Public Works Department recommends adoption.