

ST. TAMMANY PARISH COUNCIL

ORDINANCE

ORDINANCE CALENDAR NO: 4827

ORDINANCE COUNCIL SERIES NO: _____

COUNCIL SPONSOR: GOULD/BRISTER

PROVIDED BY: PRESIDENT/LEGAL

INTRODUCED BY: _____

SECONDED BY: _____

ON THE 12 DAY OF JULY, 2012

ORDINANCE TO AUTHORIZE THE PARISH OF ST. TAMMANY, THROUGH THE OFFICE OF THE PARISH PRESIDENT, TO PURCHASE AND OR OTHERWISE ACQUIRE CERTAIN PARCELS, RIGHTS-OF-WAY, AND/OR SERVITUDES FOR THE OAK STREET BRIDGE PROJECT.

WHEREAS, the St. Tammany Parish Government desires to acquire certain immovable property (hereinafter referred to as "Property"); and

WHEREAS, there is a need and a public purpose for the acquisition of certain immovable property for bridge expansion and road improvements; and

WHEREAS, the Parish of St. Tammany hereby desires to acquire the Property, rights-of-way and/or servitudes and authorizes the Office of the Parish President to do whatever is necessary to enter into negotiations and acquire said Property, servitudes and/or rights-of-way.

THE PARISH OF ST. TAMMANY HEREBY ORDAINS: to authorize the Parish of St. Tammany, to acquire by purchase, donation, and/or servitude, all that certain parcel of ground described in Exhibit "A" attached hereto.

BE IT FURTHER ORDAINED that pursuant to all applicable provisions of law, the Office of the Parish President is directed and authorized to do whatever is necessary to acquire the Property, servitudes and/or rights-of-way.

BE IT FURTHER ORDAINED that the Office of the Parish President is authorized and instructed to proceed with the acquisition of the Property, servitudes and/or rights-of-way in a timely and orderly matter.

BE IT FURTHER ORDAINED that the Office of the Parish President is authorized to exercise its discretion in acquiring the Property, servitudes and/or rights-of-way, together with all agreements and all transactions necessary to carry out the intent of this Ordinance.

BE IT FURTHER ORDAINED that if purchased, the purchase price shall not exceed the fair market value of the Property as evidenced by an appraisal obtained or supplied to the Parish plus fees and costs.

BE IT FURTHER ORDAINED that any and all actions previously taken by the Office of the Parish President in furtherance of the actions contemplated herein are ratified and accepted accordingly.

REPEAL: All ordinances or parts of Ordinances in conflict herewith are hereby repealed.

SEVERABILITY: If any provision of this Ordinance shall be held to be invalid, such invalidity shall not affect other provisions herein which can be given effect without the invalid provision and to this end the provisions of this Ordinance are hereby declared to be severable.

EFFECTIVE DATE: This Ordinance shall become effective fifteen (15) days after adoption.

MOVED FOR ADOPTION BY: _____ SECONDED BY: _____

WHEREUPON THIS ORDINANCE WAS SUBMITTED TO A VOTE AND RESULTED IN THE FOLLOWING:

YEAS: _____

NAYS: _____

ABSTAIN: _____

ABSENT: _____

THIS ORDINANCE WAS DECLARED DULY ADOPTED AT A REGULAR MEETING OF THE PARISH COUNCIL ON THE 2 DAY OF AUGUST, 2012; AND BECOMES ORDINANCE COUNCIL SERIES NO _____.

MARTIN W. GOULD, JR., COUNCIL CHAIRMAN

ATTEST:

THERESA L. FORD, COUNCIL CLERK

PATRICIA P. BRISTER, PARISH PRESIDENT

Published Introduction: JUNE 28, 2012

Published Adoption: _____, 2012

Delivered to Parish President: _____, 2012 at _____

Returned to Council Clerk: _____, 2012 at _____

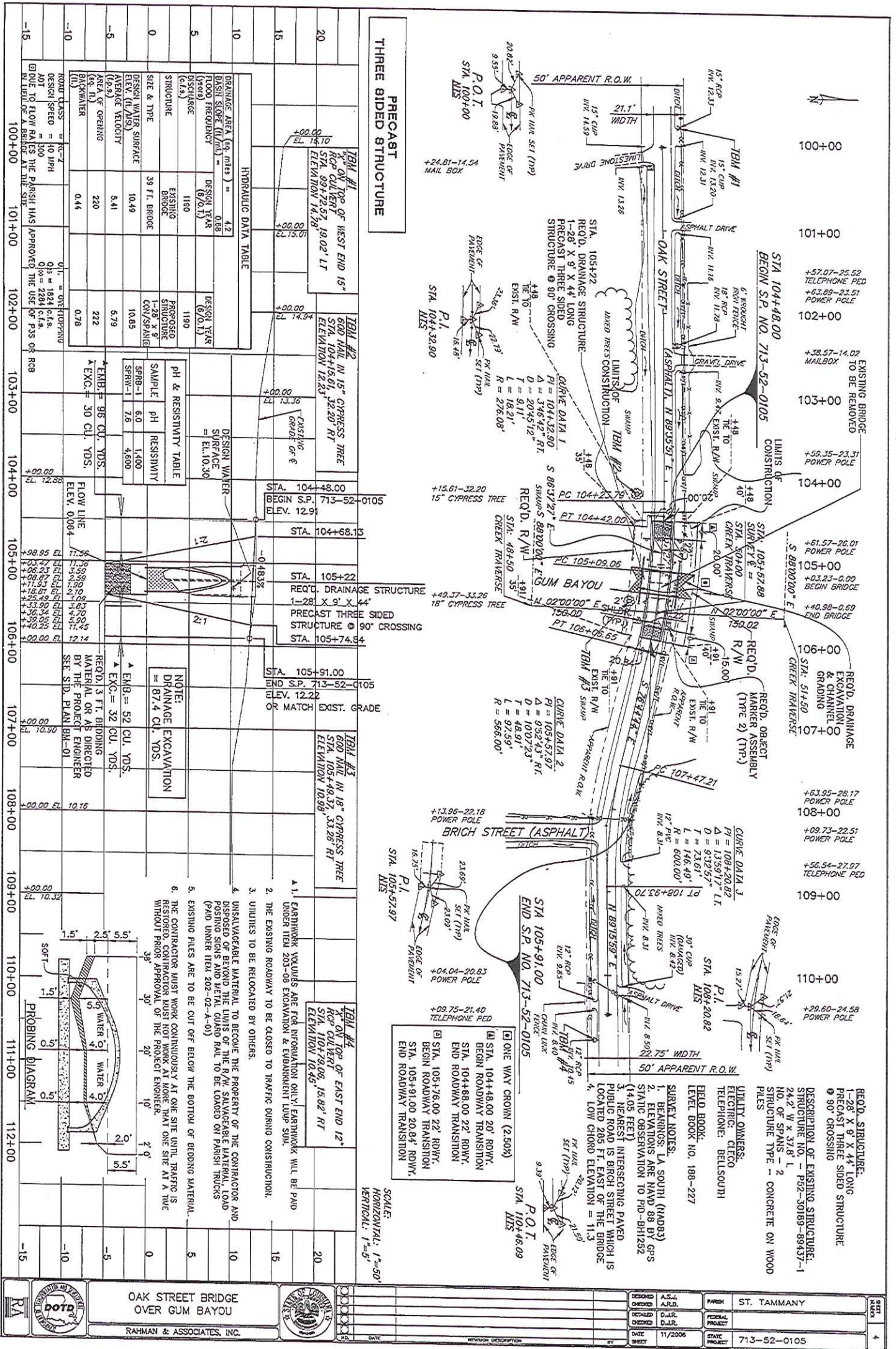

THREE SIDED PRECAST STRUCTURE

STATION	DESCRIPTION
100+00	1-28' X 9' X 44' LONG PRECAST THREE SIDED STRUCTURE @ 90° CROSSING
101+00	1-28' X 9' X 44' LONG PRECAST THREE SIDED STRUCTURE @ 90° CROSSING
102+00	1-28' X 9' X 44' LONG PRECAST THREE SIDED STRUCTURE @ 90° CROSSING
103+00	1-28' X 9' X 44' LONG PRECAST THREE SIDED STRUCTURE @ 90° CROSSING
104+00	1-28' X 9' X 44' LONG PRECAST THREE SIDED STRUCTURE @ 90° CROSSING
105+00	1-28' X 9' X 44' LONG PRECAST THREE SIDED STRUCTURE @ 90° CROSSING
106+00	1-28' X 9' X 44' LONG PRECAST THREE SIDED STRUCTURE @ 90° CROSSING
107+00	1-28' X 9' X 44' LONG PRECAST THREE SIDED STRUCTURE @ 90° CROSSING
108+00	1-28' X 9' X 44' LONG PRECAST THREE SIDED STRUCTURE @ 90° CROSSING
109+00	1-28' X 9' X 44' LONG PRECAST THREE SIDED STRUCTURE @ 90° CROSSING
110+00	1-28' X 9' X 44' LONG PRECAST THREE SIDED STRUCTURE @ 90° CROSSING
111+00	1-28' X 9' X 44' LONG PRECAST THREE SIDED STRUCTURE @ 90° CROSSING
112+00	1-28' X 9' X 44' LONG PRECAST THREE SIDED STRUCTURE @ 90° CROSSING

HYDRAULIC DATA TABLE

STATION	DESIGN YEAR	DESIGN VELOCITY (FT./SEC.)	DESIGN FLOOD FREQUENCY (YEAR)	DESIGN DISCHARGE (CFS)	DESIGN FLOOD FLOW (MGAL/DAY)	DESIGN ORANGE AREA (SQ. MILES)
100+00	1980	5.41	10	1190	4.2	0.68
101+00	1980	5.41	10	1190	4.2	0.68
102+00	1980	5.41	10	1190	4.2	0.68
103+00	1980	5.41	10	1190	4.2	0.68
104+00	1980	5.41	10	1190	4.2	0.68
105+00	1980	5.41	10	1190	4.2	0.68
106+00	1980	5.41	10	1190	4.2	0.68
107+00	1980	5.41	10	1190	4.2	0.68
108+00	1980	5.41	10	1190	4.2	0.68
109+00	1980	5.41	10	1190	4.2	0.68
110+00	1980	5.41	10	1190	4.2	0.68
111+00	1980	5.41	10	1190	4.2	0.68
112+00	1980	5.41	10	1190	4.2	0.68

PH & RESISTIVITY TABLE

SAMPLE	PH	RESISTIVITY
SPRM-1	6.0	1,400
SPRM-2	7.6	4,600

NOTE:
1. EMB. = 98 CU. YDS.
2. EMB. = 32 CU. YDS.
3. EMB. = 87.4 CU. YDS.

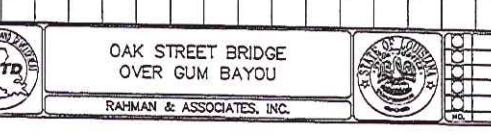

SCALE: HORIZONTAL: 1"=50'
VERTICAL: 1"=5'

RAHMAN & ASSOCIATES, INC.

NO.	REVISION	DATE	BY
1	ISSUED FOR PERMITS	11/2006	RAHMAN & ASSOCIATES, INC.
2	ISSUED FOR PERMITS	11/2006	RAHMAN & ASSOCIATES, INC.
3	ISSUED FOR PERMITS	11/2006	RAHMAN & ASSOCIATES, INC.
4	ISSUED FOR PERMITS	11/2006	RAHMAN & ASSOCIATES, INC.

ST. TAMMANY
713-52-0105

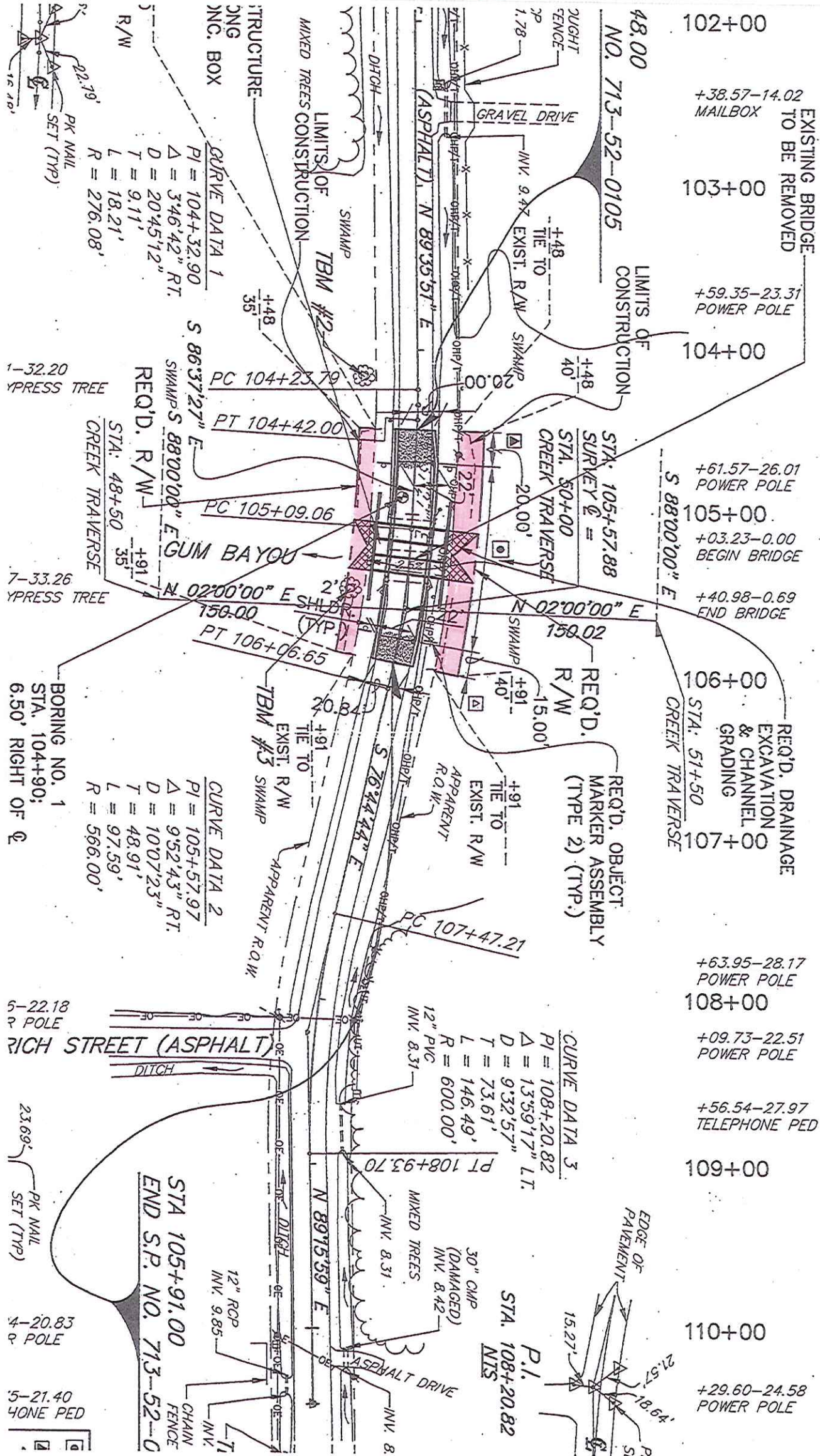

Deck

- 102+00 EXISTING BRIDGE TO BE REMOVED
- +38.57-14.02 MAILBOX
- 103+00
- +59.35-23.31 POWER POLE
- 104+00
- +61.57-26.01 POWER POLE
- +03.23-0.00 BEGIN BRIDGE
- 105+00
- +40.98-0.69 END BRIDGE
- 106+00 REQ'D. DRAINAGE EXCAVATION & CHANNEL GRADING
- 107+00 CREEK TRAVERSE
- +63.95-28.17 POWER POLE
- 108+00
- +09.73-22.51 POWER POLE
- +56.54-27.97 TELEPHONE PED
- 109+00
- +29.60-24.58 POWER POLE
- 110+00

48.00 NO. 713-52-0105

1.78' FENCE

GRAVEL DRIVE

INV. 9.42' EXIST. R.W.

SWAMP

20.00'

1.48' TIE TO

1.48' 40'

LIMITS OF CONSTRUCTION

SWAMP

1.48' 35'

STRUCTURE CONC. BOX

CURVE DATA 1

PI = 104+32.90

Δ = 346'42" RT.

D = 20'45'12"

T = 9.11'

L = 18.21'

R = 276.08'

REQ'D. R/W

PC 104+23.79

PT 104+42.00

PC 105+09.06

GUMBO BAYOU

N 02°00'00" E SHLDR. (TYP.)

2' SWAMP

150.00

PT 106+06.65

20.84'

+91' TIE TO

EXIST. R/W

TBM #3 SWAMP

APPARENT R.O.W.

REQ'D. MARKER ASSEMBLY (TYPE 2) (TYP.)

REQ'D. SURVEY

STA. 50+00

CREEK TRAVERSE

20.00'

15.00'

+91' TIE TO

EXIST. R/W

APPARENT R.O.W.

PC 107+47.21

PT 108+93.70

N 89°15'59" E

30" CMP (DAMAGED) INV. 8.42'

MIXED TREES INV. 8.31'

ASPHALT DRIVE

INV. 8.31'

12" RCP INV. 9.85'

CHAIN FENCE

STA 105+91.00

END S.P. NO. 713-52-0

CURVE DATA 2

PI = 105+57.97

Δ = 9'52'43" RT.

D = 10'07'23"

T = 48.91'

L = 97.59'

R = 566.00'

BORING NO. 1

STA. 104+90;

6.50' RIGHT OF Q

7-33.26

YPRESS TREE

1-32.20

YPRESS TREE

22.79'

PK NAIL SET (TYP.)

16.40'

5-22.18

POLE

RICH STREET (ASPHALT)

DITCH

23.69'

PK NAIL SET (TYP.)

4-20.83

POLE

5-21.40

40NE PED

15.27'

27.57'

18.64'

P.I.

STA. 108+20.82

NTS

Ordinance Administrative Comment

ORDINANCE TO AUTHORIZE THE PARISH OF ST. TAMMANY, THROUGH THE OFFICE OF THE PARISH PRESIDENT, TO PURCHASE OR OTHERWISE ACQUIRE CERTAIN PARCELS, RIGHTS OF WAY, AND/OR SERVITUDES FOR THE OAK STREET BRIDGE PROJECT.

This property will be acquired for bridge expansion and road improvements. The Parish intends to pay no more than appraised value or less, plus closing costs and fees.