

ST. TAMMANY PARISH COUNCIL

ORDINANCE

ORDINANCE CALENDAR NO: 5979

ORDINANCE COUNCIL SERIES NO: _____

COUNCIL SPONSOR: DEAN

PROVIDED BY: COUNCIL OFFICE

INTRODUCED BY: _____

SECONDED BY: _____

ON THE 3 DAY OF MAY , 2018

ORDINANCE ESTABLISHING A NO PARKING ZONE ON
DEFOREST DRIVE (1-J-25) (WARD 1, DISTRICT 1)

WHEREAS, St. Tammany Parish Government is charged with protecting the safety and welfare of citizens of the Parish.

THE PARISH OF ST. TAMMANY HEREBY ORDAINS: that

SECTION I: A "No Parking" zone is hereby established on Deforest Drive (1-J-25) as per the attached memo from the St. Tammany Parish Department of Engineering.

SECTION II: The Parish Department of Public Works is directed to post the appropriate signage at these locations, in accordance with the attached Engineering data.

REPEAL: All ordinances or parts of Ordinances in conflict herewith are hereby repealed.

SEVERABILITY: If any provision of this Ordinance shall be held to be invalid, such invalidity shall not affect other provisions herein which can be given effect without the invalid provision and to this end the provisions of this Ordinance are hereby declared to be severable.

EFFECTIVE DATE: This Ordinance shall become effective fifteen (15) days after adoption.

MOVED FOR ADOPTION BY: _____ SECONDED BY: _____

WHEREUPON THIS ORDINANCE WAS SUBMITTED TO A VOTE AND RESULTED IN THE FOLLOWING:

YEAS: _____

NAYS: _____

ABSTAIN: _____

ABSENT: _____

THIS ORDINANCE WAS DECLARED DULY ADOPTED AT A REGULAR MEETING OF THE PARISH COUNCIL ON THE 7 DAY OF JUNE , 2018 ; AND BECOMES ORDINANCE COUNCIL SERIES NO _____.

S. MICHELE BLANCHARD, COUNCIL CHAIRMAN

ATTEST:

THERESA L. FORD, COUNCIL CLERK

PATRICIA P. BRISTER, PARISH PRESIDENT

Published Introduction: APRIL 25 , 2018

Published Adoption: _____, 2018

Delivered to Parish President: _____, 2018 at _____

Returned to Council Clerk: _____, 2018 at _____



ST. TAMMANY PARISH
PATRICIA P. BRISTER
PARISH PRESIDENT

Date: March 28, 2018

To: **Joey Lobrano**
Right Of Way Coordinator
Department Of Public Works

From: **Jay Watson, P.E.**
Development Engineer

Re: **District 1**
Project 18-008
Deforest Dr. 1-J-25
2-NO PARKING RIGHT ARROW signs
2-NO PARKING LEFTARROW signs
2-NO PARKING signs

Council Ordinance Required:

Yes: X

No:

The Department of Planning and Development recommends the installation of Signage to be installed in District 1.

As per MUTCD, when signs with arrows are used to indicate the restricted parking zones, the signs with the arrows should be set at an angle of not less than 30 degrees and not more than 45 degrees with the line of traffic flow in order to be visible to approaching traffic.

1. Install NO PARKING RIGHT ARROW sign on Deforest Dr. 10' from the Deforest and Rex intersection.
2. Install NO PARKING LEFT ARROW sign on Deforest Dr. 10' from the Deforest and Rex intersection.
3. Install NO PARKING sign on Deforest Dr. between mailboxes 27 and 29.
4. Install NO PARKING sign on Deforest Dr. across from Job #3.
5. Install NO PARKING RIGHT ARROW sign on Deforest Dr. 15' from the Deforest and Mardi St. intersection.
6. Install NO PARKING LEFT ARROW sign on Deforest Dr. 15' from the Deforest and Mardi St. intersection.

cc. Councilman Marty Dean
Theodore C. Reynolds
Michael Spiehler

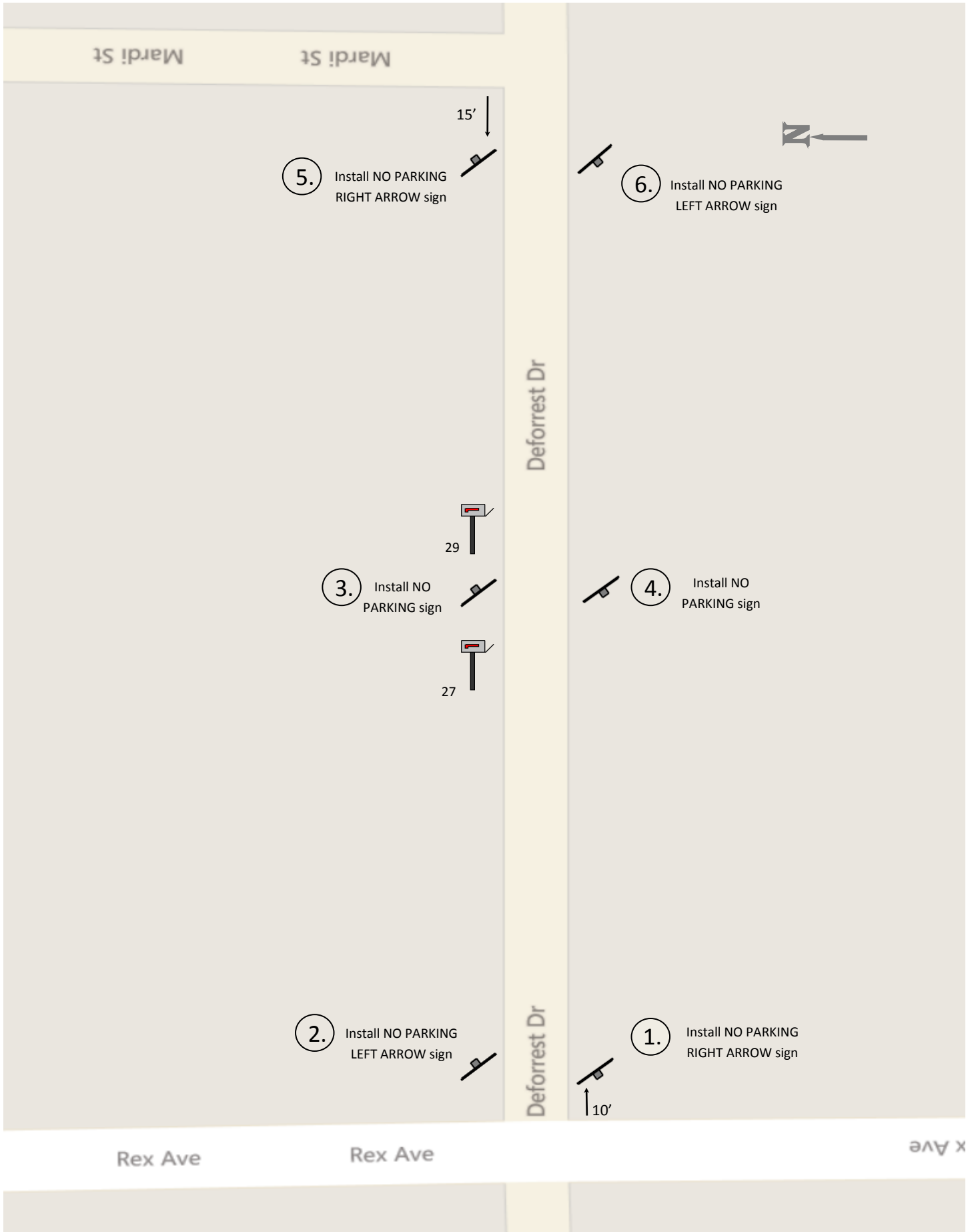
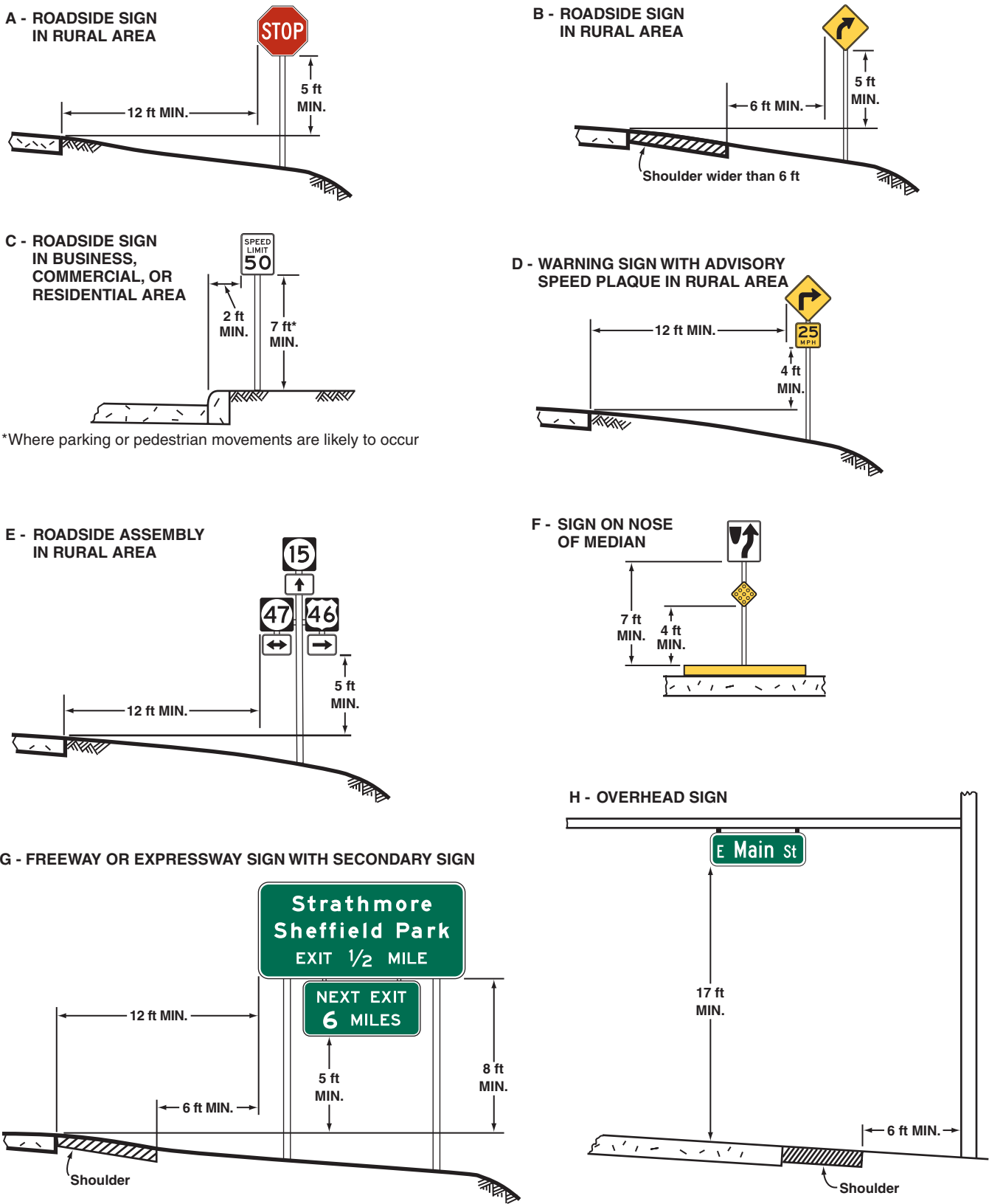

Figure 2A-2. Examples of Heights and Lateral Locations of Sign Installations



*Where parking or pedestrian movements are likely to occur

Note:
See Section 2A.19 for reduced lateral offset distances that may be used in areas where lateral offsets are limited, and in business, commercial, or residential areas where sidewalk width is limited or where existing poles are close to the curb.

Figure 2A-3. Examples of Locations for Some Typical Signs at Intersections

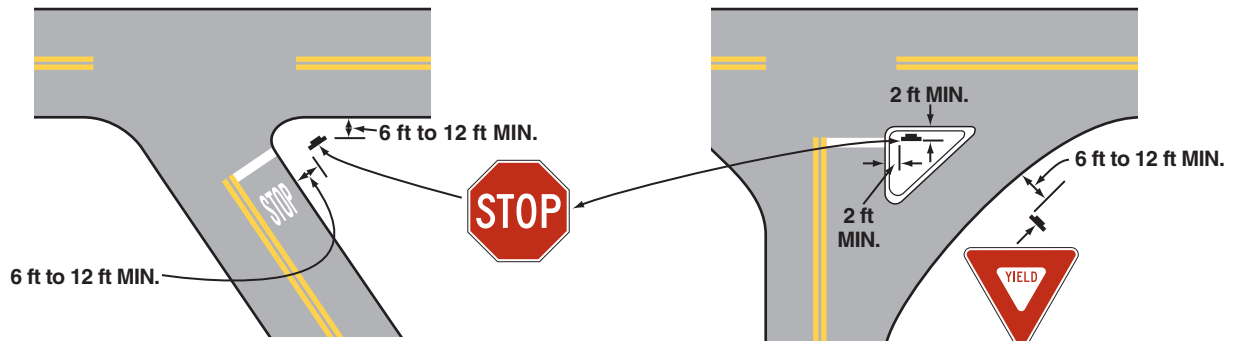

A - ACUTE ANGLE INTERSECTION

B - CHANNELIZED INTERSECTION

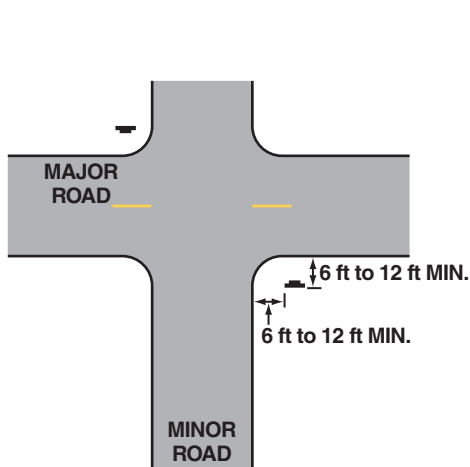

C - MINOR CROSSROAD

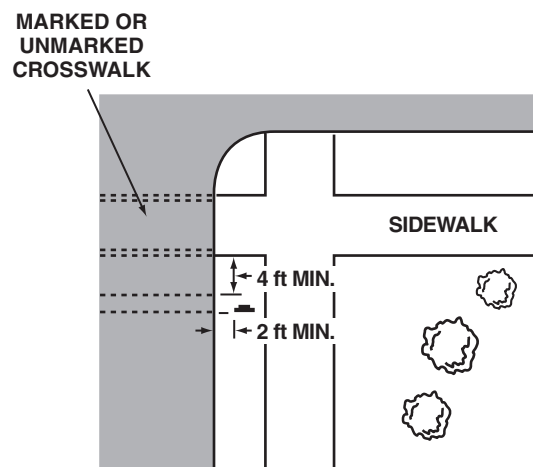

D - URBAN INTERSECTION

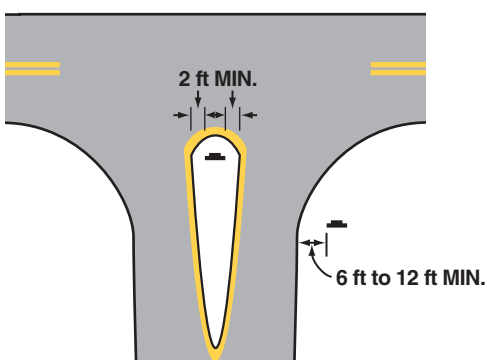

E - DIVISIONAL ISLAND

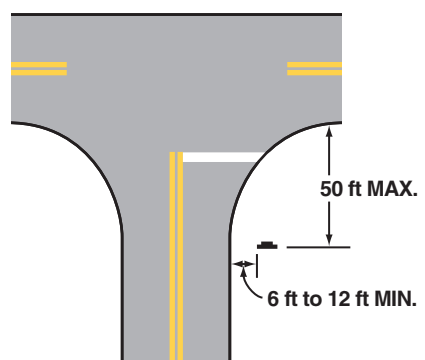

F - WIDE THROAT INTERSECTION

Note: Lateral offset is a minimum of 6 feet measured from the edge of the shoulder, or 12 feet measured from the edge of the traveled way. See Section 2A.19 for lower minimums that may be used in urban areas, or where lateral offset space is limited.