

ST. TAMMANY PARISH COUNCIL

ORDINANCE

ORDINANCE CALENDAR NO: 6067 ORDINANCE COUNCIL SERIES NO: \_\_\_\_\_

COUNCIL SPONSOR: BLANCHARD/BRISTER PROVIDED BY: CIVIL DIVISION ADA

INTRODUCED BY: \_\_\_\_\_ SECONDED BY: \_\_\_\_\_

ON THE 1 DAY OF NOVEMBER , 2018

ORDINANCE TO AUTHORIZE ST. TAMMANY PARISH GOVERNMENT, THROUGH THE OFFICE OF THE PARISH PRESIDENT, TO ACQUIRE CERTAIN DRAINAGE SERVITUDES IN ROBINDALE SUBDIVISION, SQUARES 7-9 AND 13-15 (WARD 3, DISTRICT 2)

WHEREAS, St. Tammany Parish desires to acquire certain drainage servitudes situated within Squares 7-9 and 13-15 of Robindale Subdivision and as depicted on the Exhibit attached hereto; and

WHEREAS, there is a need and a public purpose for the acquisition of said drainage servitudes to provide for drainage as well as maintenance and improvements to drainage.

THE PARISH OF ST. TAMMANY HEREBY ORDAINS: that St. Tammany Parish Government, through the Office of the Parish President, is directed and authorized to acquire by dedication, donation, or assignment the drainage servitudes in Squares 7-9 and 13-15 of Robindale Subdivision as depicted on the Exhibit attached hereto.

BE IT FURTHER ORDAINED: that pursuant to all applicable provisions of law, the Office of the Parish President is directed and authorized to do whatever is necessary to acquire said servitudes.

BE IT FURTHER ORDAINED: that any and all actions previously taken by the Office of the Parish President in furtherance of the actions contemplated herein are ratified and accepted accordingly.

REPEAL: All ordinances or parts of Ordinances in conflict herewith are hereby repealed.

SEVERABILITY: If any provision of this Ordinance shall be held to be invalid, such invalidity shall not affect other provisions herein which can be given effect without the invalid provision and to this end the provisions of this Ordinance are hereby declared to be severable.

EFFECTIVE DATE: This Ordinance shall become effective fifteen (15) days after adoption.

MOVED FOR ADOPTION BY: \_\_\_\_\_ SECONDED BY: \_\_\_\_\_

WHEREUPON THIS ORDINANCE WAS SUBMITTED TO A VOTE AND RESULTED IN THE FOLLOWING:

YEAS: \_\_\_\_\_

NAYS: \_\_\_\_\_

ABSTAIN: \_\_\_\_\_

ABSENT: \_\_\_\_\_

THIS ORDINANCE WAS DECLARED DULY ADOPTED AT A REGULAR MEETING OF THE PARISH COUNCIL ON THE 6 DAY OF DECEMBER , 2018 ; AND BECOMES ORDINANCE COUNCIL SERIES NO \_\_\_\_\_.

\_\_\_\_\_  
S. MICHELE BLANCHARD, COUNCIL CHAIRMAN

ATTEST:

\_\_\_\_\_  
THERESA L. FORD, COUNCIL CLERK

\_\_\_\_\_  
PATRICIA P. BRISTER, PARISH PRESIDENT

Published Introduction: OCTOBER 24 , 2018

Published Adoption: \_\_\_\_\_, 2018

Delivered to Parish President: \_\_\_\_\_, 2018 at \_\_\_\_\_

Returned to Council Clerk: \_\_\_\_\_, 2018 at \_\_\_\_\_

### **Ordinance Administrative Comment**

ORDINANCE TO AUTHORIZE ST. TAMMANY PARISH GOVERNMENT, THROUGH THE OFFICE OF THE PARISH PRESIDENT, TO ACQUIRE CERTAIN DRAINAGE SERVITUDES IN ROBINDALE SUBDIVISION, SQUARES 7-9 AND 13-15 (WARD 3, DISTRICT 2)

No purchase price will be due or owed for these drainage servitudes, which will be acquired by dedication, donation and/or assignment of existing drainage servitudes. The servitudes to be acquired increase the width of existing 20' servitudes to allow for required access and maintenance needs and are as required by Planning and Development.

The area presently consists of Robindale Subdivision as a partially undeveloped "paper" subdivision. Lot lines are not being modified, which would otherwise allow a dedication via a subdivision plat.

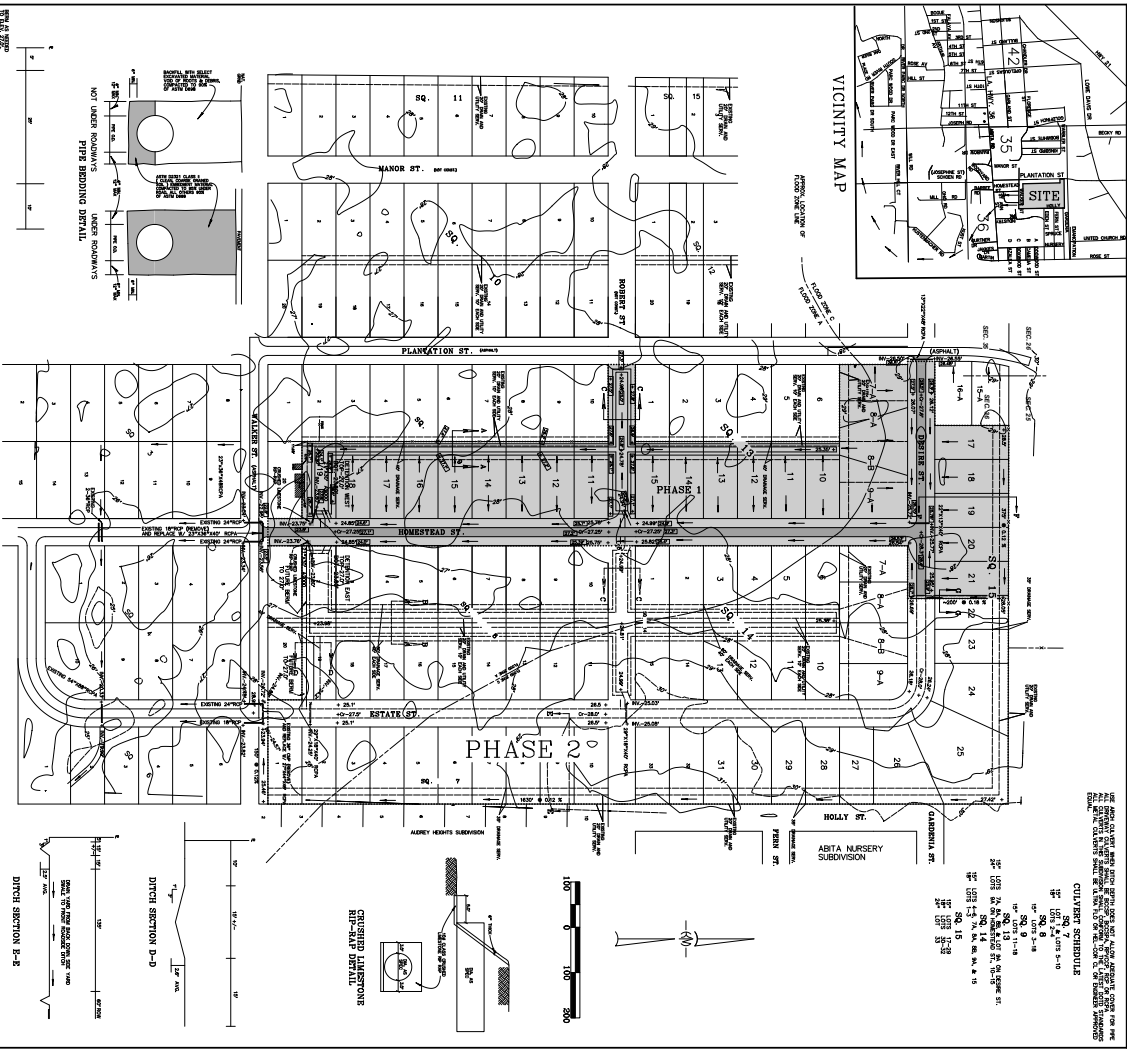
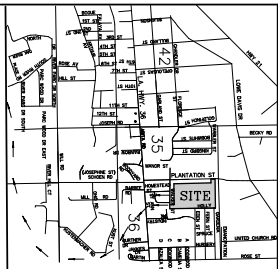

THE ENGINEER HAS CONDUCTED VISUAL INSPECTIONS OF THE SITE AND HAS FOUND THE INFORMATION TO BE TRUE AND CORRECT. THE ENGINEER HAS CONDUCTED VISUAL INSPECTIONS OF THE SITE AND HAS FOUND THE INFORMATION TO BE TRUE AND CORRECT.

**CULVERT SCHEDULE**

NO.	SPAN	LENGTH	DEPTH	INLET	OUTLET
1	12'-0"	10'-0"	4'-0"	11'-0"	11'-0"
2	12'-0"	10'-0"	4'-0"	11'-0"	11'-0"
3	12'-0"	10'-0"	4'-0"	11'-0"	11'-0"
4	12'-0"	10'-0"	4'-0"	11'-0"	11'-0"
5	12'-0"	10'-0"	4'-0"	11'-0"	11'-0"
6	12'-0"	10'-0"	4'-0"	11'-0"	11'-0"
7	12'-0"	10'-0"	4'-0"	11'-0"	11'-0"
8	12'-0"	10'-0"	4'-0"	11'-0"	11'-0"
9	12'-0"	10'-0"	4'-0"	11'-0"	11'-0"
10	12'-0"	10'-0"	4'-0"	11'-0"	11'-0"
11	12'-0"	10'-0"	4'-0"	11'-0"	11'-0"
12	12'-0"	10'-0"	4'-0"	11'-0"	11'-0"
13	12'-0"	10'-0"	4'-0"	11'-0"	11'-0"
14	12'-0"	10'-0"	4'-0"	11'-0"	11'-0"
15	12'-0"	10'-0"	4'-0"	11'-0"	11'-0"
16	12'-0"	10'-0"	4'-0"	11'-0"	11'-0"
17	12'-0"	10'-0"	4'-0"	11'-0"	11'-0"
18	12'-0"	10'-0"	4'-0"	11'-0"	11'-0"
19	12'-0"	10'-0"	4'-0"	11'-0"	11'-0"
20	12'-0"	10'-0"	4'-0"	11'-0"	11'-0"
21	12'-0"	10'-0"	4'-0"	11'-0"	11'-0"
22	12'-0"	10'-0"	4'-0"	11'-0"	11'-0"
23	12'-0"	10'-0"	4'-0"	11'-0"	11'-0"
24	12'-0"	10'-0"	4'-0"	11'-0"	11'-0"
25	12'-0"	10'-0"	4'-0"	11'-0"	11'-0"
26	12'-0"	10'-0"	4'-0"	11'-0"	11'-0"
27	12'-0"	10'-0"	4'-0"	11'-0"	11'-0"
28	12'-0"	10'-0"	4'-0"	11'-0"	11'-0"
29	12'-0"	10'-0"	4'-0"	11'-0"	11'-0"
30	12'-0"	10'-0"	4'-0"	11'-0"	11'-0"
31	12'-0"	10'-0"	4'-0"	11'-0"	11'-0"

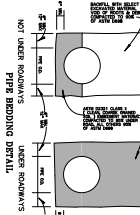

DITCH SECTION A-A

DITCH SECTION B-B

DITCH SECTION C-C

DITCH SECTION P-P

DITCH SECTION D-D

DITCH SECTION B-B

DITCH SECTION C-C

"AS BUILT" ELEVATIONS AND DATA

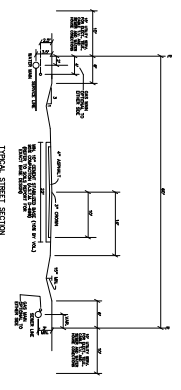

**LINE**  
 1-800-274-5033  
 2. PROFESSIONAL SEAL REQUIRED FOR THIS PLAN.

**ROBINDALE SUBDIVISION  
 ENTER THE PARISH RIGHT OF WAY  
 ST. TAMMANY PARISH, LOUISIANA.**

NO.	DATE	DESCRIPTION
1	01-20-13	PRELIMINARY PLAN
2	01-20-13	FINAL PLAN