

ST. TAMMANY PARISH COUNCIL

ORDINANCE

ORDINANCE CALENDAR NO: 5870

ORDINANCE COUNCIL SERIES NO: \_\_\_\_\_

COUNCIL SPONSOR: MR. GROBY

PROVIDED BY: COUNCIL OFFICE

INTRODUCED BY: MR. TOLEDANO

SECONDED BY: MR. BELLISARIO

ON THE 7 DAY OF SEPTEMBER , 2017

ORDINANCE ESTABLISHING A SPEED LIMIT OF 15 MPH ON THE ROADS WITHIN AUTUMN WIND SUBDIVISION. (WARD 4, DISTRICT 7)

WHEREAS, St. Tammany Parish Government is charged with protecting the safety and general welfare of citizens of the parish; and

WHEREAS, the St. Tammany Parish department of Engineering has evaluated the current speed limit on the roads within Autumn Wind subdivision and have no objection to reducing the existing speed limit of 25 MPH to 15 MPH.

THE PARISH OF ST. TAMMANY HEREBY ORDAINS:

SECTION I: A speed limit of 15 MPH is hereby established on the Autumn Wind Ln. (4-F-63) within the Autumn Wind Subdivision. (Ward 4 , District 7).

SECTION II: The Parish Department of Public Works is directed to replace all existing 25 MPH signs on this road with 15 MPH signs according to the attached engineering memo.

SECTION III: If any provision of this ordinance shall be held to be invalid, such invalidity shall not affect any other provision herein which can be given effect without the invalid provision and to this end the provisions of this ordinance are hereby declared to be severable.

SECTION IV: All ordinances or parts of ordinances in conflict herewith are hereby repealed.

SECTION V: This ordinance shall become effective immediately upon final adoption.

REPEAL: All ordinances or parts of Ordinances in conflict herewith are hereby repealed.

SEVERABILITY: If any provision of this Ordinance shall be held to be invalid, such invalidity shall not affect other provisions herein which can be given effect without the invalid provision and to this end the provisions of this Ordinance are hereby declared to be severable.

EFFECTIVE DATE: This Ordinance shall become effective fifteen (15) days after adoption.

MOVED FOR ADOPTION BY: \_\_\_\_\_ SECONDED BY: \_\_\_\_\_

WHEREUPON THIS ORDINANCE WAS SUBMITTED TO A VOTE AND RESULTED IN THE FOLLOWING:

YEAS: \_\_\_\_\_

NAYS: \_\_\_\_\_

ABSTAIN: \_\_\_\_\_

ABSENT: \_\_\_\_\_

THIS ORDINANCE WAS DECLARED DULY ADOPTED AT A REGULAR MEETING OF THE PARISH COUNCIL ON THE 5 DAY OF OCTOBER , 2017 ; AND BECOMES ORDINANCE COUNCIL SERIES NO \_\_\_\_\_.

\_\_\_\_\_  
STEVE STEFANCIK, COUNCIL CHAIRMAN

ATTEST:

\_\_\_\_\_  
THERESA L. FORD, COUNCIL CLERK

\_\_\_\_\_  
PATRICIA P. BRISTER, PARISH PRESIDENT

Published Introduction: AUGUST 30 , 2017

Published Adoption: \_\_\_\_\_ , 2017

Delivered to Parish President: \_\_\_\_\_ , 2017 at \_\_\_\_\_

Returned to Council Clerk: \_\_\_\_\_ , 2017 at \_\_\_\_\_



**ST. TAMMANY PARISH**

**PATRICIA P. BRISTER**  
PARISH PRESIDENT

**Date:** July 31, 2017

**To:** Joey Lobrano  
Right Of Way Coordinator  
Department Of Public Works

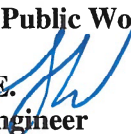
**From:** Jay Watson, P.E.   
Development Engineer

**Re:** District 7  
Project 17-033  
Autumn Wind Ln. 4-F-63  
Autumn Wind Blvd  
5-SPEED LIMIT 15 signs

Council Ordinance Required:

Yes:  No:

At the request of Councilman Jacob B. Groby, III the Department of Planning & Development has no objection to the installation of the following signage in District 7.

1. Raise and Replace Speed Limit 25 sign on Autumn Wind Ln. near Hoffman with a SPEED LIMIT 15 sign.
2. Install SPEED LIMIT 15 sign on Autumn Wind Ln. between addresses 381 and 391.
3. Install SPEED LIMIT 15 sign on Autumn Wind Ln. 40' from the curve on Autumn Wind Ln. as indicated on map.
4. Install SPEED LIMIT 15 sign on Autumn Wind Ln. 40' from the intersection on Autumn Wind Ln. as indicated on map.
5. Remove Speed Limit 25 sign on Autumn Wind Ln. as indicated on map.
6. Remove Speed Limit 25 sign on Autumn Wind Ln. as indicated on map.
7. Install SPEED LIMIT 15 sign on Autumn Wind Ln. entrance as indicated on map.

cc. Councilman Jacob B. Groby, III  
Theodore C. Reynolds  
Michael Spiehler



**Figure 2A-2. Examples of Heights and Lateral Locations of Sign Installations**

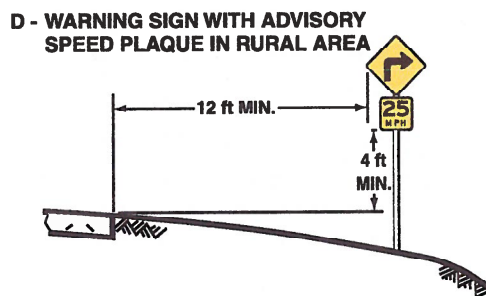
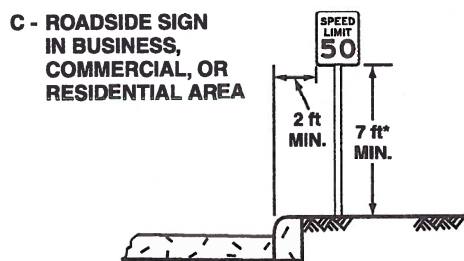
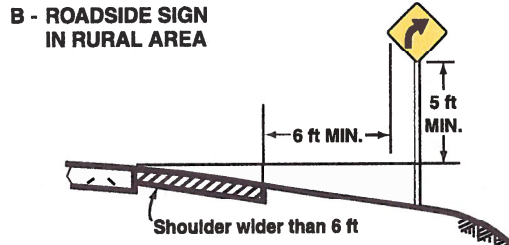
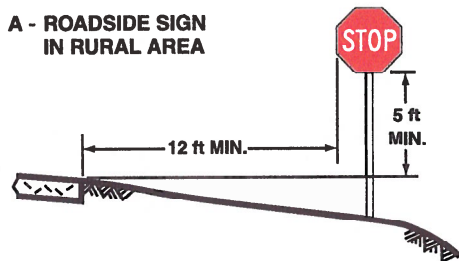

\*Where parking or pedestrian movements are likely to occur

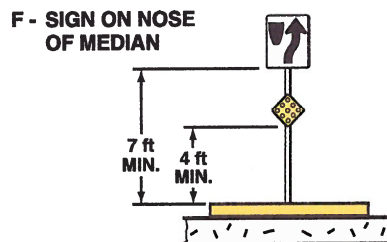
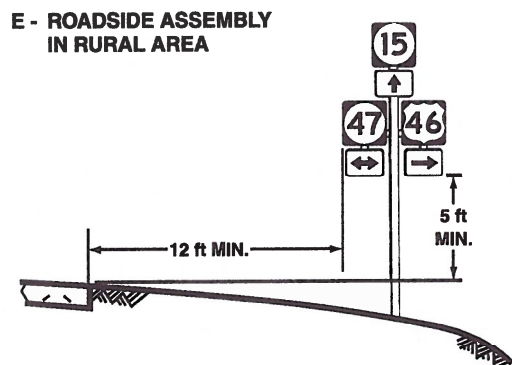

**G - FREEWAY OR EXPRESSWAY SIGN WITH SECONDARY SIGN**

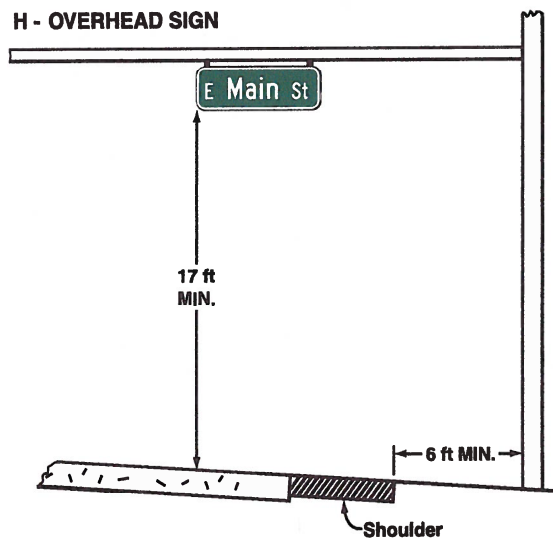
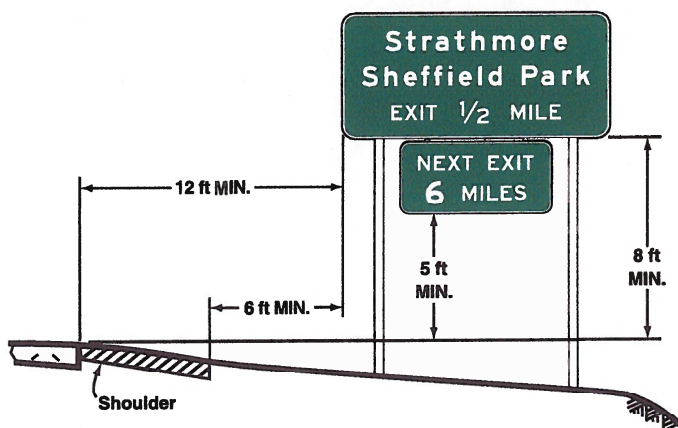

Note:  
See Section 2A.19 for reduced lateral offset distances that may be used in areas where lateral offsets are limited, and in business, commercial, or residential areas where sidewalk width is limited or where existing poles are close to the curb.

**Figure 2A-3. Examples of Locations for Some Typical Signs at Intersections**

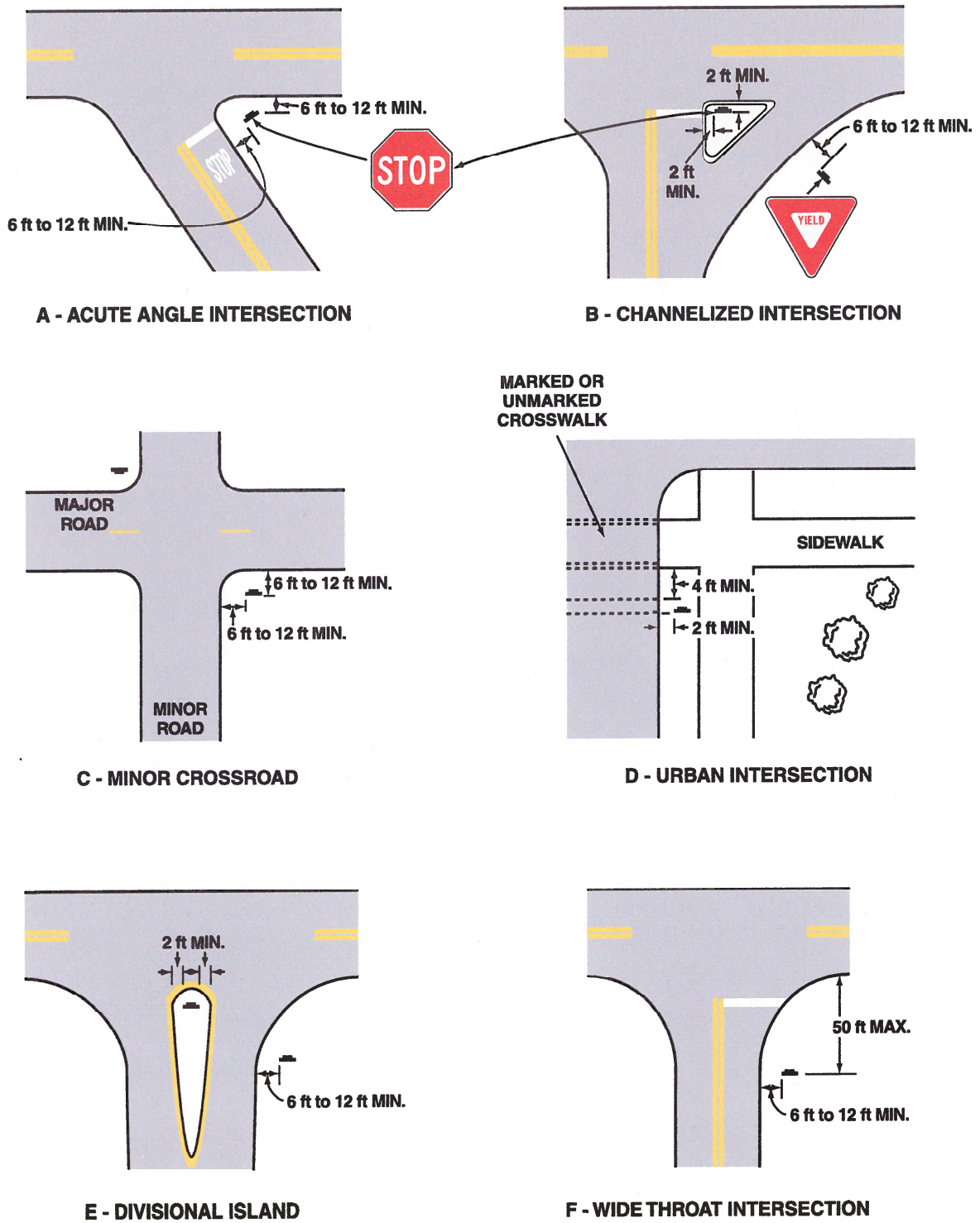

Note: Lateral offset is a minimum of 6 feet measured from the edge of the shoulder, or 12 feet measured from the edge of the traveled way. See Section 2A.19 for lower minimums that may be used in urban areas, or where lateral offset space is limited.