

ST. TAMMANY PARISH COUNCIL

ORDINANCE

ORDINANCE CALENDAR NO: 6399

ORDINANCE COUNCIL SERIES NO: \_\_\_\_\_

COUNCIL SPONSOR: LORINO/COOPER

PROVIDED BY: TU/CIVIL ADA

INTRODUCED BY: MR. FITZGERALD

SECONDED BY: MR. TOLEDANO

ON THE 4 DAY OF JUNE , 2020

ORDINANCE TO AUTHORIZE THE PARISH OF ST. TAMMANY, THROUGH THE OFFICE OF THE PARISH PRESIDENT, TO ENTER INTO A UTILITY SERVICES AGREEMENT FOR WATER AND SEWER SERVICES FOR ARUNDEL SUBDIVISION (WARD 1, DISTRICT 4)

WHEREAS, St. Tammany Parish Government desires to enter into a Utility Services Agreement with the developer of Arundel Subdivision to provide water and sewer treatment services to the subdivision; and

WHEREAS, the developer will install the water/sewer lines and related equipment needed to connect to Parish’s existing systems, at their expense and as more fully described in the Utility Services Agreement to be effected; and

WHEREAS, upon completion and acceptance of the water and sewer lines and related equipment, the developer shall donate said lines and equipment to Parish, as more fully described in the Utility Services Agreement to be effected.

THE PARISH OF ST. TAMMANY HEREBY ORDAINS: that the Office of the Parish President is authorized to exercise its discretion in entering a Utility Services Agreement for provision of water and sewer services to Arundel Subdivision and to take all actions necessary, including entering into all agreements or negotiations in furtherance of the actions contemplated herein; and

BE IT FURTHER ORDAINED: that all actions previously taken by the Office of the Parish President in furtherance of the actions or agreements contemplated herein are hereby ratified and approved.

REPEAL: All ordinances or parts of Ordinances in conflict herewith are hereby repealed.

SEVERABILITY: If any provision of this Ordinance shall be held to be invalid, such invalidity shall not affect other provisions herein which can be given effect without the invalid provision and to this end the provisions of this Ordinance are hereby declared to be severable.

EFFECTIVE DATE: This Ordinance shall become effective fifteen (15) days after adoption.

MOVED FOR ADOPTION BY: \_\_\_\_\_ SECONDED BY: \_\_\_\_\_

WHEREUPON THIS ORDINANCE WAS SUBMITTED TO A VOTE AND RESULTED IN THE FOLLOWING:

YEAS: \_\_\_\_\_

NAYS: \_\_\_\_\_

ABSTAIN: \_\_\_\_\_

ABSENT: \_\_\_\_\_

THIS ORDINANCE WAS DECLARED DULY ADOPTED AT A REGULAR MEETING OF THE PARISH COUNCIL ON THE 9 DAY OF JULY , 2020 ; AND BECOMES ORDINANCE COUNCIL SERIES NO \_\_\_\_\_.

\_\_\_\_\_  
MICHAEL R. LORINO, JR. , COUNCIL CHAIRMAN

ATTEST:

\_\_\_\_\_  
THERESA L. FORD, COUNCIL CLERK

\_\_\_\_\_  
MICHAEL B. COOPER, PARISH PRESIDENT

Published Introduction: MAY 27 , 2020

Published Adoption: \_\_\_\_\_ , 2020

Delivered to Parish President: \_\_\_\_\_ , 2020 at \_\_\_\_\_

Returned to Council Clerk: \_\_\_\_\_ , 2020 at \_\_\_\_\_

### **Ordinance Administrative Comment**

ORDINANCE TO AUTHORIZE THE PARISH OF ST. TAMMANY, THROUGH THE OFFICE OF THE PARISH PRESIDENT, TO ENTER INTO A UTILITY SERVICES AGREEMENT FOR WATER AND SEWER SERVICES FOR ARUNDEL SUBDIVISION (WARD 1, DISTRICT 4)

St. Tammany Parish seeks to enter into a Utility Services Agreement for provision of water/sewer services to Arundel Subdivision. Appurtenant to the Utility Services Agreement will include the donation of lines constructed and/or extended and all related equipment necessary to facilitate such services. This will also include all necessary servitudes for future operation and maintenance by Tammany Utilities.



**TAMMANY UTILITIES**  
DEPT. OF ENVIRONMENTAL SERVICES  
ST. TAMMANY PARISH GOVERNMENT

April 9, 2018

Jim Lark  
123 Tchefuncte Parc Drive  
Madisonville, LA 70447  
Email: jlark@airmail.net

**RE: Arundel, Madisonville, LA**

To Whom It May Concern:

Tammany Utilities (TU) will be able to service water and sewer to the above referenced development through the existing Faubourg Water System (PWS 1103149) and the West St. Tammany Wastewater Treatment Plant (LA0120235). It is the developer's responsibility to have a reputable engineer design the infrastructure for the development, including details of the connections for both the water distribution and sewer collection systems. These plans must be submitted to Tammany Utilities for review and approval before applying for tentative subdivision approval with St. Tammany Parish. Tammany Utilities also needs to approve the Louisiana Licensed Contractor that will construct the tie in and the infrastructure before any work may begin. At such time that the plans have been accepted by Tammany Utilities, our legal counsel will draft a Utility Services Agreement between Tammany Utilities and you, as the developer.

Using the information provided to TU by the developer and the State Sanitary Code Loading Criteria, the following sewer and water capacities were calculated for this development:

<b>Item</b>	<b>Quantity</b>	<b>Units</b>	<b>GPD</b>	<b>Total (gallons)</b>
Water/Sewer Services	25	Lots	400	10,000
			<b>TOTAL:</b>	<b>10,000</b>

Estimated fees may include, but are not limited to:

Water

Fee	Quantity	Unit	Rate	Total
Capacity	10,000	Gallons	\$2.35	\$23,500.00
			<b>TOTAL:</b>	<b>\$23,500.00</b>

Sewer

Fee	Quantity	Unit	Rate	Total
Capacity	10,000	Gallons	\$4.70	\$47,000.00
			<b>TOTAL:</b>	<b>\$47,000.00</b>

Miscellaneous

Fee	Quantity	Unit	Rate	Total
Lift Station	1	L/S	\$25,000.00	\$25,000.00
Legal Fees, Permits. Etc.	1	Fees	\$2,000.00	\$2,000.00
			<b>TOTAL:</b>	<b>\$27,000.00</b>

**Grand Total: \$ 97,500.00**

Please be advised that the above-referenced water system and sewer treatment plant each have limited capacity. This letter should not be construed as a reservation of such capacity. Until such time as a written Utility Services Agreement is executed, Tammany Utilities expressly reserves the right to sell said capacity to any third party. Should the remaining capacity of either the water system or sewer treatment plant be purchased by others before a written Utility Services Agreement is executed and the terms and conditions therein have been fulfilled, Tammany Utilities may be unable to provide such service and you may need to find other alternatives for providing central water and sewer services to your development.

Finally, any and all fees and charges contained herein are estimates. Any and all such fees are subject to change up and until the execution of a written Utility Services Agreement between the developer and Tammany Utilities.

At your convenience, please forward to Tammany Utilities a copy of the engineered plans once prepared for our review, as well as an estimated project timeline. If you have any further questions please call me at 985-893-1717.

Sincerely,  
St. Tammany Parish Government

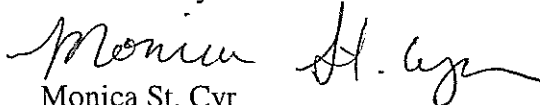
  
Monica St. Cyr  
Tammany Utilities - Field Compliance Coordinator

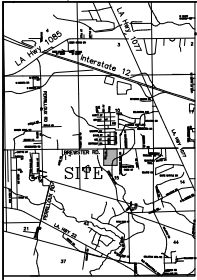

**LEGAL DESCRIPTION**

A certain parcel of ground situated in Section 15, Township-7-South, Range-10-East, Greensburg Land District, St. Tammany Parish, Louisiana and more fully described as follows:

Commence at the 1/4 Section Corner common to Sections 10 & 15 Township-7-South, Range-10-East and measure South 00°44'00" East 28.32' to a point on the new Southern Right of Way of Brewster Rd. and the Point of Beginning.

From the Point of Beginning and having said Southern Right of Way measure South 00°19'28" East a distance of 856.79 feet to a point;

Thence North 89°19'40" West a distance of 856.12 feet to a point;

Thence North 00°25'00" West a distance of 837.41 feet to a point on the said new Southern Right of Way, thence along said Southern Right of Way North 89°40'33" East a distance of 186.84 feet to the point of Beginning, and containing 721,952.57 square feet of 16.57 acres (±), more or less.

**ARUNDEL**  
SECTION 15, T-7-S, R-10-E  
GREENSBURG LAND DISTRICT  
ST. TAMMANY PARISH, LOUISIANA.

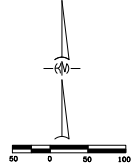

- RESTRICTIVE COVENANTS**
1. THIS PLAT IS NOT TO BE CONSIDERED AS A GUARANTEE OF THE ACCURACY OF THE SURVEYING AND ENGINEERING DATA HEREON, NOR AS A GUARANTEE OF THE ACCURACY OF THE INFORMATION CONTAINED HEREIN. THE ENGINEER AND SURVEYOR SHALL NOT BE RESPONSIBLE FOR ANY ERRORS OR OMISSIONS IN THE DATA OR INFORMATION CONTAINED HEREIN, NOR FOR ANY CONSEQUENCES ARISING FROM THE USE OF THE DATA OR INFORMATION CONTAINED HEREIN.
  2. THE ENGINEER AND SURVEYOR SHALL NOT BE RESPONSIBLE FOR ANY ERRORS OR OMISSIONS IN THE DATA OR INFORMATION CONTAINED HEREIN, NOR FOR ANY CONSEQUENCES ARISING FROM THE USE OF THE DATA OR INFORMATION CONTAINED HEREIN.
  3. THE ENGINEER AND SURVEYOR SHALL NOT BE RESPONSIBLE FOR ANY ERRORS OR OMISSIONS IN THE DATA OR INFORMATION CONTAINED HEREIN, NOR FOR ANY CONSEQUENCES ARISING FROM THE USE OF THE DATA OR INFORMATION CONTAINED HEREIN.
  4. THE ENGINEER AND SURVEYOR SHALL NOT BE RESPONSIBLE FOR ANY ERRORS OR OMISSIONS IN THE DATA OR INFORMATION CONTAINED HEREIN, NOR FOR ANY CONSEQUENCES ARISING FROM THE USE OF THE DATA OR INFORMATION CONTAINED HEREIN.
  5. THE ENGINEER AND SURVEYOR SHALL NOT BE RESPONSIBLE FOR ANY ERRORS OR OMISSIONS IN THE DATA OR INFORMATION CONTAINED HEREIN, NOR FOR ANY CONSEQUENCES ARISING FROM THE USE OF THE DATA OR INFORMATION CONTAINED HEREIN.
  6. THE ENGINEER AND SURVEYOR SHALL NOT BE RESPONSIBLE FOR ANY ERRORS OR OMISSIONS IN THE DATA OR INFORMATION CONTAINED HEREIN, NOR FOR ANY CONSEQUENCES ARISING FROM THE USE OF THE DATA OR INFORMATION CONTAINED HEREIN.
  7. THE ENGINEER AND SURVEYOR SHALL NOT BE RESPONSIBLE FOR ANY ERRORS OR OMISSIONS IN THE DATA OR INFORMATION CONTAINED HEREIN, NOR FOR ANY CONSEQUENCES ARISING FROM THE USE OF THE DATA OR INFORMATION CONTAINED HEREIN.
  8. THE ENGINEER AND SURVEYOR SHALL NOT BE RESPONSIBLE FOR ANY ERRORS OR OMISSIONS IN THE DATA OR INFORMATION CONTAINED HEREIN, NOR FOR ANY CONSEQUENCES ARISING FROM THE USE OF THE DATA OR INFORMATION CONTAINED HEREIN.
  9. THE ENGINEER AND SURVEYOR SHALL NOT BE RESPONSIBLE FOR ANY ERRORS OR OMISSIONS IN THE DATA OR INFORMATION CONTAINED HEREIN, NOR FOR ANY CONSEQUENCES ARISING FROM THE USE OF THE DATA OR INFORMATION CONTAINED HEREIN.
  10. THE ENGINEER AND SURVEYOR SHALL NOT BE RESPONSIBLE FOR ANY ERRORS OR OMISSIONS IN THE DATA OR INFORMATION CONTAINED HEREIN, NOR FOR ANY CONSEQUENCES ARISING FROM THE USE OF THE DATA OR INFORMATION CONTAINED HEREIN.
  11. THE ENGINEER AND SURVEYOR SHALL NOT BE RESPONSIBLE FOR ANY ERRORS OR OMISSIONS IN THE DATA OR INFORMATION CONTAINED HEREIN, NOR FOR ANY CONSEQUENCES ARISING FROM THE USE OF THE DATA OR INFORMATION CONTAINED HEREIN.
  12. THE ENGINEER AND SURVEYOR SHALL NOT BE RESPONSIBLE FOR ANY ERRORS OR OMISSIONS IN THE DATA OR INFORMATION CONTAINED HEREIN, NOR FOR ANY CONSEQUENCES ARISING FROM THE USE OF THE DATA OR INFORMATION CONTAINED HEREIN.
  13. THE ENGINEER AND SURVEYOR SHALL NOT BE RESPONSIBLE FOR ANY ERRORS OR OMISSIONS IN THE DATA OR INFORMATION CONTAINED HEREIN, NOR FOR ANY CONSEQUENCES ARISING FROM THE USE OF THE DATA OR INFORMATION CONTAINED HEREIN.

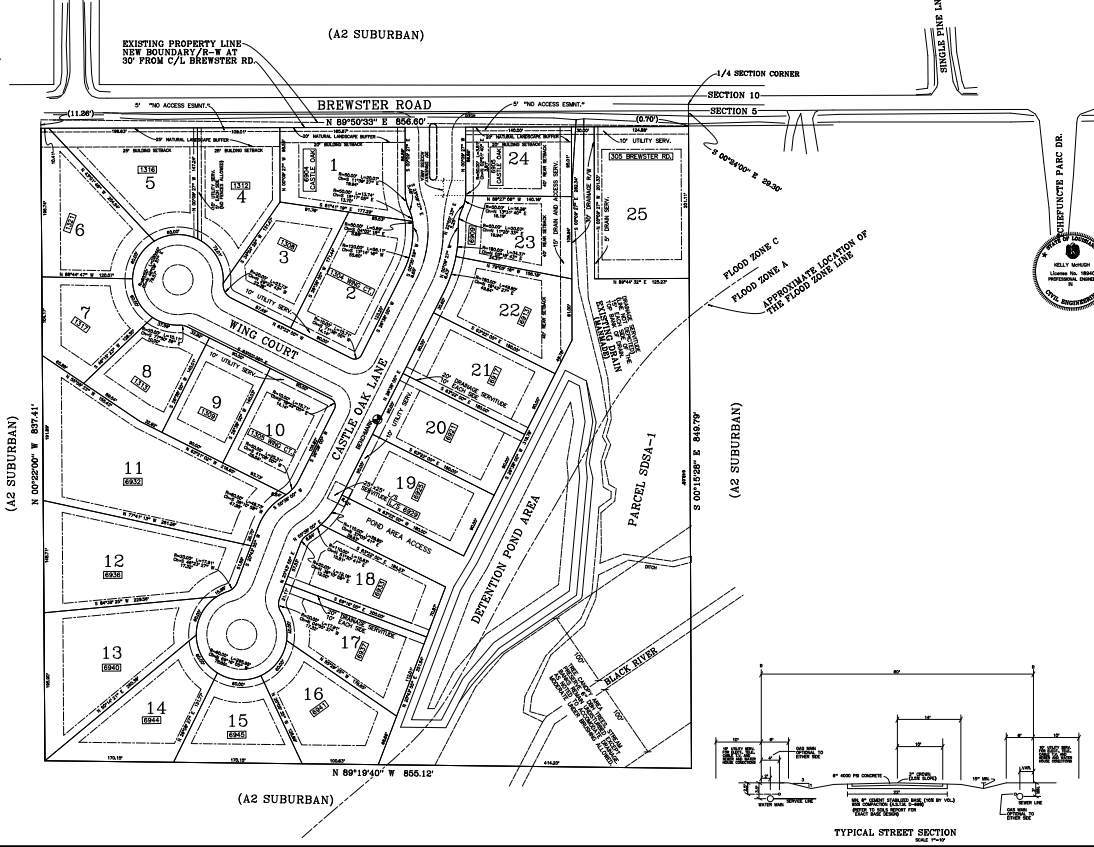
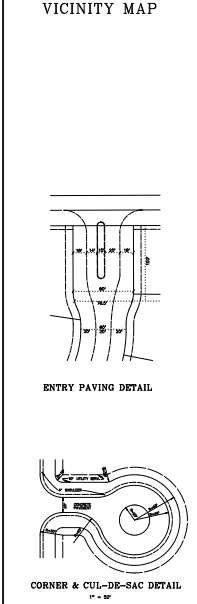

**DEDICATION**

ALL STREET RIGHTS OF WAY AND DETENTION POND AS SHOWN HEREON ARE HEREBY DEDICATED TO THE PUBLIC USE OF THE STATE OF LOUISIANA, TO BE MAINTAINED AND IMPROVED BY THE STATE OF LOUISIANA, AND TO BE SUBJECT TO THE SUPERVISION OF THE SUPERVISOR OF THE DISTRICT.

**PROFESSIONAL ENGINEER AND SURVEYOR**

KELLY J. McHUGH  
License No. 4442  
Professional Engineer  
Professional Surveyor

NO.	DATE	DESCRIPTION
1	04-16-20	PRELIMINARY PLAT
2	04-16-20	FINAL PLAT

FOR:	APPROVAL:
NO. 11 LOT	CHANDLER PARISH PLANNING COMMISSION
NO. 12 LOT	ST. TAMMANY PARISH PLANNING COMMISSION
NO. 13 LOT	ST. TAMMANY PARISH PLANNING COMMISSION
NO. 14 LOT	ST. TAMMANY PARISH PLANNING COMMISSION
NO. 15 LOT	ST. TAMMANY PARISH PLANNING COMMISSION
NO. 16 LOT	ST. TAMMANY PARISH PLANNING COMMISSION
NO. 17 LOT	ST. TAMMANY PARISH PLANNING COMMISSION
NO. 18 LOT	ST. TAMMANY PARISH PLANNING COMMISSION
NO. 19 LOT	ST. TAMMANY PARISH PLANNING COMMISSION
NO. 20 LOT	ST. TAMMANY PARISH PLANNING COMMISSION
NO. 21 LOT	ST. TAMMANY PARISH PLANNING COMMISSION
NO. 22 LOT	ST. TAMMANY PARISH PLANNING COMMISSION
NO. 23 LOT	ST. TAMMANY PARISH PLANNING COMMISSION
NO. 24 LOT	ST. TAMMANY PARISH PLANNING COMMISSION
NO. 25 LOT	ST. TAMMANY PARISH PLANNING COMMISSION

**FINAL PLAT**

ARUNDEL  
SECTION 15, T-7-S, R-10-E  
GREENSBURG LAND DISTRICT  
ST. TAMMANY PARISH, LOUISIANA.

KELLY J. McHUGH & ASSOC., INC.  
CIVIL ENGINEERS & LAND SURVEYORS  
845 CALVEZ ST., MARKEVILLE, LA.

NO.	DATE	DESCRIPTION
1	04-16-20	PRELIMINARY PLAT
2	04-16-20	FINAL PLAT

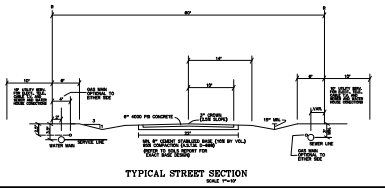

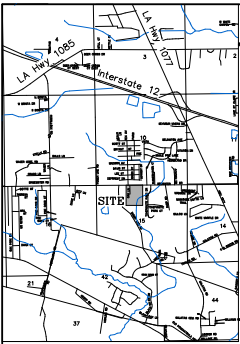

VICINITY MAP

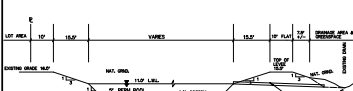

SECTION A-A

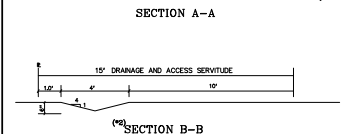

SECTION B-B

CULVERT SCHEDULE

ALL LOTS 15' DIA.  
 USE ARCH CULVERT WHEN DITCH DEPTH DOES NOT ALLOW ADEQUATE COVER FOR PIPE.  
 ALL CULVERTS SHALL BE 15' DIA. UNLESS OTHERWISE NOTED.  
 ALL CULVERTS SHALL BE 15' DIA. UNLESS OTHERWISE NOTED.  
 ALL CULVERTS SHALL BE 15' DIA. UNLESS OTHERWISE NOTED.

LOT #	UPSTREAM	DOWNSTREAM	LOT #	UPSTREAM	DOWNSTREAM
1	18.0	18.0	13	18.0	18.0
2 (2nd)	18.0	18.0	14	18.0	18.0
3 (2nd)	18.0	18.0	15	18.0	18.0
4	17.0	16.9	16	18.0	18.0
5	17.0	17.0	17	18.0	18.0
6	17.0	17.0	18	18.0	18.0
7	17.0	17.0	19	18.0	18.0
8	17.0	17.0	20	18.0	18.0
9	17.0	17.0	21	18.0	18.0
10 (2nd)	18.0	18.0	22	18.0	18.0
11	18.0	18.0	23	18.0	18.0
12	18.0	18.0	24	18.0	18.0

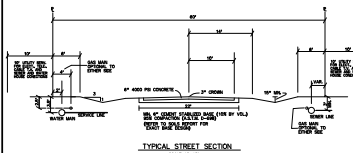

TYPICAL STREET SECTION

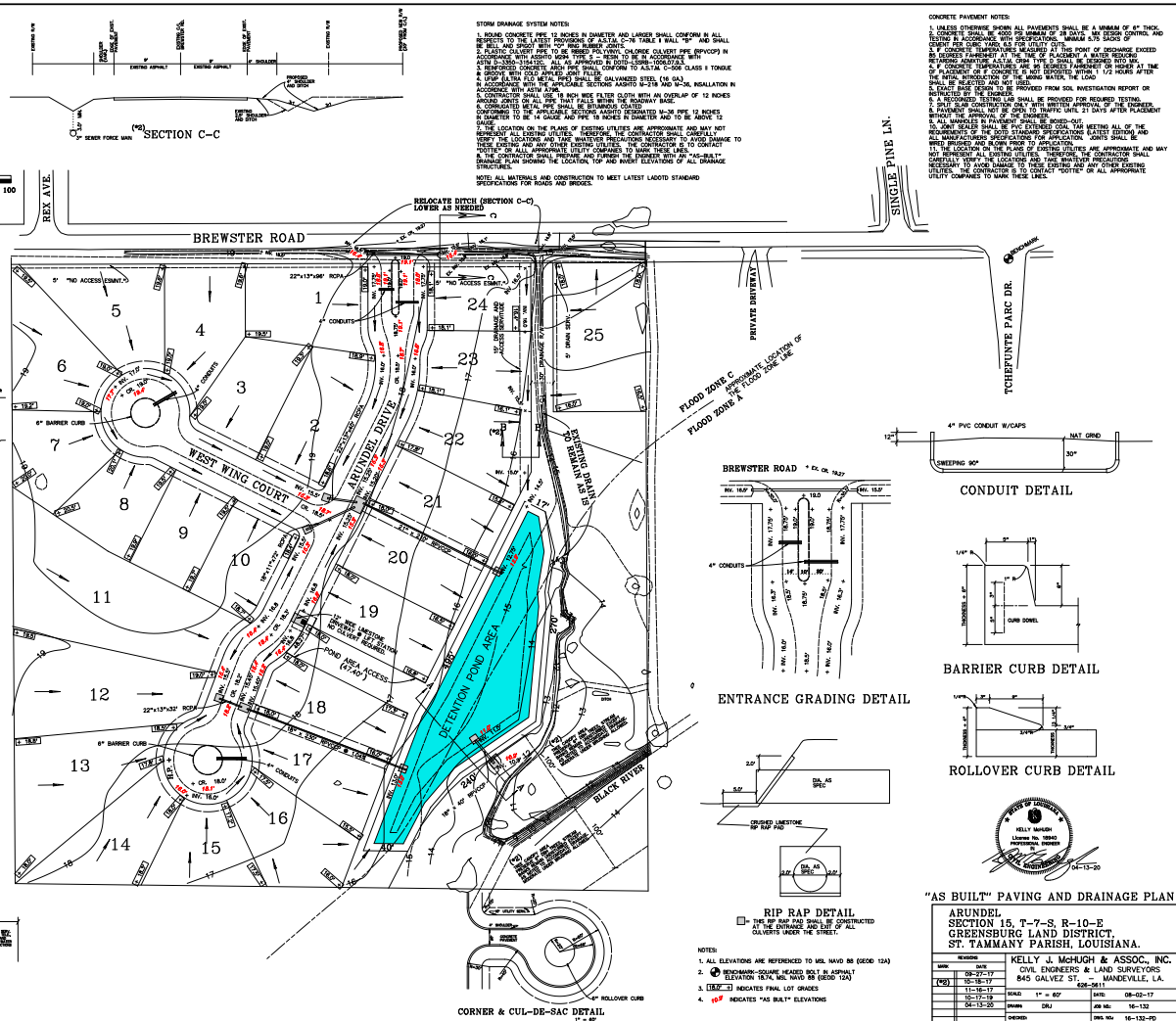

STORM DRAINAGE SYSTEM NOTES:

1. ROUND CONCRETE PIPE 12 INCHES IN DIAMETER AND LARGER SHALL CONFORM TO ALL APPLICABLE STANDARDS AND SPECIFICATIONS.
2. ALL CONCRETE PIPE SHALL BE 15' LONG UNLESS OTHERWISE NOTED.
3. ALL CONCRETE PIPE SHALL BE 15' LONG UNLESS OTHERWISE NOTED.
4. ALL CONCRETE PIPE SHALL BE 15' LONG UNLESS OTHERWISE NOTED.
5. ALL CONCRETE PIPE SHALL BE 15' LONG UNLESS OTHERWISE NOTED.
6. ALL CONCRETE PIPE SHALL BE 15' LONG UNLESS OTHERWISE NOTED.
7. ALL CONCRETE PIPE SHALL BE 15' LONG UNLESS OTHERWISE NOTED.
8. ALL CONCRETE PIPE SHALL BE 15' LONG UNLESS OTHERWISE NOTED.
9. ALL CONCRETE PIPE SHALL BE 15' LONG UNLESS OTHERWISE NOTED.
10. ALL CONCRETE PIPE SHALL BE 15' LONG UNLESS OTHERWISE NOTED.
11. ALL CONCRETE PIPE SHALL BE 15' LONG UNLESS OTHERWISE NOTED.
12. ALL CONCRETE PIPE SHALL BE 15' LONG UNLESS OTHERWISE NOTED.
13. ALL CONCRETE PIPE SHALL BE 15' LONG UNLESS OTHERWISE NOTED.
14. ALL CONCRETE PIPE SHALL BE 15' LONG UNLESS OTHERWISE NOTED.
15. ALL CONCRETE PIPE SHALL BE 15' LONG UNLESS OTHERWISE NOTED.
16. ALL CONCRETE PIPE SHALL BE 15' LONG UNLESS OTHERWISE NOTED.
17. ALL CONCRETE PIPE SHALL BE 15' LONG UNLESS OTHERWISE NOTED.
18. ALL CONCRETE PIPE SHALL BE 15' LONG UNLESS OTHERWISE NOTED.
19. ALL CONCRETE PIPE SHALL BE 15' LONG UNLESS OTHERWISE NOTED.
20. ALL CONCRETE PIPE SHALL BE 15' LONG UNLESS OTHERWISE NOTED.
21. ALL CONCRETE PIPE SHALL BE 15' LONG UNLESS OTHERWISE NOTED.
22. ALL CONCRETE PIPE SHALL BE 15' LONG UNLESS OTHERWISE NOTED.
23. ALL CONCRETE PIPE SHALL BE 15' LONG UNLESS OTHERWISE NOTED.
24. ALL CONCRETE PIPE SHALL BE 15' LONG UNLESS OTHERWISE NOTED.

CONCRETE PAVEMENT NOTES:

1. UNLESS OTHERWISE NOTED ALL PAVEMENT SHALL BE A MINIMUM OF 4\"/>
- 2. ALL CONCRETE SHALL BE 4\"/>
- 3. ALL CONCRETE SHALL BE 4\"/>
- 4. ALL CONCRETE SHALL BE 4\"/>
- 5. ALL CONCRETE SHALL BE 4\"/>
- 6. ALL CONCRETE SHALL BE 4\"/>
- 7. ALL CONCRETE SHALL BE 4\"/>
- 8. ALL CONCRETE SHALL BE 4\"/>
- 9. ALL CONCRETE SHALL BE 4\"/>
- 10. ALL CONCRETE SHALL BE 4\"/>
- 11. ALL CONCRETE SHALL BE 4\"/>
- 12. ALL CONCRETE SHALL BE 4\"/>
- 13. ALL CONCRETE SHALL BE 4\"/>
- 14. ALL CONCRETE SHALL BE 4\"/>
- 15. ALL CONCRETE SHALL BE 4\"/>
- 16. ALL CONCRETE SHALL BE 4\"/>
- 17. ALL CONCRETE SHALL BE 4\"/>
- 18. ALL CONCRETE SHALL BE 4\"/>
- 19. ALL CONCRETE SHALL BE 4\"/>
- 20. ALL CONCRETE SHALL BE 4\"/>
- 21. ALL CONCRETE SHALL BE 4\"/>
- 22. ALL CONCRETE SHALL BE 4\"/>
- 23. ALL CONCRETE SHALL BE 4\"/>
- 24. ALL CONCRETE SHALL BE 4\"/>

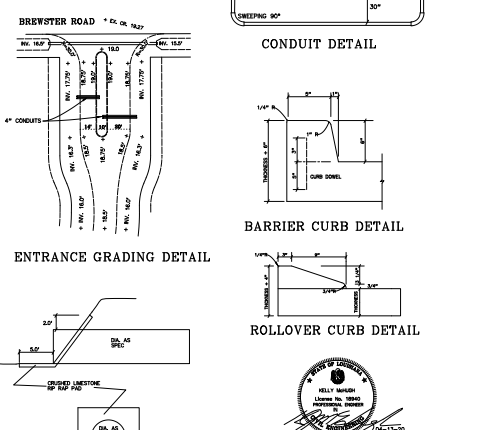

RIP RAP DETAIL

TYPE OF RIP RAP SHALL BE CONSTRUCTED AT THE ENTRANCE AND EXIT OF ALL CULVERTS UNDER THE STREET.

1. ALL ELEVATIONS ARE REFERENCED TO MSL NAVD 83 (ECCO 124)
2. ALL ELEVATIONS ARE REFERENCED TO MSL NAVD 83 (ECCO 124)
3. ALL ELEVATIONS ARE REFERENCED TO MSL NAVD 83 (ECCO 124)
4. ALL ELEVATIONS ARE REFERENCED TO MSL NAVD 83 (ECCO 124)



"AS BUILT" PAVING AND DRAINAGE PLAN

DATE	DESCRIPTION	BY	CHECKED
08-22-17	ISSUED FOR PERMIT	KJM	SM
11-16-17	REVISED PER COMMENTS	KJM	SM
04-13-20	REVISED PER COMMENTS	KJM	SM
08-02-17	ISSUED FOR PERMIT	KJM	SM
10-12-17	REVISED PER COMMENTS	KJM	SM
10-12-17	REVISED PER COMMENTS	KJM	SM

KELLY J. McHUGH & ASSOC., INC.  
 CIVIL ENGINEERS & LAND SURVEYORS  
 845 GALVEZ ST. - MANDEVILLE, LA.  
 ST. TAMMANY PARISH, LOUISIANA.

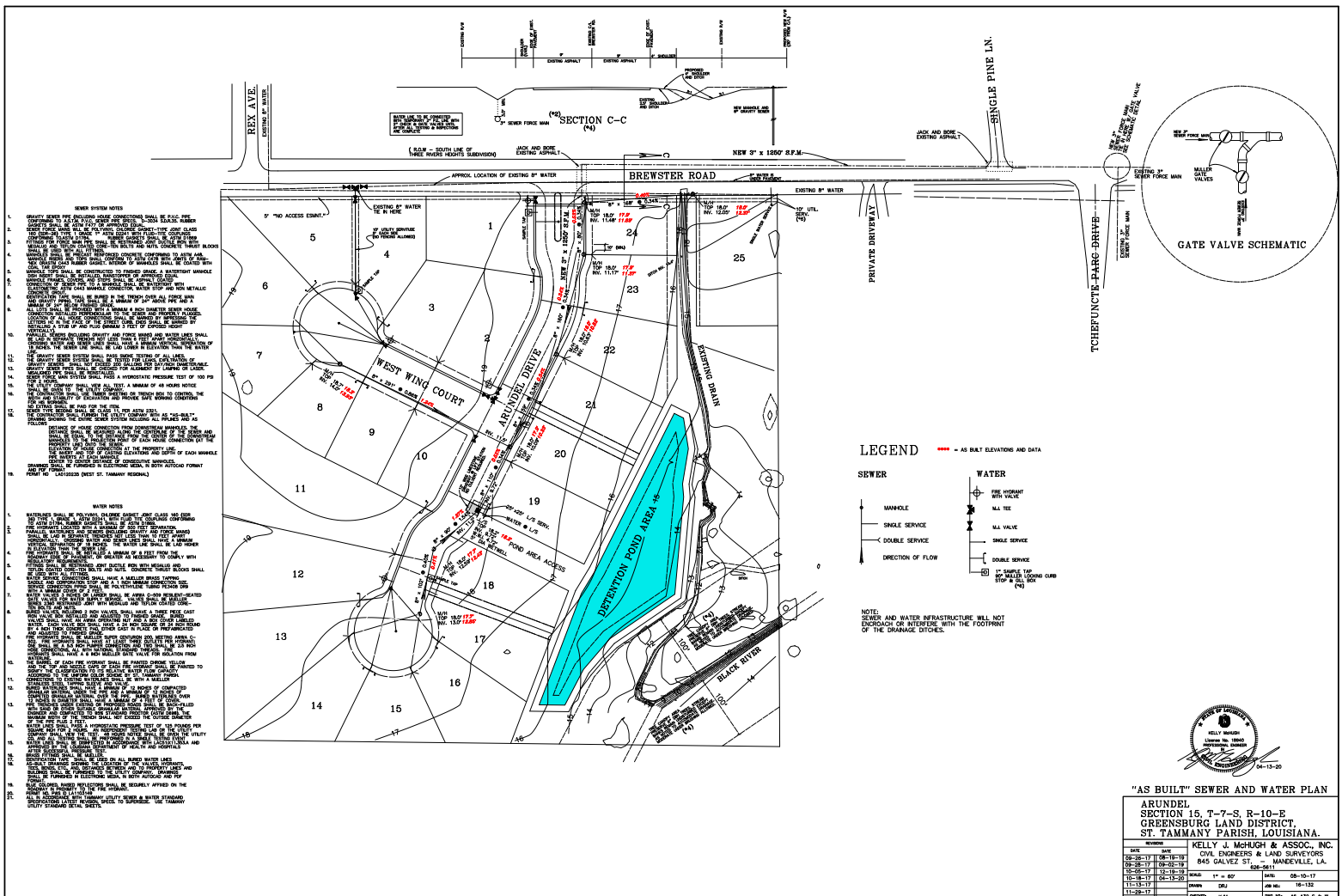

**SEWER SYSTEM NOTES**

1. ALL SEWER SYSTEMS SHALL BE DESIGNED TO SERVE THE ENTIRE PLANNED AREA AND TO BE CONFORMANT WITH THE LATEST EDITIONS OF THE SEWER DESIGN HANDBOOK AND THE SEWERAGE AND WASTEWATER ENGINEERING MANUAL.
2. THE SEWER SYSTEM SHALL BE DESIGNED TO OPERATE AT A FLOW VELOCITY OF NOT LESS THAN 2.0 FEET PER SECOND AT ALL TIMES.
3. THE SEWER SYSTEM SHALL BE DESIGNED TO OPERATE AT A FLOW VELOCITY OF NOT MORE THAN 10.0 FEET PER SECOND AT ALL TIMES.
4. THE SEWER SYSTEM SHALL BE DESIGNED TO OPERATE AT A FLOW VELOCITY OF NOT MORE THAN 15.0 FEET PER SECOND AT ALL TIMES.
5. THE SEWER SYSTEM SHALL BE DESIGNED TO OPERATE AT A FLOW VELOCITY OF NOT MORE THAN 20.0 FEET PER SECOND AT ALL TIMES.
6. THE SEWER SYSTEM SHALL BE DESIGNED TO OPERATE AT A FLOW VELOCITY OF NOT MORE THAN 25.0 FEET PER SECOND AT ALL TIMES.
7. THE SEWER SYSTEM SHALL BE DESIGNED TO OPERATE AT A FLOW VELOCITY OF NOT MORE THAN 30.0 FEET PER SECOND AT ALL TIMES.
8. THE SEWER SYSTEM SHALL BE DESIGNED TO OPERATE AT A FLOW VELOCITY OF NOT MORE THAN 35.0 FEET PER SECOND AT ALL TIMES.
9. THE SEWER SYSTEM SHALL BE DESIGNED TO OPERATE AT A FLOW VELOCITY OF NOT MORE THAN 40.0 FEET PER SECOND AT ALL TIMES.
10. THE SEWER SYSTEM SHALL BE DESIGNED TO OPERATE AT A FLOW VELOCITY OF NOT MORE THAN 45.0 FEET PER SECOND AT ALL TIMES.
11. THE SEWER SYSTEM SHALL BE DESIGNED TO OPERATE AT A FLOW VELOCITY OF NOT MORE THAN 50.0 FEET PER SECOND AT ALL TIMES.
12. THE SEWER SYSTEM SHALL BE DESIGNED TO OPERATE AT A FLOW VELOCITY OF NOT MORE THAN 55.0 FEET PER SECOND AT ALL TIMES.
13. THE SEWER SYSTEM SHALL BE DESIGNED TO OPERATE AT A FLOW VELOCITY OF NOT MORE THAN 60.0 FEET PER SECOND AT ALL TIMES.
14. THE SEWER SYSTEM SHALL BE DESIGNED TO OPERATE AT A FLOW VELOCITY OF NOT MORE THAN 65.0 FEET PER SECOND AT ALL TIMES.
15. THE SEWER SYSTEM SHALL BE DESIGNED TO OPERATE AT A FLOW VELOCITY OF NOT MORE THAN 70.0 FEET PER SECOND AT ALL TIMES.
16. THE SEWER SYSTEM SHALL BE DESIGNED TO OPERATE AT A FLOW VELOCITY OF NOT MORE THAN 75.0 FEET PER SECOND AT ALL TIMES.
17. THE SEWER SYSTEM SHALL BE DESIGNED TO OPERATE AT A FLOW VELOCITY OF NOT MORE THAN 80.0 FEET PER SECOND AT ALL TIMES.
18. THE SEWER SYSTEM SHALL BE DESIGNED TO OPERATE AT A FLOW VELOCITY OF NOT MORE THAN 85.0 FEET PER SECOND AT ALL TIMES.
19. THE SEWER SYSTEM SHALL BE DESIGNED TO OPERATE AT A FLOW VELOCITY OF NOT MORE THAN 90.0 FEET PER SECOND AT ALL TIMES.
20. THE SEWER SYSTEM SHALL BE DESIGNED TO OPERATE AT A FLOW VELOCITY OF NOT MORE THAN 95.0 FEET PER SECOND AT ALL TIMES.
21. THE SEWER SYSTEM SHALL BE DESIGNED TO OPERATE AT A FLOW VELOCITY OF NOT MORE THAN 100.0 FEET PER SECOND AT ALL TIMES.
22. THE SEWER SYSTEM SHALL BE DESIGNED TO OPERATE AT A FLOW VELOCITY OF NOT MORE THAN 105.0 FEET PER SECOND AT ALL TIMES.
23. THE SEWER SYSTEM SHALL BE DESIGNED TO OPERATE AT A FLOW VELOCITY OF NOT MORE THAN 110.0 FEET PER SECOND AT ALL TIMES.
24. THE SEWER SYSTEM SHALL BE DESIGNED TO OPERATE AT A FLOW VELOCITY OF NOT MORE THAN 115.0 FEET PER SECOND AT ALL TIMES.
25. THE SEWER SYSTEM SHALL BE DESIGNED TO OPERATE AT A FLOW VELOCITY OF NOT MORE THAN 120.0 FEET PER SECOND AT ALL TIMES.

**WATER NOTES**

1. THE WATER SYSTEM SHALL BE DESIGNED TO SERVE THE ENTIRE PLANNED AREA AND TO BE CONFORMANT WITH THE LATEST EDITIONS OF THE WATER SUPPLY ENGINEERING HANDBOOK AND THE WATER SUPPLY ENGINEERING MANUAL.
2. THE WATER SYSTEM SHALL BE DESIGNED TO OPERATE AT A FLOW VELOCITY OF NOT LESS THAN 2.0 FEET PER SECOND AT ALL TIMES.
3. THE WATER SYSTEM SHALL BE DESIGNED TO OPERATE AT A FLOW VELOCITY OF NOT MORE THAN 10.0 FEET PER SECOND AT ALL TIMES.
4. THE WATER SYSTEM SHALL BE DESIGNED TO OPERATE AT A FLOW VELOCITY OF NOT MORE THAN 15.0 FEET PER SECOND AT ALL TIMES.
5. THE WATER SYSTEM SHALL BE DESIGNED TO OPERATE AT A FLOW VELOCITY OF NOT MORE THAN 20.0 FEET PER SECOND AT ALL TIMES.
6. THE WATER SYSTEM SHALL BE DESIGNED TO OPERATE AT A FLOW VELOCITY OF NOT MORE THAN 25.0 FEET PER SECOND AT ALL TIMES.
7. THE WATER SYSTEM SHALL BE DESIGNED TO OPERATE AT A FLOW VELOCITY OF NOT MORE THAN 30.0 FEET PER SECOND AT ALL TIMES.
8. THE WATER SYSTEM SHALL BE DESIGNED TO OPERATE AT A FLOW VELOCITY OF NOT MORE THAN 35.0 FEET PER SECOND AT ALL TIMES.
9. THE WATER SYSTEM SHALL BE DESIGNED TO OPERATE AT A FLOW VELOCITY OF NOT MORE THAN 40.0 FEET PER SECOND AT ALL TIMES.
10. THE WATER SYSTEM SHALL BE DESIGNED TO OPERATE AT A FLOW VELOCITY OF NOT MORE THAN 45.0 FEET PER SECOND AT ALL TIMES.
11. THE WATER SYSTEM SHALL BE DESIGNED TO OPERATE AT A FLOW VELOCITY OF NOT MORE THAN 50.0 FEET PER SECOND AT ALL TIMES.
12. THE WATER SYSTEM SHALL BE DESIGNED TO OPERATE AT A FLOW VELOCITY OF NOT MORE THAN 55.0 FEET PER SECOND AT ALL TIMES.
13. THE WATER SYSTEM SHALL BE DESIGNED TO OPERATE AT A FLOW VELOCITY OF NOT MORE THAN 60.0 FEET PER SECOND AT ALL TIMES.
14. THE WATER SYSTEM SHALL BE DESIGNED TO OPERATE AT A FLOW VELOCITY OF NOT MORE THAN 65.0 FEET PER SECOND AT ALL TIMES.
15. THE WATER SYSTEM SHALL BE DESIGNED TO OPERATE AT A FLOW VELOCITY OF NOT MORE THAN 70.0 FEET PER SECOND AT ALL TIMES.
16. THE WATER SYSTEM SHALL BE DESIGNED TO OPERATE AT A FLOW VELOCITY OF NOT MORE THAN 75.0 FEET PER SECOND AT ALL TIMES.
17. THE WATER SYSTEM SHALL BE DESIGNED TO OPERATE AT A FLOW VELOCITY OF NOT MORE THAN 80.0 FEET PER SECOND AT ALL TIMES.
18. THE WATER SYSTEM SHALL BE DESIGNED TO OPERATE AT A FLOW VELOCITY OF NOT MORE THAN 85.0 FEET PER SECOND AT ALL TIMES.
19. THE WATER SYSTEM SHALL BE DESIGNED TO OPERATE AT A FLOW VELOCITY OF NOT MORE THAN 90.0 FEET PER SECOND AT ALL TIMES.
20. THE WATER SYSTEM SHALL BE DESIGNED TO OPERATE AT A FLOW VELOCITY OF NOT MORE THAN 95.0 FEET PER SECOND AT ALL TIMES.
21. THE WATER SYSTEM SHALL BE DESIGNED TO OPERATE AT A FLOW VELOCITY OF NOT MORE THAN 100.0 FEET PER SECOND AT ALL TIMES.
22. THE WATER SYSTEM SHALL BE DESIGNED TO OPERATE AT A FLOW VELOCITY OF NOT MORE THAN 105.0 FEET PER SECOND AT ALL TIMES.
23. THE WATER SYSTEM SHALL BE DESIGNED TO OPERATE AT A FLOW VELOCITY OF NOT MORE THAN 110.0 FEET PER SECOND AT ALL TIMES.
24. THE WATER SYSTEM SHALL BE DESIGNED TO OPERATE AT A FLOW VELOCITY OF NOT MORE THAN 115.0 FEET PER SECOND AT ALL TIMES.
25. THE WATER SYSTEM SHALL BE DESIGNED TO OPERATE AT A FLOW VELOCITY OF NOT MORE THAN 120.0 FEET PER SECOND AT ALL TIMES.

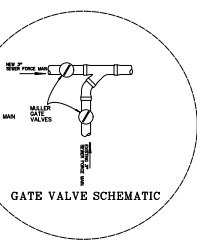
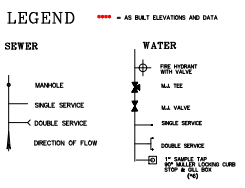

**"AS BUILT" SEWER AND WATER PLAN**

ARUNDEL  
SECTION 15, T-7-S, R-10-E  
GREENSBURG LAND DISTRICT,  
ST. TAMMANY PARISH, LOUISIANA.

DATE		REVISION	
02-28-17	02-28-17	08-10-17	08-10-17
03-16-17	03-16-17	08-10-17	08-10-17
03-16-17	03-16-17	08-10-17	08-10-17
03-16-17	03-16-17	08-10-17	08-10-17
03-16-17	03-16-17	08-10-17	08-10-17
03-16-17	03-16-17	08-10-17	08-10-17
03-16-17	03-16-17	08-10-17	08-10-17
03-16-17	03-16-17	08-10-17	08-10-17
03-16-17	03-16-17	08-10-17	08-10-17
03-16-17	03-16-17	08-10-17	08-10-17
03-16-17	03-16-17	08-10-17	08-10-17
03-16-17	03-16-17	08-10-17	08-10-17
03-16-17	03-16-17	08-10-17	08-10-17
03-16-17	03-16-17	08-10-17	08-10-17
03-16-17	03-16-17	08-10-17	08-10-17
03-16-17	03-16-17	08-10-17	08-10-17
03-16-17	03-16-17	08-10-17	08-10-17
03-16-17	03-16-17	08-10-17	08-10-17
03-16-17	03-16-17	08-10-17	08-10-17

KELLY J. McHUGH & ASSOC., INC.  
CIVIL ENGINEERS & LAND SURVEYORS  
845 GALVEZ ST. MANDEVILLE, LA. 70071  
PH: 981-861-1313  
FAX: 981-861-1314



**LEGEND**

- ◻ STREET NAME SIGN
- STOP SIGN
- 15 MPH SPEED LIMIT SIGN
- △ NO OUTLET SIGN

STREET SIGNAGE IS TO BE OBTAINED AND MAINTAINED BY ST. TAMMANY PARISH.

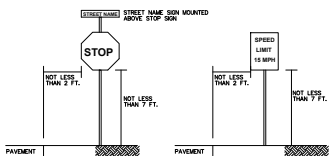
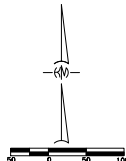
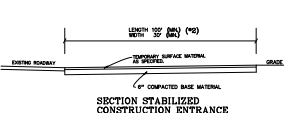

**SIGN INSTALLATION DETAIL**

1. ALL SIGNAGE SHALL BE TYPE B-HIGH INTENSITY REFLECTIVE IN ACCORDANCE WITH THE MUTCD SPECIFICATIONS. ALL SIGNS SHALL CONFORM TO ALL MUTCD AND PARISH REQUIREMENTS. A COPY OF PARISH REQUIREMENTS CAN BE OBTAINED FROM THE ST. TAMMANY PARISH OFFICE ENGINEER. ALL STREET NAME SIGNS MUST BE WHITE LETTERING ON A BLUE BACKGROUND.

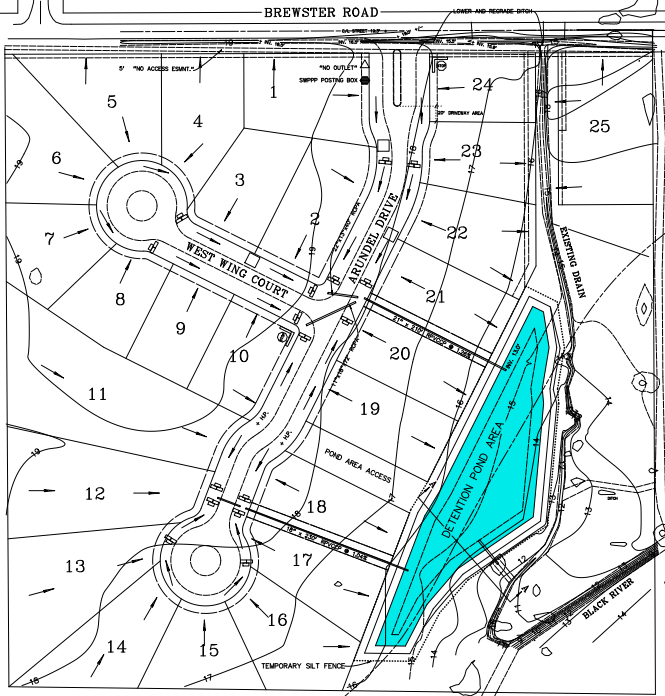

FLOOD ZONE C  
FLOOD ZONE A  
APPROXIMATE LOCATION OF THE FLOOD ZONE DATE

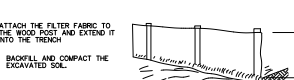

**TEMPORARY SILT FENCE**  
N.T.S.

INDICATES SILT FENCE

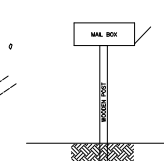

**STORMWATER POLLUTION PREVENTION PLAN ON SITE STORAGE BOX**  
**DETAIL**

STORMWATER POLLUTION PREVENTION PLAN IS TO BE INSTALLED AT ALL TIMES.

**STORMWATER POLLUTION PREVENTION PLAN AND "AS BUILT" SIGNAGE PLAN**

ARUNDEL SECTION 16, T-7-S, R-10-E GREENSBURG LAND DISTRICT, ST. TAMMANY PARISH, LOUISIANA.

NO.	DATE	BY	REVISION
(01)	02-27-17	KJM	ISSUED FOR PERMITS
(02)	05-16-17	KJM	REVISED TO ADD SIGNAGE
(03)	05-18-17	KJM	REVISED TO ADD SIGNAGE
(04)	05-18-17	KJM	REVISED TO ADD SIGNAGE
(05)	05-18-17	KJM	REVISED TO ADD SIGNAGE
(06)	05-18-17	KJM	REVISED TO ADD SIGNAGE
(07)	05-18-17	KJM	REVISED TO ADD SIGNAGE
(08)	05-18-17	KJM	REVISED TO ADD SIGNAGE
(09)	05-18-17	KJM	REVISED TO ADD SIGNAGE
(10)	05-18-17	KJM	REVISED TO ADD SIGNAGE
(11)	05-18-17	KJM	REVISED TO ADD SIGNAGE
(12)	05-18-17	KJM	REVISED TO ADD SIGNAGE
(13)	05-18-17	KJM	REVISED TO ADD SIGNAGE
(14)	05-18-17	KJM	REVISED TO ADD SIGNAGE
(15)	05-18-17	KJM	REVISED TO ADD SIGNAGE
(16)	05-18-17	KJM	REVISED TO ADD SIGNAGE
(17)	05-18-17	KJM	REVISED TO ADD SIGNAGE
(18)	05-18-17	KJM	REVISED TO ADD SIGNAGE
(19)	05-18-17	KJM	REVISED TO ADD SIGNAGE
(20)	05-18-17	KJM	REVISED TO ADD SIGNAGE
(21)	05-18-17	KJM	REVISED TO ADD SIGNAGE
(22)	05-18-17	KJM	REVISED TO ADD SIGNAGE
(23)	05-18-17	KJM	REVISED TO ADD SIGNAGE
(24)	05-18-17	KJM	REVISED TO ADD SIGNAGE
(25)	05-18-17	KJM	REVISED TO ADD SIGNAGE

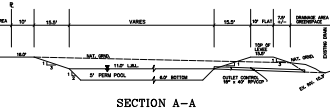

**SECTION A-A**

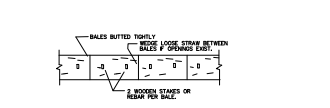

**PLAN**

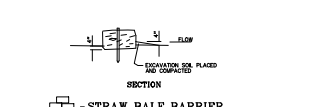

**SECTION**

STRAW BALE BARRIER NOT TO SCALE

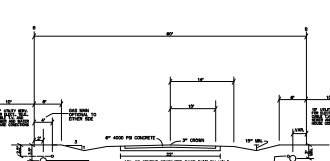

**TYPICAL STREET SECTION**  
SCALE: 1\"/>